

HH-8750 Dining Table

ASSEMBLY INSTRUCTIONS

TECHNICAL SPECIFICATION

SKU: HH-8750-078

DESCRIPTION: Dining Table 78"x40"x30"

Important safety instructions:

- * Please carefully read all instructions before assembling.
- * For your safety, assembly by two or more adults is recommended.
- * Keep instructions for future use.

Pre-assembly:

- * Do not discard any contents until after assembly is complete to avoid accidentally discarding small parts of hardware.
- * Remove parts and hardware from box along with any plastic protective packaging.

Parts :

- * Wood Top
- * 4 Wood Legs

Hardware :

- * 8 Bolts
- * 8 Washers

TO ATTACH THE LEGS TO THE TABLE

NOTE: ENLIST ADDITIONAL HELP FOR THE PROCESS OF ASSEMBLY.

- 1 TURN THE TOP UPSIDE DOWN OVER A CLEAN SURFACE.
- 2 ALIGN THE 4 LEGS TO TABLE TOP.
- 3 ATTACH THE 4 LEGS TO TABLE TOP WITH THE HARDWARE BOLTS AS SHOWN.
- 4 TURN THE TABLE BACK OVER CAREFULLY.

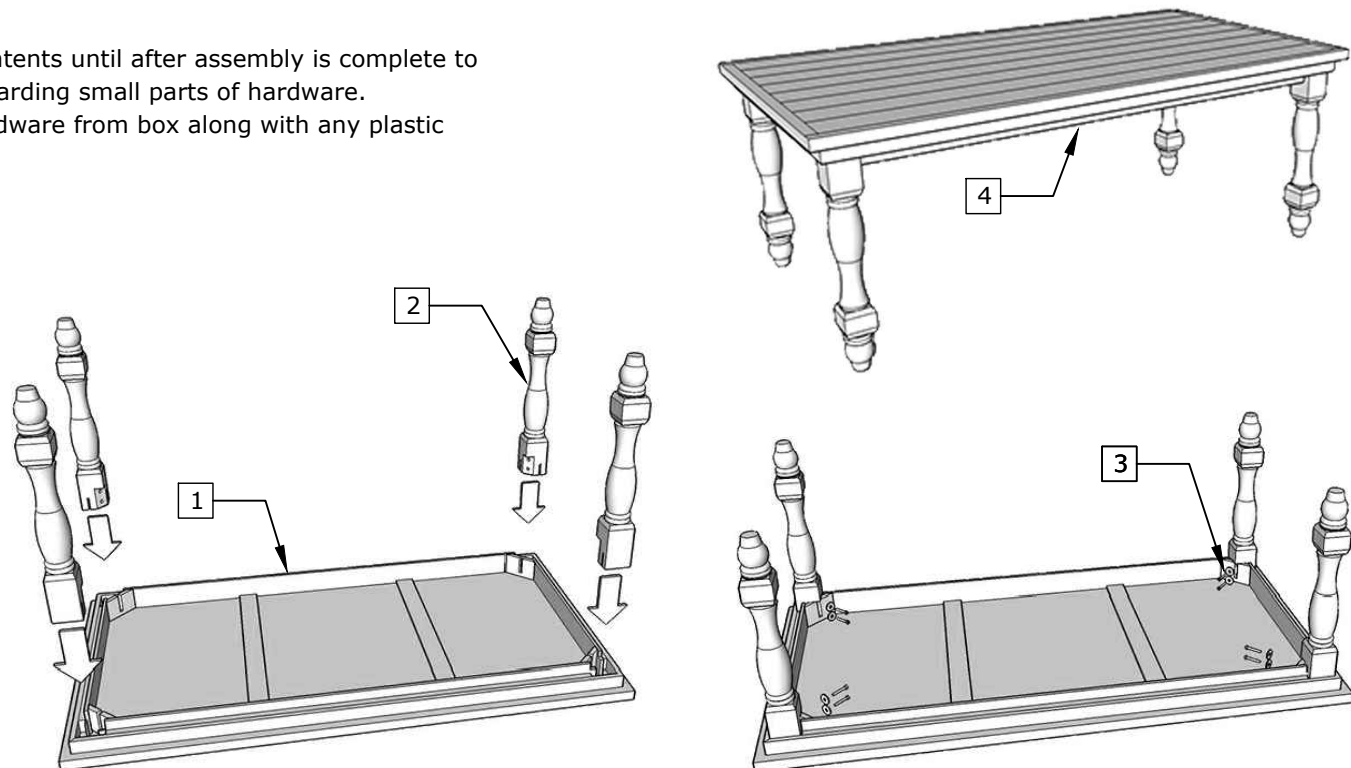

www.sunsettrading.com

info@sunsettrading.com

603-421-0900