

PARTS LIST / LISTE DES PIÈCES / LISTA DE PIEZAS

ITEM NO. / ARTICLE NO. / ARTICULO NO : P301502

DESCRIPTION/LA DESCRIPCION/DESCRIPCIÓN : Bookcase/Bibliothèque/Biblioteca

WARNING



Children have died from furniture tipover. To reduce the risk of furniture tipover:

- ALWAYS install tipover restraint provided.
- NEVER put a TV on this product.
- NEVER allow children to stand, climb or hang on drawers, doors, or shelves.
- NEVER open more than one drawer at a time.
- Place heaviest items in the lowest drawers.

This is a permanent label. Do not remove!

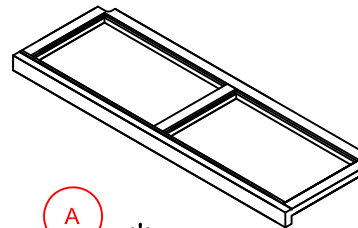
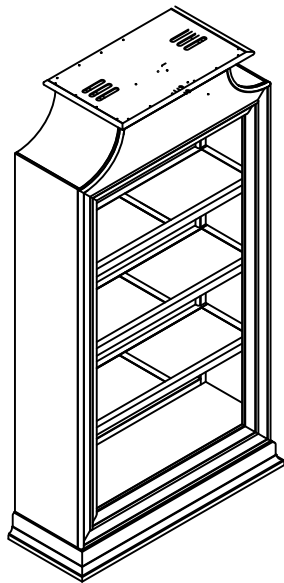

A *
 x2 Adjustable Shelf
 x2 Tablette ajustable
 x2 Estante ajustable

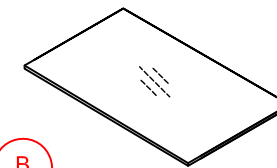

B *
 x6 Glass Shelf
 x6 Étagère en verre
 x6 Estante de vidrio

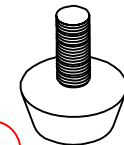

C *
 x2 Adjustable leveler
 x2 Patin réglable
 x2 Nivelador ajustable

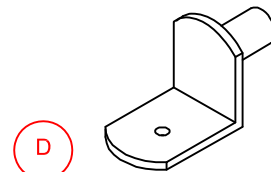

D *
 x8 Shelf Supports
 x8 Supports Pour Tablette
 x8 Soporte De Las Repisas

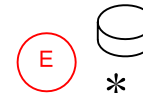

E *
 x18 Glass pad
 x18 Coussin en verre
 x18 Almohadilla de vidrio



F *
 x1 Tipping restraint
 x1 Liste des pièces de quincaillerie antibasculement
 x1 Abrazadera antivuelco

* Replaceable Part

ASSEMBLY INSTRUCTIONS/ NOTICE DE MONTAGE/ INSTRUCCIONES DE MONTAJE

ITEM NO. / ARTICLE NO. / ARTICULO NO : P301502

DESCRIPTION/LA DESCRIPCION/DESCRIPCIÓN : Bookcase/Bibliothèque/Biblioteca

⚠ WARNING	
	Children have died from furniture tipover. To reduce the risk of furniture tipover: <ul style="list-style-type: none">• ALWAYS install tipover restraint provided.• NEVER put a TV on this product.• NEVER allow children to stand, climb or hang on drawers, doors, or shelves.• NEVER open more than one drawer at a time.• Place heaviest items in the lowest drawers. <i>This is a permanent label. Do not remove!</i>
	

Anti-Tipping/ Liste des pièces de quincaillerie antibasculement/
Lista del kit de materiales antivuelco

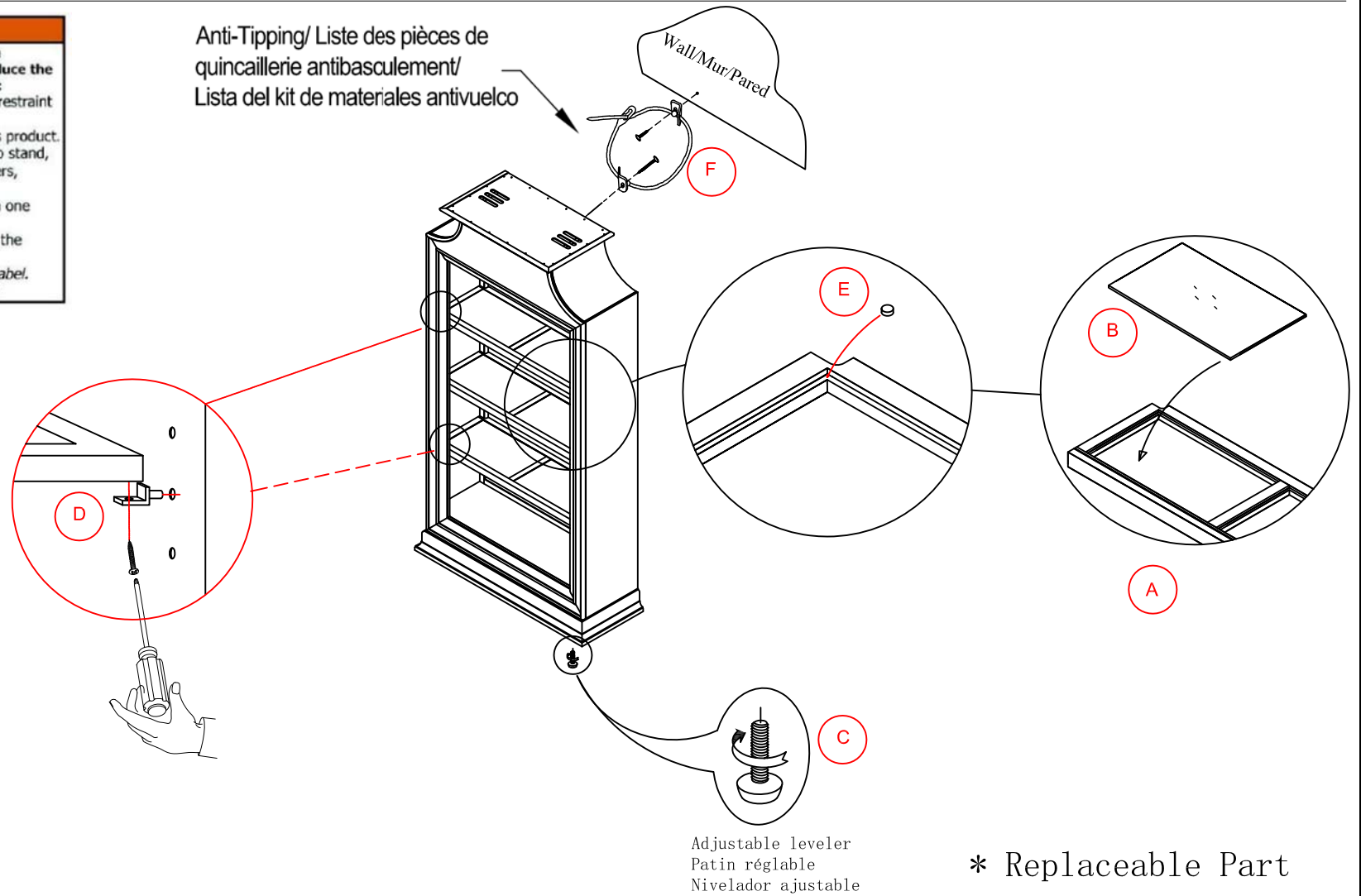

REPLACEABLE PART/ PARTIE REMPLACABLE/ PARTE REEMPLAZABLE

ITEM NO. / ARTICLE NO. / ARTICULO NO : P301502

DESCRIPTION/LA DESCRIPCION/DESCRIPCIÓN : Bookcase/Bibliothèque/Biblioteca

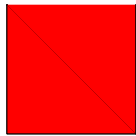

WARNING

Children have died from furniture tipover. To reduce the risk of furniture tipover:

- ALWAYS install tipover restraint provided.
- NEVER put a TV on this product.
- NEVER allow children to stand, climb or hang on drawers, doors, or shelves.
- NEVER open more than one drawer at a time.
- Place heaviest items in the lowest drawers.

This is a permanent label. Do not remove!

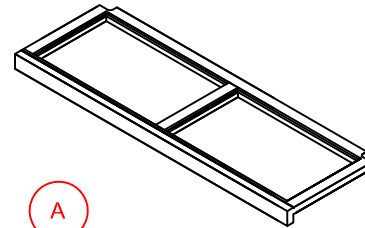
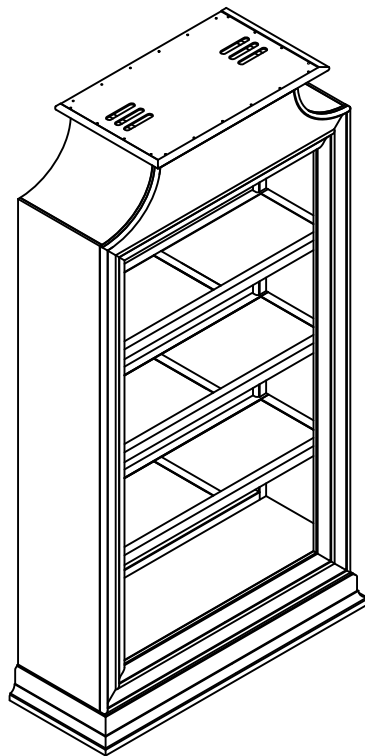

A

* x2 RP301502-ASHELF
Adjustable Shelf
Tablette ajustable
Estante ajustable

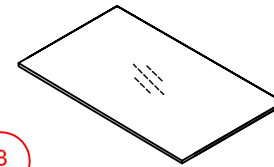

B

* x6 RP301502-SHELF
Glass Shelf
Étagère en verre
Estante de vidrio

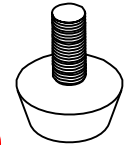

C

* x2 RP301502-LEVE
Adjustable leveler
Patin réglable
Nivelador ajustable

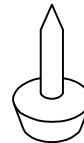

D

* x2 RP301502-NAIL
Plastic Nail
Clou en plastique
Clavo de plástico

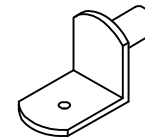

E

* x8 RP301502-SUPP
Shelf Supports
Supports Pour Tablette
Soporte De Las Repisas



F

* x18 RP301502-PAD
Glass pad
Coussin en verre
Almohadilla de vidrio



G

* x1 RC-ANTI-TIP
Tipping restraint
Liste des pièces de quincaillerie antibasculement
Abrazadera antivuelco

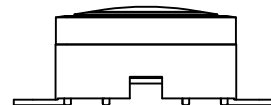

H

* RP301502-LIGHT
* x1 Light
x1 Éclairage
x1 Iluminación

* Replaceable Part