

PARTS LIST / LISTE DES PIÈCES / LISTA DE PIEZAS

ITEM NO. / NO D'ARTICLE / ARTICULO NO. : P361260

DESCRIPTION / LA DESCRIPTION / DESCRIPCIÓN : WOOD BACK SIDE CHAIR / CHAISE D'APPOINT AVEC DOSSIER EN BOIS / SILLA CON RESPALDO DE MADERA

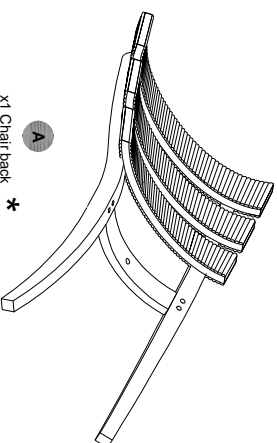
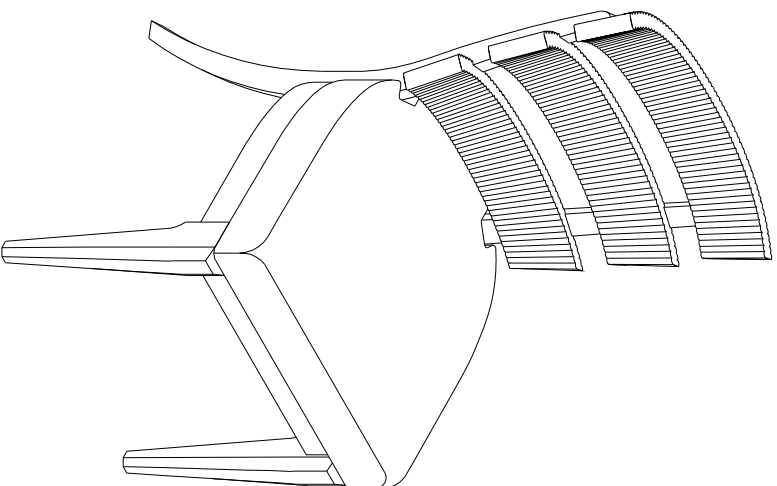

- A**
- X1 Chair back *
 - X1 Dossier de chaise
 - X1 Respaldo de la silla

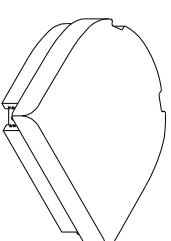

- B**
- X1 Seat Cushions *
 - X1 Coussins de siège
 - X1 Colchines de asientos

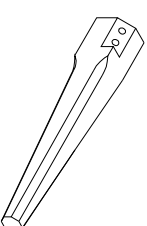

- C**
- X2 Left/Right front leg *
 - X2 Gaucher/Déas brazo pata delantera
 - X2 Izquierda/Derecho pata delantera

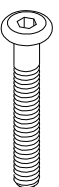

- D**
- X8 Allen bolt $\phi 5/16" \times 64mm$ *
 - X8 Vis à tête creuse hexagonale $\phi 5/16" \times 64mm$
 - X8 Perno Allen $\phi 5/16" \times 64mm$

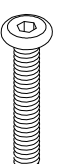

- E**
- X1 Allen bolt $\phi 5/16" \times 38mm$ *
 - X1 Vis à tête creuse hexagonale $\phi 5/16" \times 38mm$
 - X1 Perno Allen $\phi 5/16" \times 38mm$



- F**
- X9 Flat Washer $\phi 5/16" \times 19 \times 2mm$ *
 - X9 Rondelle plate $\phi 5/16" \times 19 \times 2mm$
 - X9 Arandela plana $\phi 5/16" \times 19 \times 2mm$



- G**
- X9 Lock washer $\phi 5/16"$ *
 - X9 Rondelle de blocage $\phi 5/16"$
 - X9 Arandela de Seguridad $\phi 5/16"$

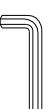

- H**
- X1 Allen Key 5mm *
 - X1 Cle hexagonale 5mm
 - X1 Llave Allen 5mm

* Replaceable Part

Residential Use Only

Made In Vietnam / Fabriqué au Vietnam / Hecho en Vietnam
For assembly instruction video, please go to: www.myfurnitureinstructions.com

ASSEMBLY INSTRUCTIONS/ NOTICE DE MONTAGE/ INSTRUCCIONES DE MONTAJE

ITEM NO./ NO D'ARTICLE/ ARTICULO NO. : P361260

DESCRIPTION/ LA DESCRIPTION /DESCRIPCIÓN :WOOD BACK SIDE CHAIR/ CHAISE D'APPOINT AVEC DOSSIER EN BOIS/ SILLA CON RESPALDO DE MADERA

STEP 1
ÉTAPE 1
PASO 1

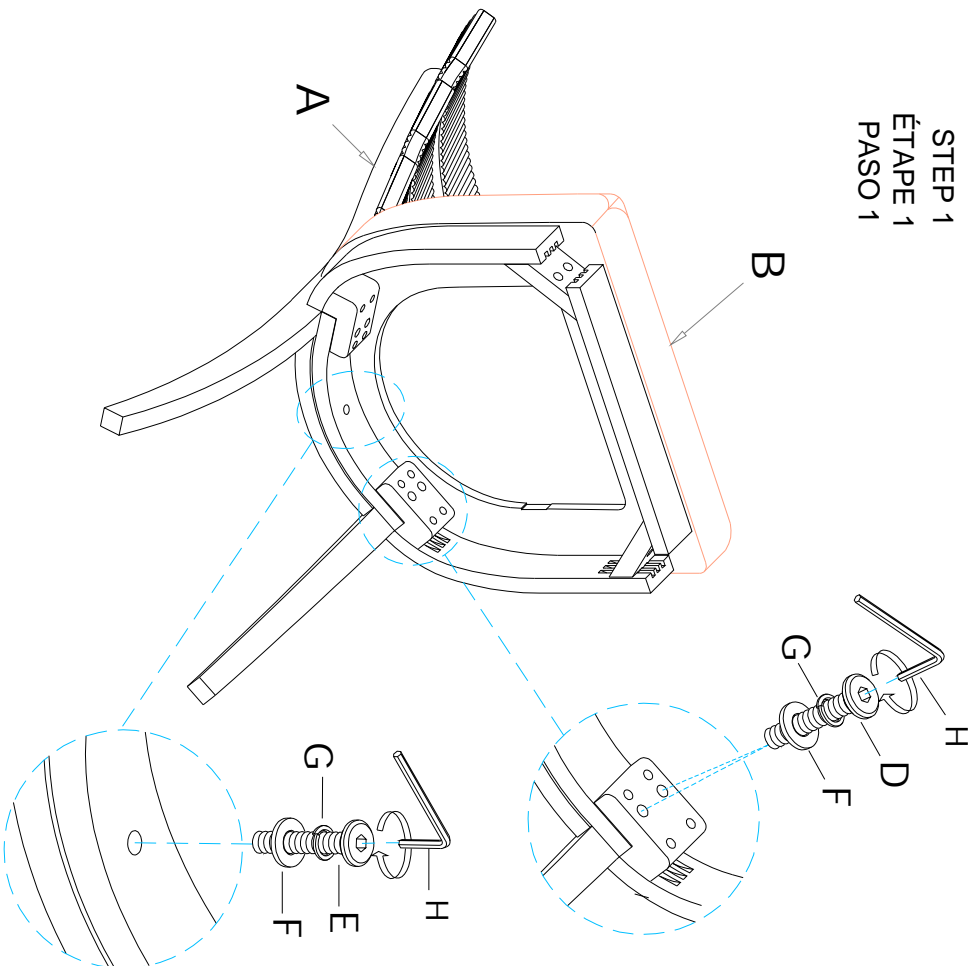

STEP 2
ÉTAPE 2
PASO 2

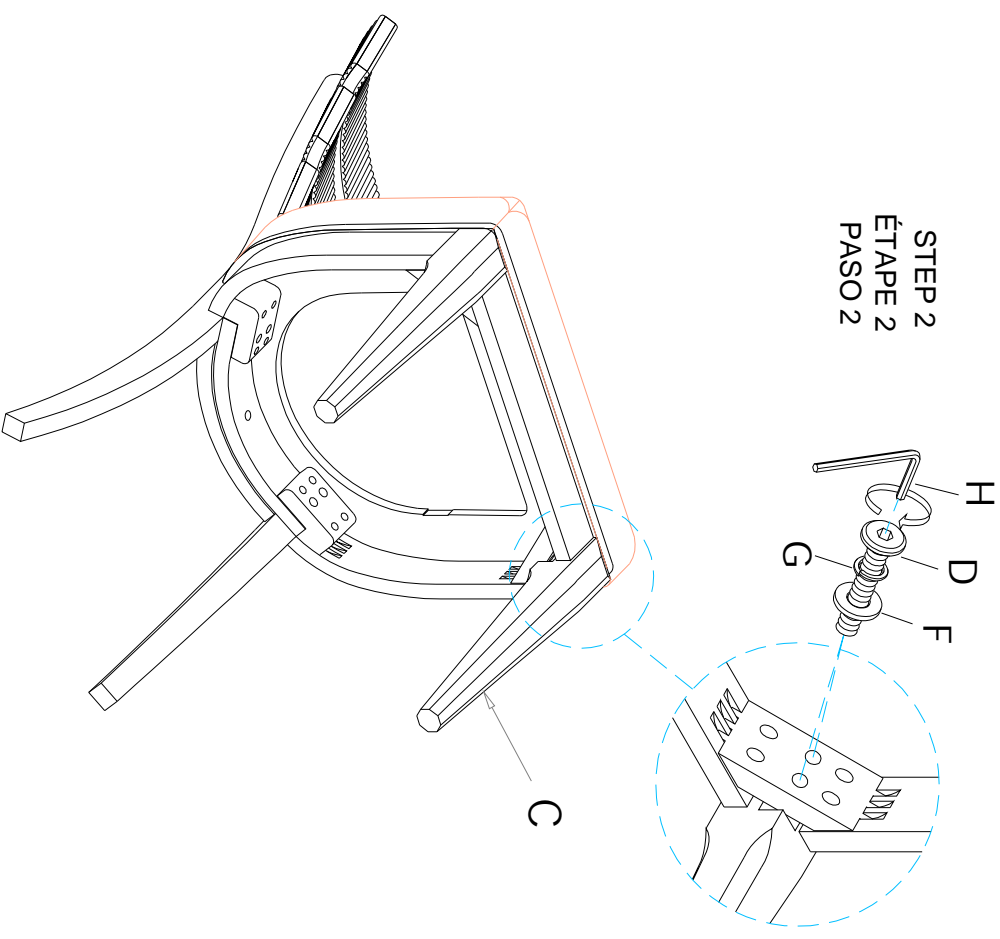

* Replaceable Part

Residential Use Only

REPLACEABLE PART / PARTIE REMPLAÇABLE / PARTE REEMPLAZABLE

ITEM NO./ NO D'ARTICLE/ ARTICULO NO. : P361260
 DESCRIPTION/ LA DESCRIPTION / DESCRIPCIÓN : WOOD BACK SIDE CHAIR/ CHAISE D'APPOINT AVEC DOSSIER EN BOIS/ SILLA CON RESPALDO DE MADERA

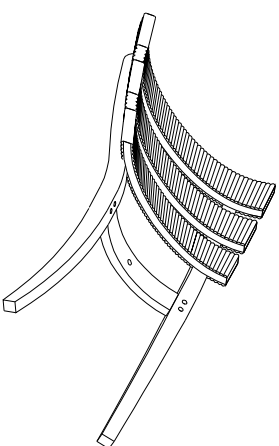
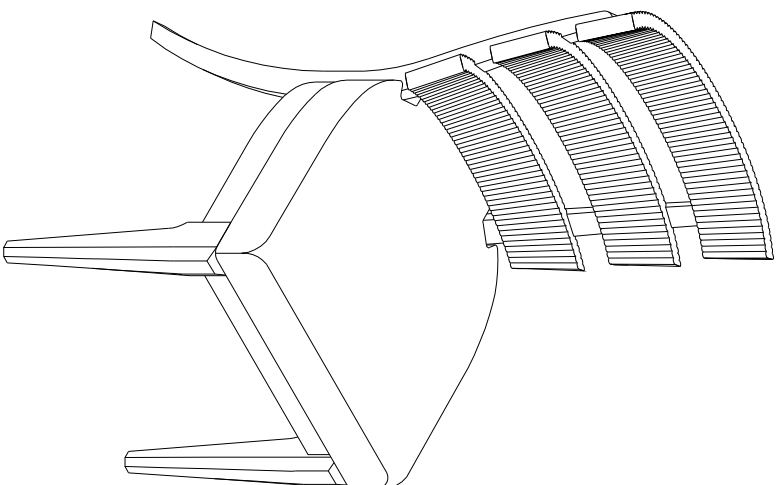

x1 RP361-260-BACK- Chair Back
 Dossier de chaise
 Pespaldo de silla *

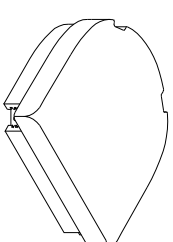

x1 RP361-260-FRAME- Seat frame with cushion
 Siège avec coussin
 Cqj In de asiento con cuadro del asiento *

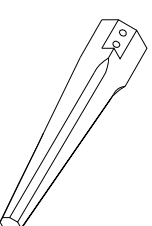

x1 RP361260LEGR-Front leg (Right)
 Patte avant (Arrière)
 Pata delantera (Derecha) *

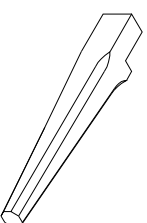

x1 RP361260-LEGL- Front leg (Left) *



x1 RP361260-HWKIT-Hardware
 Liste des pièces de quincaillerie
 Lista del kit de materiales *

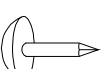

x4 RC-WH-NAIL - White Plastic Nail
 Clou en plastique
 Clavo de plástico

* Replaceable Part

Residential Use Only

Made In Vietnam / Fabriqué au Vietnam / Hecho en Vietnam
 For assembly instruction video, please go to: www.myfurnitureinstructions.com

Protect Your Wood or Laminate Flooring

* This statement applies to any floor without carpet.

If not careful, all furniture including upholstery and case pieces can scratch, scuff and even gouge floors. The recommendation is to have felt, rubber pads or area rugs under furniture on flooring without carpet.

Moving your furniture

Pushing and dragging furniture over floor without carpet can lead to scratches and scuffs. Have someone help when moving the larger pieces of furniture by lifting, try using a dolly or moving pads.

Felt and rubber pads

Applying furniture pads to the feet of furniture helps cushion contact points. Furniture pads can be found at local hardware stores. Felt pads slide easily across the floor, making them ideal for dining chairs and other pieces that move with use. Rubber pads will help furniture stay in place and are perfect for larger pieces, like sofas and loveseats.

Area rugs and rug pads

Using an are rug under furniture is another way to protect your floor from scratches and scuff marks. A rug pad under the area rug will provide extra cushion and added protection.

* *Reproducible Part*