

x1 Tipping restraint  
x1 Liste des pièces de quincaillerie antibasculement  
x1 Abrazadera antivuelco

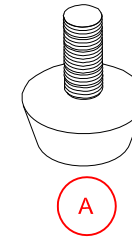

x2 Adjustable leveler-Brown  
x2 Patin réglable  
x2 Nivelador ajustable

\* Replaceable Part

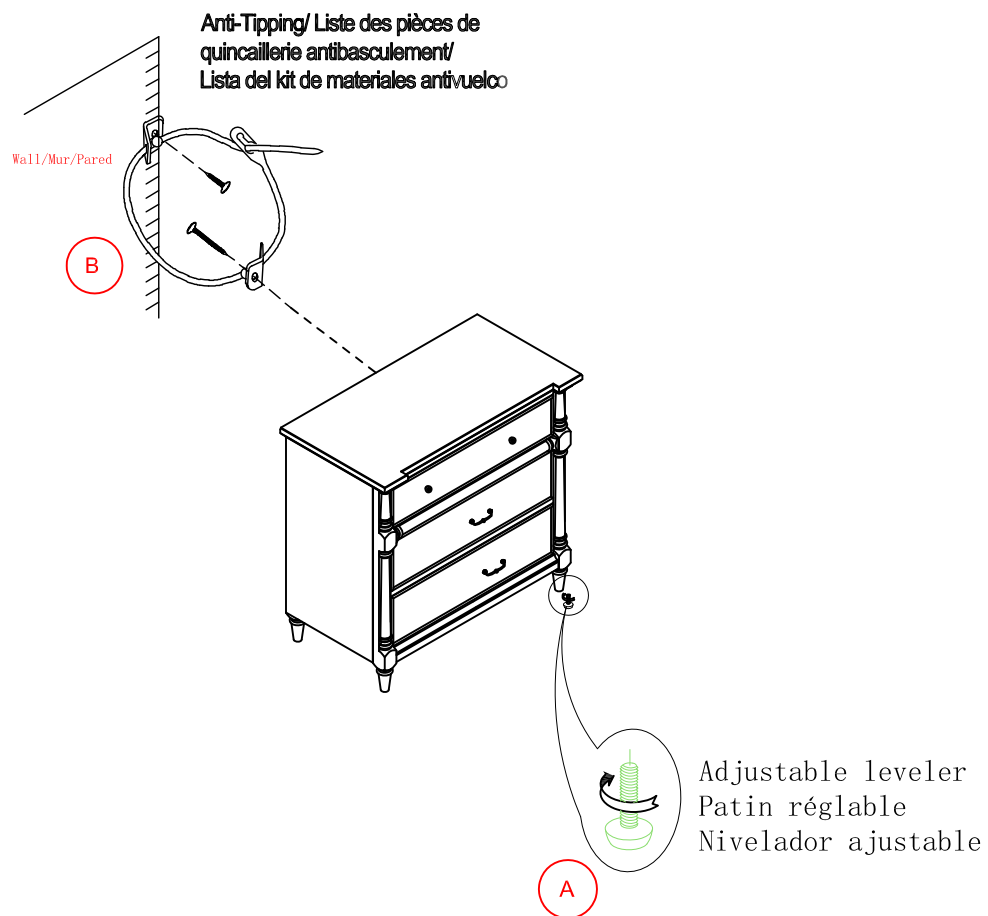

\* Replaceable Part

# HF

# HOOKER® FURNISHINGS

REPLACEABLE PART/ PARTIE REMPLACABLE/ PARTE REEMPLAZABLE

ITEM NO. / ARTICLE NO. / ARTICULO NO : P348123

DESCRIPTION/LA DESCRIPCION/DESCRIPCIÓN : Bachelor'S Chest-Commode-Cómoda



RP348123-USB \*  
x1 USB Outlet  
x1 Prise de courant  
x1 Enchufe

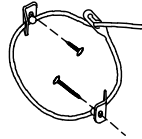

RC-ANTI-TIP \*  
x1 Tipping restraint  
x1 Liste des pièces de quincaillerie antibasculement  
x1 Abrazadera antivuelco

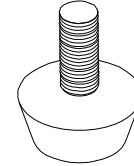

RC-FG-BROWN \*  
x2 Adjustable leveler-Brown  
x2 Patin réglable  
x2 Nivelador ajustable

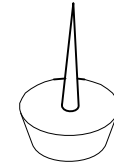

RC-BR-NAIL  
x2 Plastic Nail \*  
x2 Clou en plastique  
x2 Clavo de plástico

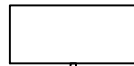

RP348123-FELT \*  
x1 Removable Felt-Brown  
x1 Feutre  
x1 Fieltro

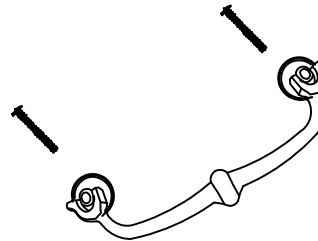

RP348100-PULL \*  
x2 Pull with screw  
x2 Tirer et vis  
x2 Tire y Tornillo

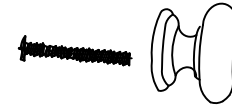

RP348100-KNOB \*  
x2 Knob with screw  
x2 Tirer et vis  
x2 Tire y Tornillo

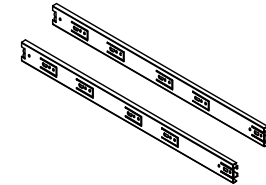

COMGLIDE-10-45 \*  
x3 Drawer Glide 10"L x 45mmW  
x3 Glissière  
x3 Carril de deslizamiento

\* Replaceable Part

## **Protect Your Wood or Laminate Flooring**

\*This statement applies to any floor without carpet.

If not careful, all furniture including upholstery and case pieces can scratch, scuff and even gouge floors. The recommendation is to have felt, rubber pads or area rugs under furniture on flooring without carpet.

### **Moving your furniture**

Pushing and dragging furniture over floors without carpet can lead to scratches and scuffs. Have someone help when moving the larger pieces of furniture by lifting, try using a dolly or moving pads.

### **Felt and rubber pads**

Applying furniture pads to the feet of furniture helps cushion contact points. Furniture pads can be found at local hardware stores. Felt pads slide easily across the floor, making them ideal for dining chairs and other pieces that move with use. Rubber pads will help furniture stay in place and are perfect for larger pieces, like sofas and loveseats.

### **Area rugs and rug pads**

Using an area rug under furniture is another way to protect your floor from scratches and scuff marks. A rug pad under the area rug will provide extra cushion and added protection.