

x2 Adjustable Shelf
x2 Tablette ajustable
x2 Estante ajustable

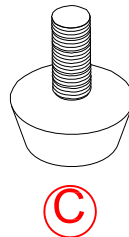

x1 Tipping restraint
x1 Liste des pièces de quincaillerie antibasculement
x1 Abrazadera antivuelco

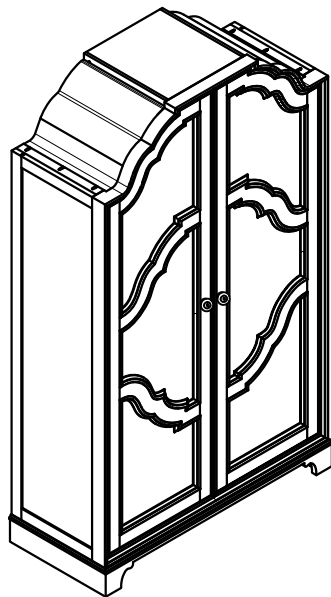

x2 Adjustable leveler-Brown
x2 Patin réglable
x2 Nivelador ajustable



x8 Shelf Supports
x8 Supports Pour Tablette
x8 Soporte De Las Repisas

* Replaceable Part

WARNING

Children have died from furniture tipover. To reduce the risk of furniture tipover:

- ALWAYS install tipover restraint provided.
- NEVER put a TV on this product.
- NEVER allow children to stand, climb or hang on drawers, doors, or shelves.
- NEVER open more than one drawer at a time.
- Place heaviest items in the lowest drawers.

This is a permanent label. Do not remove!

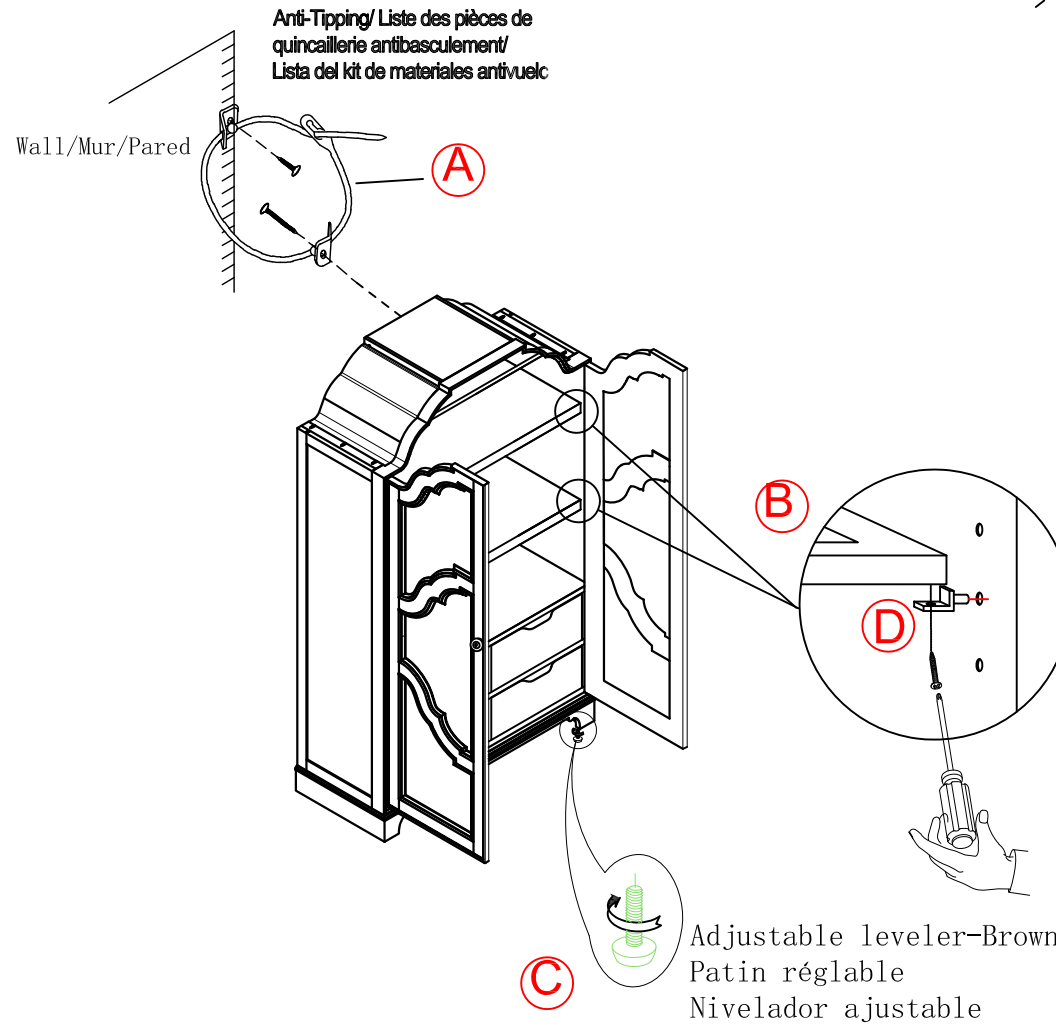

* Replaceable Part

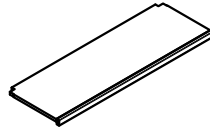

RP348120-SHELF *
x2 Adjustable Shelf
x2 Tablette ajustable
x2 Estante ajustable



RC-ANTI-TIP *
x1 Tipping restraint
x1 Liste des pièces de quincaillerie antibasculement
x1 Abrazadera antivuelco

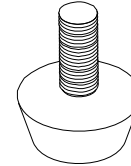

RC-FG-BROWN
x2 Adjustable leveler-Brown *
x2 Patin réglable
x2 Nivelador ajustable



RP348120-SUPP *
x8 Shelf Supports
x8 Supports Pour Tablette
x8 Soporte De Las Repisas

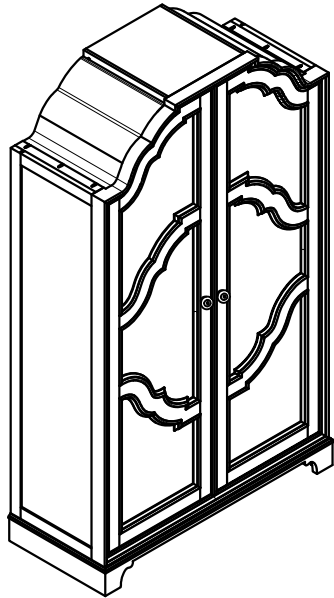

RP348100-KNOB *
x2 Pull with screw
x2 Tirer et vis
x2 Tire y Tornillo

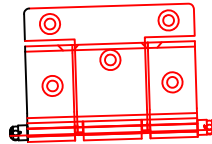

RP348120-HINGE *
x8 Door Hinge
x8 Charnière de porte
x8 Bisagra de la puerta

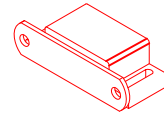

RP348120-CATCH *
x4 Door Catch
x4 Catch de aimant
x4 Captura de imã

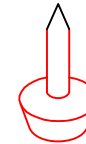

RC-BR-NAIL *
x2 Plastic Nail
x2 Clou en plastique
x2 Clavo de plástico

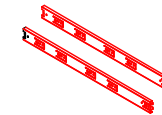

COMGLIDE-12-45 *
x4 Drawer Glide 12"Lx 45mmW
x4 Glissière
x4 Carril de deslizamiento

* Replaceable Part

Protect Your Wood or Laminate Flooring

*This statement applies to any floor without carpet.

If not careful, all furniture including upholstery and case pieces can scratch, scuff and even gouge floors. The recommendation is to have felt, rubber pads or area rugs under furniture on flooring without carpet.

Moving your furniture

Pushing and dragging furniture over floors without carpet can lead to scratches and scuffs. Have someone help when moving the larger pieces of furniture by lifting, try using a dolly or moving pads.

Felt and rubber pads

Applying furniture pads to the feet of furniture helps cushion contact points. Furniture pads can be found at local hardware stores. Felt pads slide easily across the floor, making them ideal for dining chairs and other pieces that move with use. Rubber pads will help furniture stay in place and are perfect for larger pieces, like sofas and loveseats.

Area rugs and rug pads

Using an area rug under furniture is another way to protect your floor from scratches and scuff marks. A rug pad under the area rug will provide extra cushion and added protection.