

K

x1 Center Leg
x1 Pattes centrales
x1 Patas centrales

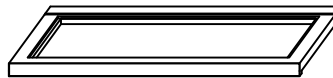

L

x6 Adjustable Shelf
x6 Tablette ajustable
x6 Estante ajustable

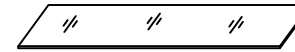

M

x6 Glass Shelf
x6 Étagère en verre
x6 Estante de vidrio



N

x24 Shelf Supports
x24 Supports Pour Tablette
x24 Soporte De Las Repisas

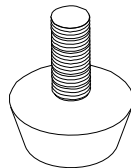

O

x4 Adjustable leveler-Brown
x4 Patin réglable
x4 Nivelador ajustable

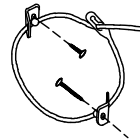

A

x1 Tipping restraint *
x1 Liste des pièces de quincaillerie antibasculement
x1 Abrazadera antivuelco



B

x1 Allen Wrench
x1 Clé hexagonale
x1 Llave Allen

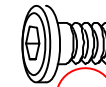

C

x4 Bolt 1/4*19mm
x4 Boulon
x4 Perno



D

x4 Lock washer 1/4 "
x4 Rondelle de blocage
x4 Arandela de Seguridad



E

x4 Flat Washer
1/4*16mm
x4 Rondelle plate
x4 Arandela plana

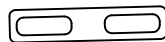

F

x2 Metal plate
x2 Plaque de métal
x2 Placa de metal

* Replaceable Part

WARNING

Children have died from furniture tipover. To reduce the risk of furniture tipover:

- ALWAYS install tipover restraint provided.
- NEVER put a TV on this product.
- NEVER allow children to stand, climb or hang on drawers, doors, or shelves.
- NEVER open more than one drawer at a time.
- Place heaviest items in the lowest drawers.

This is a permanent label. Do not remove!

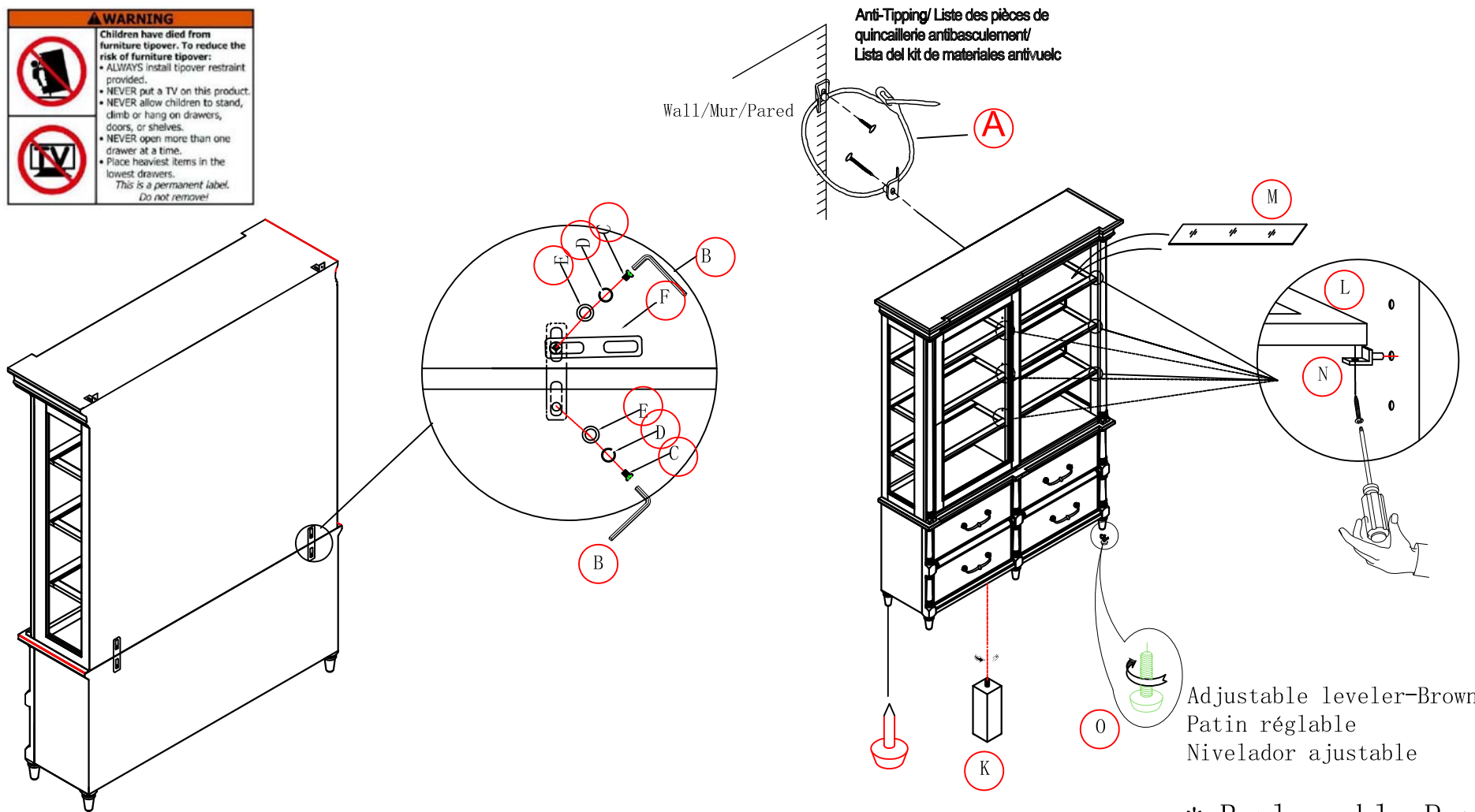

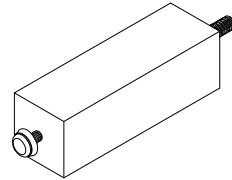
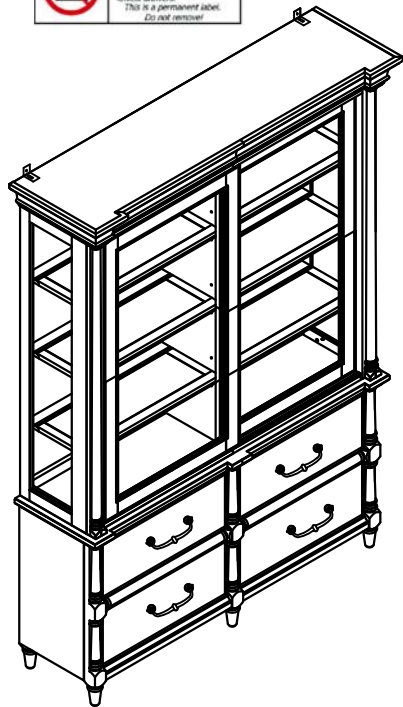

RP348300-CELEG *
x1 Center Leg
x1 Pattes centrales
x1 Patas centrales

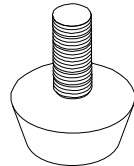

RC-FG-BROWN *
x4 Adjustable leveler-Brown
x4 Patin réglable
x4 Nivelador ajustable

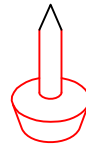

RC-BR-NAIL *
x2 Plastic Nail
x2 Clou en plastique
x2 Clavo de plástico

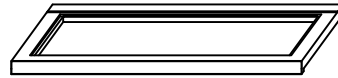

RP348301-SHELF *
x6 Adjustable Shelf
x6 Tablette ajustable
x6 Estante ajustable

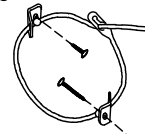

RC-ANTI-TIP *
x1 Tipping restraint
x1 Liste des pièces de quincaillerie antibasculement
x1 Abrazadera antivuelco

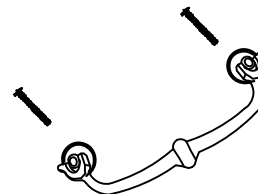

RP348100-PULL *
x4 Pull with screw
x4 Tirer et vis
x4 Tire y Tornillo

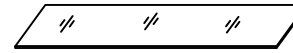

RP348301-GLASS *
x6 Glass Shelf
x6 Étagère en verre
x6 Estante de vidrio

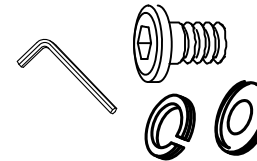

RP348301-HWKIT *
x1 Hardware Kit
x1 Liste des pièces de quincaillerie
x1 Lista del materiales

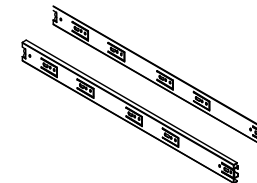

COMGLIDE-10-45 *
x4 Drawer Glide 10"L x 45mmW
x4 Glissière
x4 Carril de deslizamiento



RP348301-SUPP *
x24 Shelf Supports
x24 Supports Pour Tablette
x24 Soporte De Las Repisas

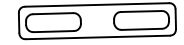

RP348301-PLATE *
x2 Metal plate
x2 Plaque de métal
x2 Placa de metal

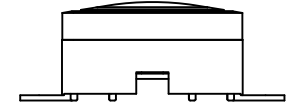

RP348301-LIGHT *
x1 Light
x1 Éclairage
x1 Iluminación

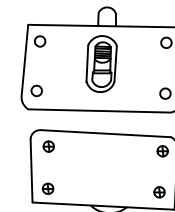

RP348301-ROLLER *
x4 Common roller
x4 Rouleau
x4 Rodillo

* Replaceable Part

Protect Your Wood or Laminate Flooring

*This statement applies to any floor without carpet.

If not careful, all furniture including upholstery and case pieces can scratch, scuff and even gouge floors. The recommendation is to have felt, rubber pads or area rugs under furniture on flooring without carpet.

Moving your furniture

Pushing and dragging furniture over floors without carpet can lead to scratches and scuffs. Have someone help when moving the larger pieces of furniture by lifting, try using a dolly or moving pads.

Felt and rubber pads

Applying furniture pads to the feet of furniture helps cushion contact points. Furniture pads can be found at local hardware stores. Felt pads slide easily across the floor, making them ideal for dining chairs and other pieces that move with use. Rubber pads will help furniture stay in place and are perfect for larger pieces, like sofas and loveseats.

Area rugs and rug pads

Using an area rug under furniture is another way to protect your floor from scratches and scuff marks. A rug pad under the area rug will provide extra cushion and added protection.