

PARTS LIST / LISTE DES PIÈCES / LISTA DE PIEZAS

ITEM NO. / ARTICLE NO. / ARTICULO NO : P301603

DESCRIPTION / LA DESCRIPCION / DESCRIPCIÓN : Door Credenza/Bahut/Aparador

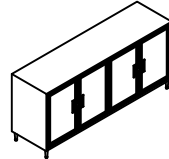
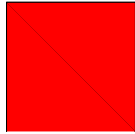

**A**

x 1 Door Credenza  
x1 Bahut  
x1 Aparador

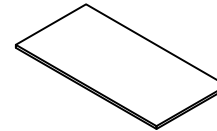

**B** \*

x2 Wood Shelf  
x2 étagère  
x2 estante



**C** \*

x5 Legs  
x5 jambes  
x5 Piernas

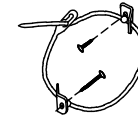

**D** \*

x1 Tipping restraint  
x1 Liste des pièces de  
quincaillerie antibasculement  
x1 Abrazadera antivuelco

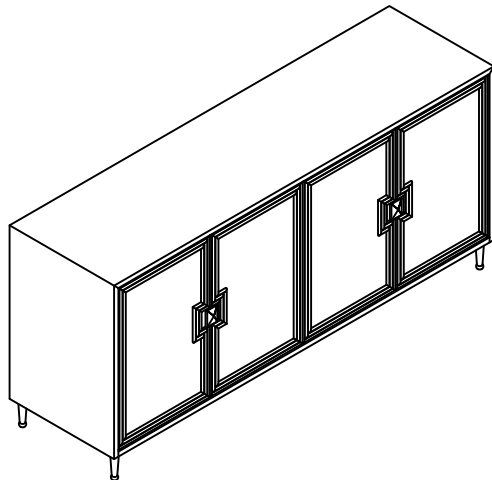

**E** \*

x1 Allen Wrench  
x1 Clé hexagonale  
x1 Llave Allen



**F** \*

x15 Bolt  
x15 Boulon  
x15 Perno



**G** \*

x15 Lock washer  
x15 Rondelle de blocage  
x15 Arandela de Seguridad



**H** \*

x15 Flat Washer  
x15 Rondelle plate  
x15 Arandela plana



**I** \*

x5 Adjustable leveler  
x5 Patin réglable  
x5 Nivelador ajustable

\* Replaceable Part

ASSEMBLY INSTRUCTIONS/ NOTICE DE MONTAGE/ INSTRUCCIONES DE MONTAJE

ITEM NO. / ARTICLE NO. / ARTICULO NO : P301603

DESCRIPTION / LA DESCRIPCION / DESCRIPCIÓN :Door Credenza/Bahut/Aparador

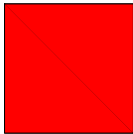

**⚠ WARNING**

Children have died from furniture tipover.  
To reduce the risk of furniture tipover:

- ALWAYS install tipover restraint provided.
- For use with televisions weighing 170 lbs (77.11 kgs) or less. Use with heavier televisions may result in instability causing tip-over resulting in death or serious injury.
- NEVER allow children to stand, climb or hang on drawers, doors, or shelves.
- NEVER open more than one drawer at a time.
- Place heaviest items in the lowest drawers.

*This is a permanent label. Do not remove!*

Anti-Tipping/Liste des pièces de quincaillerie antibasculement/  
Lista del kit de materiales antivuelco

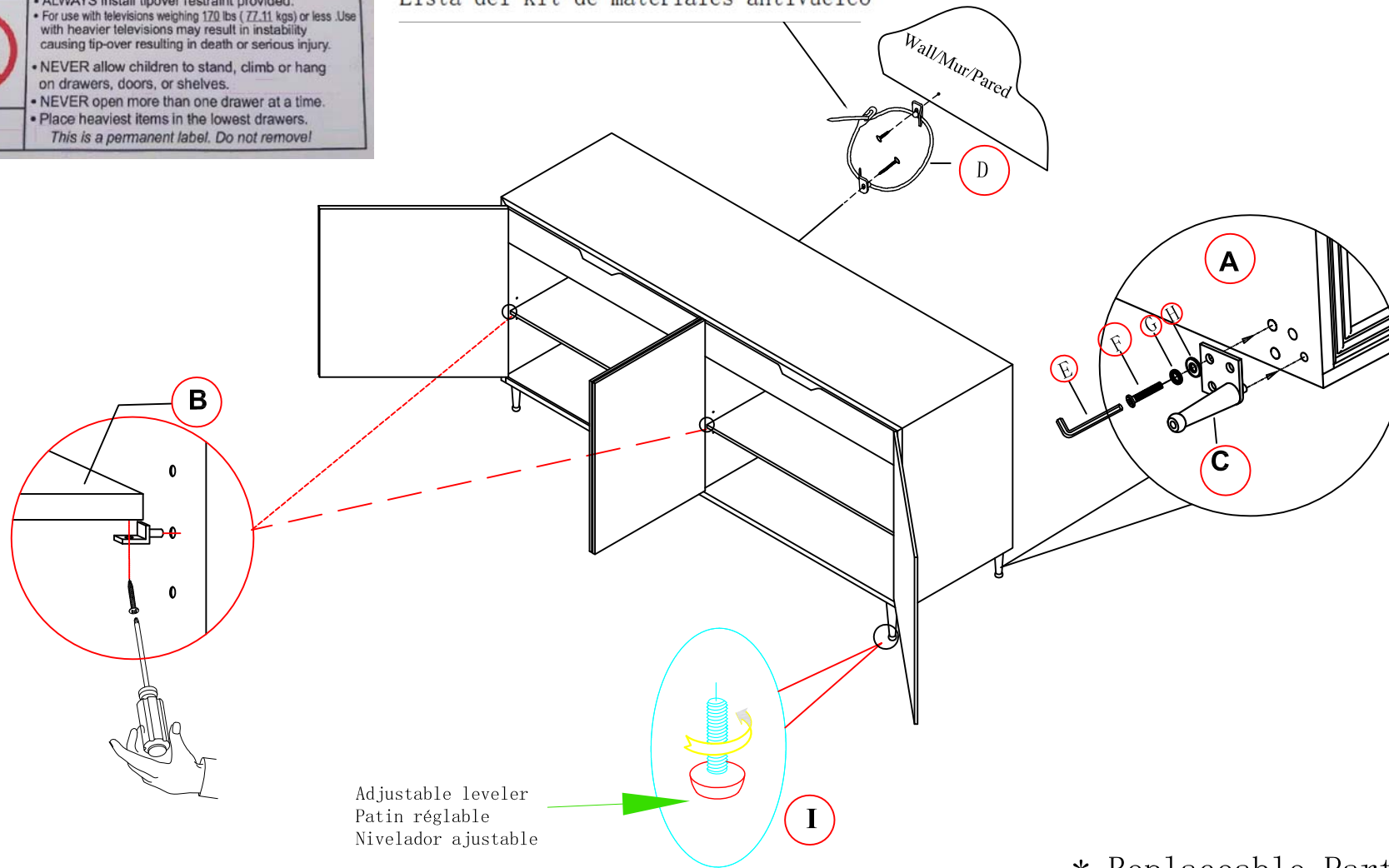

\* Replaceable Part

REPLACEABLE PART/ PARTIE REMPLACABLE/ PARTE REEMPLAZABLE

ITEM NO. / ARTICLE NO. / ARTICULO NO : P301603

DESCRIPTION / LA DESCRIPCION / DESCRIPCIÓN : Door Credenza/Bahut/Aparador

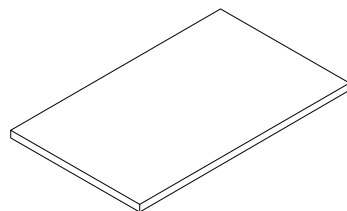

\* x2 RP301603-SHELF  
Wood Shelf  
étagère  
estante

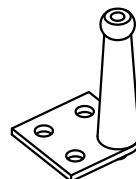

\* x5 RP301603-LEG  
Legs  
jambes  
Piernas

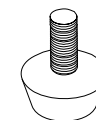

\*x5 RP301603-LEVE  
Adjustable leveler  
Patin réglable  
Nivelador ajustable



\* x2 RP301603-PULL  
Pull with screw  
Tirer et vis  
Tire y Tornillo

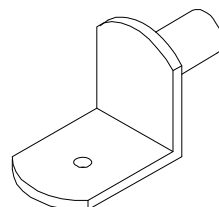
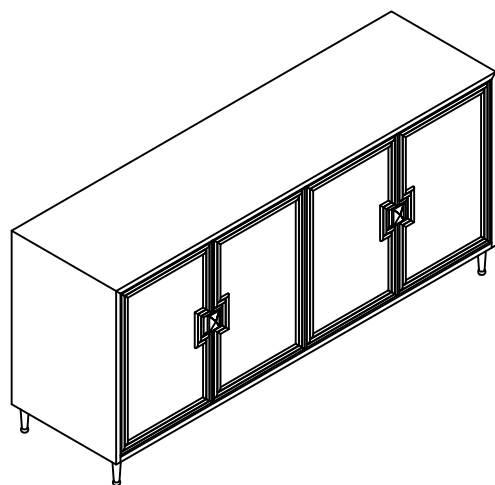

\* x8 RP301603-SUPP  
Shelf Supports  
Supports Pour Tablette  
Soporte De Las Repisas

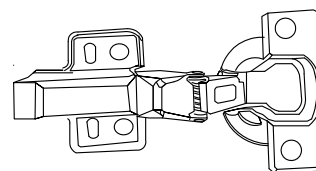

\* x4 RP301603-HINGE1  
Center Door Hinge  
Charnière de porte  
Bisagra de la puerta

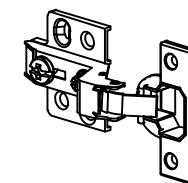

\* x4 RP301603-HINGE2  
Side Door Hinge  
Charnière de porte  
Bisagra de la puerta

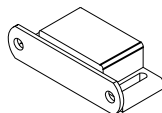

\* x8 RP301603-CATCH  
Door Catch  
Catch de aimant  
Captura de imá



\* x1 RP301603-GROM  
Grommet  
Oeillet  
Ojal

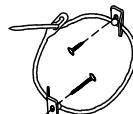

\* x1 RC-ANTI-TIP  
Tipping restraint  
Liste des pièces de  
quincaillerie antibasculement  
Abrazadera antivuelco

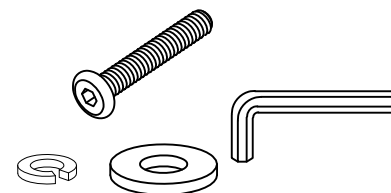

\*x1 RP301603-HWKIT  
Hardware Kit  
Liste des pièces de quincaillerie  
Lista del materiales

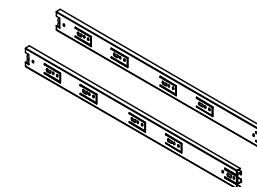

\* x2 RP301603-DG  
Full Extension guides  
Rails à extension complète  
Rieles completamente extensibles

\* Replaceable Part