

PARTS LIST / LISTE DES PIÈCES / LISTA DE PIEZAS

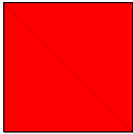

ITEM NO. / ARTICLE NO. / ARTICULO NO : P301529

DESCRIPTION/LA DESCRIPCION/DESCRIPCIÓN : Display Cabinet/Vitrine d' exposition/Vitrina

**WARNING**

Children have died from furniture tipover. To reduce the risk of furniture tipover:

- ALWAYS install tipover restraint provided.
- NEVER put a TV on this product.
- NEVER allow children to stand, climb or hang on drawers, doors, or shelves.
- NEVER open more than one drawer at a time.
- Place heaviest items in the lowest drawers.

*This is a permanent label. Do not remove!*

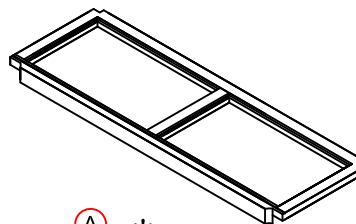
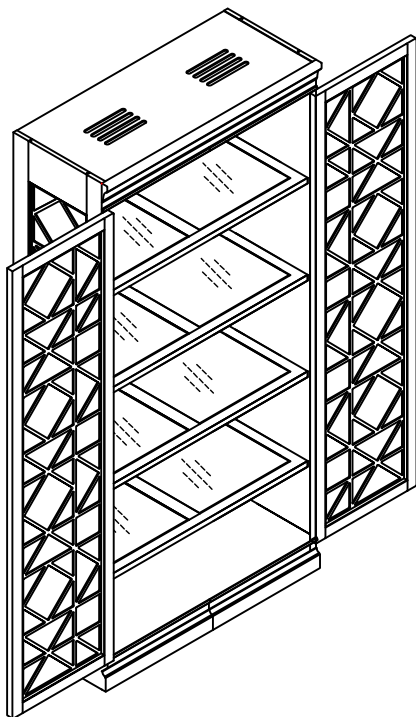

(A) \*

- \* x4 Adjustable Shelf
- x4 Tablette ajustable
- x4 Estante ajustable

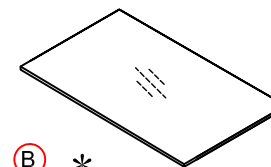

(B) \*

- \* x8 Glass Shelf
- x8 Étagère en verre
- x8 Estante de vidrio

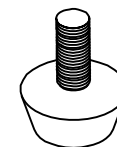

(C) \*

- \* x4 Adjustable leveler
- x4 Patin réglable
- x4 Nivelador ajustable

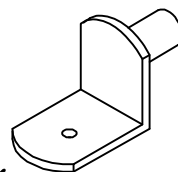

(D) \*

- \* x16 Shelf Supports
- x16 Supports Pour Tablette
- x16 Soporte De Las Repisas

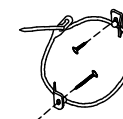

(E) \*

- x1 Tipping restraint
- x1 Liste des pièces de quincaillerie antibasculement
- x1 Abrazadera antivuelco

\* Replaceable Part

ASSEMBLY INSTRUCTIONS/ NOTICE DE MONTAGE/ INSTRUCCIONES DE MONTAJE

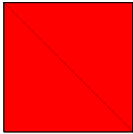

ITEM NO. / ARTICLE NO. / ARTICULO NO : P301529

DESCRIPTION/LA DESCRIPCION/DESCRIPCION : Display Cabinet/Vitrine d' exposition/Vitrina

**WARNING**

Children have died from furniture tipover. To reduce the risk of furniture tipover:

- ALWAYS install tipover restraint provided.
- NEVER put a TV on this product.
- NEVER allow children to stand, climb or hang on drawers, doors, or shelves.
- NEVER open more than one drawer at a time.
- Place heaviest items in the lowest drawers.

*This is a permanent label. Do not remove!*

Anti-Tipping/ Liste des pièces de quincaillerie antibasculement/  
Lista del kit de materiales antivuelco

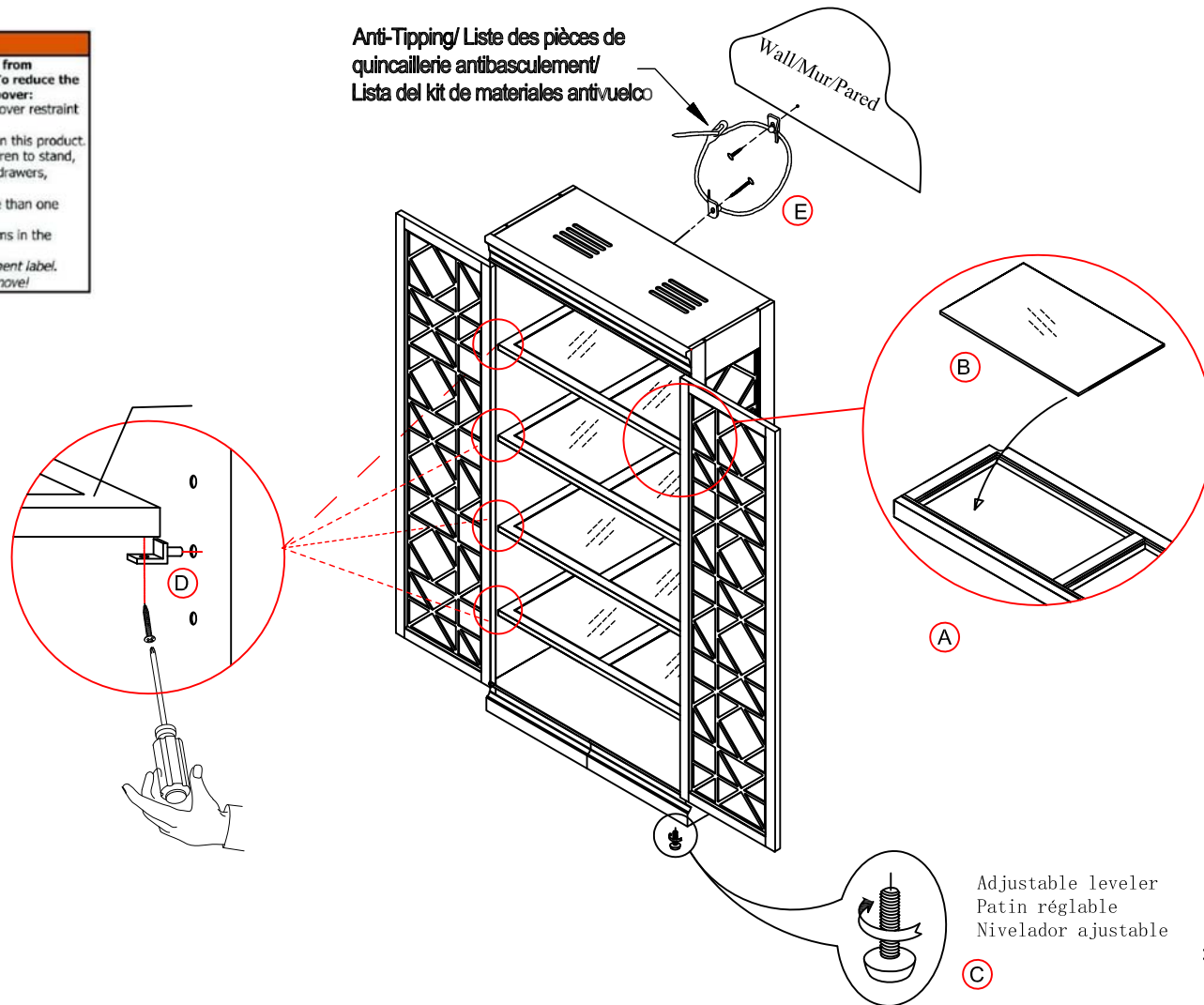

REPLACEABLE PART/ PARTIE REMPLACABLE/ PARTE REEMPLAZABLE

ITEM NO. / ARTICLE NO. / ARTICULO NO : P301529

DESCRIPTION/LA DESCRIPCION/DESCRIPCIÓN : Display Cabinet/Vitrine d' exposition/Vitrina

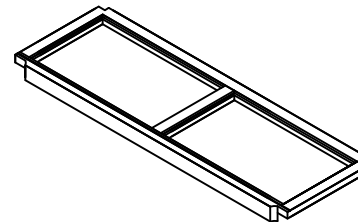
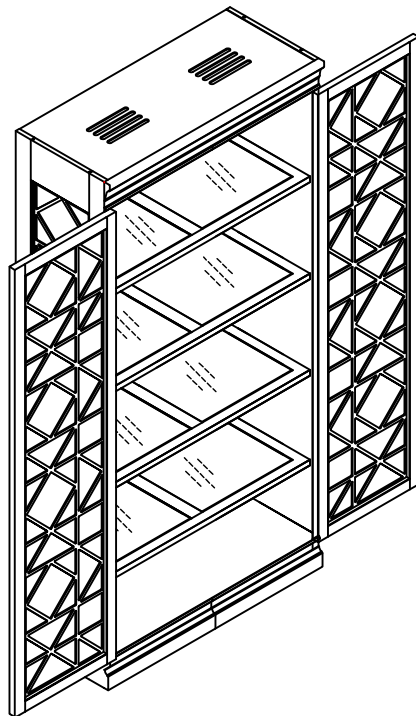

**(A)** \* RP301529-SHELF  
\* x4 Adjustable Shelf  
\* x4 Tablette ajustable  
\* x4 Estante ajustable

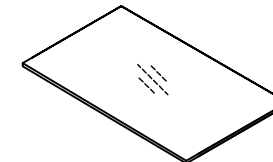

**(B)** \* RP301529-SHELFG  
\* x8 Glass Shelf  
\* x8 Étagère en verre  
\* x8 Estante de vidrio

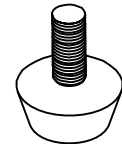

**(C)** \* RP301529-LEVE  
\* x4 Adjustable leveler  
\* x4 Patin réglable  
\* x4 Nivelador ajustable

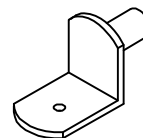

**(D)** \* RP301529-SUPP  
\* x16 Shelf Supports  
\* x16 Supports Pour Tablette  
\* x16 Soporte De Las Repisas



\* RP301529-PULL  
\* x2 RP301526-PULL  
Pull with screw  
Tirer et vis  
Tire y Tornillo



**(E)** \* RC-ANTI-TIP  
x1 Tipping restraint  
x1 Liste des pièces de quincaillerie antibasculément  
x1 Abrazadera antivuelco

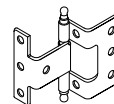

\* x6 RP301529-HINGE  
Door Hinge  
Charnière de porte  
Bisagra de la puerta



\* RP301529-LIGHT  
\* x1 Light  
x1 Éclairage  
x1 Iluminación

\* Replaceable Part