

PARTS LIST / LISTE DES PIÈCES / LISTA DE PIEZAS

ITEM NO. / ARTICLE NO. / ARTICULO NO : P301526

DESCRIPTION / LA DESCRIPCION / DESCRIPCIÓN : Bar/Cabinet-cellier /Mueble bar

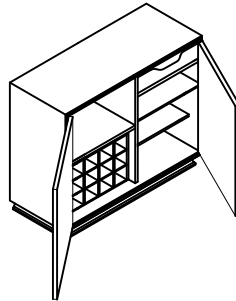

x1 Bar
x1 Cabinet-cellier
x1 Mueble bar

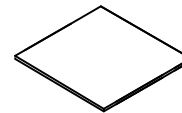

(A) *

x1 Right top Adjustable Shelf A
x1 Tablette ajustable
x1 Estante ajustable

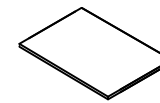

(B) *

x1 Right bottom Adjustable Shelf B
x1 Tablette ajustable
x1 Estante ajustable

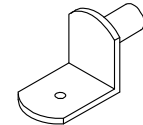

(C) *

x8 Shelf Supports
x8 Supports Pour Tablette
x8 Soporte De Las Repisas

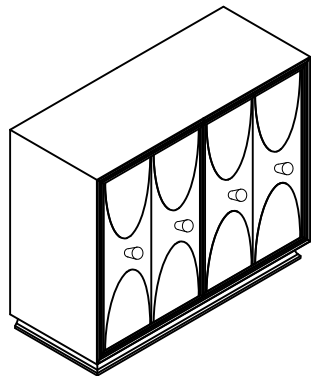

(D) *

x4 Adjustable leveler
x4 Patin réglable
x4 Nivelador ajustable



(E) *

x1 Tipping restraint
x1 Liste des pièces de quincaillerie antibasculement
x1 Abrazadera antivuelco

* Replaceable Part

ASSEMBLY INSTRUCTIONS/ NOTICE DE MONTAGE/ INSTRUCCIONES DE MONTAJE

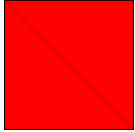

ITEM NO. / ARTICLE NO. / ARTICULO NO : P301526

DESCRIPTION / LA DESCRIPCION / DESCRIPCIÓN : Bar/Cabinet-cellier /Mueble bar



Anti-Tipping/ Liste des pièces de quincaillerie antibasculement/
Lista del kit de materiales antivuelco

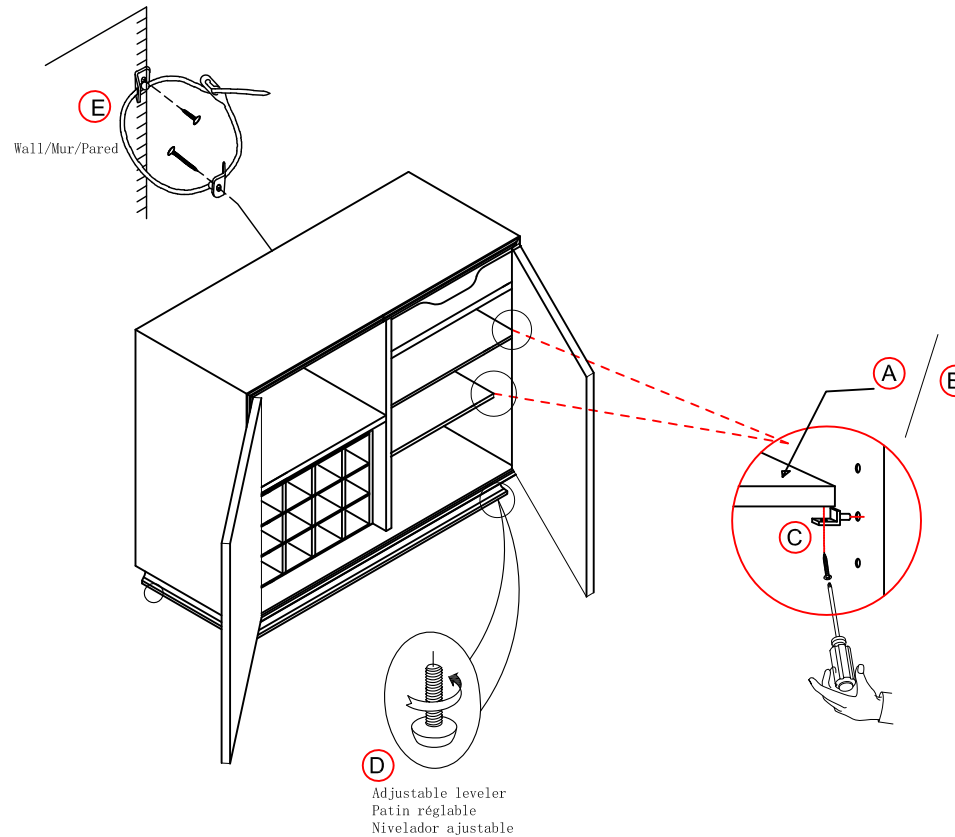

* Replaceable Part

REPLACEABLE PART/ PARTIE REMPLACABLE/ PARTE REEMPLAZABLE

ITEM NO. / ARTICLE NO. / ARTICULO NO : P301526

DESCRIPTION / LA DESCRIPCION / DESCRIPCIÓN : Bar/Cabinet-cellier /Mueble bar

REPLACEABLE PART/ PARTIE REMPLACABLE/ PARTE REEMPLAZABLE

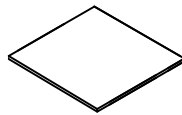

- (A) * RP301526-SHELFA**
 x1 Right top Adjustable Shelf A
 x1 Tablette ajustable
 x1 Estante ajustable

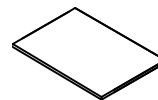

- (B) * RP301526-SHELFB**
 x1 Right bottom Adjustable Shelf B
 x1 Tablette ajustable
 x1 Estante ajustable

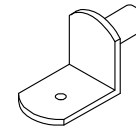

- (C) * RP301526-SUPP**
 x8 Shelf Supports
 x8 Supports Pour Tablette
 x8 Soporte De Las Repisas

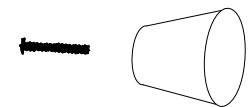

- RP301526-PULL**
 * x4 RP301526-PULL
 Pull with screw
 Tirer et vis
 Tira y Tornillo



- (D) * RP301526-LEVE**
 x4 Adjustable leveler
 x4 Patin réglable
 x4 Nivelador ajustable



- (E) * RC-ANTI-TIP**
 x1 Tipping restraint
 x1 Liste des pièces de quincaillerie antibasculement
 x1 Abrazadera antivuelco

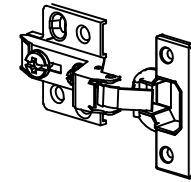

- * RP301526-HINGE**
 * x4 RP301526-HINGE
 Door Hinge
 Charnière de porte
 Bisagra de la puerta

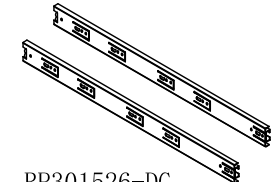

- RP301526-DG**
 * x1 Drawer Glide
 x1 Glissière
 x1 Carril de deslizamiento

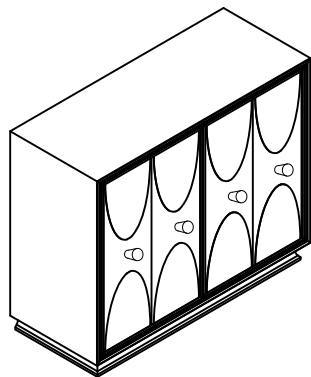

- * x4 RP301526-CATCH**
 Door Catch
 Catch de aimant
 Captura de imá'

* Replaceable Part