

Desk Chair Assembly Instructions

PARTS	QTY
SEAT ASSEMBLY	1
SEAT PLATE	1
5-STAR BASE	1
PNEUMATIC CYLINDER	1
TELESCOPIC LIFT COVER	1
ALLEN BOLT	4
ALLEN WRENCH	1
CASTERS	5

Remove all parts from carton and make sure part quantities are correct.

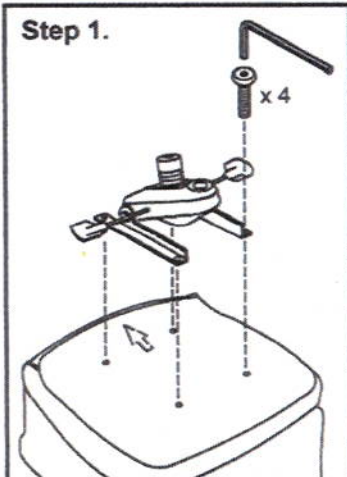

Attach Seat Plate to bottom of Seat Assembly by securing the Allen Bolts (4) with the Allen Wrench. FULLY TIGHTEN ALL BOLTS.

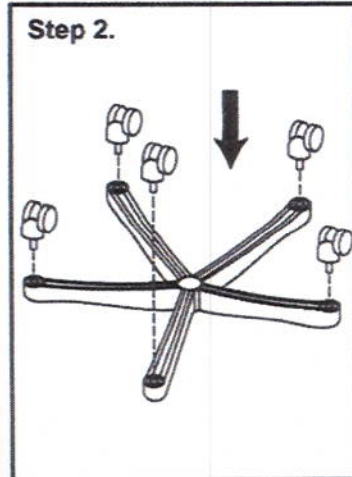

Insert Casters (5) to bottom of 5-Star Base. Be sure ALL Casters are inserted properly. Place base upright so that Casters are on the floor.

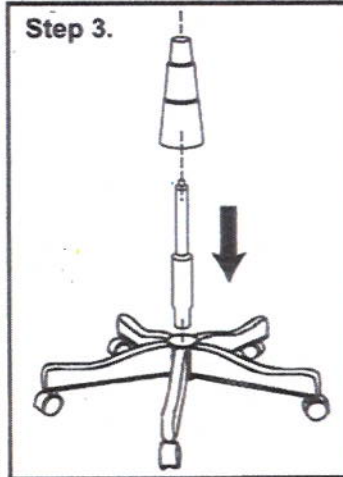

Insert Pneumatic Cylinder into 5-Star Base, applying pressure to lock it in place. Place Telescopic Lift Cover directly on Cylinder.

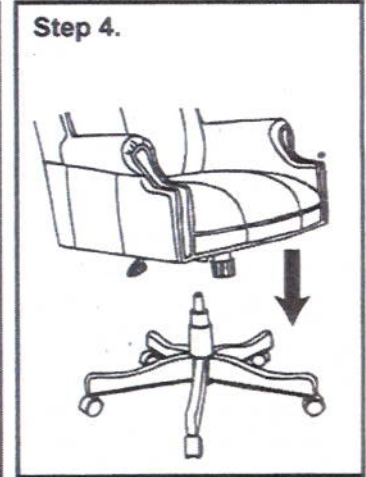

Place assembled seat on top of Pneumatic Cylinder. Apply AMPLE AMOUNT OF PRESSURE to ensure proper locking of Seat to Base.

ATTENTION: MAKE SURE ALL SCREWS ARE FULLY TIGHTENED BEFORE USING CHAIR.

WARNING!

- DO NOT STAND ON THIS CHAIR. THIS CHAIR IS DESIGNED FOR SITTING ONLY.
- DO NOT USE THIS CHAIR AS A STEP LADDER.
- Do not sit on arms of the chair as they are not constructed for this and tipping could occur.
- Applying excessive weight or pressure on arms of the chair can risk breakage as they are not constructed for this.
- Use this product for seating only one person at a time.
- Do not allow children to use this chair as a toy.
- Do not use this chair unless all bolts are firmly tightened. Check and retighten all bolts and parts every 3 months.
- If parts are missing, broken, damaged or worn, stop using until repairs are made, using only factory authorized parts.
- FAILURE TO FOLLOW THESE WARNINGS COULD RESULT IN SERIOUS INJURY.
- It is recommended to use a mat made especially for castered chairs on all flooring surfaces.

Recommended weight limit not to exceed 300 lbs