

ASSEMBLY INSTRUCTIONS

B677W-115 ANDOVER 6/ 6-6/ 0 EK/WK HEADBOARD, FOOTBOARD & SLATS-WHITE
 B677W-335 ANDOVER 5/ 0-6 /6 Q/EK SIDE RAILS-WHITE

&

B677B-115 ANDOVER 6/ 6-6/ 0 EK/WK HEADBOARD, FOOTBOARD & SLATS-NUTMEG
 B677B-335 ANDOVER 5/ 0-6 /6 Q/EK SIDE RAILS-NUTMEG

Thank you for purchasing this quality product. Be sure to check all packing materials carefully for small parts, which may have come loose inside the carton during shipment. Identify and count all items and compare with the parts list and/or hardware list shown below.

STEP 1

| PARTS LIST | | | |
|------------|---------|-----------------|-------|
| ITEM | DRAWING | DESCRIPTION | QTY |
| 1 | | HEAD BOARD | 1 PC |
| 2 | | FOOT BOARD | 1 PC |
| 3 | | HB LEG POST (L) | 1 PC |
| 4 | | HB LEG POST (R) | 1 PC |
| 5 | | SIDE RAILS | 2 PCS |
| 6 | | SLATS SUPPORT | 8 PCS |
| 7 | | WOODEN SLAT | 4 PCS |

| HARDWARD LIST | | | |
|---------------|---------|--------------------------------|-------|
| ITEM | DRAWING | DESCRIPTION | QTY |
| A | | JCBB (M8) 8 x 35MM (NYLOK) | 4 PCS |
| B | | Spring Washer M8 x22mm | 4 PCS |
| C | | Flat Washer M8 x 16 x 1.6mm | 4 PCS |
| D | | ALLEN KEY M5 5 x 35 x120MM | 1 PC |
| E | | C.S.K SCREW (M4) 4 x32mm | 8 PCS |

Screw Driver is not included

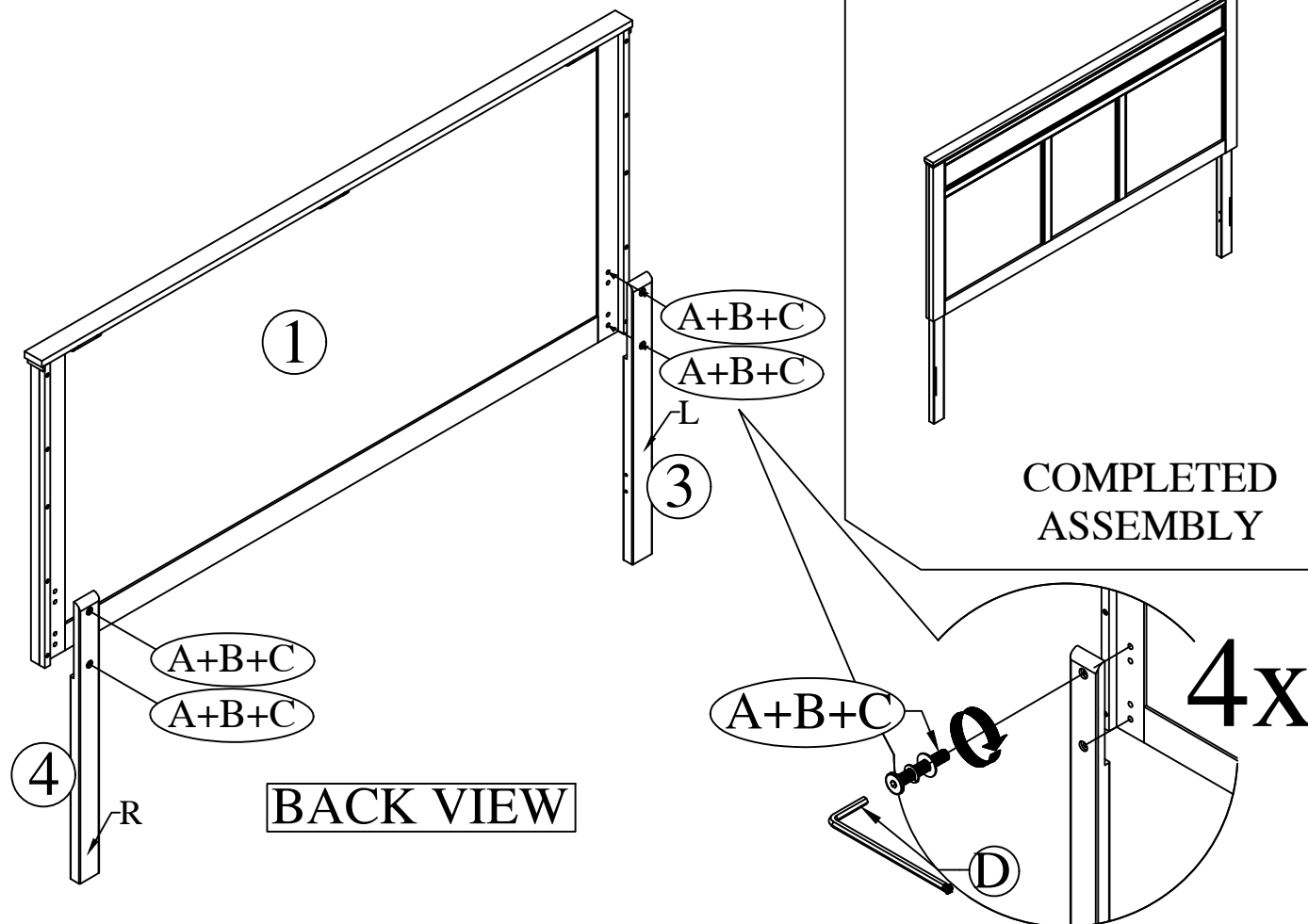
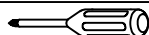

BACK VIEW

Step 1: Attach and tighten the leg posts (3 & 4) to the head board (1) by inserting JCBB bolt (A) with washers (B & C).

STEP 2

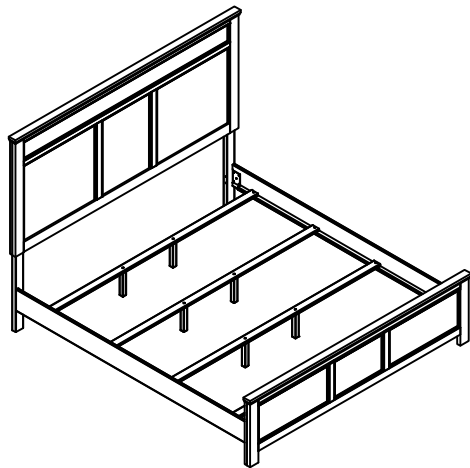
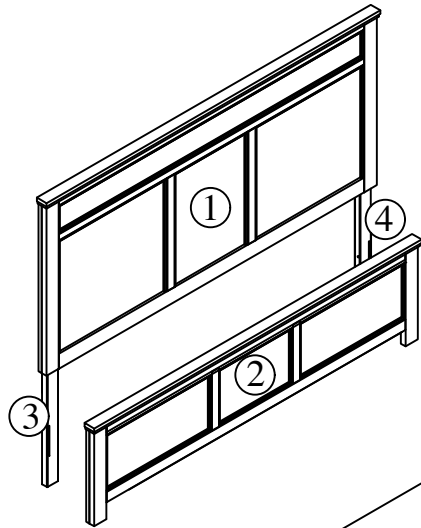

COMPLETED ASSEMBLY

STEP 3

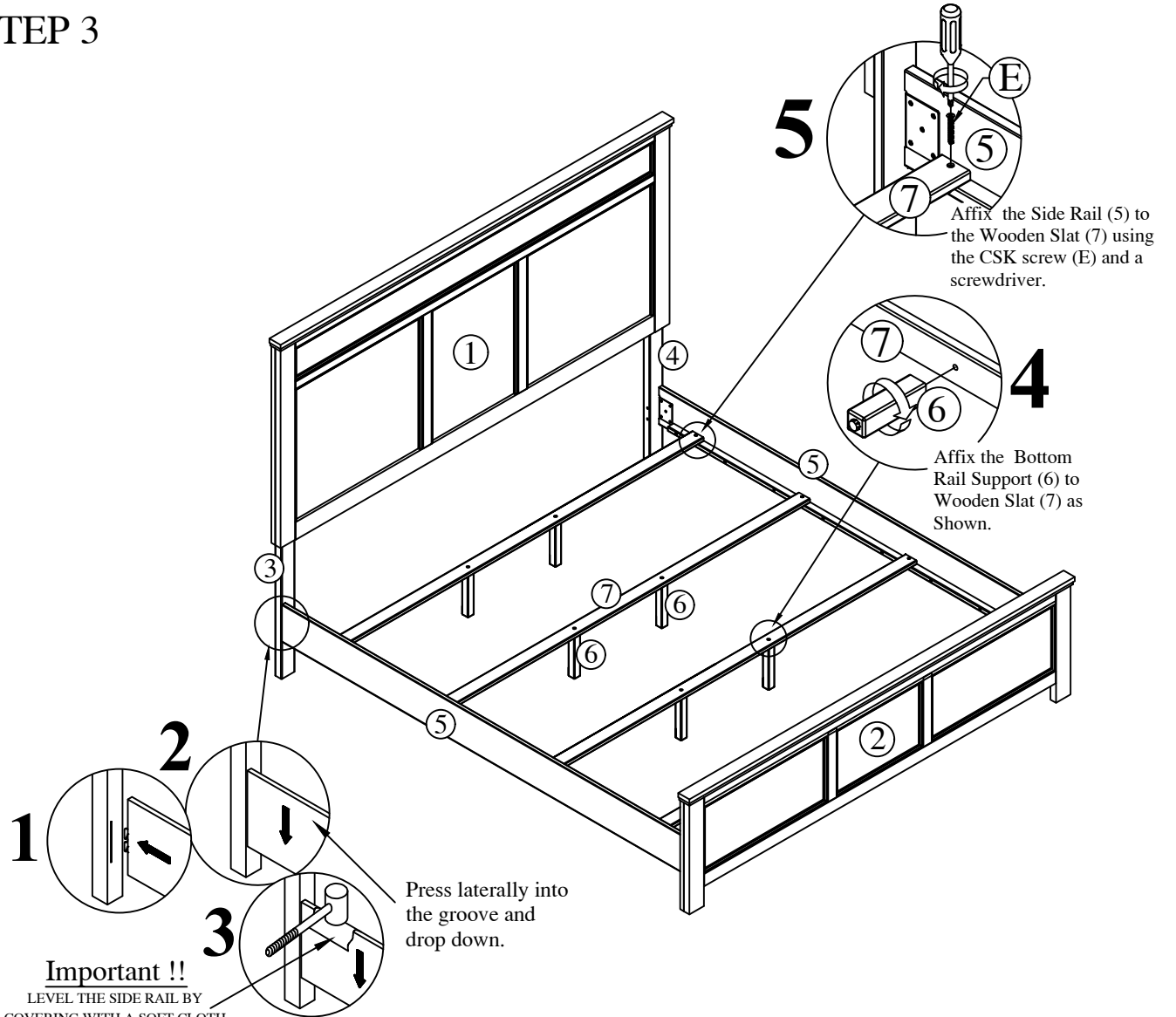

NOTE: MUST TIGHTEN SCREW PERIODICALLY. WITH USE SCREWS WILL BECOME LOOSE CHECK TIGHT OF ALL SREWS EVERY 6-8 WEEKS.