

# ASSEMBLY INSTRUCTIONS

390 / 392 / 393 / 394 / 395 / 399 - C

meridian.  
furniture

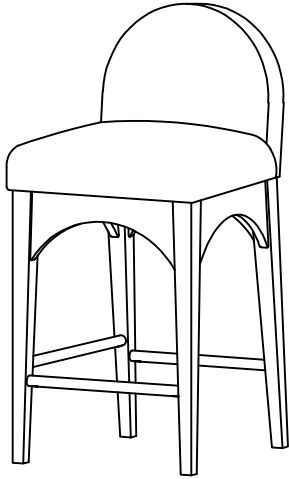

## +Parts Included

① Leg frame (1 pc)

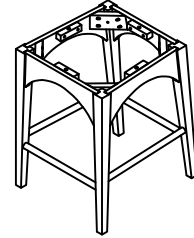

② Seat frame (1 pc)

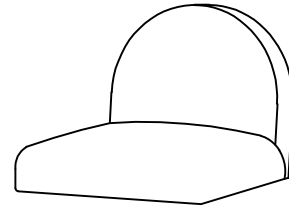

## +Do Not Use Power Tools



## +Suggested Adults

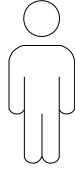

**NOTE:** For questions about parts or assembly please email [support@meridianfurnitureusa.com](mailto:support@meridianfurnitureusa.com) or call us at 718-758-4455.

- 1 Read instructions cover to cover.
- 2 Save all packaging until assembly is completed.

## 1 IMPORTANT SAFETY INFORMATION

- Do not** assemble the product if the parts arrived damaged.
- Do not** assemble if Hardware parts are missing.

## 2 IMPORTANT ASSEMBLY INFORMATION

Assembly Step If loosening persists, please make sure to tighten all the bolts periodically, or use a thread locker adhesive.

## +Parts Included

A. Bolt  
Ø8x45mm (4 pcs)

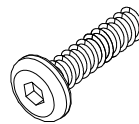

B. Spring Washer  
Ø8xØ13mm (4 pcs)



C. Flat Washer  
Ø8xØ19mm (4 pcs)

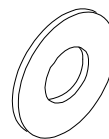

D. Allen Key (1 pc)

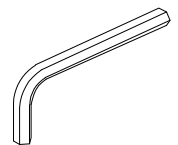

# ASSEMBLY INSTRUCTIONS

meridian.  
furniture

390 / 392 / 393 / 394 / 395 / 399 - C

①

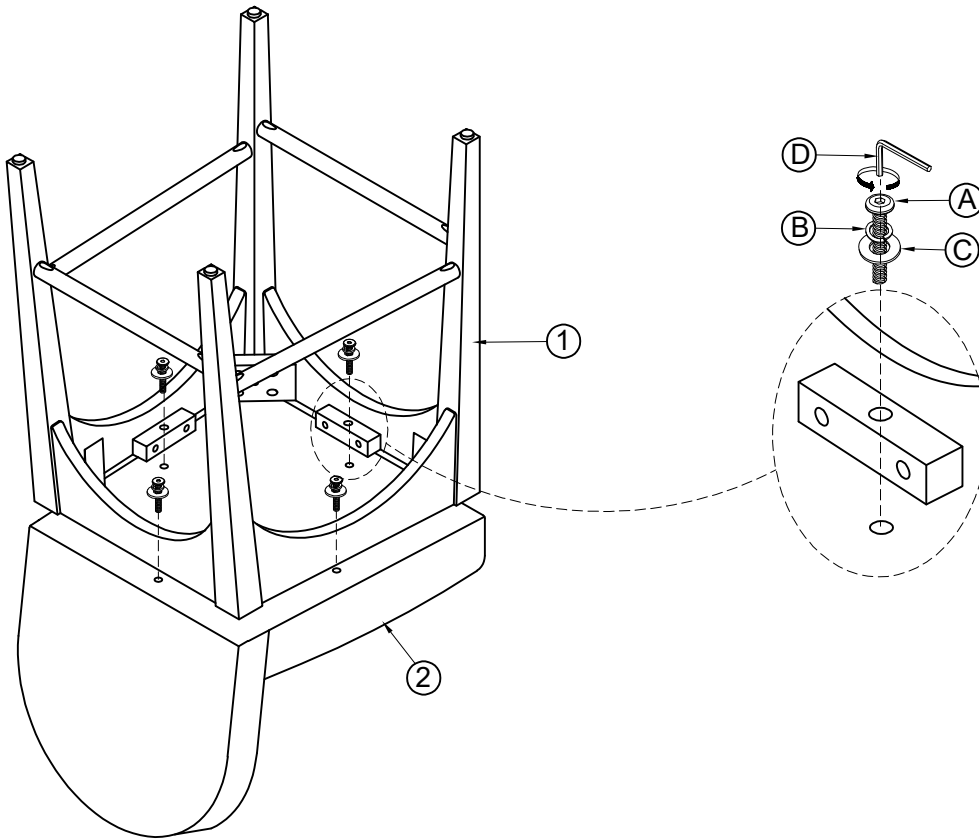

②

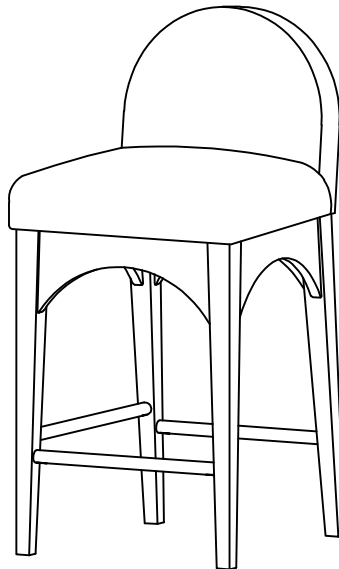

NOTE: For questions about parts or assembly please email [support@meridianfurnitureusa.com](mailto:support@meridianfurnitureusa.com) or call us at 718-758-4455.  
[www.MeridianFurnitureUSA.com](http://www.MeridianFurnitureUSA.com) | [support@meridianfurnitureusa.com](mailto:support@meridianfurnitureusa.com)