

ASSEMBLY INSTRUCTION

ITEM NO.:89116-A /89117-A

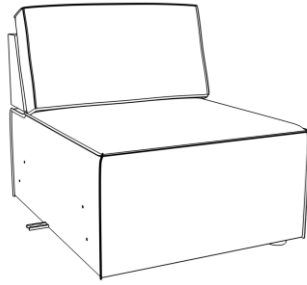

PARTS LIST



A

x1

B

x1

D

Leg

x4

Open up Velcro of Non-Woven Fabric cover on the bottom of the seat frame to remove Legs

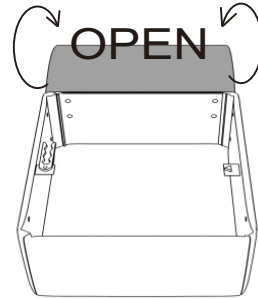

Step1

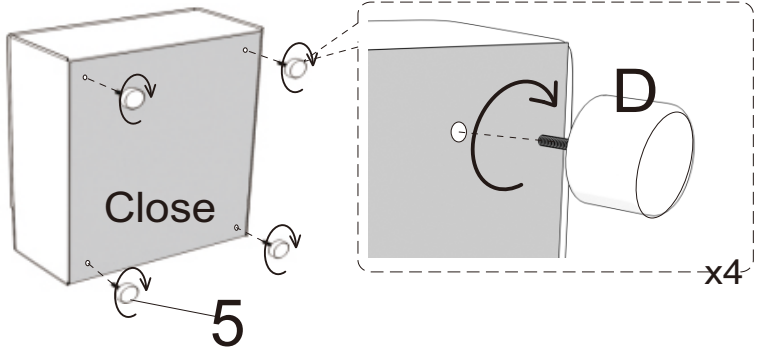
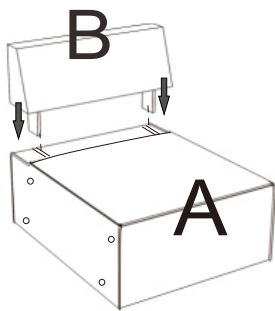

Step2

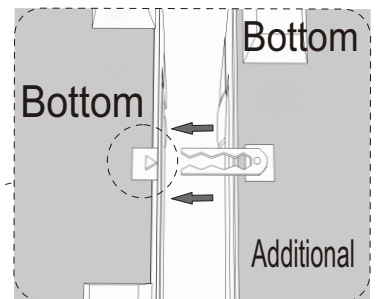
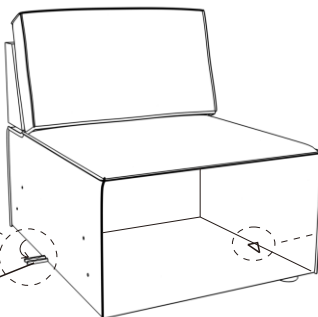
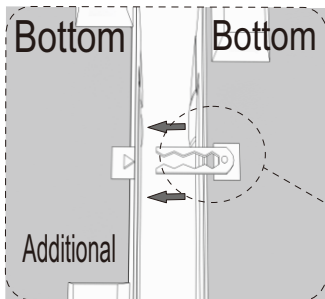

Latch the bottom connector

Please note that **89116- ARM / 89117- ARM** and **89116-A / 89117-A** can be assembled on the left or on the right.
 Assemble **(89116-A / 89117-A) LEFT ARM** and **(89116-A / 89117-A) RIGHT ARM** according to the serial numbers of the products purchased.

(89116-A / 89117-A) LEFT ARM

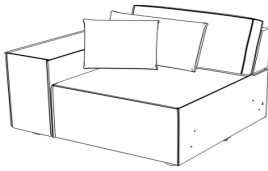

(89116-A/ 89117-A) RIGHT ARM

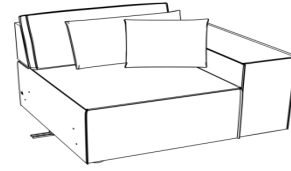

PARTS LIST

BOX: 89116-A/89117-A

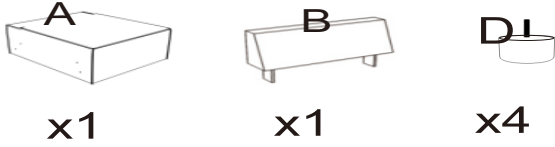

BOX: 89116-ARM / 89117-ARM

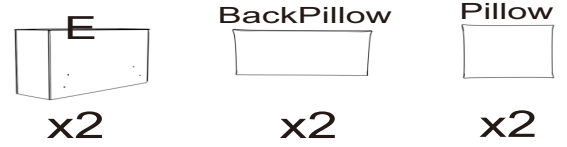

HARDWARE LIST INSIDE BOX-89116-ARM/89117-ARM

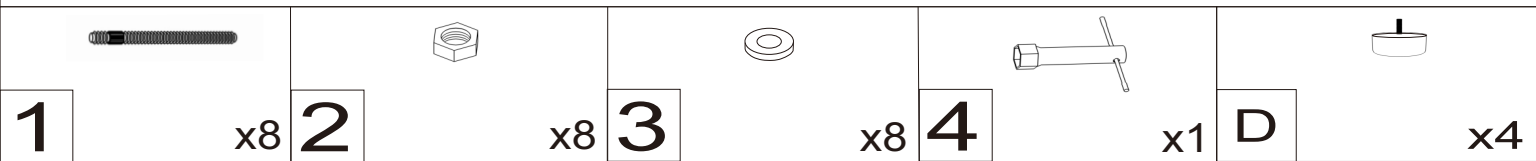

LEFT ASSEMBLY INSTRUCTION

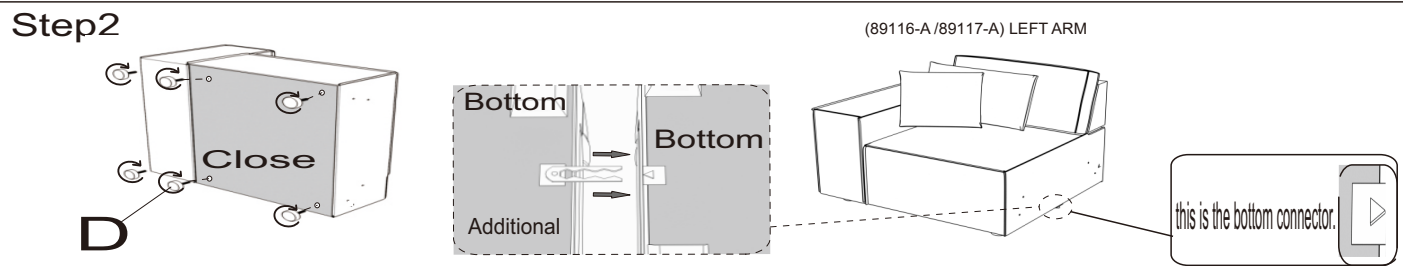
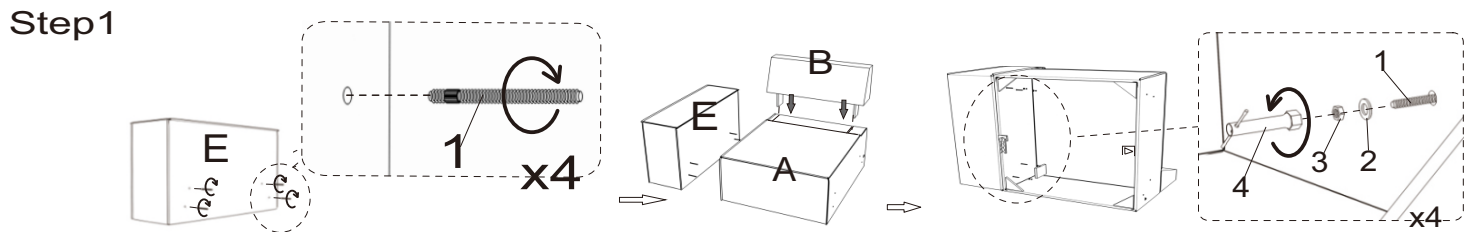

RIGHT ASSEMBLY INSTRUCTION

