

ASSEMBLY INSTRUCTION

ITEM NO.: 87802

Please choose the **CHAISE** will be on the **LEFT** or **RIGHT** hand side

CHAISE ON THE RIGHT

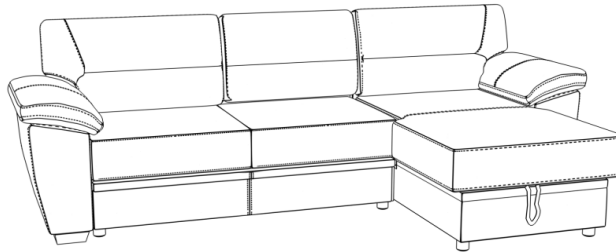

PARTS LIST

BOX-1

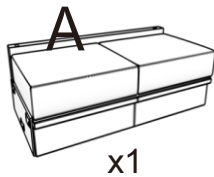

BOX-2

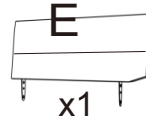
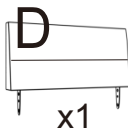
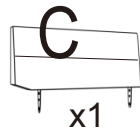
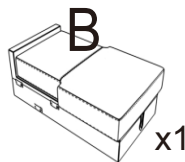

BOX-3

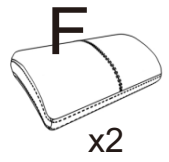
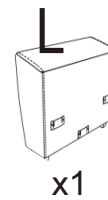

1

x8



2

x4



3

x1



4

x6



5

x12

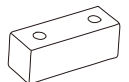

6

x6

BEFORE ASSEMBLY

Open up **(BOX-1)** **(BOX-2)** **(BOX-3)** Velcro of Non-Woven Fabric cover on the bottom of the seat frame to remove **back cushions**, **arms cushions**, **hardwares** and **legs**.

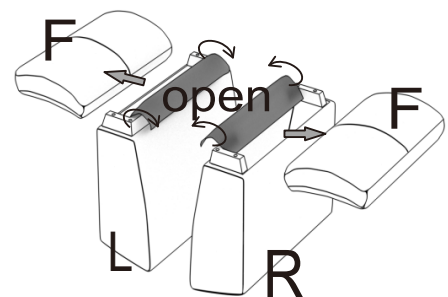
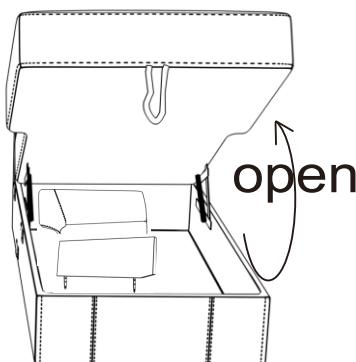
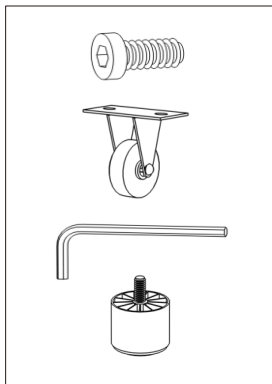

Please check all components before assembly ,Thanks.

CHAISE ON THE RIGHT

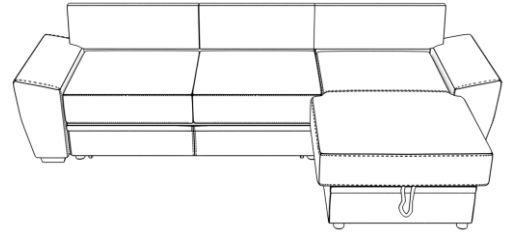
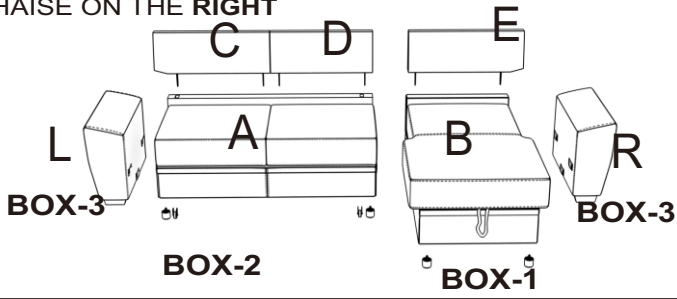

ASSEMBLY INSTRUCTION

Step1

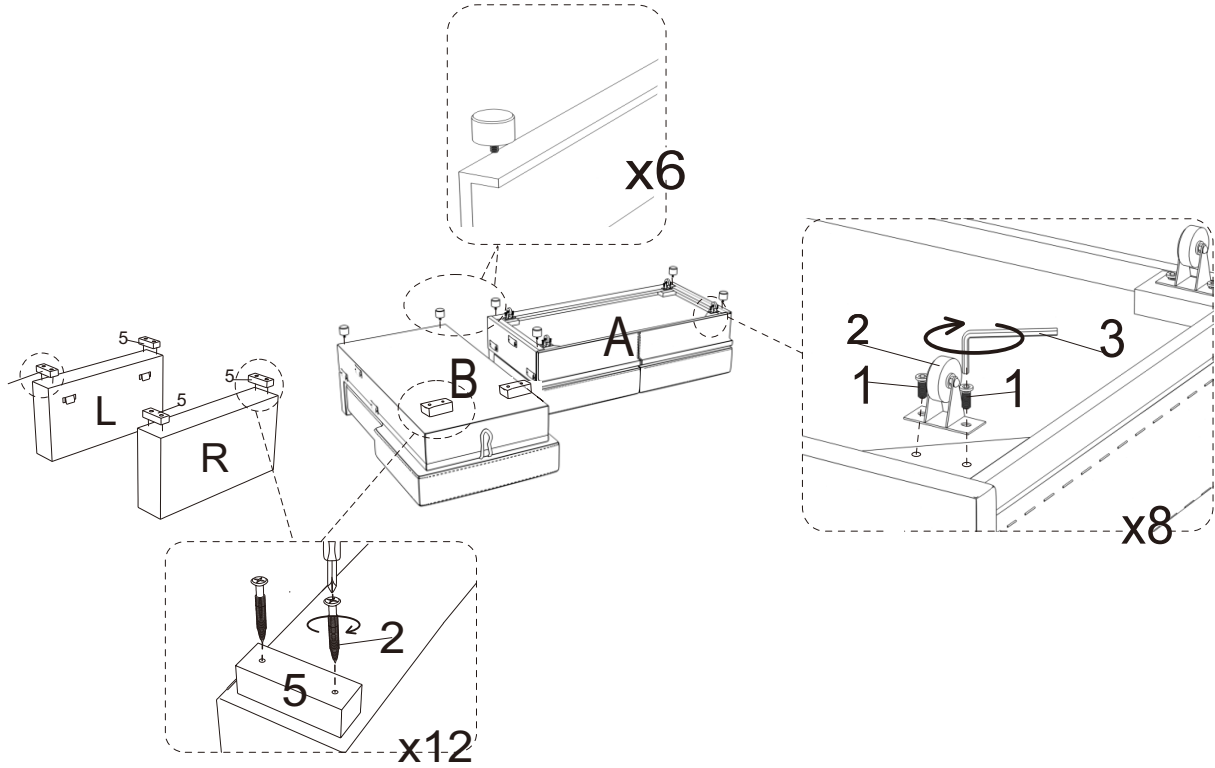

Step2

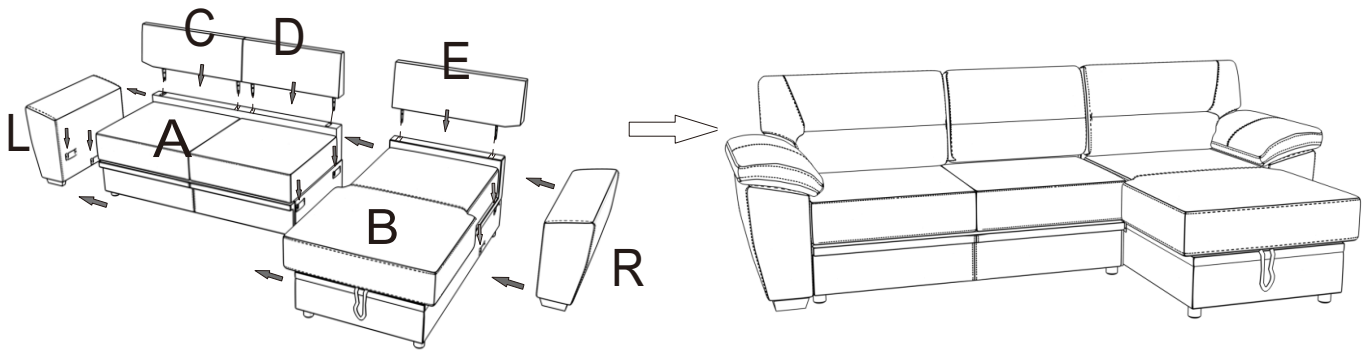

Step3

