



furnishing better
lives together

WWW.JOFRAN.COM

ASSEMBLY INSTRUCTIONS & PARTS IDENTIFICATION MODEL # 2271-WESBLBLK WES BACKLESS STOOL BLACK

Thank you for purchasing this quality product. Be sure to check all packing material carefully for small parts that may have come loose inside the carton during shipment.

Hardware kit (WESBLBLKP46)			
No	Description		Q'Ty
A		Lock Washer Ø6.2	8 pcs
B		Flat Washer Ø6.2	8 pcs
C		Bolt Ø6.3x0.794x50mm(L)	8 pcs
D		Allen Key	1 pc
E		Screw Ø4 x 35mm	8pcs

Key Parts			
No	Code	Description	Q'ty
1	WESBLBLKP41	Complete Seat	1 pc
2	WESBLBLKP42	Right Leg	2 pcs
3	WESBLBLKP43	Left Leg	2 pcs
4	WESBLBLKP44	Side Stretcher	2 pcs
5	WESBLBLKP49	Front, Behind Stretcher	2 pcs
6	WESBP01F	Floor glide	4 pcs

STEP 1

- Carefully lay Complete Seat flat on a smooth flat surface to prevent scratches.
- Attach Complete Seat to Right Leg by inserting a Flat Washer (B), Lock Washer (A) with Bolt (C) into each of the hole on the back rail of the Complete Seat corners. (See Detail A).
- Do not fully Tighten bolts with provided Allen Key (D) by turning clockwise.

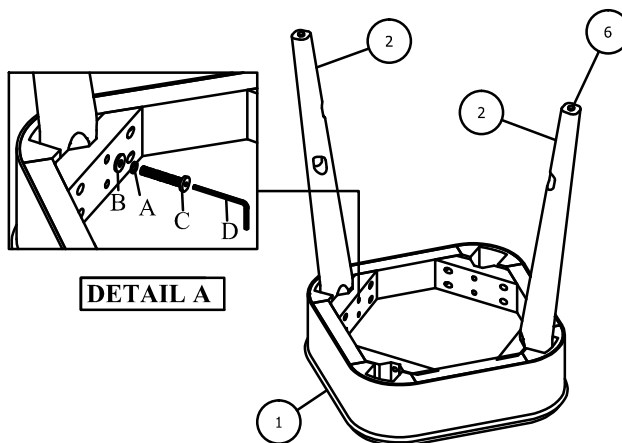

DETAIL A

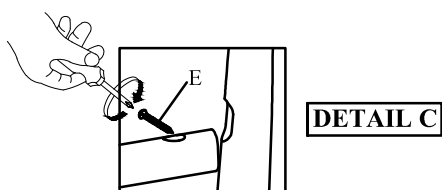

DETAIL C

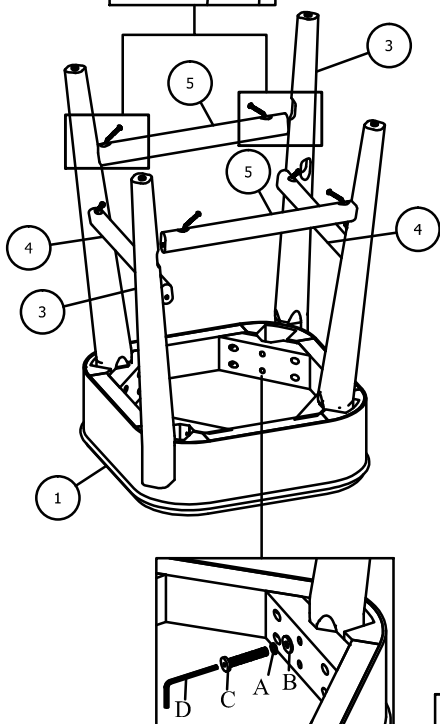

DETAIL B

STEP 2

- Insert the Side Stretcher into the Right Leg.
- Insert the Front, Behind Stretcher into the Left Leg.
- Attach Left Leg to Complete Seat by inserting a Flat Washer (B), Lock Washer (A) with Bolt (C) into each of the hole on the back rail of the Complete Seat corners. (See Detail B).
- Tighten bolts with provided Allen Key (D) by turning clockwise until secure
- Fasten stretchers with Wood Screws (E) by hand using a Phillips screwdriver (not provided) (See Detail C)
- Be sure to tighten all screws and nuts prior to using Chair.

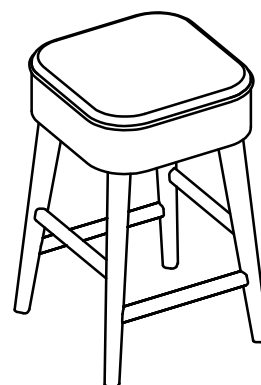

MADE IN VIETNAM