

Parts key				Hardware kit #1851-60P01			
No	Code	Qty	Description	No	Description		Qty
1	1851-60P24	1 pc	Table Top	A	Hex nut M8		4 pcs
2	1851-60P07	2 pcs	Sliding Door	B	Lock washer	Ø8	28 pcs
3	1851P04	2 pcs	Pull w/Screws	C	Flat washer	Ø8 x 16mm	28 pcs
4	1851P07S	4 sets	Sliding Wheel & Lock w/Screws - 2 pcs	D	Long bolt-Attaching Leg Extension	5/6" x 180mm	8 pcs
5	1851-60P08T	1 pc	Storage Box Top Panel	E	Medium bolt Attaching Leg	M6 x 60mm	8 pcs
6	1851-60P08L	1 pc	Left Storage Box Shelf	F	Short bolt Attaching Top/Bottom Panel	M6 x 30mm	8 pcs
7	1851-60P08R	1 pc	Right Storage Box Shelf	G	Allen key	K4	1 pc
8	1851-60P08B	1 pc	Storage Box Bottom Panel	H	Key wrench	13	1 pc
9	1851-60P02L	2 pcs	Left Facing Leg	I	Wooden Screw	Ø4 x 25mm	10 pcs
10	1851-60P02R	2 pcs	Right Facing Leg	J	Wooden Dowel	Ø10 x 20mm	4 pcs
11	1851-60P02E	4 pcs	Extensions Leg				
12	1851-60P08S	2 pcs	Storage Box Side Panel				
13	1851-60P08V	1 pc	Storage Box Vertical Panel				
14	1851-60P13	2 sets	Extension Mechanism				
15	1851-60P13L	4 sets	Extension Lock				
16	1851P01F	4 pcs	Floor Glide				
17	1851-60P36	1 pc	Leaf Support				

### Step 2

Attach the Bottom Panel to the Vertical Panel with a Short Bolt (F), a Lock Washer (B) and a Flat Washer (C) using the Allen key provided.

Slide the Side Panels into the grooves on the Top and Bottom Panels as show in the diagram.

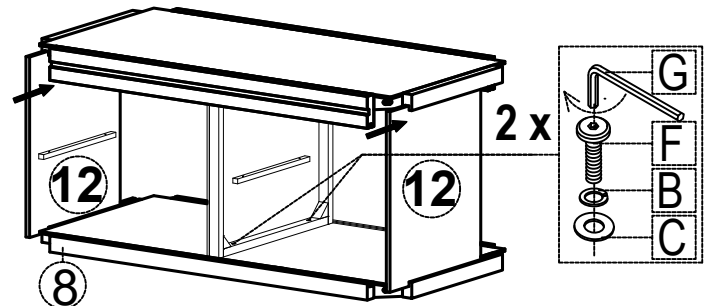

### Step 1

Lay the top of the Storage Box upside down on a clean padded surface to prevent scratching. Insert the Wood Dowels (J) into the Vertical Panel ends.

Attach the Storage Box Vertical Panel to the Top Panel with a Short Bolt (F), a Lock Washer (B) and a Flat Washer (C) using the Allen key provided.

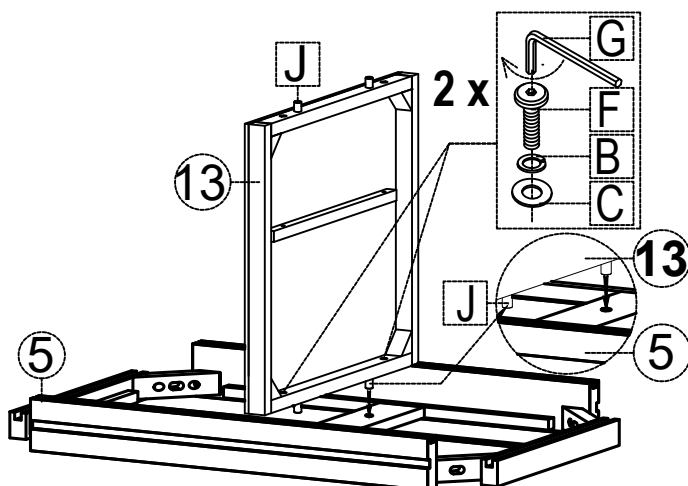

### Step 3

Carefully lay the Shelf Unit on the side and attach a Right Side Leg and a Left Side Leg to the top corners using a Bolt (E), a Lock Washer (B) and a flat Washer (C).

Note that the groove in the leg will be on the inside of the unit. Repeat for the other side. Make sure all bolts are securely tightened.

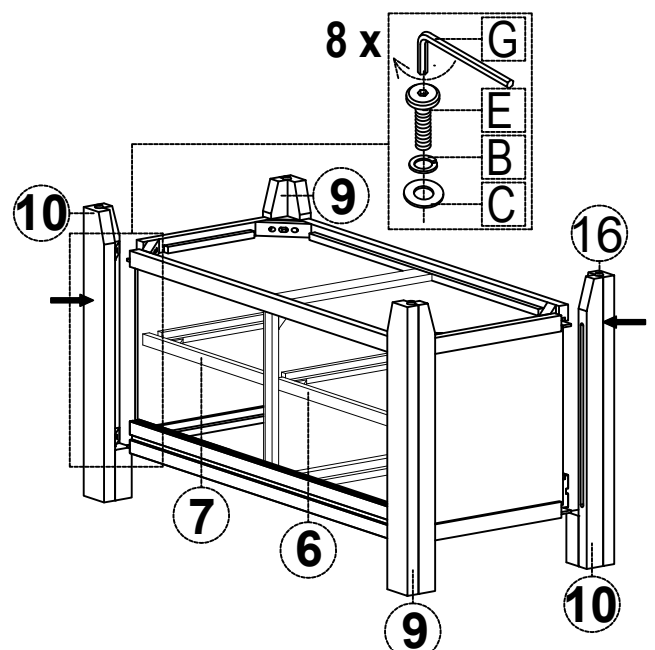

**Step 4**

Attach the shelves into place with the wood screws (I). Note there are two different size shelves.

**Step 5**

Place the Table Base upright and position the doors in place. Note that the rollers go into the base track and the guide pins lock into the top track.

Attach the Leg Extensions (for counter height table) using the Long Bolt (D), Lock Washer (B) and Flat Washer (C).

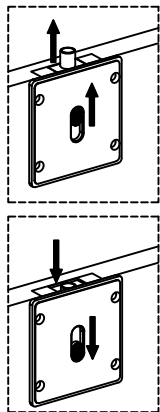

TO REACTIVATE DOOR PIN, PRESS THE BUTTON WHEN IN THE BOTTOM POSITION

TO RELEASE DOOR PIN, MOVE THE BUTTON TO THE BOTTOM POSITION

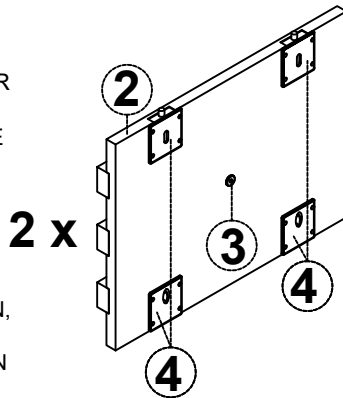

2 x

8 x

8 x

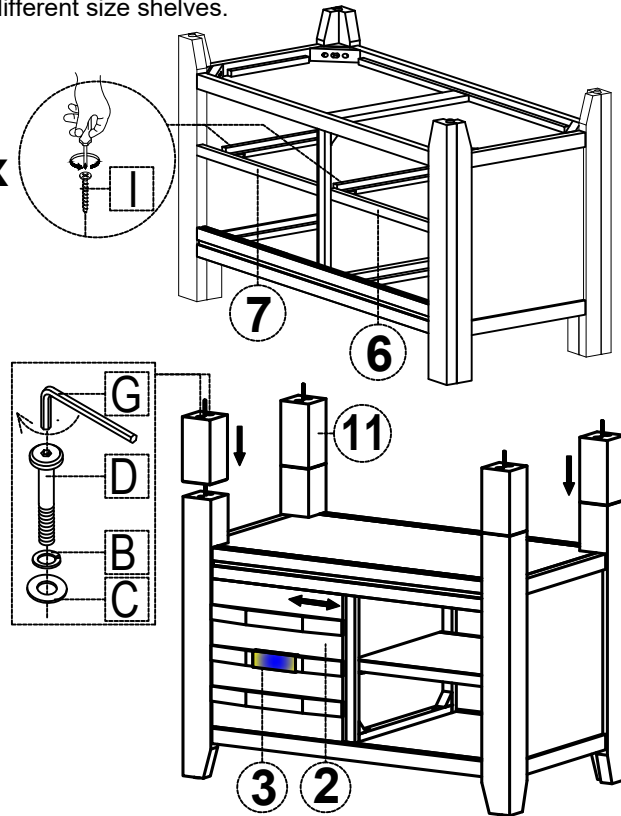

**Step 6**

Attach the Leaf Support to the Extension Mechanism using two Wood Screws (I) into the predrilled holes in the Extension Mechanism.

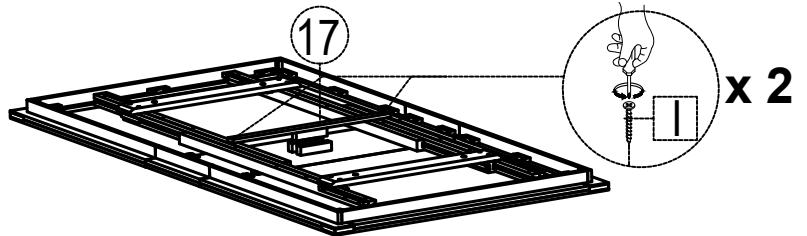
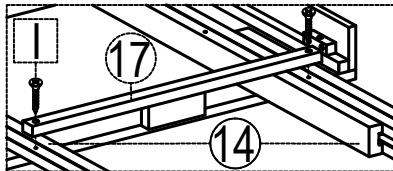

**Step 7**

Place the table top on top of the legs and attach with a Flat Washer (C), Lock Washer (B) and a nut (A). Tighten with the wrench (H) provided.

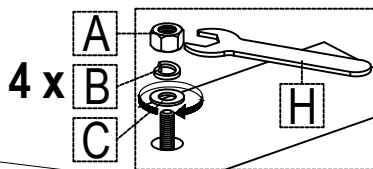

4 x

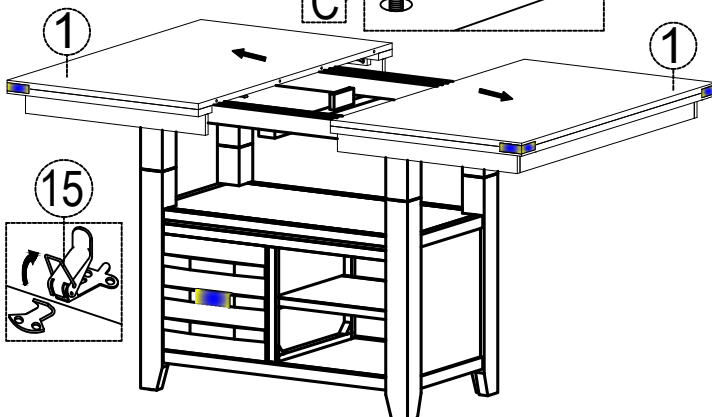

**FINISH**

