

Thank you for purchasing this quality product. Be sure to check all packing material carefully for small parts that may have come loose inside the carton during shipment.

Parts key							
No	Code	Qty	Description	No	Code	Qty	Description
1	1702B-10P07L	1 pc	Left Facing Wood Door	8	1702B-10P08L	1 pc	Left Shelf
2	1702B-10P07R	1 pc	Right Facing Wood Door	9	1702B-10P08R	1 pc	Right Shelf
3	1702B-10P04L	2 sets	Pull w/Screws for Door	10	1702BP08P	8 pcs	Shelf Pin </td
4	1702B-10P05T	3 pcs	Top Drawer Complete	11	1702BP01F	4 pcs	Floor glide
5	1702B-10P05B	3 pcs	Bottom Drawer Complete	12	1702BP01L	1 pc	Floor leveler
6	1702B-10P04S	3 sets	Pull w/Screws for Drawer	13	1702BP01AT	1 set	Anti - tip kit
7	1702BP06	6 sets	Full Extension glide				

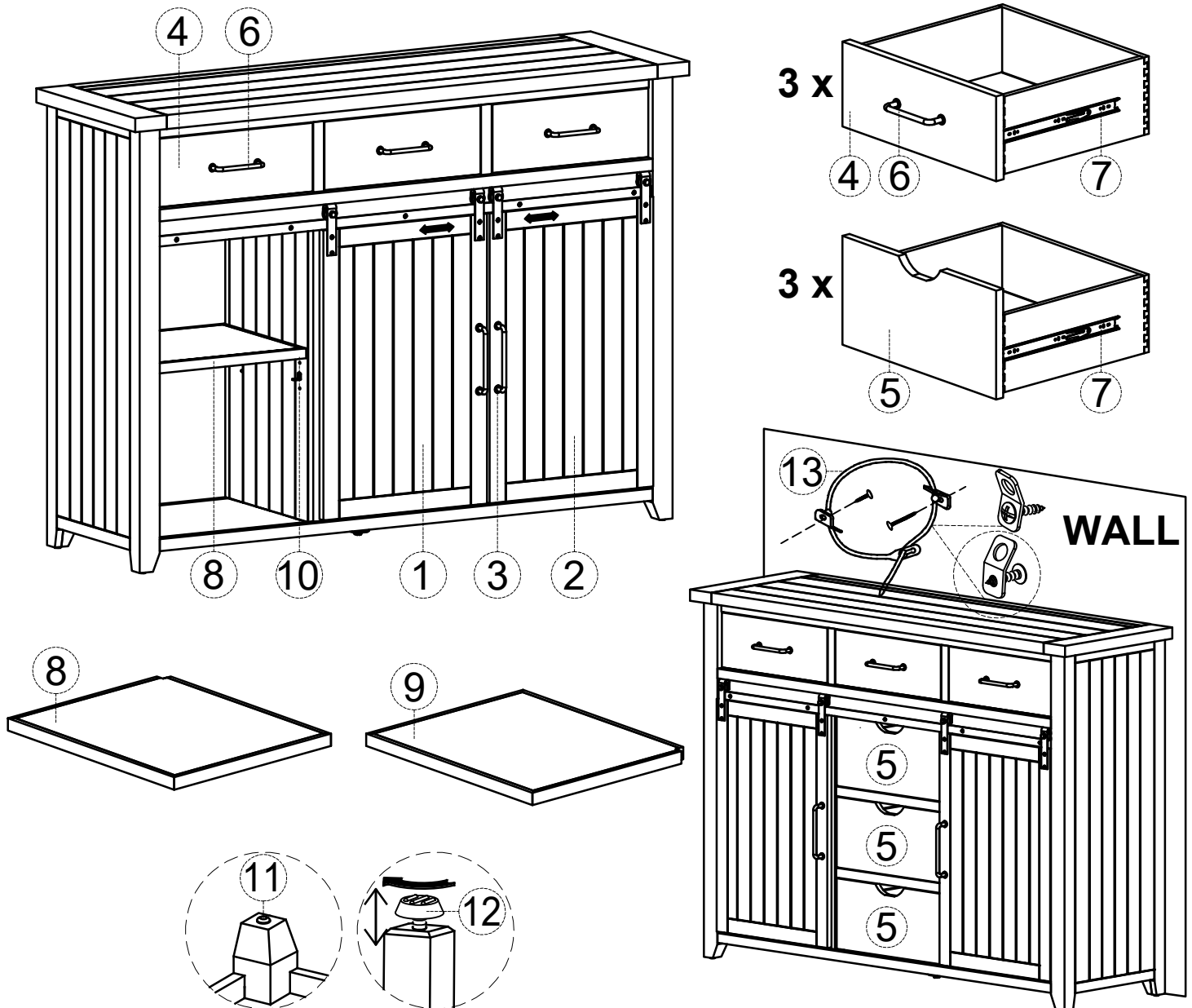

PLEASE NOTE : To help prevent the possibility of tip-over, install the ANTI-TIP OVER restraint provided.