

ASSEMBLY INSTRUCTIONS

**MODEL : 0295A
DRESSER**

**(BOX 1)
BOX OF DRESSER**

NO	ITEM	QTY
A	DRESSER	1 pc
B	BUN FOOT	4 pcs
C	BOTTOM SUPPORT LEG	1 pc

**(BOX 1)
HARDWARE LIST**

NO	ITEM	QTY
1	JCBC M6 x 50mm	4 pcs
2	Spring Washer 1/4" Rbw	4 pcs
3	Flat Washer 1/4"ID x 19mmOD Bk	4 pcs
4	ALLEN KEY m4x65mm Bk	1 pc

STEP 1 : Pull the drawer and take out the Bunfoot carton (B). Attach the Bunfoot (B) at the bottom Night Stand (A) used JCBC (1) with Spring Washer (2) Flat Washer (3) and tighten with Allen Wrench (4).

Hardware Pack

Remove Center Leg

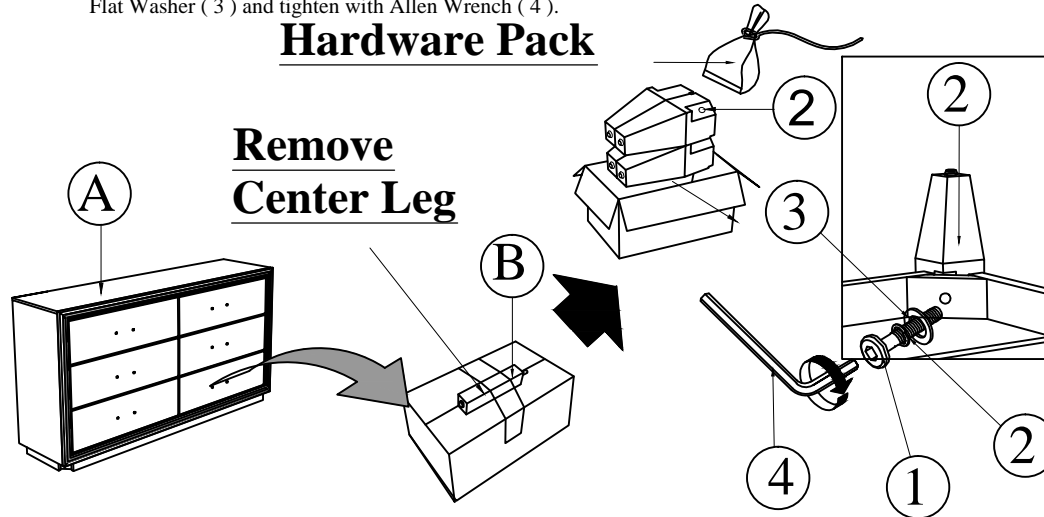

Leveler Adjuster Remark : Turn the Dresser to upright position as shown.

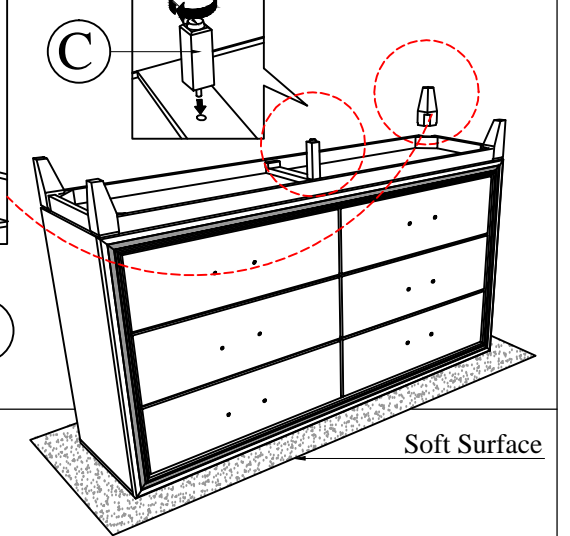

STEP 2 :

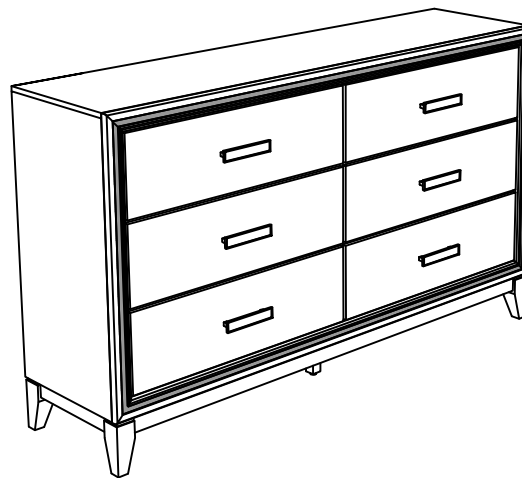

COMPLETED ASSEMBLY

Step 2.1

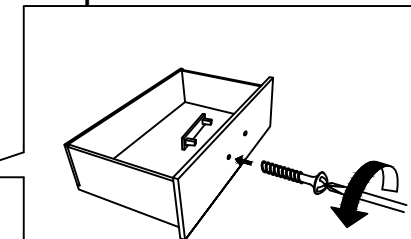

Step 2.2

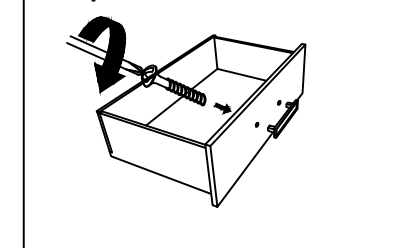

NOTE : MUST TIGHTEN SCREWS PERIODICALLY WITH USE SCREW WILL BECOME LOOSE CHECK TIGHTNESS OF ALL SCREW EVERY 6-8 WEEKS.