

# ASSEMBLY INSTRUCTIONS

MODEL #

**CM3216PC-2PK**

## Questions?

GIVE US CALL: 1-888-980-5122  
MON-FRI 8:30AM - 5:30PM (PST)

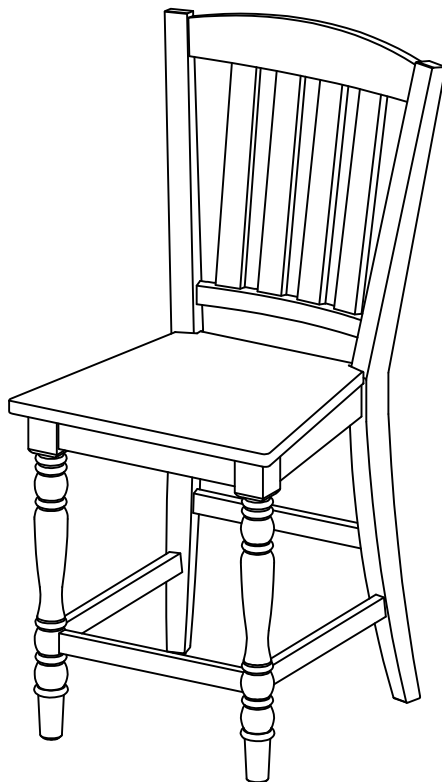

## TOOLS REQUIRED

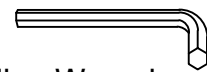

Allen Wrench

(Included)

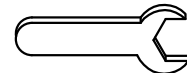

Wrench

(Included)



Phillips  
Screwdriver

(Not Included)



2 - People  
Recommended

## ASSEMBLY RATING



EASY → DIFFICULT

The Assembly Rating is a 5-point system showing the level of effort needed to assemble a specific product.



FOA Intro

Thank you for your purchase!

We hope you enjoy this new addition to your home for many years to come.

Our commitment to providing quality products does not simply end when you purchase our product. We fully stand behind our products from start to finish. Our customer service department is available Monday – Friday 8:30 AM – 5:30 PM Pacific and can help with assembly questions as well as, if necessary, replacing damaged or missing parts. To help expedite our service, please have these assembly instructions readily available, along with your order receipt.

 **Consumer Hotline**  
Toll-Free 1-888-980-5122

 **WEBSITE**  
[www.foagroup.com](http://www.foagroup.com)

    foagroup

 **Monday to Friday**  
8:30AM- 5:30PM (PST)

 **E-MAIL**  
[cs.ec@foagroup.com](mailto:cs.ec@foagroup.com)

 FurnitureOfAmerica

---

## CHECK BEFORE STARTING

**Are you missing anything?**

Double-check all parts, hardware and accessories listed on Page 6 are accounted for.

**Should we send any replacements?**

Are there any irregularities or flaws in the parts? We can send replacements!

**Check out our Quick Tips!**

We recommend reviewing the pre-assembly handouts. Even experts need a refresher now and then!

**Prep Time!**

Please review the assembly instructions and all diagrams prior to assembling. Arrange parts as recommended on Page 7 and group identical hardware together to make assembling easier.

# PRE ASSEMBLY INTRODUCTION

We understand building ready-to-assemble furniture can be a challenging experience for some. To help avoid confusion, we have provided some helpful tips that may speed up the process.

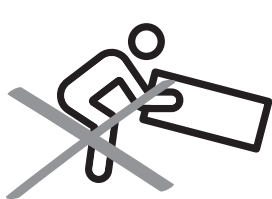

## Teamwork

ALWAYS have at least two people to help with transporting and assembling the product to avoid potential injury and/or damage.

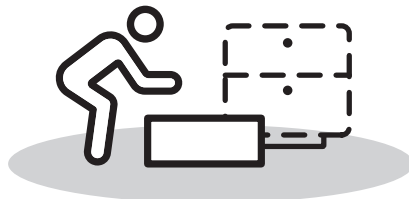
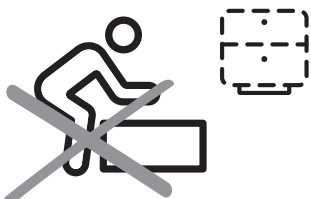

## Suitable Location

Assembling near the area of the intended location is highly recommended.



## Sufficient Space

Make sure you have enough space to move around during the assembly.

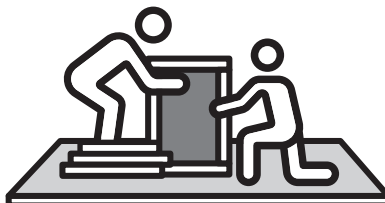

## Avoid Scratches

Use cardboard, blankets or a carpeted area while assembling furniture to prevent scratches.

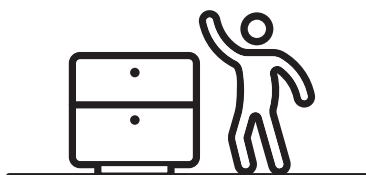
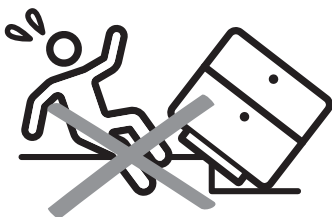

## Flat Surface

Make sure the furniture rests on a flat and level surface with each leg evenly touching the floor.

# ASSEMBLY AND CARE ADVICE



**FAILURE TO FOLLOW THE GUIDELINES BELOW MAY RESULT IN INJURY AND/OR PROPERTY DAMAGE.**



Position each part correctly and insert screws or bolts into their respective holes.

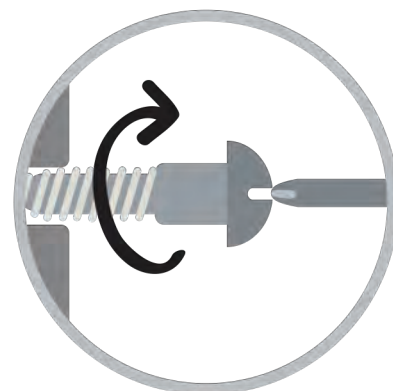

Turn clockwise to tighten and only tighten when step is completed or when instructed to do so.



Use the appropriate hand tools or power tools for assembly. Select steps, such as tightening screws and/or bolts, may require hand tools to avoid causing damage during assembly.



Save the instructions and store any supplied tools for later maintenance.

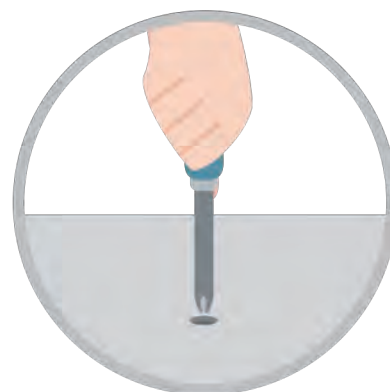

After two weeks, check and tighten any loose hardware and repeat again every six months thereafter.

**IT IS THE USER'S RESPONSIBILITY TO MAINTAIN THE FURNITURE. THE HARDWARE MAY LOOSEN OVER TIME AND MAY CAUSE THE FURNITURE TO BE WOBBLY AND UNABLE TO SUPPORT ITS INTENDED WEIGHT CAPACITY. THIS MAY LEAD TO COLLAPSE AND MAY CAUSE SERIOUS INJURY.**

# COUNTER HT. CHAIR

CM3216PC-2PK

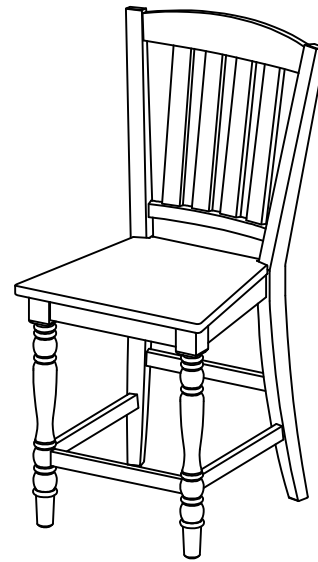
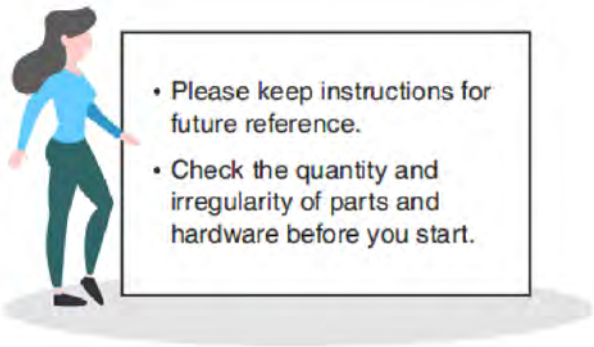

## PARTS

#1 1pc x2

#2 1pc x2

#3 2pcs x2

#4 1pc x2

#5 2pcs x2

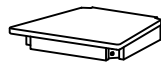

Chair Back

Cushion Seat

Front Leg (L/R)

Front Stretcher

Side stretcher (L/R)

## HARDWARE

#A 3pcs x2

#B 4pcs x2

#C 7pcs x2

#D 7pcs x2



Bolt Ø1/4" x 1-1/2"

Bolt Ø1/4" x 3-1/4"

Lock Washer  
Ø1/4"x13mm

Flat Washer  
Ø1/4"x19mm

#E 1pc x2

#F 4pcs x2

#G 4pcs x2

#H 4pcs x2



Allen Wrench M4

Hex Nut (Ø5/16")

Lock Washer  
Ø5/16"x13mm

Flat Washer  
Ø5/16"x19mm

#I 1pc x2

#K 6pcs x2

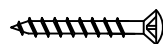
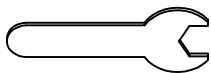

Wrench

Screw #8x40mm

# Exploded View

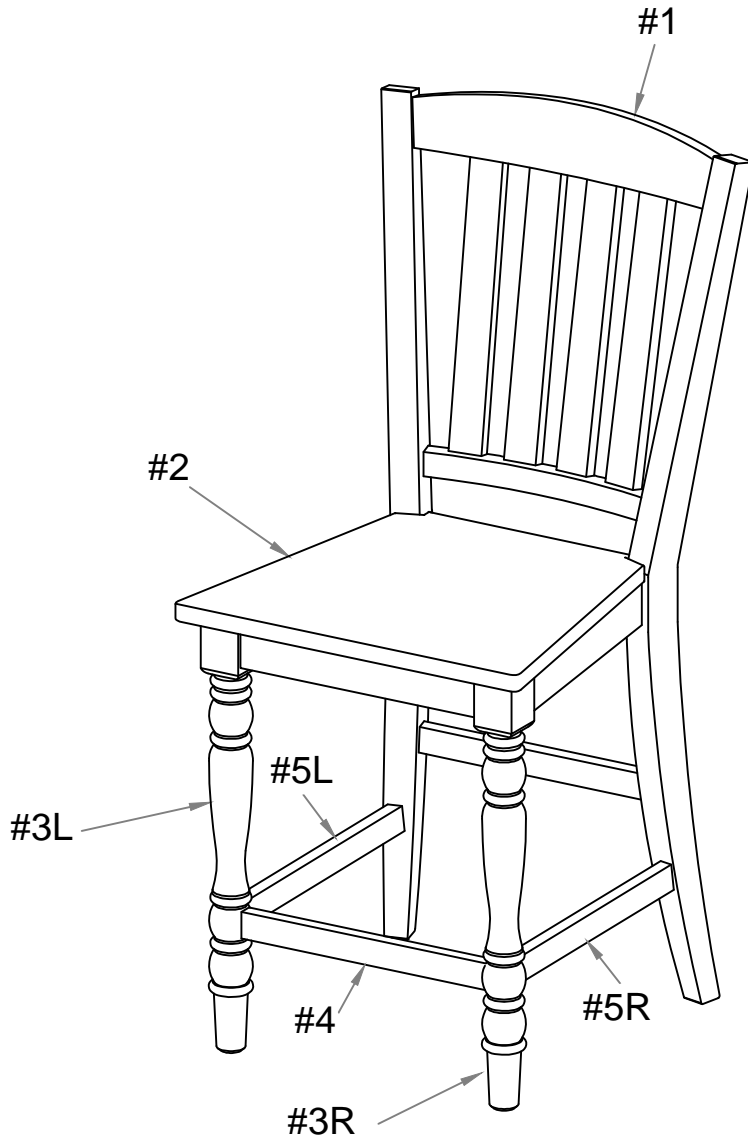

**x 2**

# ASSEMBLY INSTRUCTIONS

## 1

- Part #1 x1pc
- Part #2 x1pc
- Hardware #A x3pcs
- Hardware #C x3pcs
- Hardware #D x3pcs

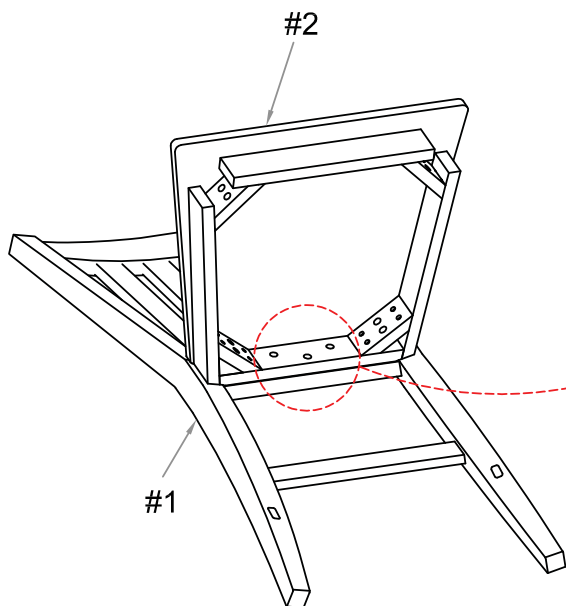

1. Prepare 3 bolt assemblies by first inserting a lock washer (#D) onto the bolt (#A) then a flat washer (#C) onto that same bolt (#A).

2. Place the backrest (#1) onto a protected surface, then align the seat (#2). Insert the bolt assemblies into the center holes and secure using the Allen wrench (#E).

## 2

- Hardware #B x4pcs
- Hardware #C x4pcs
- Hardware #D x4pcs

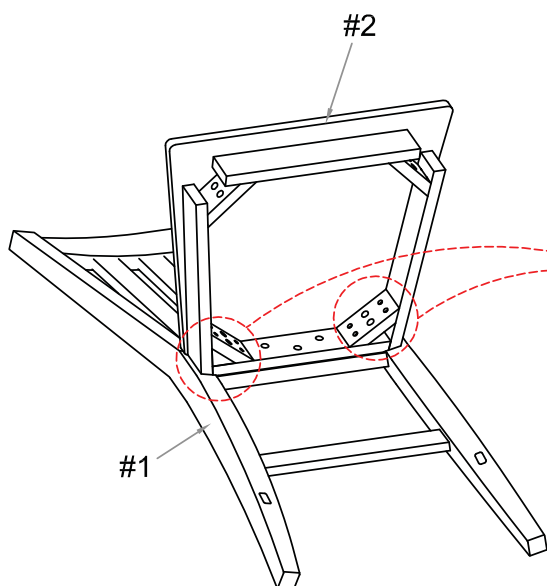

1. Prepare 4 bolt assemblies by first inserting a lock washer (#D) onto the bolt (#B) then a flat washer (#C) onto that same bolt (#B).

2. Insert 2 bolt assemblies into each back corner of the seat (#2) and secure using the Allen wrench (#E).

# ASSEMBLY INSTRUCTIONS

## 3

Part #3 x2pcs

Part #4 x1pc

Part #5 x2pcs

Hardware #F x4pcs

Hardware #G x4pcs

Hardware #H x4pcs

1. Insert the threaded ends of the front legs (#3) into the front corners of the seat (#2), make sure to insert the leg supports (#4,5) into the slots as you align the front legs.

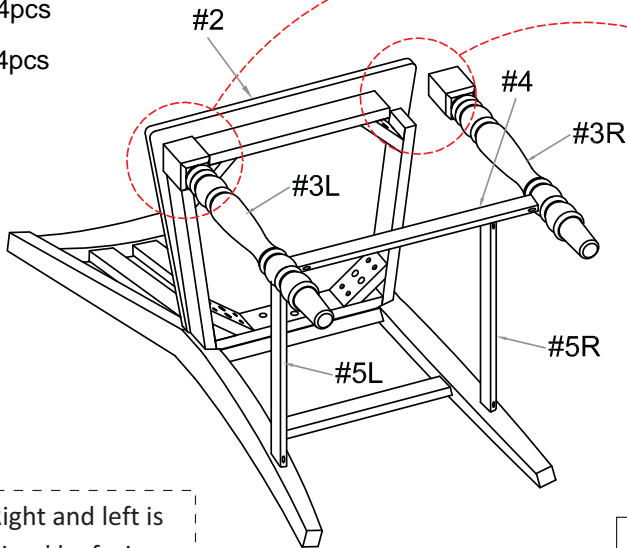

Note: Right and left is determined by facing the front of the chair in its upright position.

2. Apply a flat washer (#G), lock washer (#H), and hex nut (#F) onto each threaded end in that order. Secure using the wrench (#I).

## 4

Hardware #K x6pcs

Insert a wood screw (#K) into each end of the leg supports (#4,5). Secure using the Phillips screwdriver.

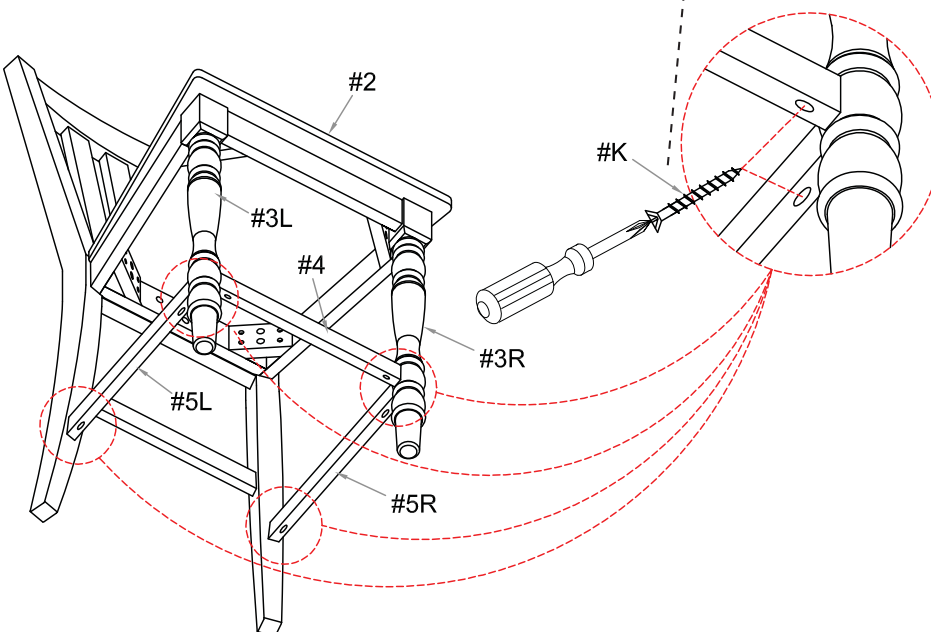

## ASSEMBLY COMPLETED



Please ensure the furniture rests on an even and flat surface. If the product wobbles or feels loose, double-check all bolts and/or screws are properly tightened and secured.

### Keep this handy!

Please retain this instruction manual and any order-related information for future reference.

### Lift, don't drag!

To avoid damage to product please always LIFT the product when transporting or adjusting the placement.