

ASSEMBLY INSTRUCTIONS

EEI-6275

V1.15.01.23

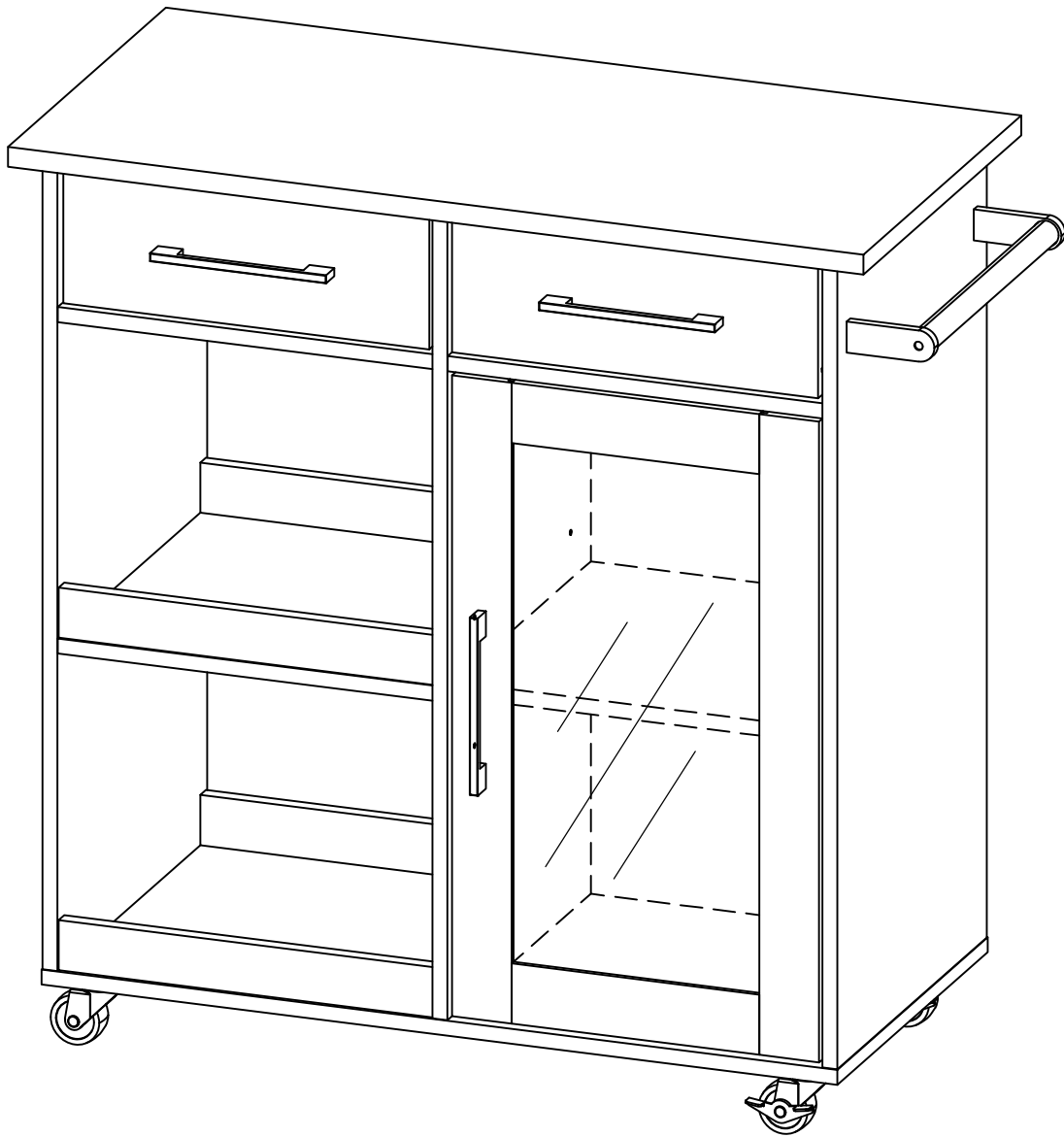

Questions? Contact us!

609.256.9000 • cs@modway.com
www.modway.com

*modway

Let's get started!

***modway**



Read through all of the instructions before starting



Care instructions are listed in the last step of this manual



Approx. 60 minutes assembly time



Make sure you have all parts and components before discarding any packing materials



2 people recommended for assembly

Only use hand tools to assemble this item. Do not use power tools. Do not tighten bolts or screws completely until all hardware is lined up and inserted into the holes.

Do not over-tighten screws and bolts to avoid stripping the hardware or cracking the item.

Assemble your item on a flat, carpeted area, with plenty of space to work. This will prevent damage and scratches to your floors or the item while you're assembling the product.

Keep all components and packaging out of reach of children or animals to avoid risk of choking or suffocation.

Furniture components:

1	Top Panel	x1	10	Back Panel - R	x1
2	Bottom Panel	x1	11	Shelf Panel	x1
3	Side Panel - L	x1	12	Drawer Front	x2
4	Side Panel - R	x1	13	Drawer Back	x2
5	Center Panel	x1	14	Drawer Side - L	x2
6	Middle Panel - 1	x2	15	Drawer Side - R	x2
7	Middle Panel - 2	x1	16	Drawer Bottom	x2
8	Middle Support	x4	17	Door Panel	x1
9	Back Panel - L	x1			

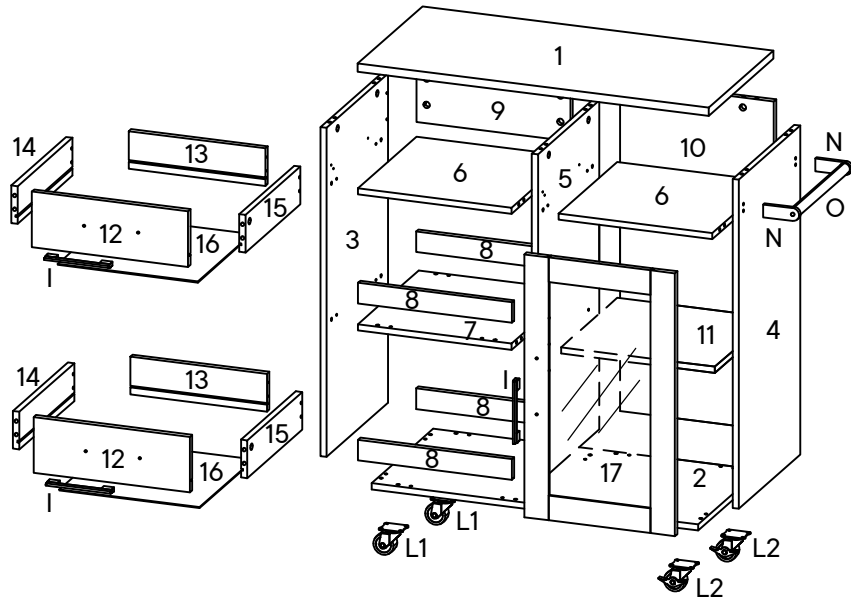

Provided hardware:

A1		Cam Lock	x32	J		Soft Closing 7/8 Hinges	x2
A2		Minifix Screw	x32	K1		12" Drawer Slide - L/R	x4
A3		Plastic Cap	x32	K2		12" Drawer Slide - L/R	x4
B		Wood Dowel M8 x 30mm	x40	L1		Nylon Castor	x2
C		CSK Cap Wood Screw M6 x 50mm	x8	L2		Nylon Castor With Stopper	x2
D		Allen Key M4	x1	M		Truss Head Screw M5 x 25mm	x4
E		C.B Screw M3.5 x 16mm	x56	N		Bracket	x2
F		C.B Screw M4 x 25mm	x6	O		Round Pipe	x1
G		C.B Screw M4 x 38mm	x16				
H		Metal Shelf Support	x4				
I		PVC Handle 00036	x3				

What You Need:

Phillips Head Screwdriver*

*Not included

Wait!

Missing parts or hardware? Need assistance?
Contact us before returning your item. We're here to help!
609.256.9000 • cs@modway.com

Step 1

HARDWARE

A2 Minifix Screw x8

COMPONENTS

1 Top Panel x1

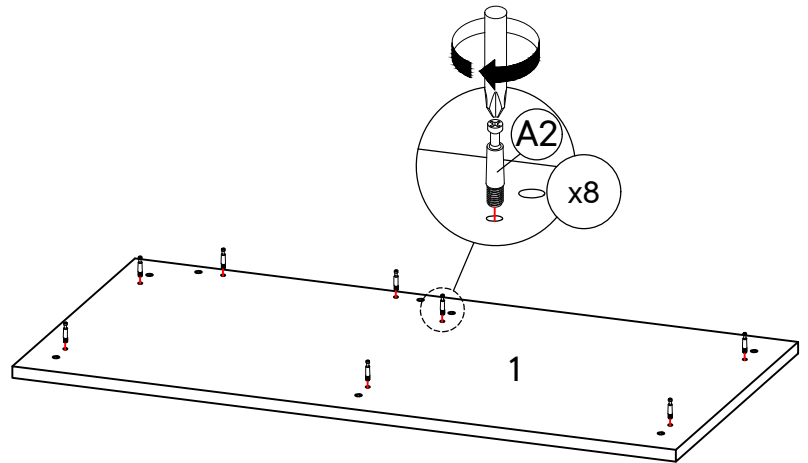

Step 2

HARDWARE

A1 Cam Lock x6

A2 Minifix Screw x20

B Wood Dowel M8 x 30mm x12

COMPONENTS

3 Side Panel - L x1

4 Side Panel - R x1

5 Center Panel x1

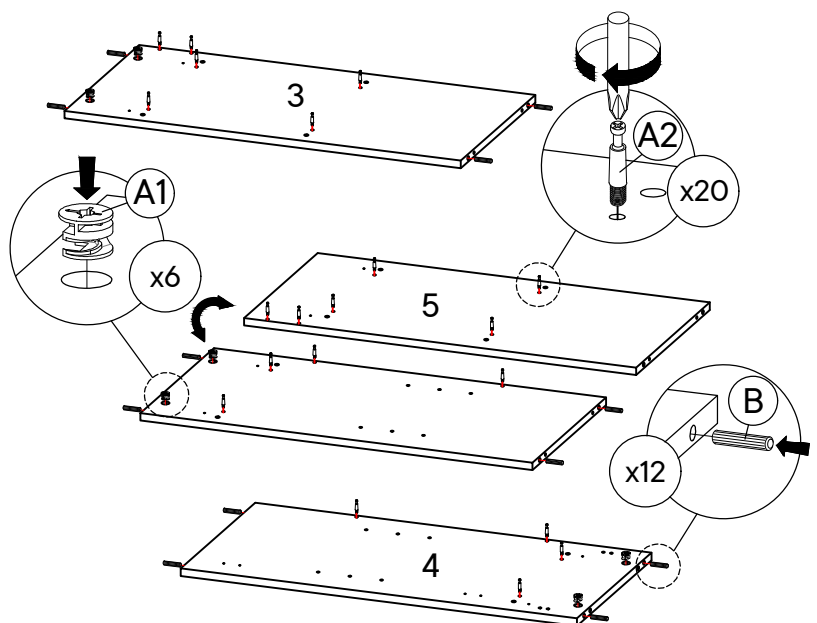

Step 3

HARDWARE

A1	Cam Lock	x12
B	Wood Dowel M8 x 30mm	x12

COMPONENTS

6	Middle Panel - 1	x2
7	Middle Panel - 2	x1

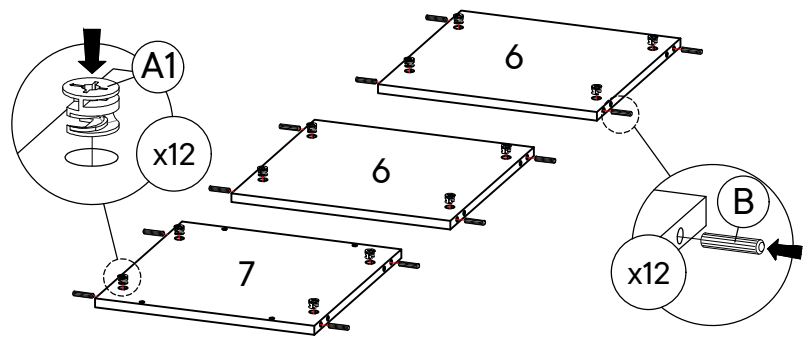

Step 4

HARDWARE

A1	Cam Lock	x10
B	Wood Dowel M8 x 30mm	x12

COMPONENTS

8	Middle Support	x4
9	Back Panel - L	x1
10	Back Panel - R	x1

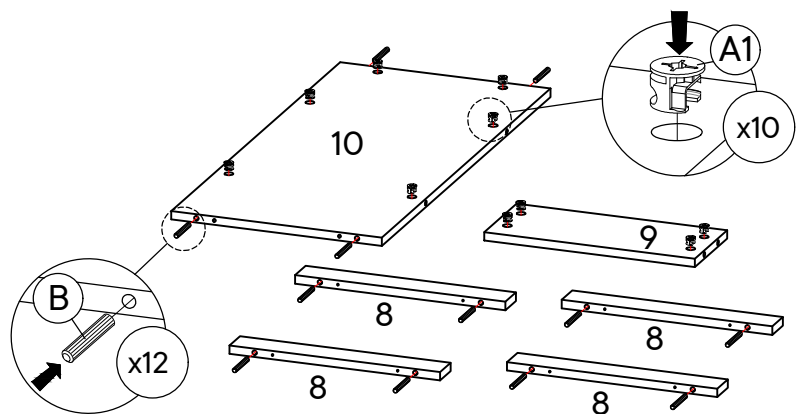

Step 5

HARDWARE

A1	Cam Lock	x4
A2	Minifix Screw	x4
B	Wood Dowel M8 x 30mm	x4

COMPONENTS

12	Drawer Front	x2
14	Drawer Side - L	x2
15	Drawer Side - R	x2

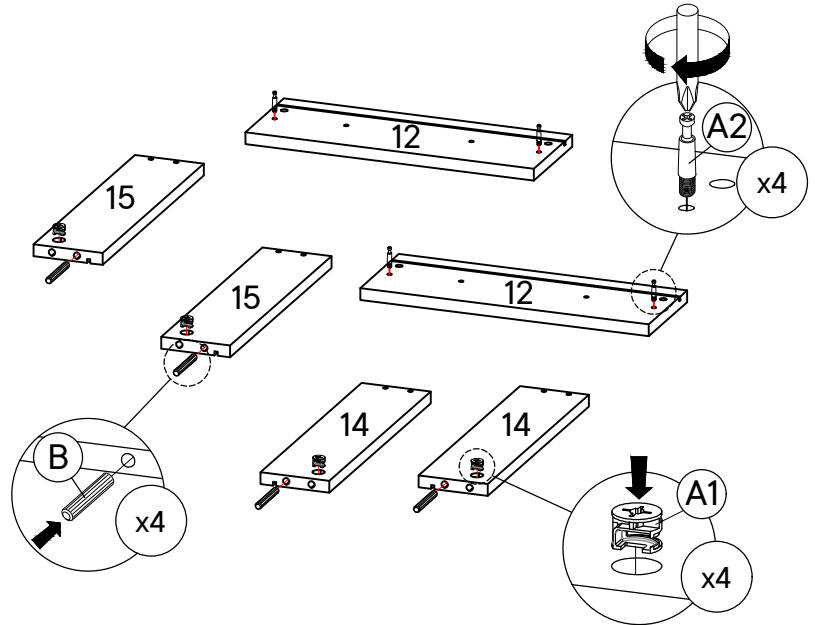

Step 6

HARDWARE

E	C.B Screw M3.5 x 16mm	x12
K1	12" Drawer Slide - L	x2
K1	12" Drawer Slide - R	x1

COMPONENTS

3	Side Panel - L	x1
4	Side Panel - R	x1
5	Center Panel	x1

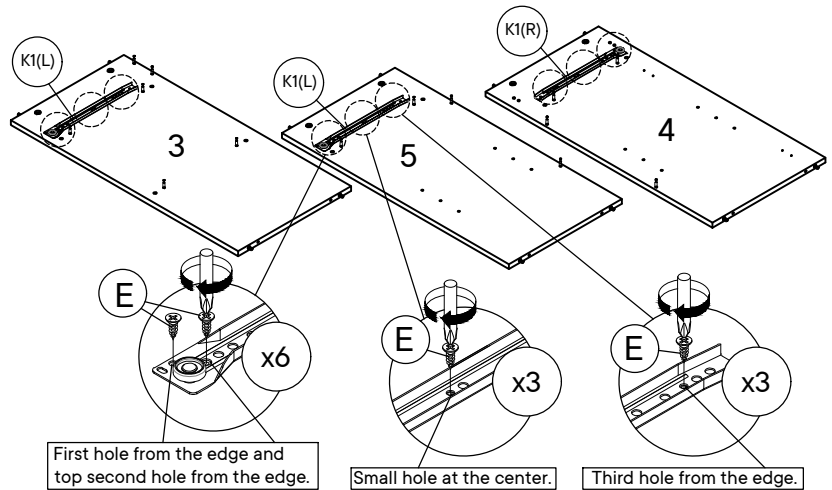

Notes

K1		12" Drawer Slide - L
K1		12" Drawer Slide - R

First hole from the edge and top second hole from the edge.

Small hole at the center.

Third hole from the edge.

Step 7

HARDWARE

- E** C.B Screw M3.5 x 16mm x4
- K1** 12" Drawer Slide - R x1

COMPONENTS

- 5** Center Panel x1

Notes

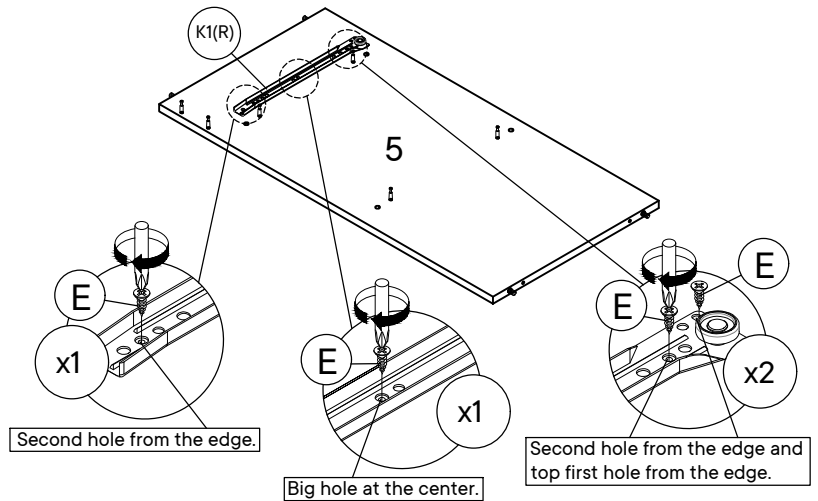
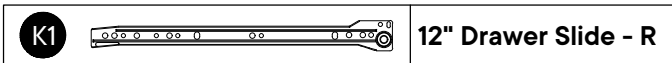

Step 8

HARDWARE

- G** C.B Screw M4 x 38mm x4

COMPONENTS

- 7** Middle Panel - 2 x1
- 8** Middle Support x2

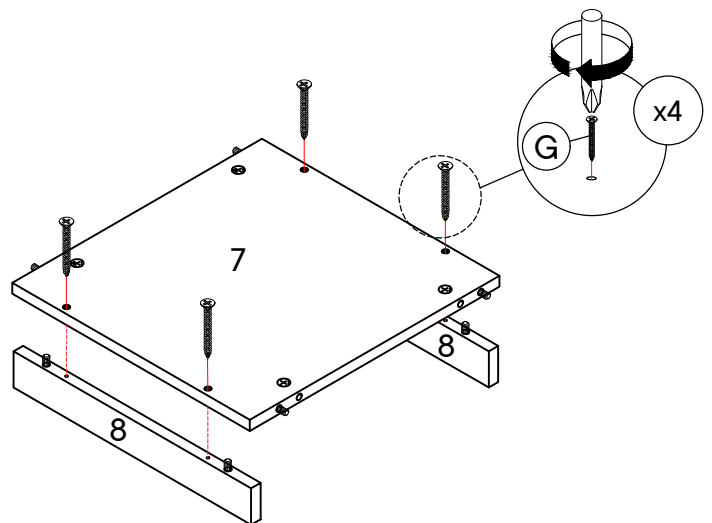

Step 9

HARDWARE

G C.B Screw M4 x 38mm x4

COMPONENTS

2 Bottom Panel x1

8 Middle Support x2

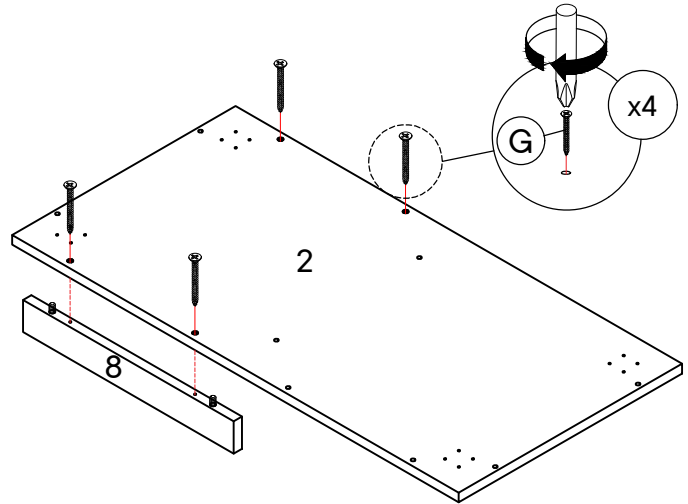

Step 10

HARDWARE

A3 Plastic Cap x6

COMPONENTS

3 Side Panel - L x1

6 Middle Panel - 1 x1

7 Middle Panel - 2 x1

9 Back Panel - L x1

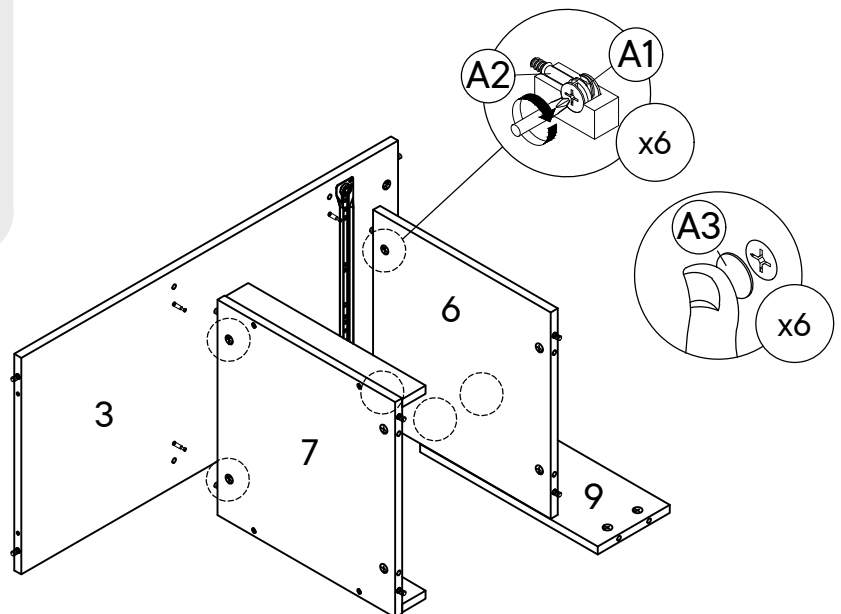

Step 11

HARDWARE

A3 Plastic Cap x6

COMPONENTS

5 Center Panel x1

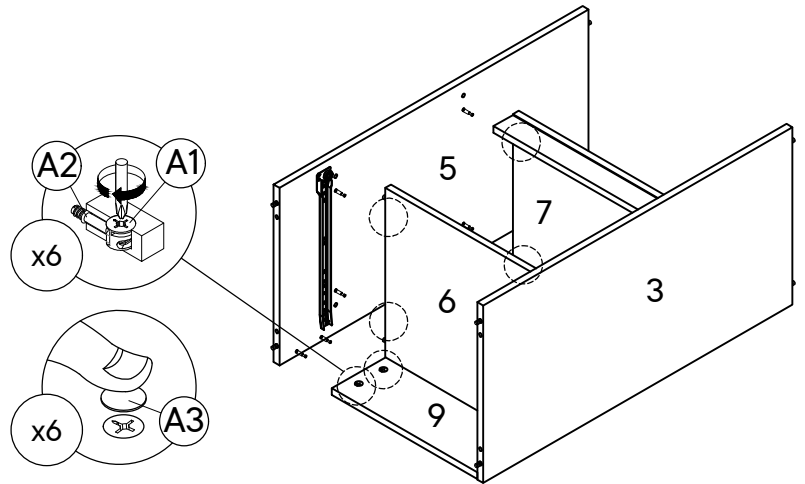

Step 12

HARDWARE

A3 Plastic Cap x4

COMPONENTS

6 Middle Panel - 1 x1

10 Back Panel - R x1

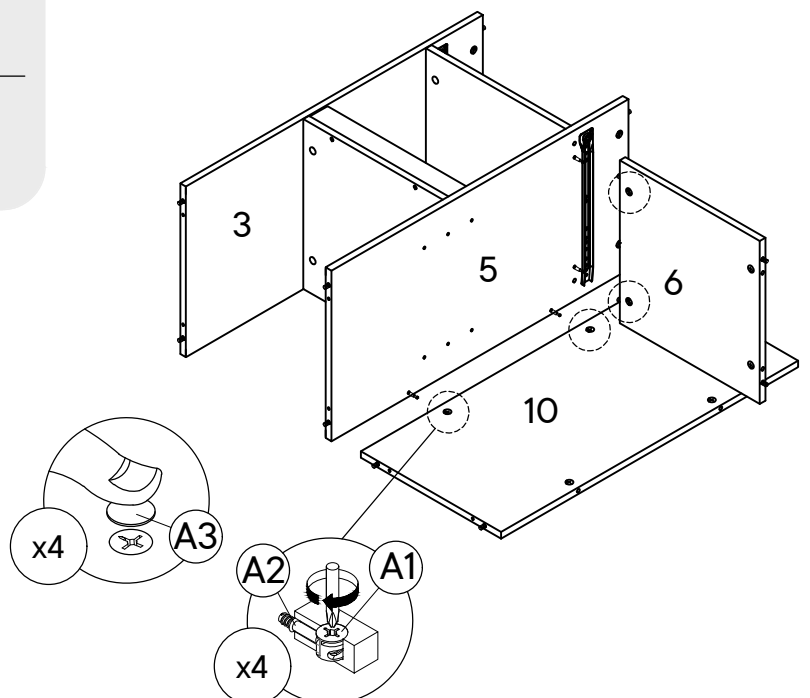

Step 13

HARDWARE

A3 Plastic Cap x4

COMPONENTS

4 Side Panel - R x1

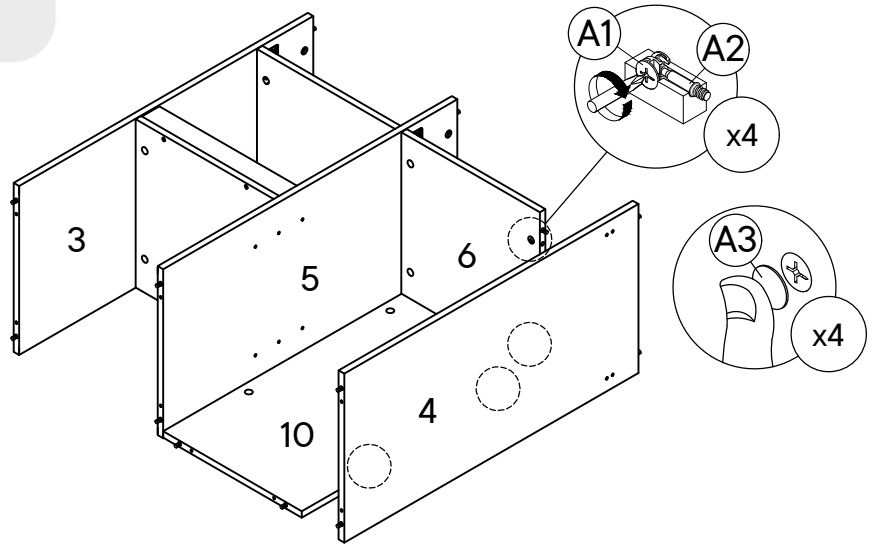

Step 14

HARDWARE

A3 Plastic Cap x8

COMPONENTS

1 Top Panel x1

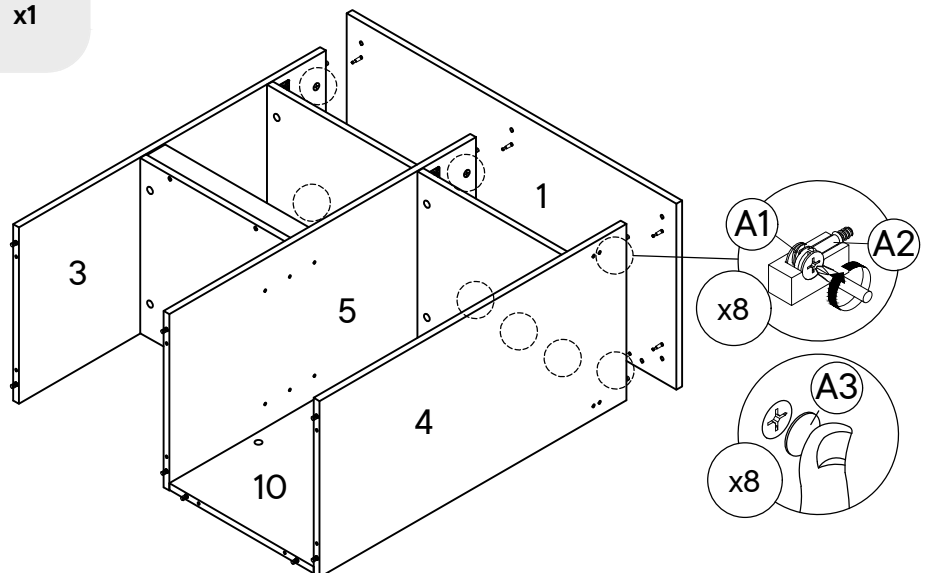

Step 15

HARDWARE

C CSK Cap Wood Screw M6 x 50mm x8

COMPONENTS

2 Bottom Panel x1

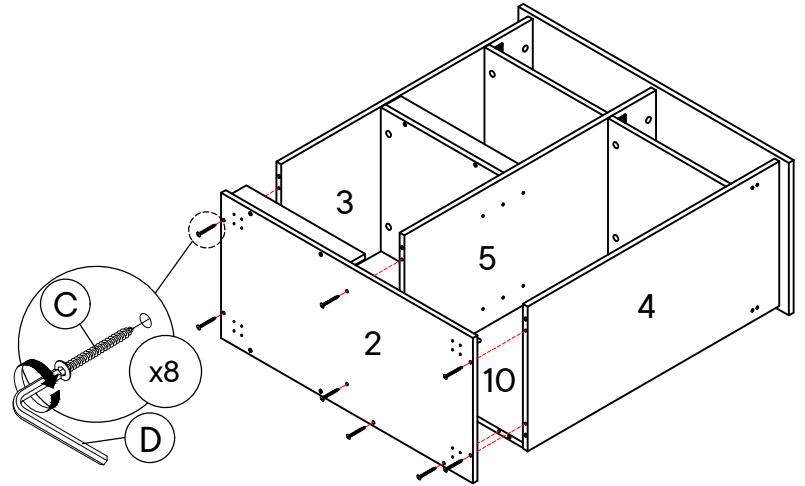

Step 16

HARDWARE

E C.B Screw M3.5 x 16mm x16

L1 Nylon Caster x2

L2 Nylon Caster Stopper x2

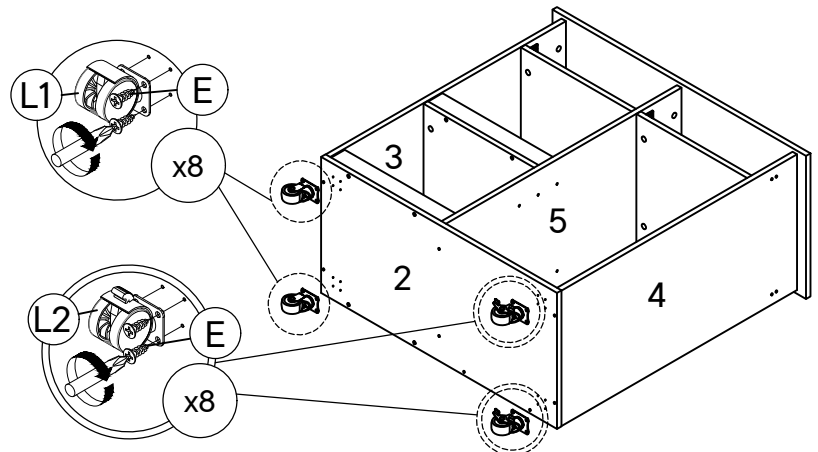

Step 17

HARDWARE

- M** Truss Head Screw M5 x 25mm x4
- N** Bracket x2
- O** Round Pipe x1

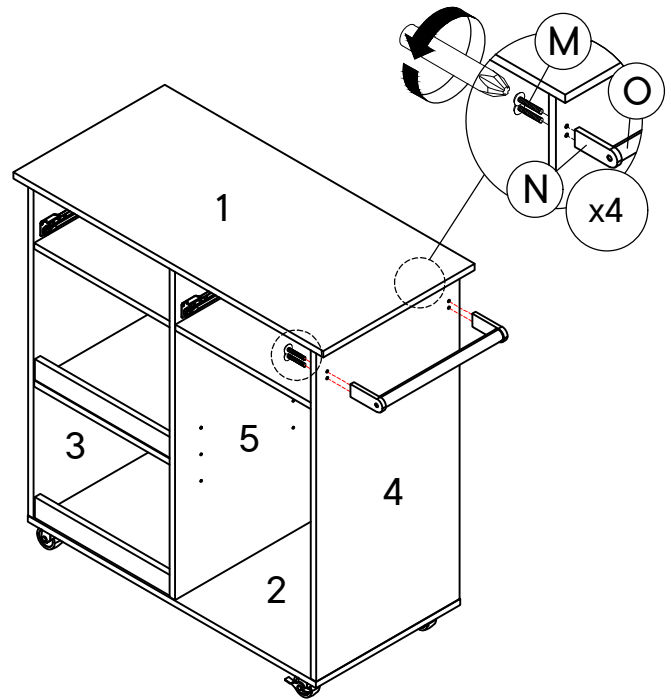

Step 18

HARDWARE

- H** Metal Shelf Support x4

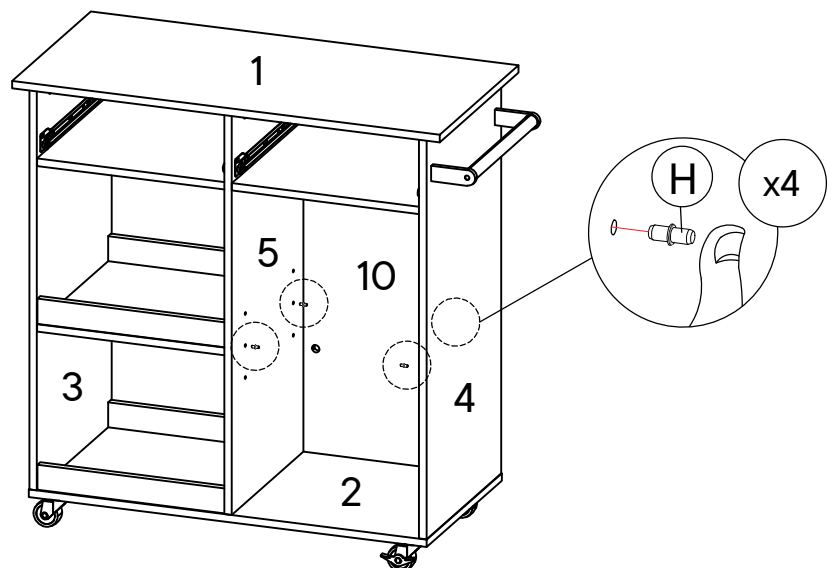

Step 19

COMPONENTS

- 11** Shelf Panel x1

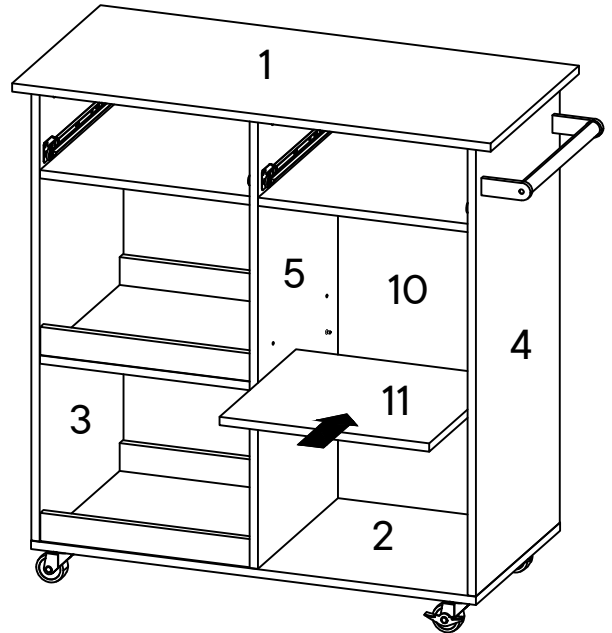

Step 20

HARDWARE

- F** C.B Screw M4 x 25mm x4
- I** PVC Handle 00036 x2

COMPONENTS

- 12** Drawer Front x2

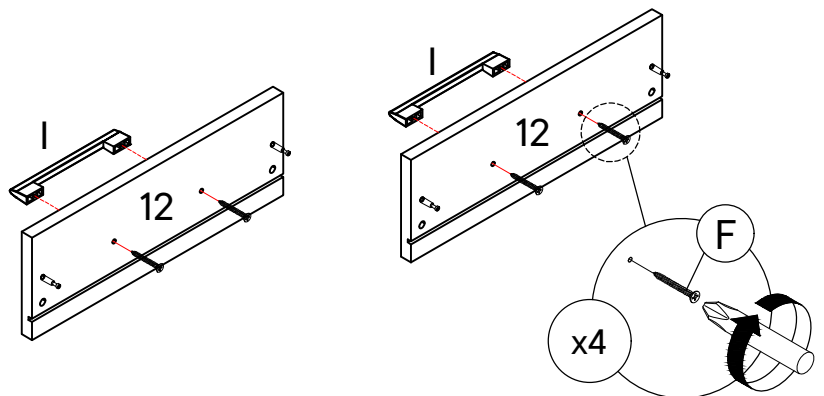

Step 21

HARDWARE

G C.B Screw M4 x 38mm x8

COMPONENTS

13 Drawer Back x2

14 Drawer Side - L x2

15 Drawer Side - R x2

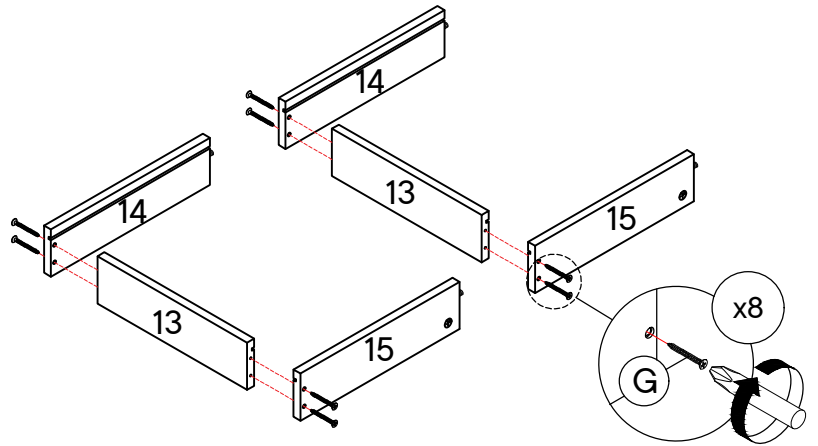

Step 22

COMPONENTS

16 Drawer Bottom x2

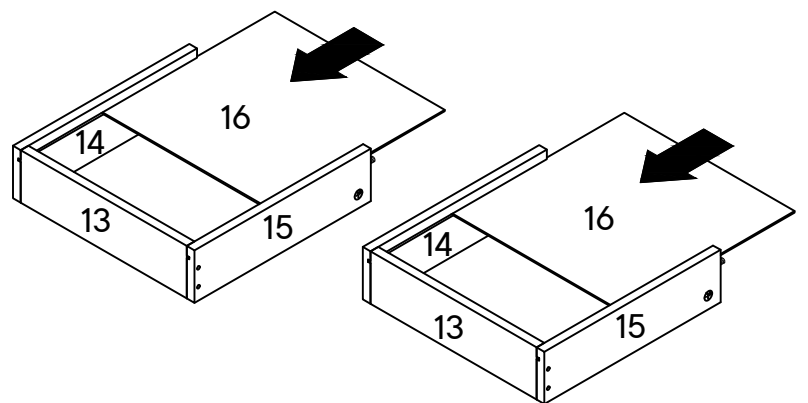

Step 23

HARDWARE

A3 Plastic Cap x4

COMPONENTS

12 Drawer Front x2

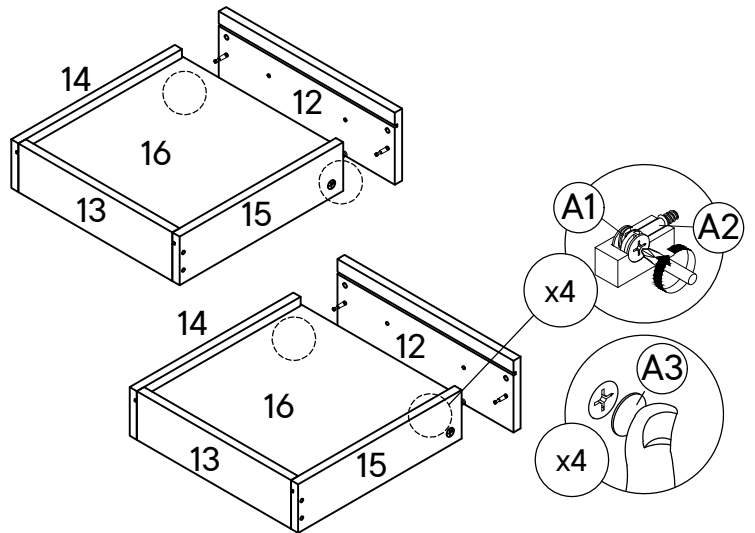

Step 24

HARDWARE

E C.B Screw M3.5 x 16mm x12

K2 12" Drawer Slide - L x2

K2 12" Drawer Slide - R x2

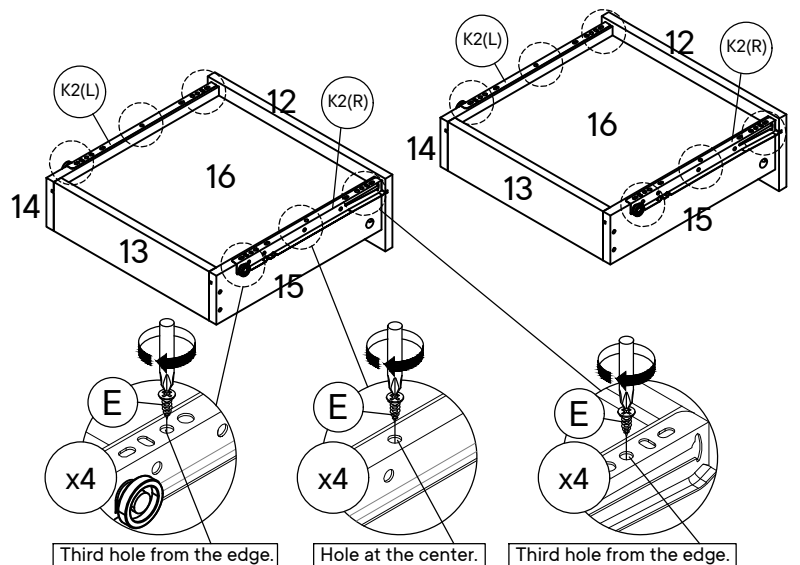

Notes

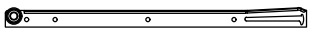
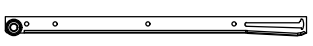
K2 	12" Drawer Slide - L
K2 	12" Drawer Slide - R

Step 25

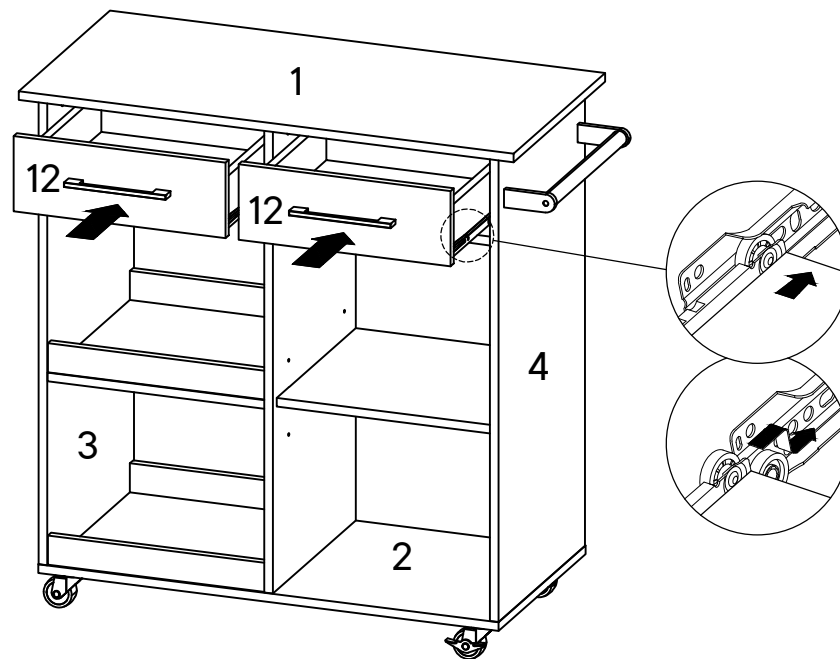

Put all the drawer in place along the drawer slides.

Step 26

HARDWARE

E	C.B Screw M3.5 x 16mm	x4
F	C.B Screw M4 x 25mm	x2
I	PVC Handle 00036	x1
J	Soft Closing 7/8 Hinges	x2

COMPONENTS

17	Door Panel	x1
-----------	------------	----

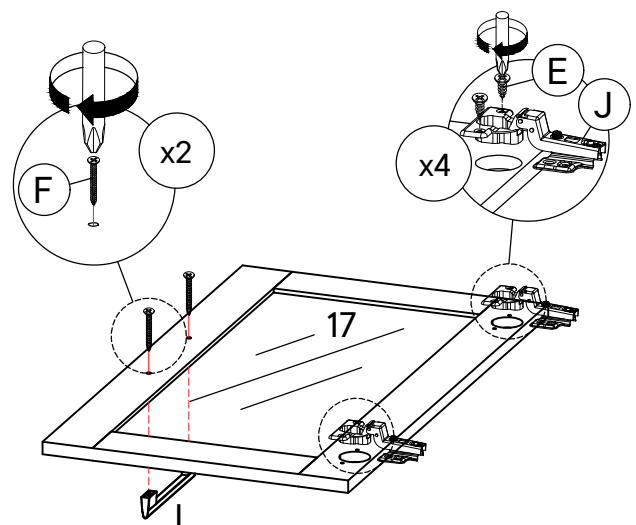

Step 27

HARDWARE

E C.B Screw M3.5 x 16mm **x8**

Fix hardware J into panel (4) by using hardware E.
(Repeat 4 times for each hardware.)

Tighten or loosen the screw to adjust
position of panel (17).
(Do only when needed.)

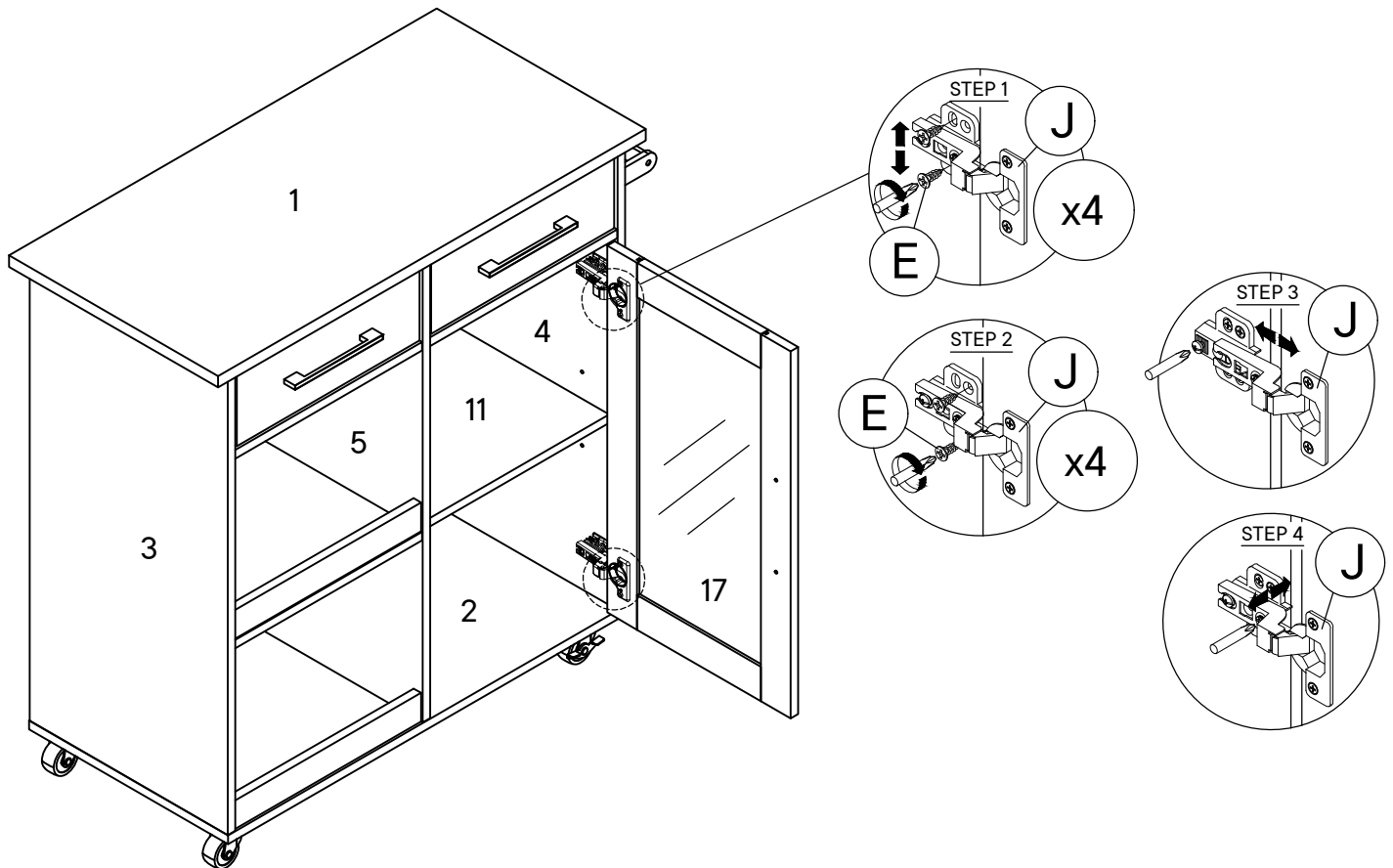

Great job!

Your new kitchen cart is ready.

♥ CARING FOR YOUR ITEM

Depending on use, it may be necessary to tighten the hardware from time to time, so please save the tools that have been provided.

Not contract grade.

Clean using a non-abrasive cloth and a mild cleaner.

CONNECT WITH US!

Tag us [@modway_furniture](#) and [#modway](#) for a chance to be featured.

