

ASSEMBLY INSTRUCTIONS

EEI-6044

V0.01.20.22

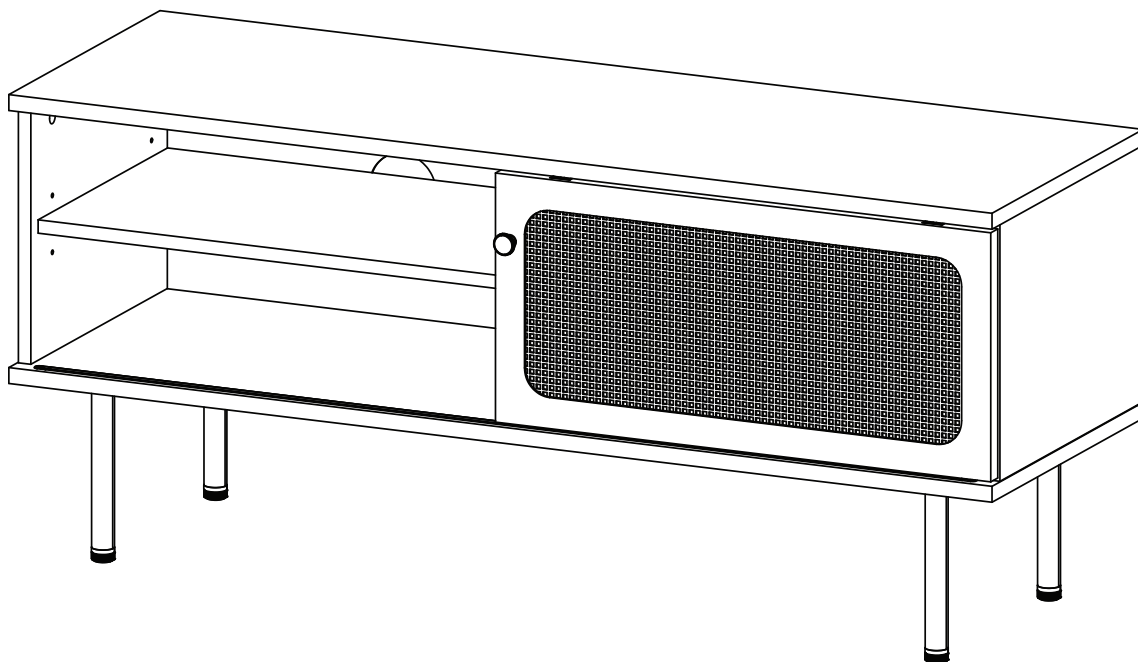

Questions? Contact us!

609.256.9000 • cs@modway.com
www.modway.com

*modway

For use with televisions weighing a maximum of 100 lb / 45.4 kg or less, with a maximum width of 45 inches / 114.3 cm.

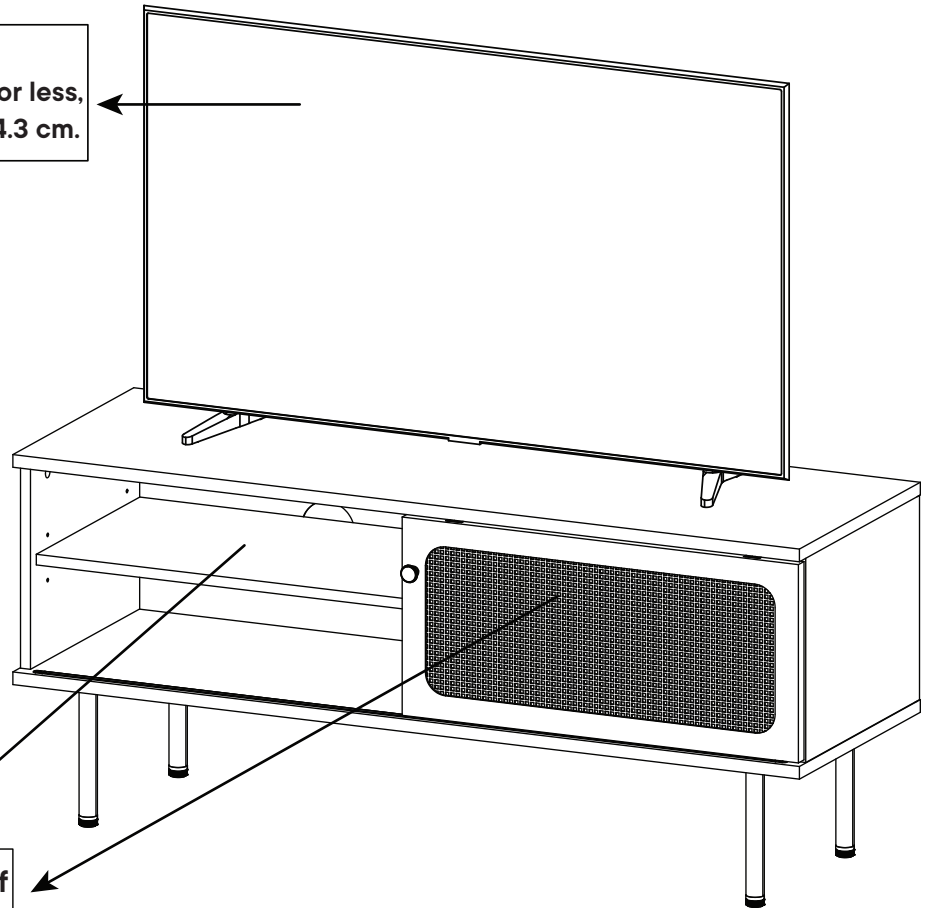

22 lb / 9.9 kg weight limit per shelf

Let's get started!

*modway



Read through all of the instructions before starting



Care instructions are listed in the last step of this manual



Approx. 60 minutes assembly time



Make sure you have all parts and components before discarding any packing materials



2 people recommended for assembly

Only use hand tools to assemble this item. Do not use power tools. Do not tighten bolts or screws completely until all hardware is lined up and inserted into the holes.

Do not over-tighten screws and bolts to avoid stripping the hardware or cracking the item.

Assemble your item on a flat, carpeted area, with plenty of space to work. This will prevent damage and scratches to your floors or the item while you're assembling the product.

Keep all components and packaging out of reach of children or animals to avoid risk of choking or suffocation.

Furniture components:

1	Top Board	x1
2	Bottom Board	x1
3	Side Board Left	x1
4	Side Board Right	x1
5	Adjustable Shelf	x2
6	Center Board	x1
7	Back Board	x2
8	Door	x1

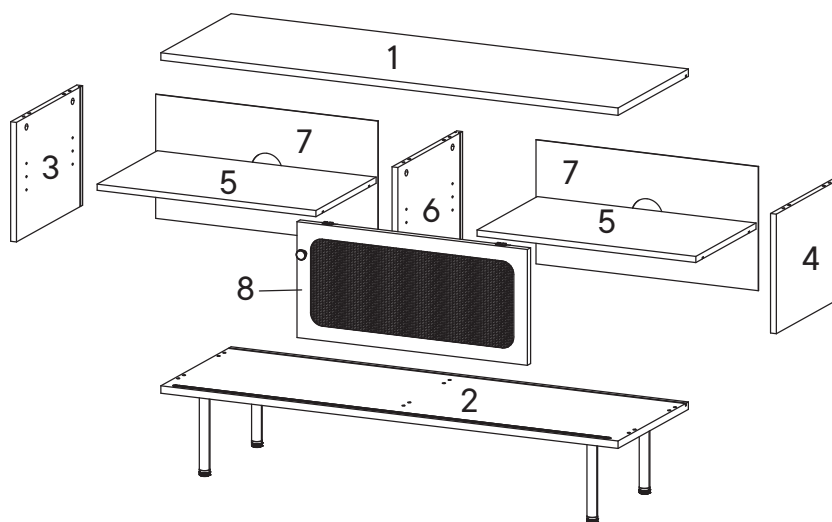

Provided hardware:

A		Cam Bolt $\varnothing 6 \times 35$ mm	x6
B		Cam Lock $\varnothing 15$ mm	x6
C		Wood Dowel $\varnothing 8 \times 30$ mm	x12
D		Allen Key	x1
E		Screw M 7 x 50 mm	x6
F		Screw Cap $\varnothing 15$ mm	x6
G		Stopper	x2
H		Screw M 3.5 x 13 mm	x8
I		Screw M 4 x 25 mm	x1

J		Screw M 4.5 x 12.5 mm	x16
K		Sliding Top	x2
L		Sliding Bottom	x2
M		Shelf Pin	x8
N		Wedge	x8
O		Screw M 3.5 x 15.5 mm	x8
P		Handle	x1
Q		Screw M 6 x 12.5 mm	x10
LM20A1		Leg	x4

US90		Anti Deflection Bar	x1
------	--	---------------------	----

What you need:

	Phillips Head Screwdriver
--	---------------------------

Wait!

Missing parts or hardware? Need assistance?
Contact us before returning your item. We're here to help!
609.256.9000 • cs@modway.com

Step 1

HARDWARE

- A** Cam Bolt Ø6 x 35 mm x6
- C** Wood Dowel Ø8 x 30 mm x12

COMPONENTS

- 1** Top Board x1
- 3** Side Board Left x1
- 4** Side Board Right x1
- 6** Center Board x1

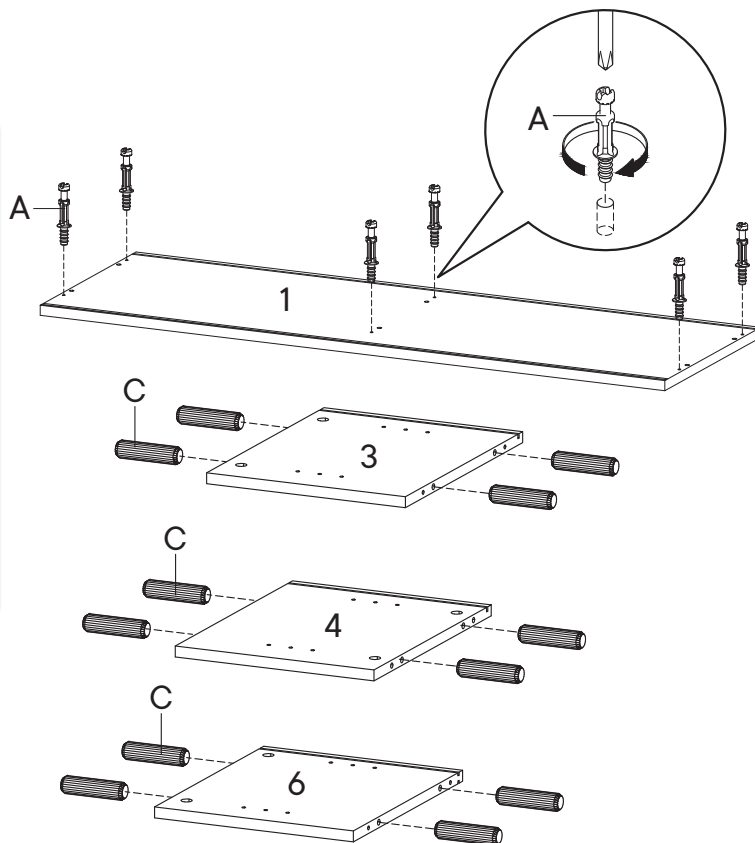

Step 2

HARDWARE

- B** Cam Lock Ø15 mm x6
- F** Screw Cap Ø15 mm x6

COMPONENTS

- 1** Top Board x1
- 3** Side Board Left x1
- 4** Side Board Right x1
- 6** Center Board x1

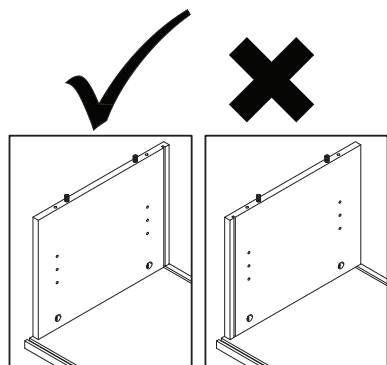
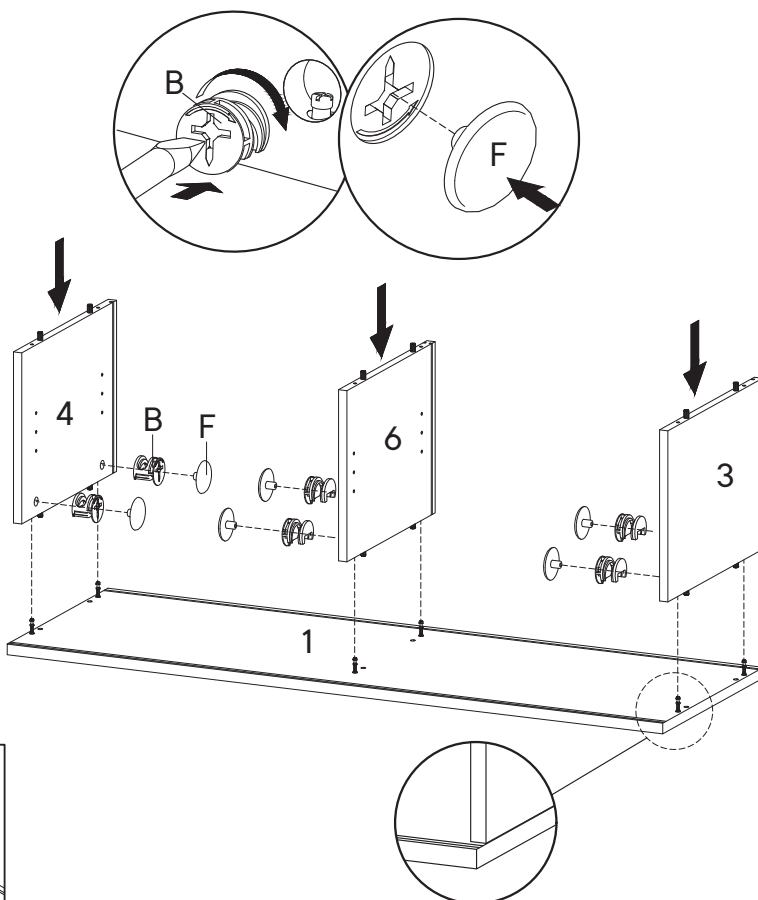

Step 3

HARDWARE

- D** Allen Key x1
- E** Screw M 7 x 50 mm x6

COMPONENTS

- 2** Bottom Board x1
- 7** Back Board x2

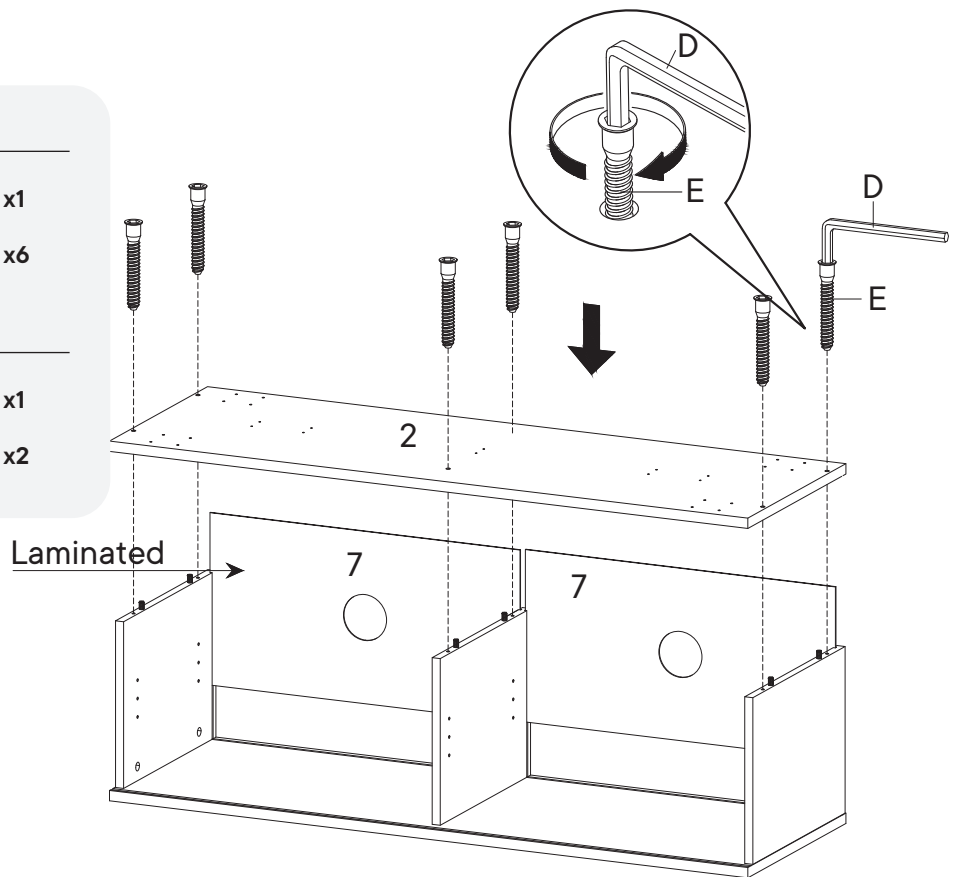

Step 4

HARDWARE

- Q** Screw M 6 x 12.5 mm x10
- US90** Anti Deflection Bar x1

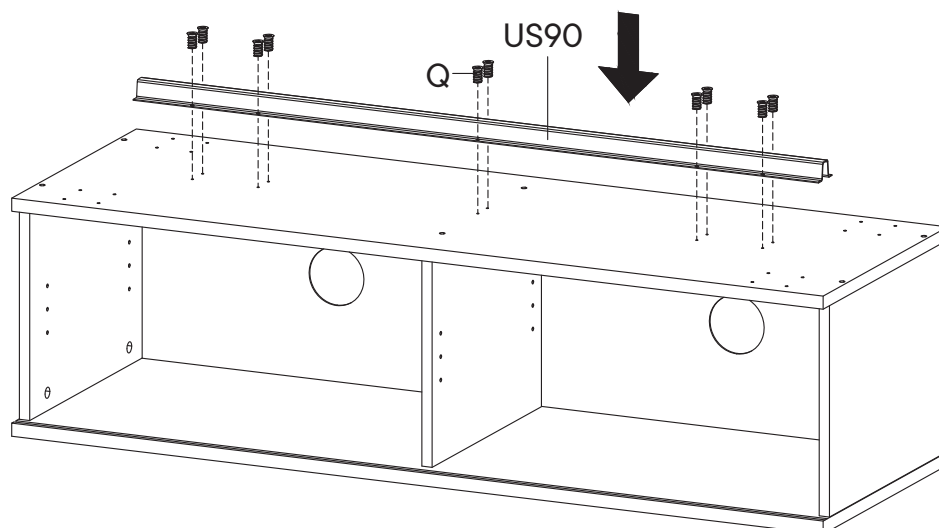
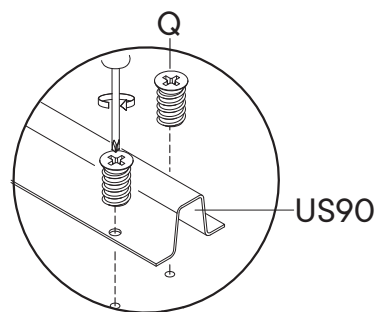

Step 5

HARDWARE

- J** Screw M 4.5 x 12.5 mm x16
- LM20A1** Leg x4

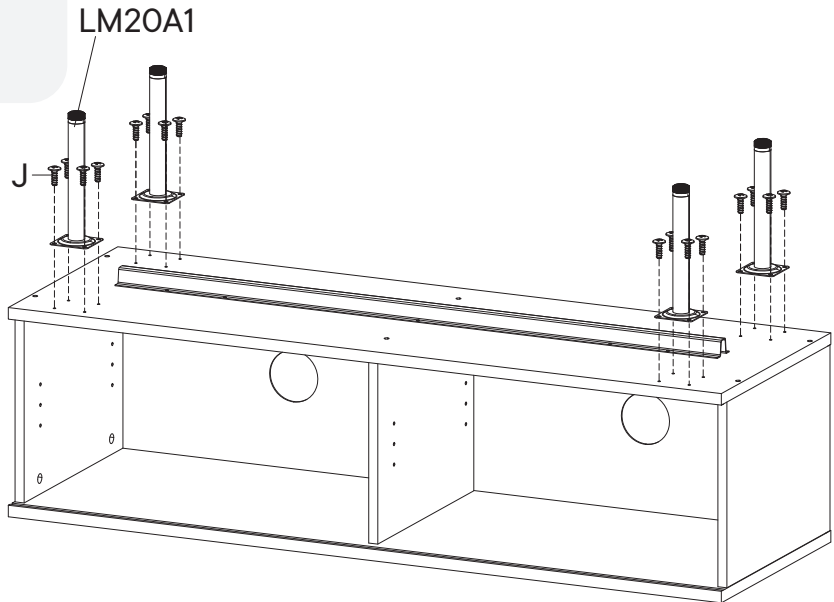

Step 6

HARDWARE

- M** Shelf Pin x8

COMPONENTS

- 5** Adjustable Shelf x2

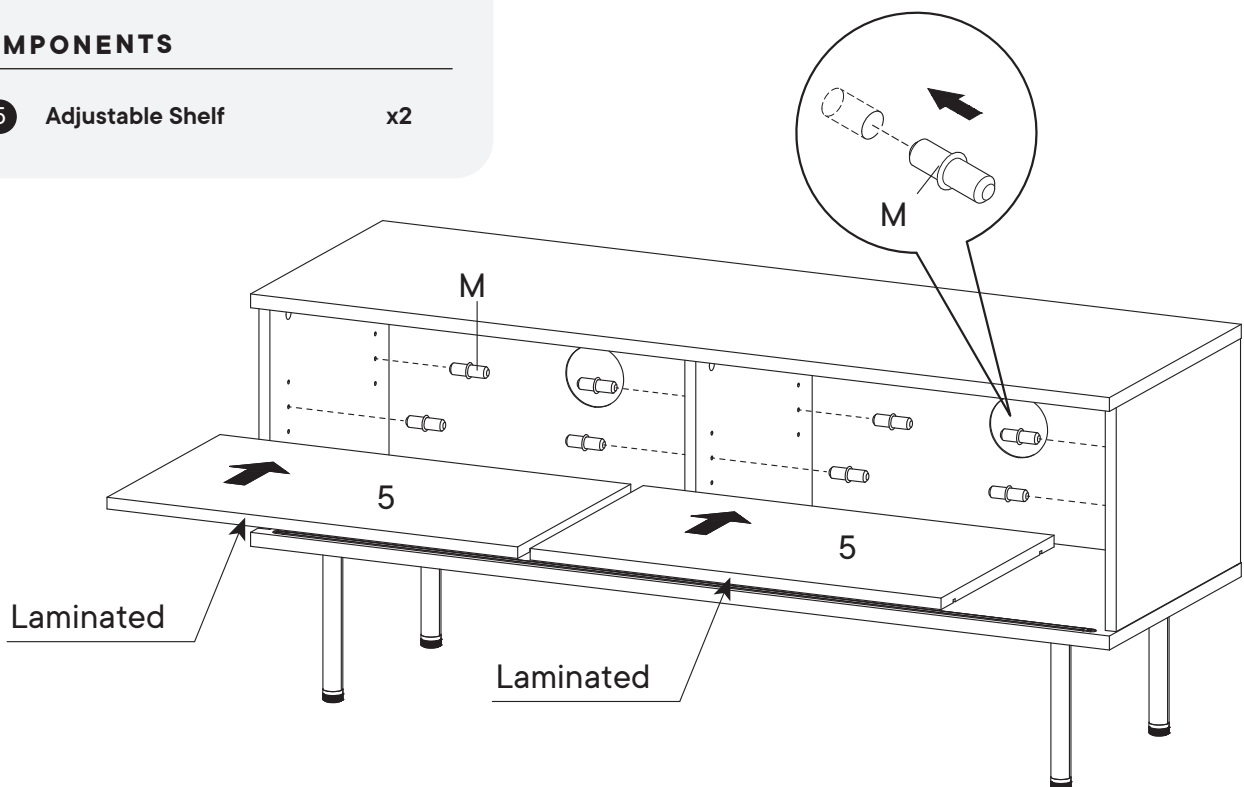

Step 7

HARDWARE

- G** Stopper x2
- H** Screw M 3.5 x 13 mm x8
- K** Sliding Top x2
- L** Sliding Bottom x2

COMPONENTS

- 8** Door x1

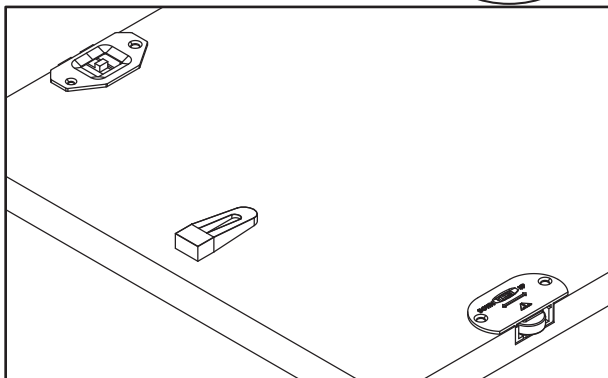
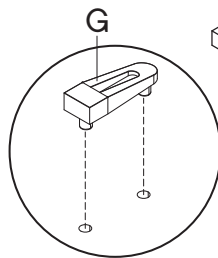
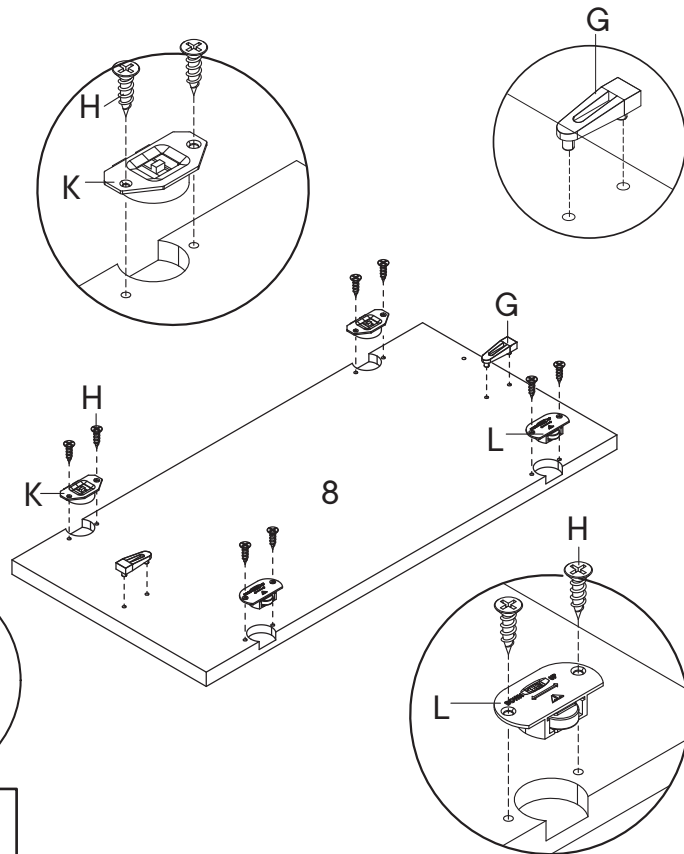

Step 8

HARDWARE

- I** Screw M 4 x 25 mm x1
- P** Handle x1

COMPONENTS

- 8** Door x1

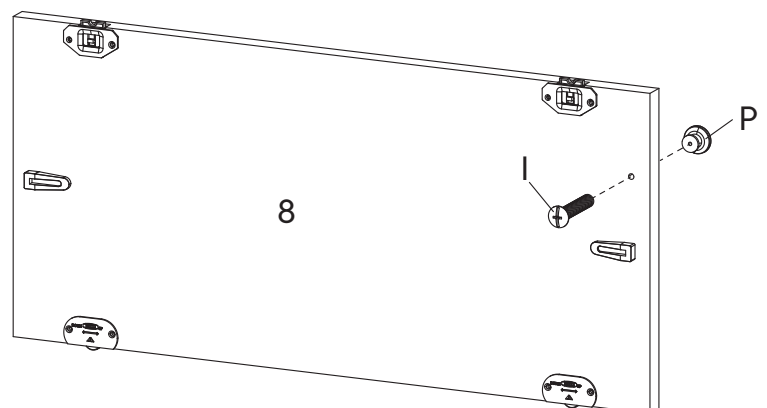

Step 9

COMPONENT

8 Door x1

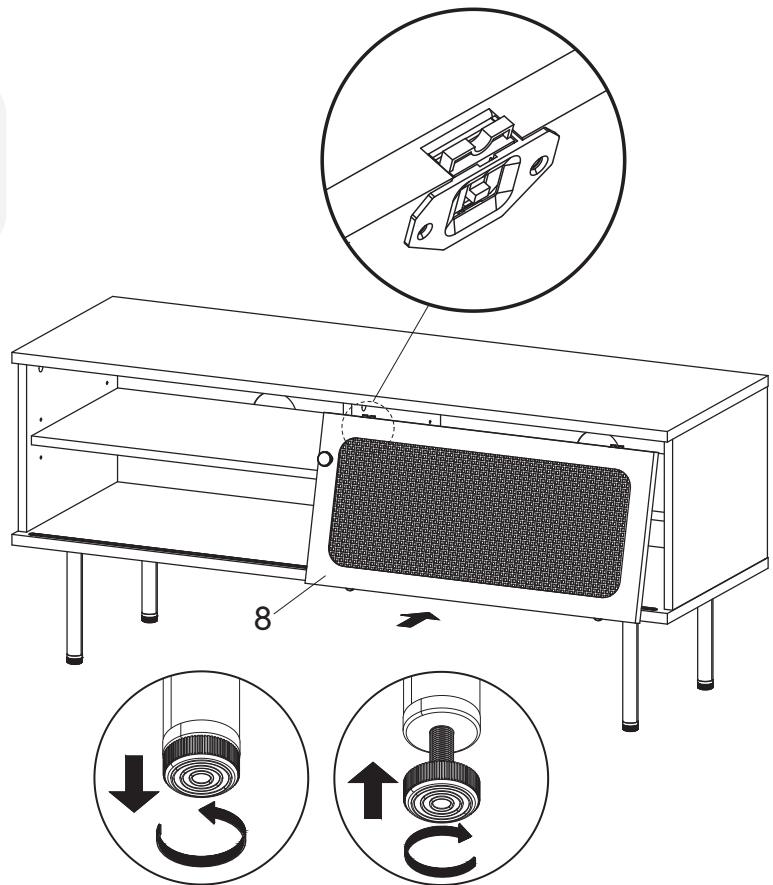
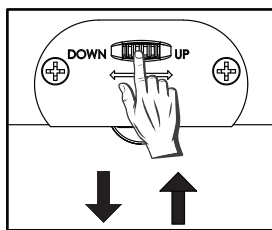
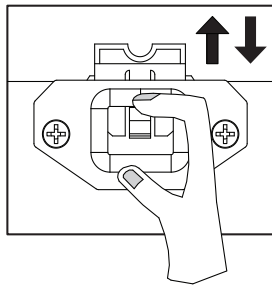

Step 10

HARDWARE

N Wedge x8
 O Screw M 3.5 x 15.5 mm x8

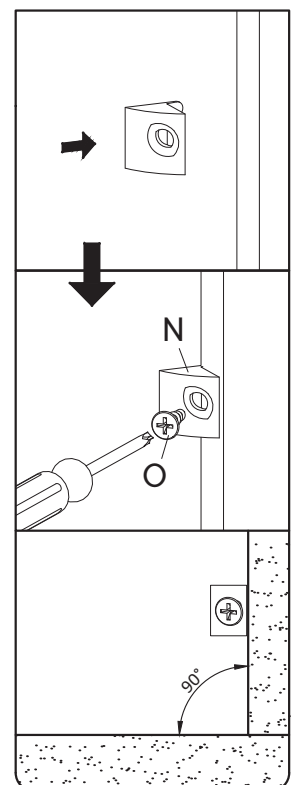
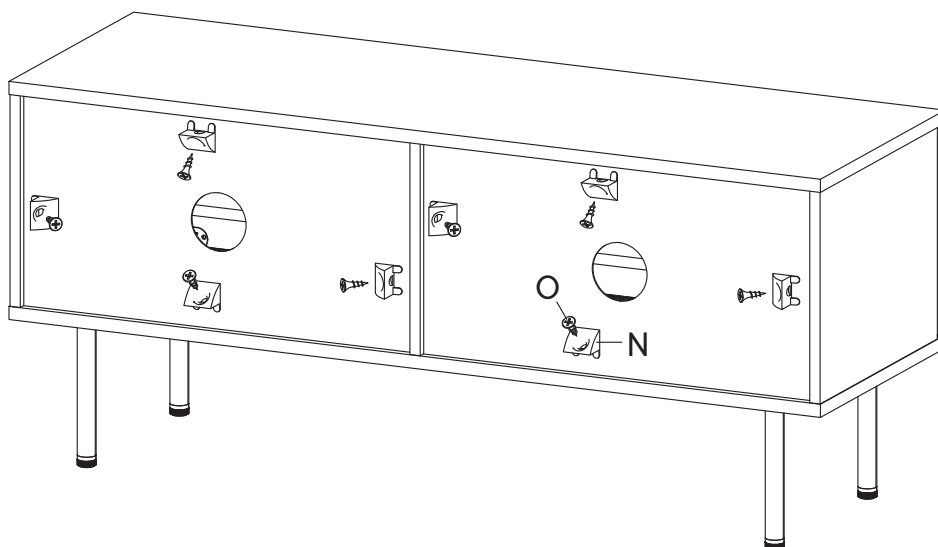

Great job!

TV Stand assembly is complete.

♥ CARING FOR YOUR ITEM

Indoor use only.

Not contract grade.

Clean using a non-abrasive cloth and a mild cleaner.

Never use harsh chemicals, as they could damage the finish or integrity of the item.

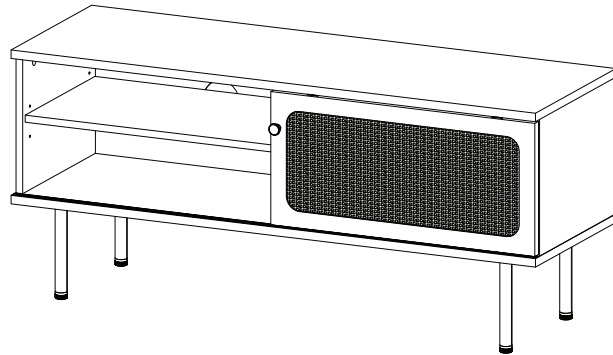

CONNECT WITH US!   

Tag us [@modway_furniture](#) and [#modway](#) for a chance to be featured.