

ASSEMBLY INSTRUCTIONS

EEI-5862

V0.09.28.21

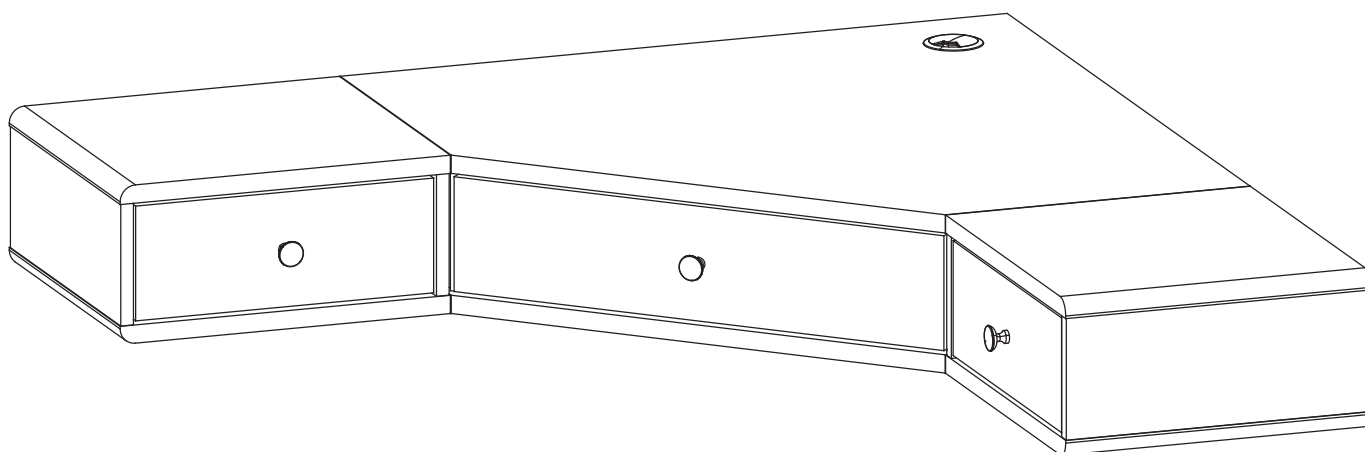

Questions? Contact us!

609.256.9000 • cs@modway.com
www.modway.com

*modway

Let's get started!

*modway



Read through all of the instructions before starting



Care instructions are listed in the last step of this manual



Approx. 90 minutes assembly time



Make sure you have all parts and components before discarding any packing materials



3 people recommended for assembly

Only use hand tools to assemble this item. Do not use power tools. Do not tighten bolts or screws completely until all hardware is lined up and inserted into the holes.

Do not over-tighten screws and bolts to avoid stripping the hardware or cracking the item.

Assemble your item on a flat, carpeted area, with plenty of space to work. This will prevent damage and scratches to your floors or the item while you're assembling the product.

Keep all components and packaging out of reach of children or animals to avoid risk of choking or suffocation.

Furniture components:

1	Top Board 1	x1	11	Top Board 3	x1	21	Front Drawer Big	x1
2	Bottom Board 1	x1	12	Bottom Board 3	x1	22	Back Drawer Big	x1
3	Side Board Left 1	x1	13	Side Board Left 3	x1	23	Bottom Drawer Big	x1
4	Side Board Right 1	x1	14	Side Board Right 3	x1	24	Back Board 2	x1
5	Center Board Left	x1	15	Back Board 1	x2	25	Back Board 3	x1
6	Center Board Right	x1	16	Front Drawer Small	x2			
7	Top Board 2	x1	17	Side Drawer Left	x3			
8	Bottom Board 2	x1	18	Side Drawer Right	x3			
9	Side Board Left 2	x1	19	Back Drawer Small	x2			
10	Side Board Right 2	x1	20	Bottom Drawer Small	x2			

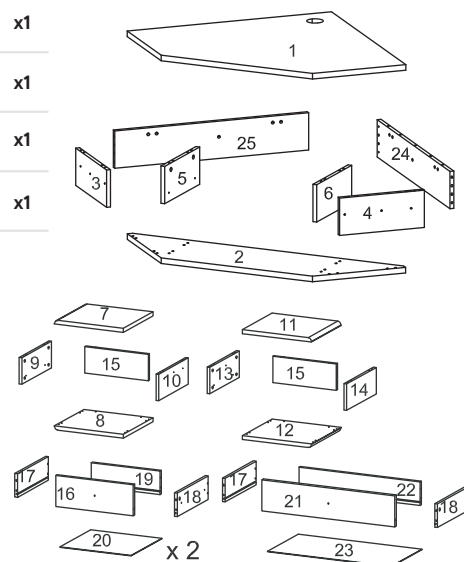

Provided hardware:

A		Cam Bolt $\varnothing 6 \times 35$ mm	x42	K		Wall Plug	x18	U		Handle	x3
B		Cam Lock $\varnothing 15$ mm	x36	L		Screw 5.5 x 45 mm	x18	V		Screw M 4 x 22 mm	x3
C		Cam Lock $\varnothing 12$ mm	x6	M		Grommet Cover	x1	W		Wall Mounted Bolt	x2
D		Wood Dowel $\varnothing 8 \times 30$ mm	x50	N		Screw M 3.5 x 15.5 mm	x14	X		Wood Dowel $\varnothing 8 \times 20$ mm	x4
E		Wood Dowel $\varnothing 6 \times 30$ mm	x6	O		Screw M 6 x 30 mm	x2	RM30A		Drawer Runner	x3
F		Wedge	x14	P		Screw M 3.5 x 13 mm	x18	PA69		Long Bracket	x2
G		Screw M 4.5 x 12.5 mm	x24	Q		Screw M 6 x 15 mm	x16	PA34		Medium Bracket	x2
H		JCN Nut	x16	R		Screw M 7 x 50 mm	x8	PA05		Short Bracket	x8
I		Screw M 6 x 10.5 mm	x12	S		Allen Key	x2				
J		Screw M 8 x 39 mm	x12	T		Mending Plate	x4				

What you need:

Phillips Head Screwdriver

Wait!

Missing parts or hardware? Need assistance?
Contact us before returning your item. We're here to help!
609.256.9000 • cs@modway.com

Step 1

HARDWARE

- A** Cam Bolt Ø6 x 35 mm x4
- E** Wood Dowel Ø6 x 30 mm x4

COMPONENTS

- 16** Front Drawer Small x2
- 17** Side Drawer Left x2
- 18** Side Drawer Right x2

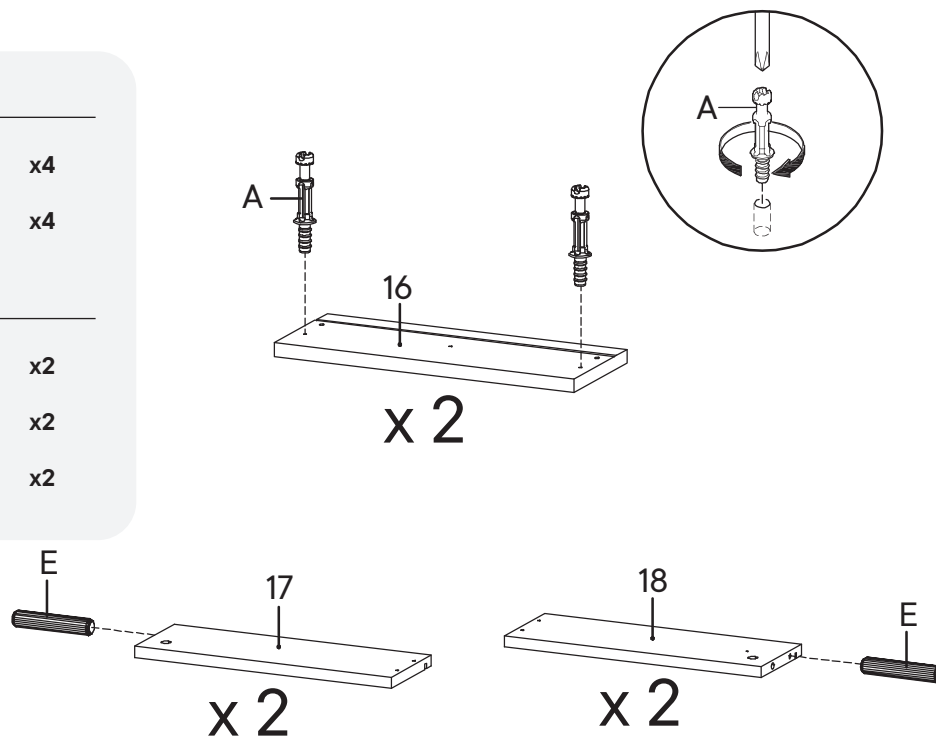

Step 2

HARDWARE

- C** Cam Lock Ø12 mm x4
- J** Screw M 8 x 39 mm x8

COMPONENTS

- 16** Front Drawer Small x2
- 17** Side Drawer Left x2
- 18** Side Drawer Right x2
- 19** Back Drawer Small x2
- 20** Bottom Drawer Small x2

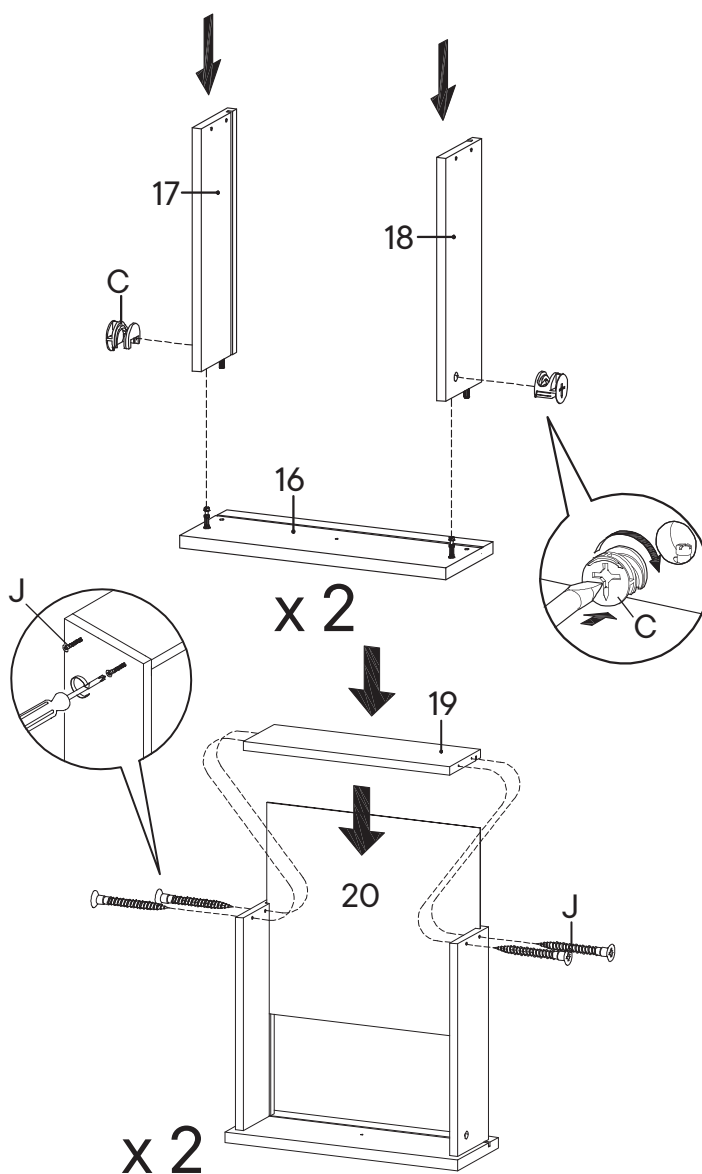

Step 3

HARDWARE

- A** Cam Bolt $\varnothing 6 \times 35$ mm x2
- E** Wood Dowel $\varnothing 6 \times 30$ mm x2

COMPONENTS

- 17** Side Drawer Left x1
- 18** Side Drawer Right x1
- 21** Front Drawer Big x1

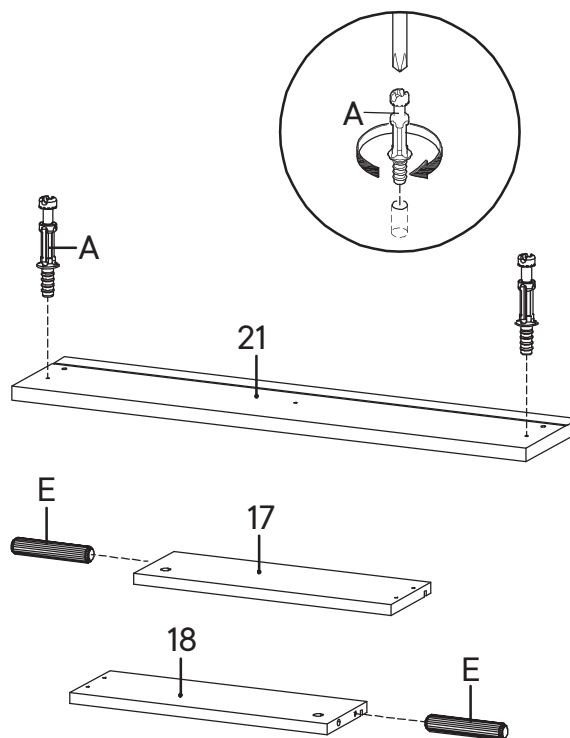

Step 4

HARDWARE

- C** Cam Lock $\varnothing 12$ mm x2
- J** Screw M 8 x 39 mm x4

COMPONENTS

- 17** Side Drawer Left x1
- 18** Side Drawer Right x1
- 21** Front Drawer Big x1
- 22** Back Drawer Big x1
- 23** Bottom Drawer Big x1

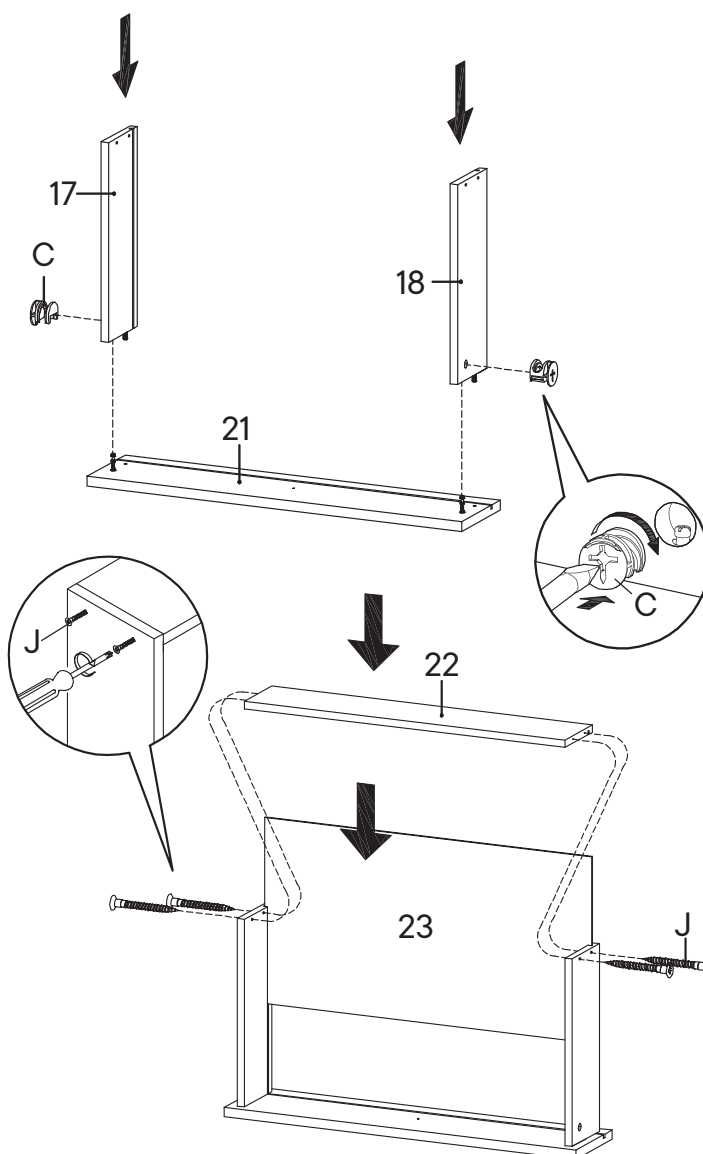

Step 5

HARDWARE

- P** Screw M 3.5 x 13 mm x18
- U** Handle x3
- V** Screw M 4 x 22 mm x3
- RM30A** Drawer Runner x3

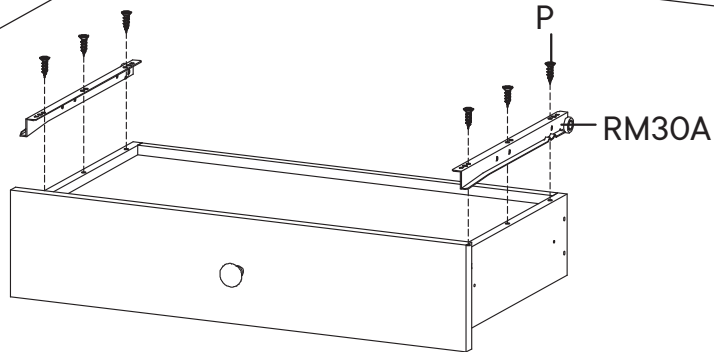
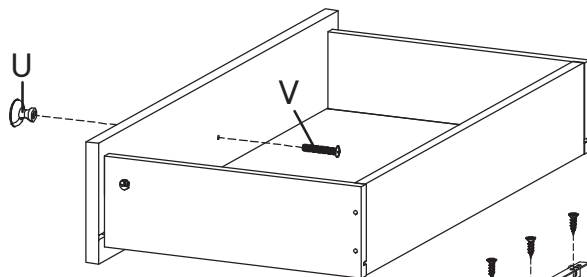
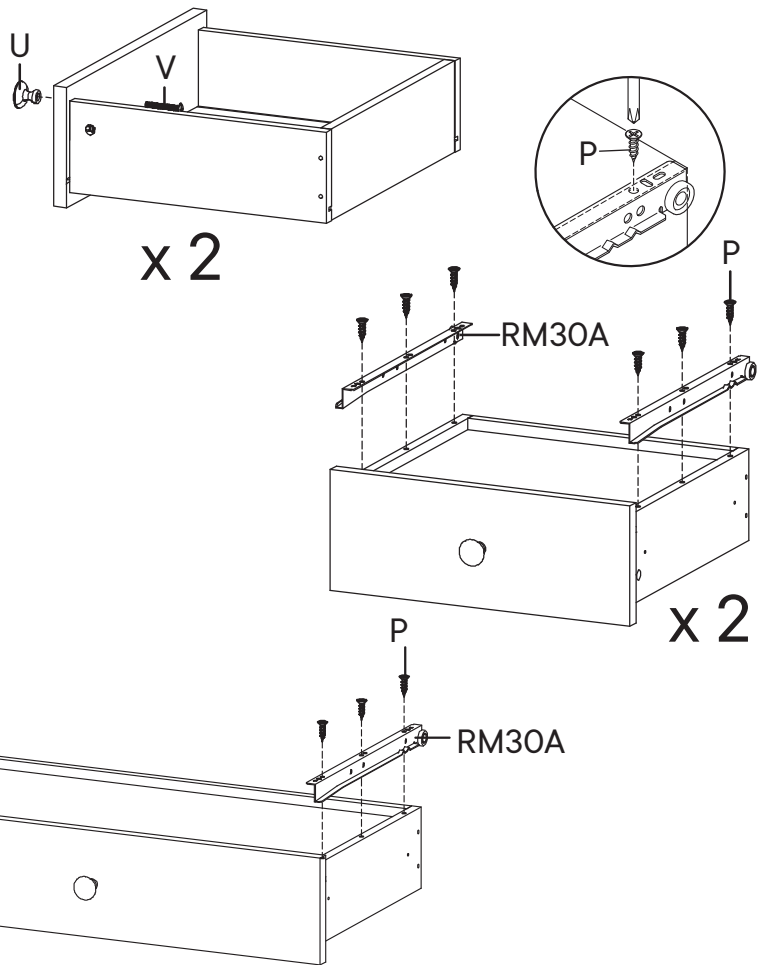

Step 6

HARDWARE

- F** Wedge x14
- N** Screw M 3.5 x 15.5 mm x14

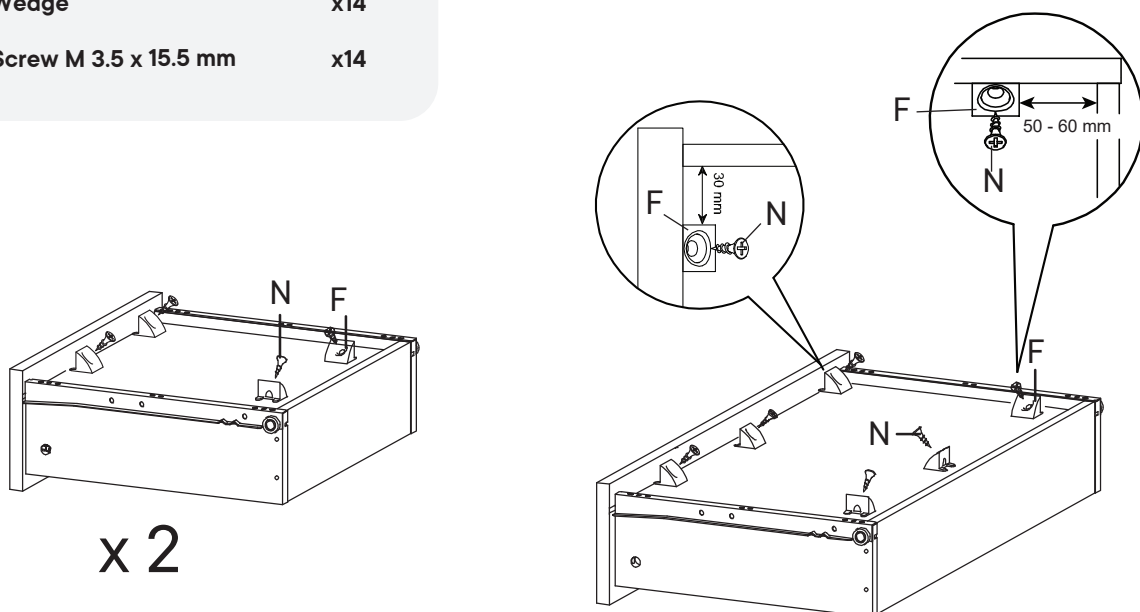

Step 7

HARDWARE

- A** Cam Bolt $\varnothing 6 \times 35$ mm x18
- D** Wood Dowel $\varnothing 8 \times 30$ mm x8

COMPONENTS

- 1** Top Board 1 x1
- 3** Side Board Left x1
- 4** Side Board Right 1 x1

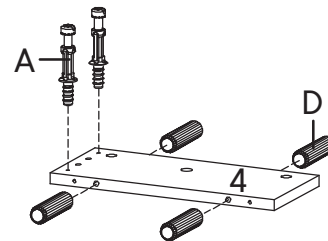
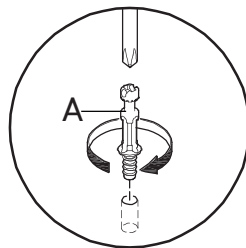
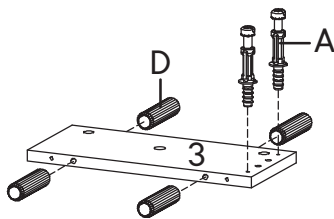
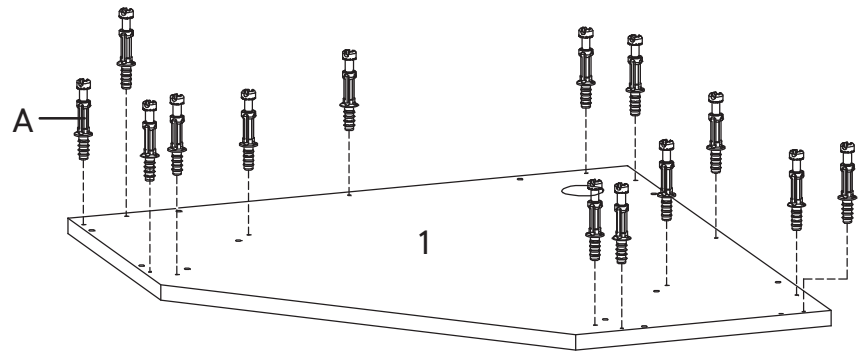

Step 8

HARDWARE

- A** Cam Bolt $\varnothing 6 \times 35$ mm x2
- D** Wood Dowel $\varnothing 8 \times 30$ mm x10

COMPONENTS

- 24** Back Board 2 x1
- 25** Back Board 3 x1

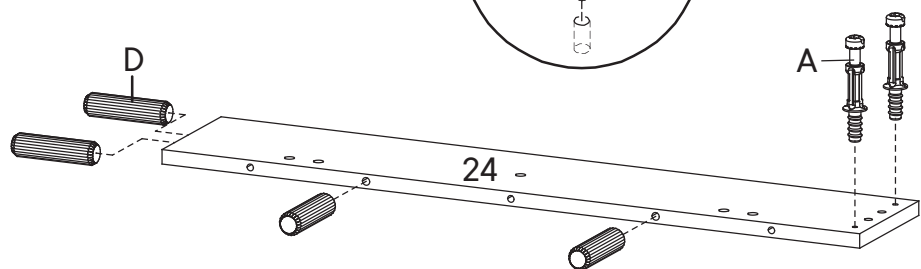
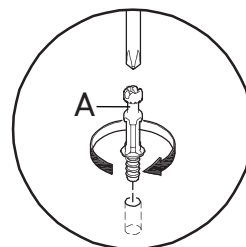
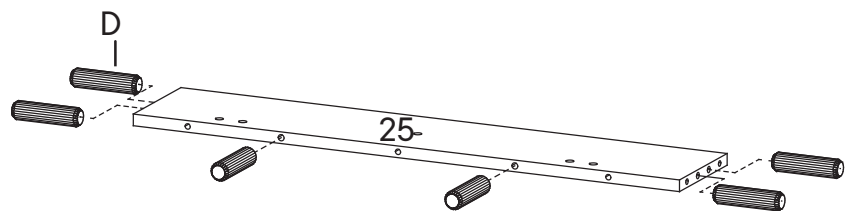

Step 9

HARDWARE

B Cam Lock Ø15 mm x2

COMPONENTS

24 Back Board 2 x1

25 Back Board 3 x1

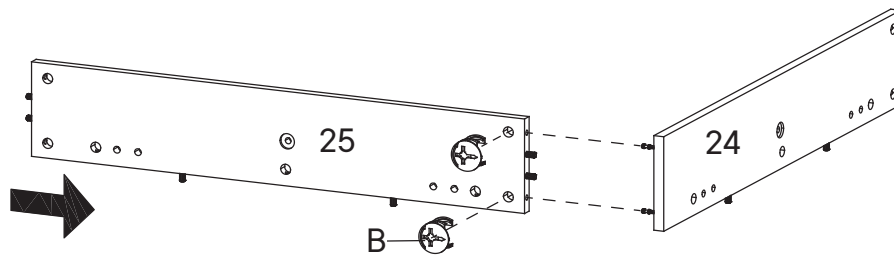
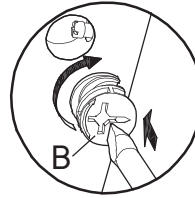

Step 10

HARDWARE

B Cam Lock Ø15 mm x4

COMPONENTS

3 Side Board Left 1 x1

4 Side Board Right 1 x1

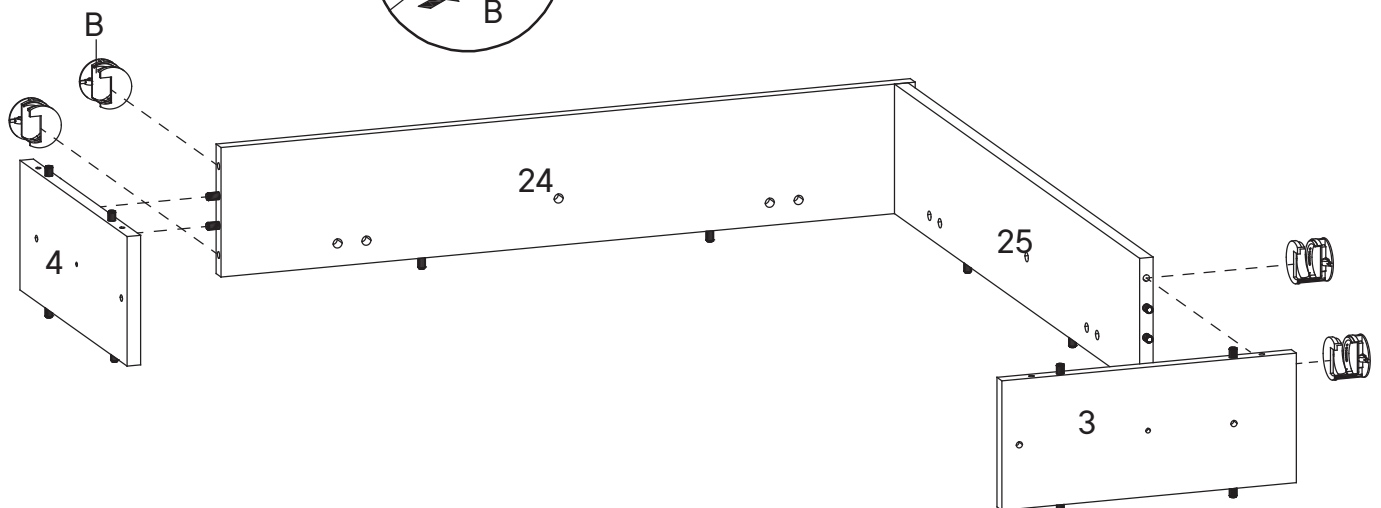
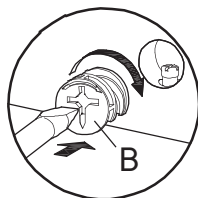

Step 11

HARDWARE

B Cam Lock Ø15 mm x10

COMPONENTS

1 Top Board 1 x1

3 Side Board Left 1 x1

4 Side Board Right 1 x1

24 Back Board 2 x1

25 Back Board 3 x1

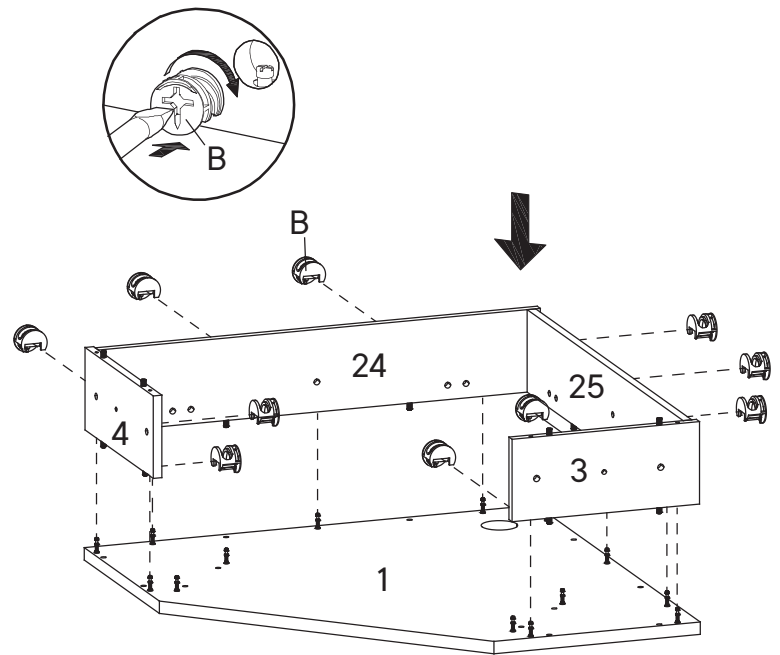

Step 12

HARDWARE

H JCN Nut x8

Q Screw M 6 x 15 mm x8

S Allen Key x2

PA05 Short Bracket x4

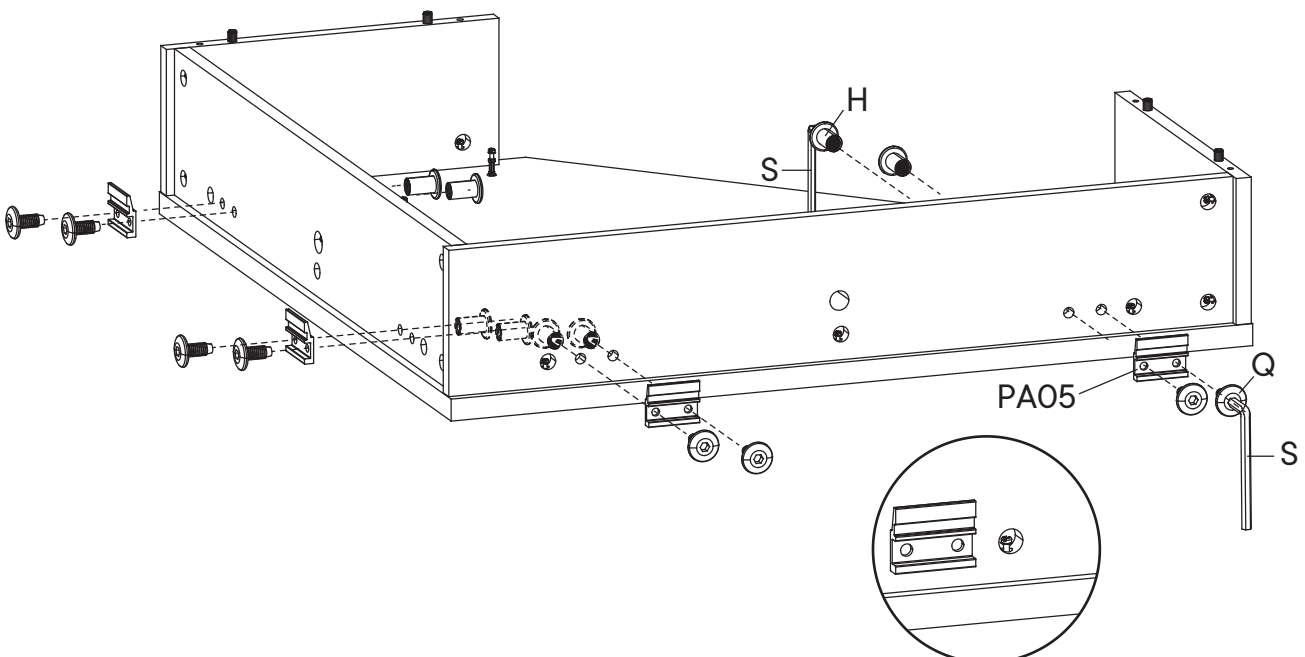
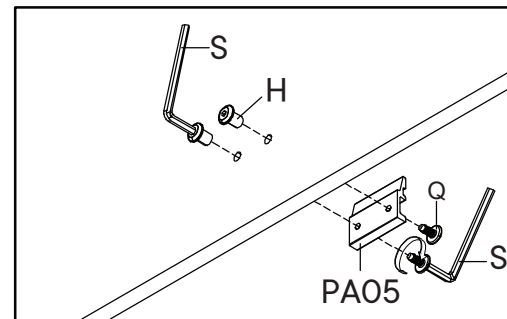

Step 13

HARDWARE

- D** Wood Dowel Ø8 x 30 mm x8
- I** Screw M 6 x 10.5 mm x4
- RM30A** Drawer Runner x1

COMPONENTS

- 5** Center Board Left x1
- 6** Center Board Right x1

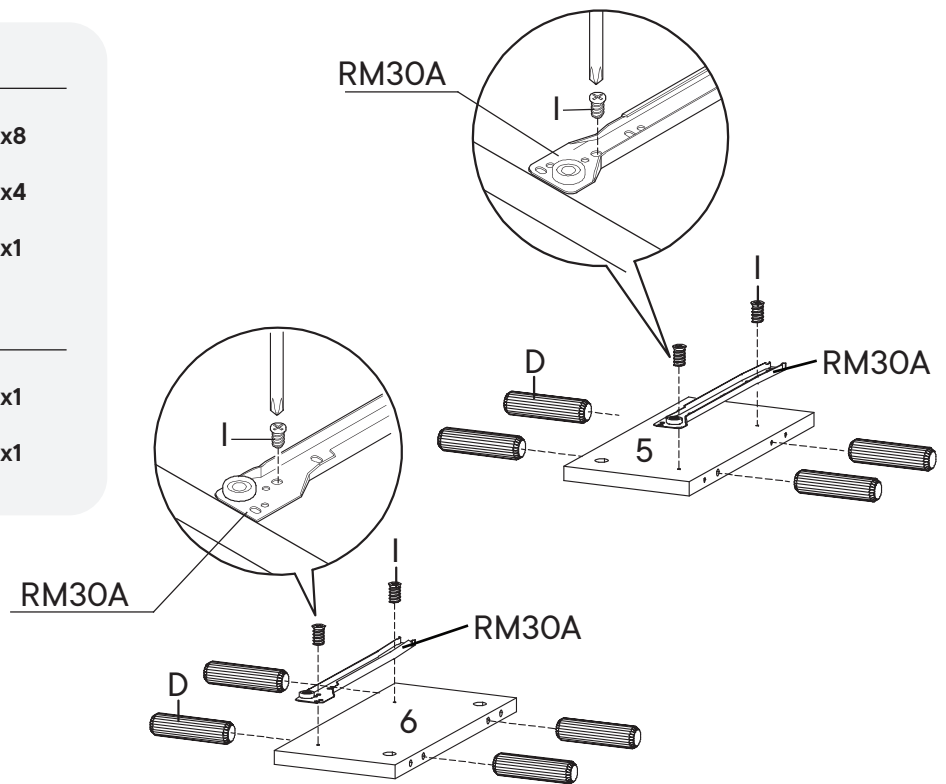

Step 14

HARDWARE

- B** Cam Lock Ø15 mm x4

COMPONENTS

- 5** Center Board Left x1
- 6** Center Board Right x1

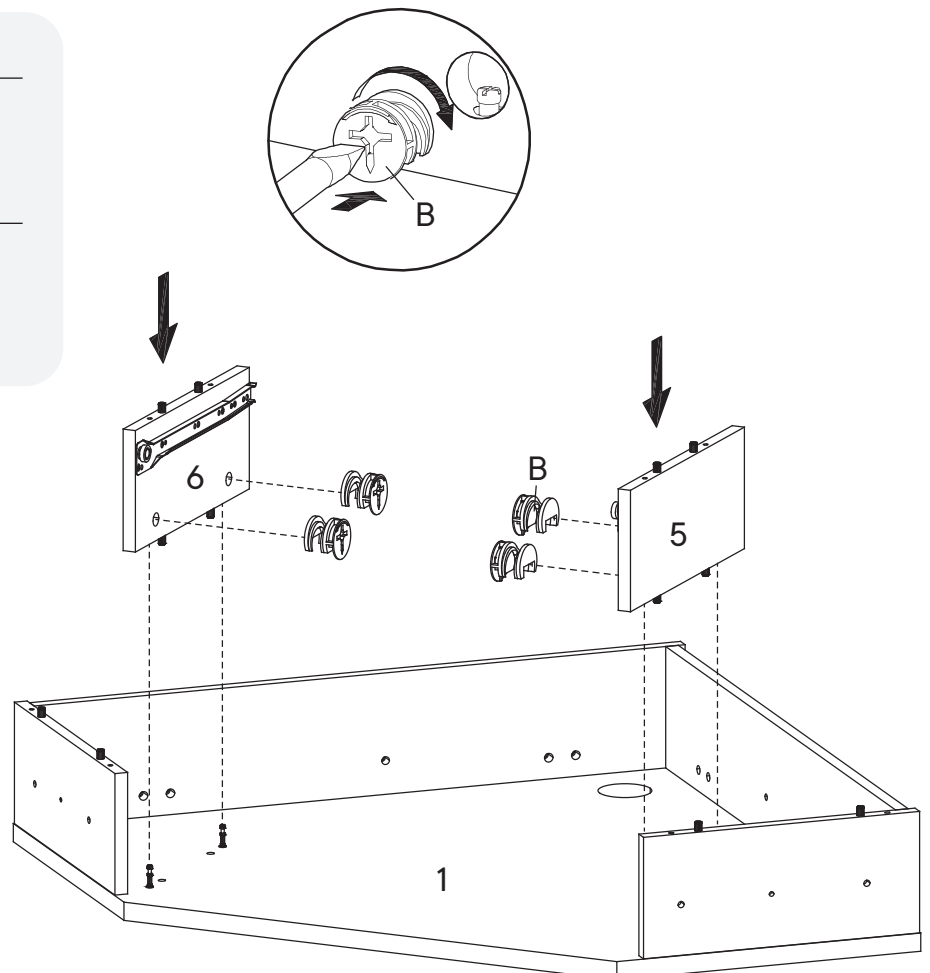

Step 15

HARDWARE

- R** Screw M 7 x 50 mm x8
- S** Allen Key x1

COMPONENTS

- 2** Bottom Board 1 x1

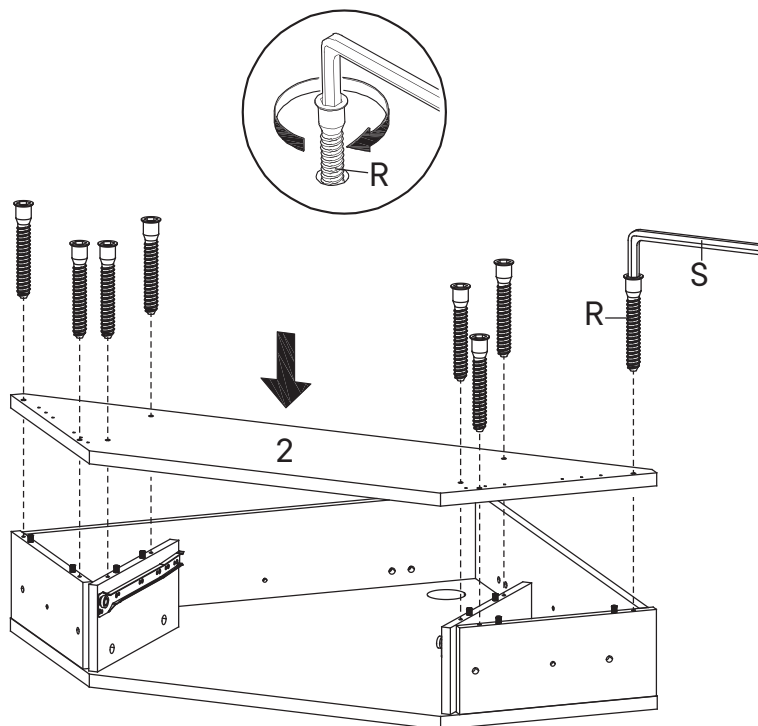

Step 16

HARDWARE

- D** Wood Dowel Ø8 x 30 mm x24

COMPONENTS

- 9** Back Board Left 2 x1
- 10** Back Board Right 2 x1
- 13** Side Board Left 3 x1
- 14** Side Board Right 3 x1
- 15** Back Board 1 x2

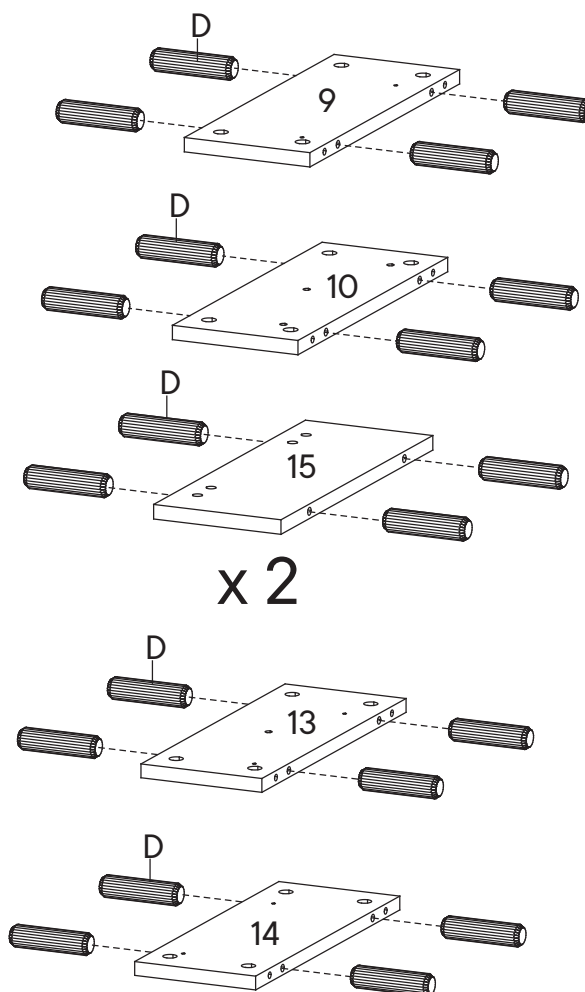

Step 17

HARDWARE

- A** Cam Bolt Ø6 x 35 mm x16

COMPONENTS

- 7** Top Board 2 x1
- 8** Bottom Board 2 x1
- 11** Top Board 3 x1
- 12** Bottom Board 3 x1

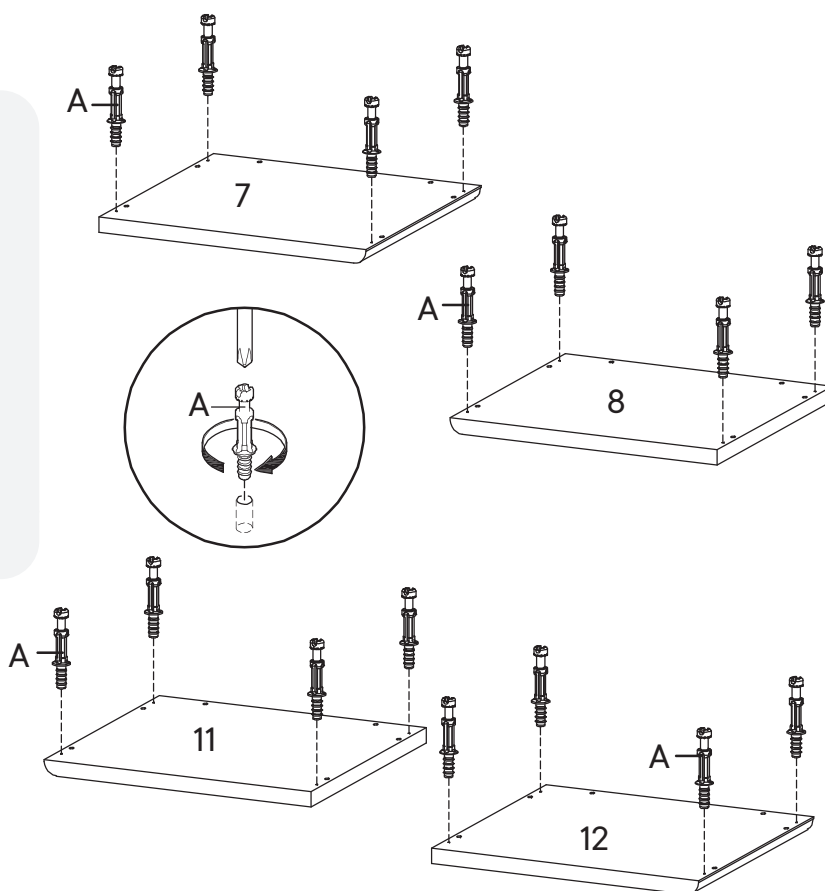

Step 18

HARDWARE

- B** Cam Lock Ø15 mm x8

COMPONENTS

- 8** Bottom Board 2 x1
- 9** Side Board Left 2 x1
- 10** Side Board Right 2 x1
- 12** Bottom Board 3 x1
- 13** Side Board Left 3 x1
- 14** Side Board Right 3 x1
- 15** Back Board 1 x2

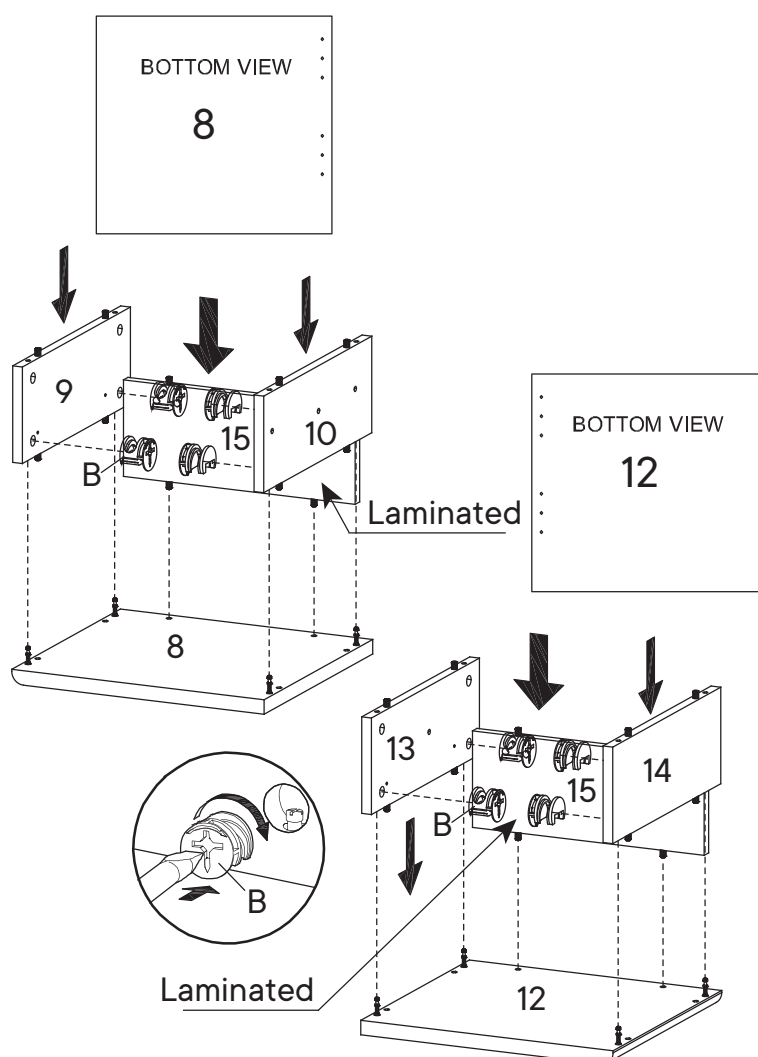

Step 19

HARDWARE

- I** Screw M 6 x 10.5 mm x8
- RM30A** Drawer Runner x2

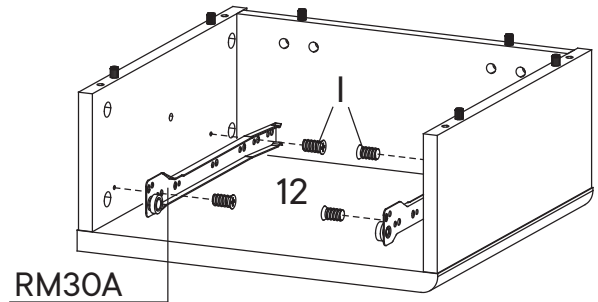
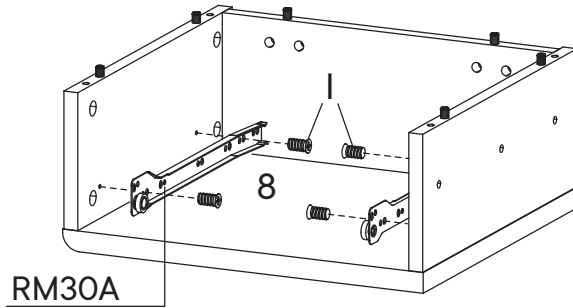
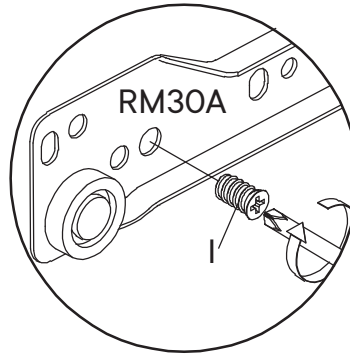

Step 20

HARDWARE

- H** JCN Nut x8
- Q** Screw M 6 x 15 mm x8
- S** Allen Key x2
- PA05** Short Bracket x4

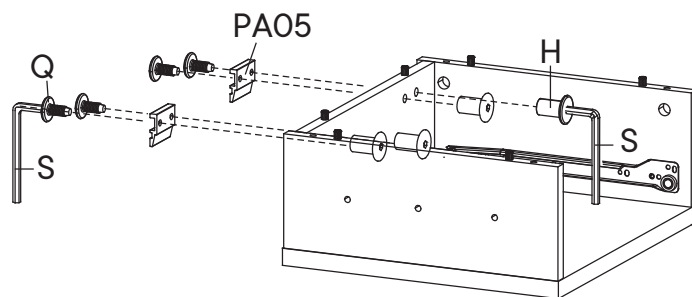
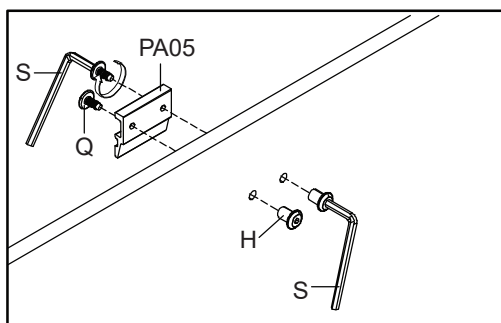
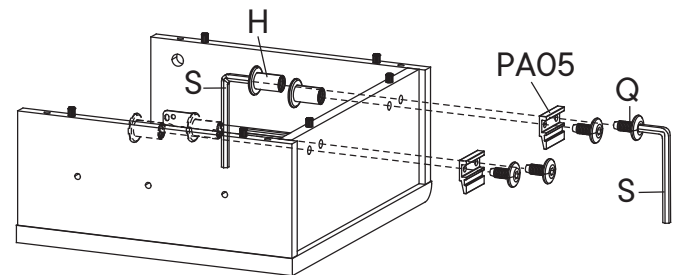

Step 21

HARDWARE

B Cam Lock Ø15 mm x8

COMPONENTS

7 Top Board 2 x1

11 Top Board 3 x1

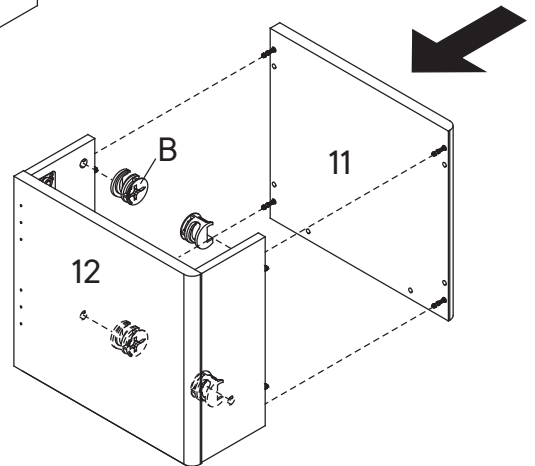
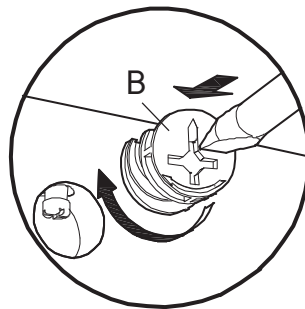
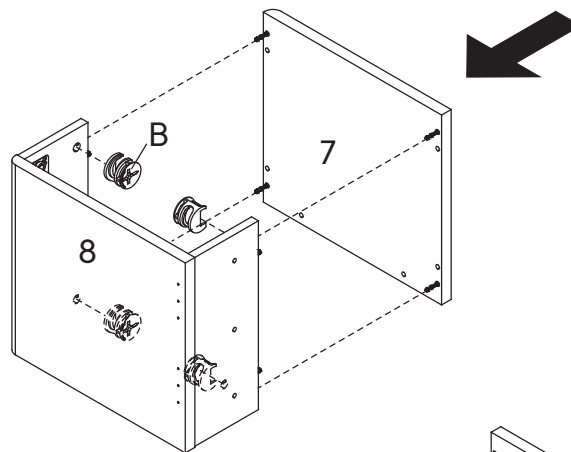

Step 22

HARDWARE

X Wood Dowel Ø8 x 20 mm x4

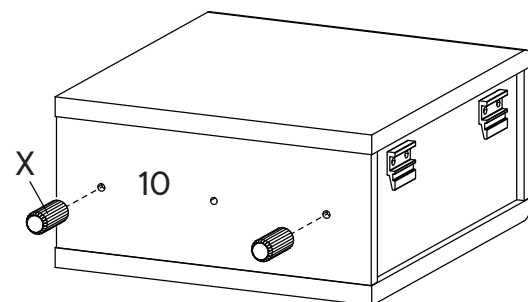
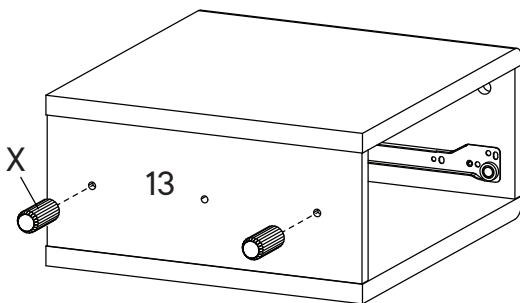

Step 23

HARDWARE

- O** Screw M 6 x 30 mm x2
- S** Allen Key x1

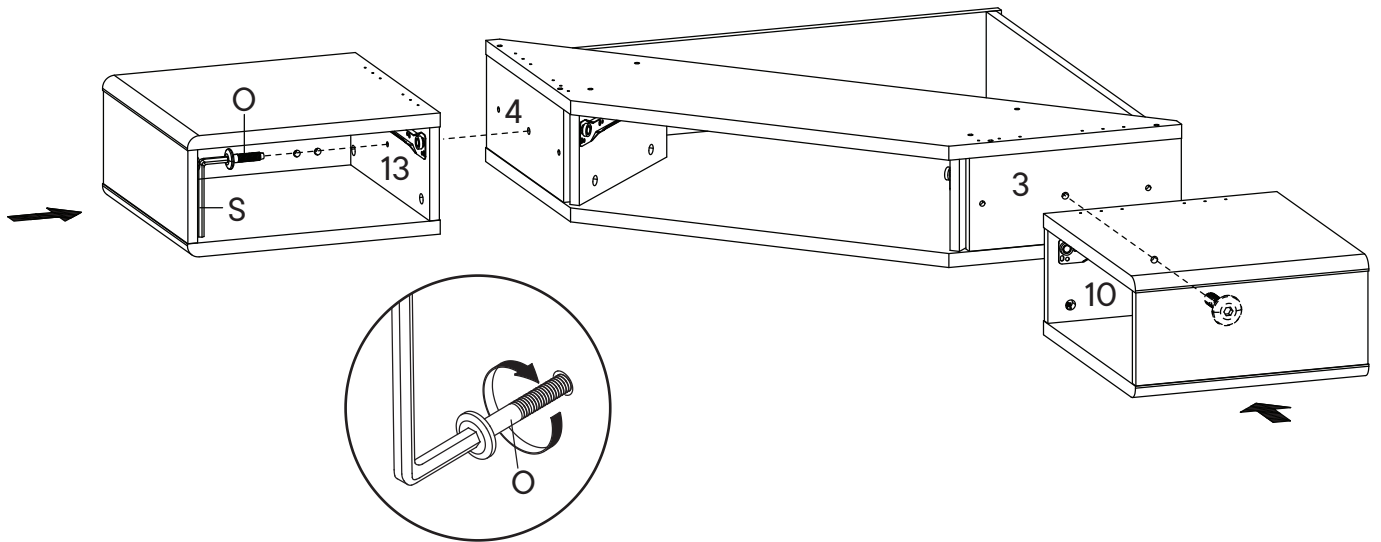

Step 24

HARDWARE

- G** Screw M 4.5 x 12.5 mm x24
- T** Mending Plate x4

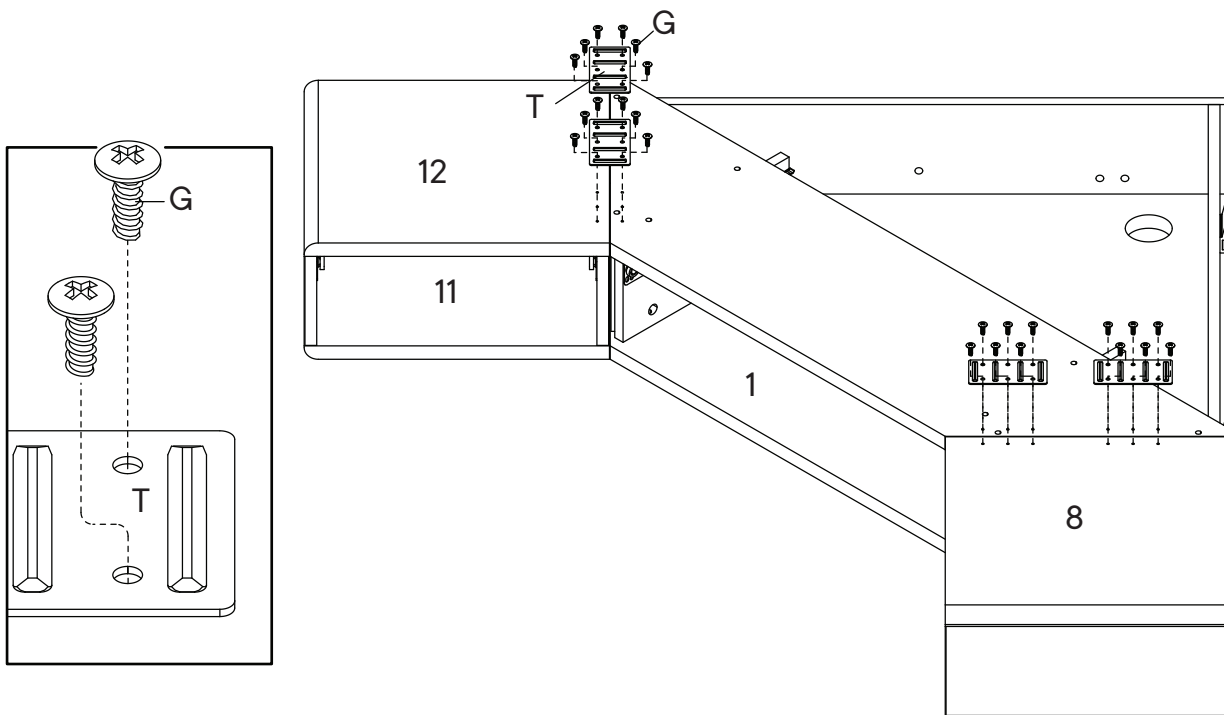

Step 25

Determine your desired (Y) height (760mm recommended), then subtract by 88 mm. This is the drill holes height from the floor (Z).

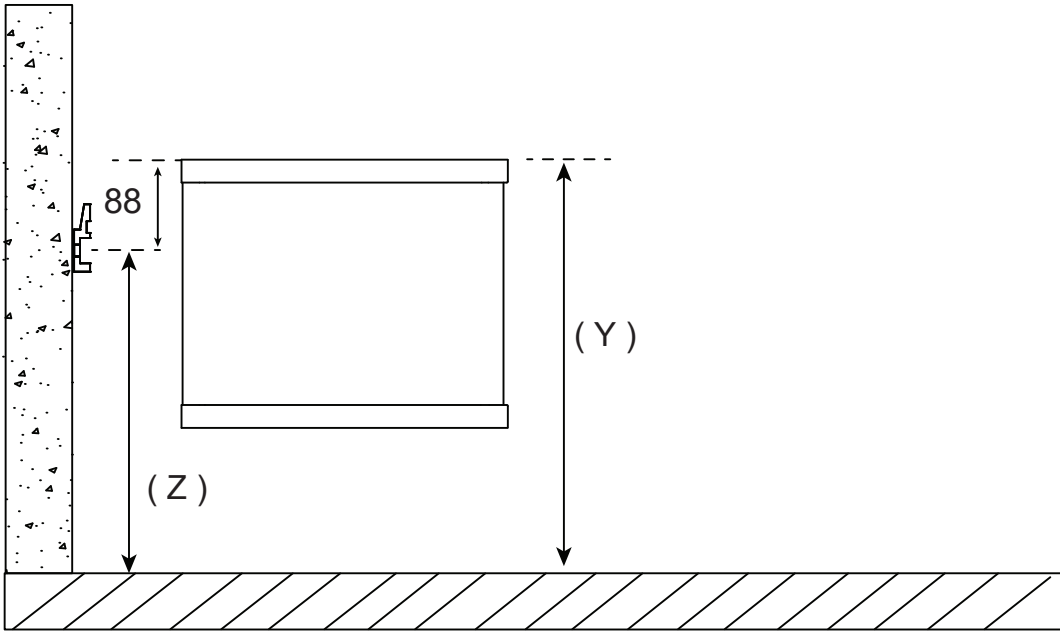

Step 26

Please use minimum 2 holes on Medium Bracket and Long Bracket, and minimum 1 hole, to apply the wall plug and screw. Use additional holes when necessary.

* Long Bracket and Medium Bracket

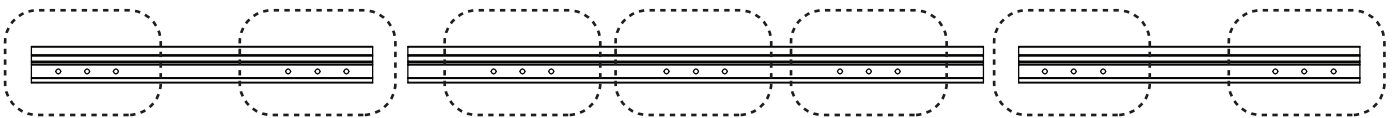

Different wall materials require unique wall fasteners.

The wall plugs (K) and screws (L) are designed for fixing to concrete walls only.

Please consult your local hardware store to ensure you are using the correct hardware for your wall type.

Step 27

HARDWARE

- K** Wall Plug x14
- L** Screw 5.5 x 45 mm x14
- PA69** Long Bracket x2
- PA34** Medium Bracket x2

Use Waterpass to ensure the drill position

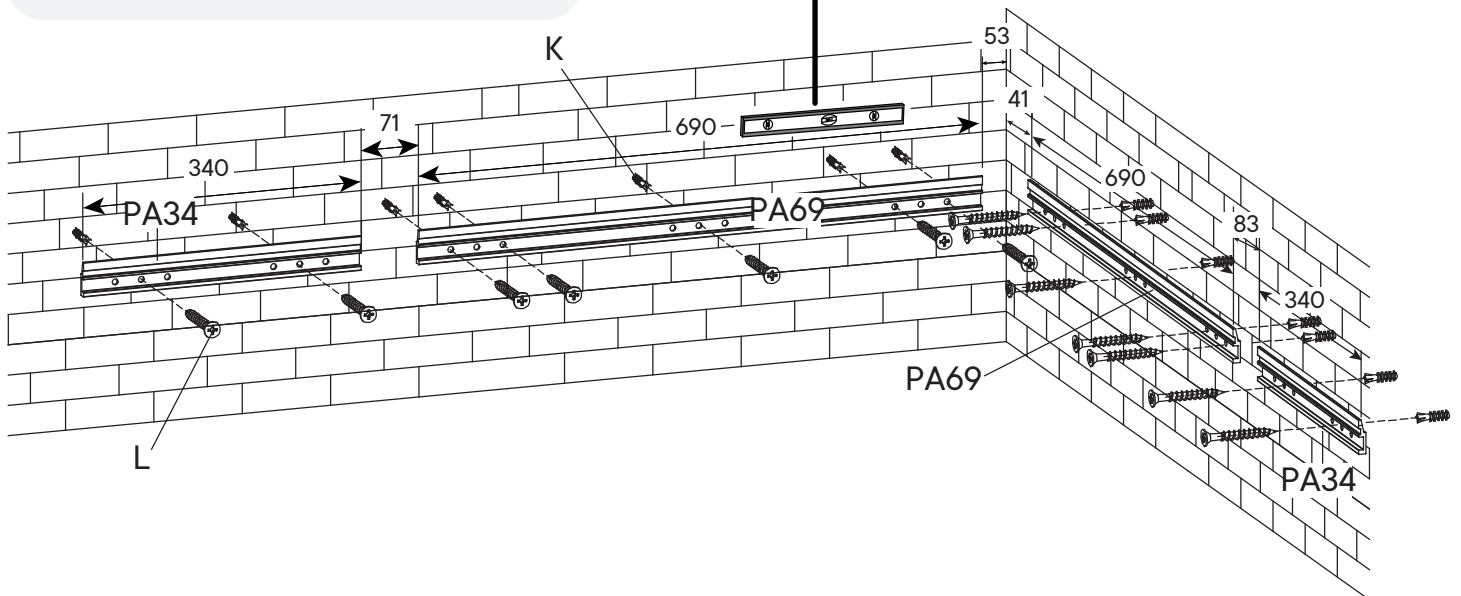

Step 28

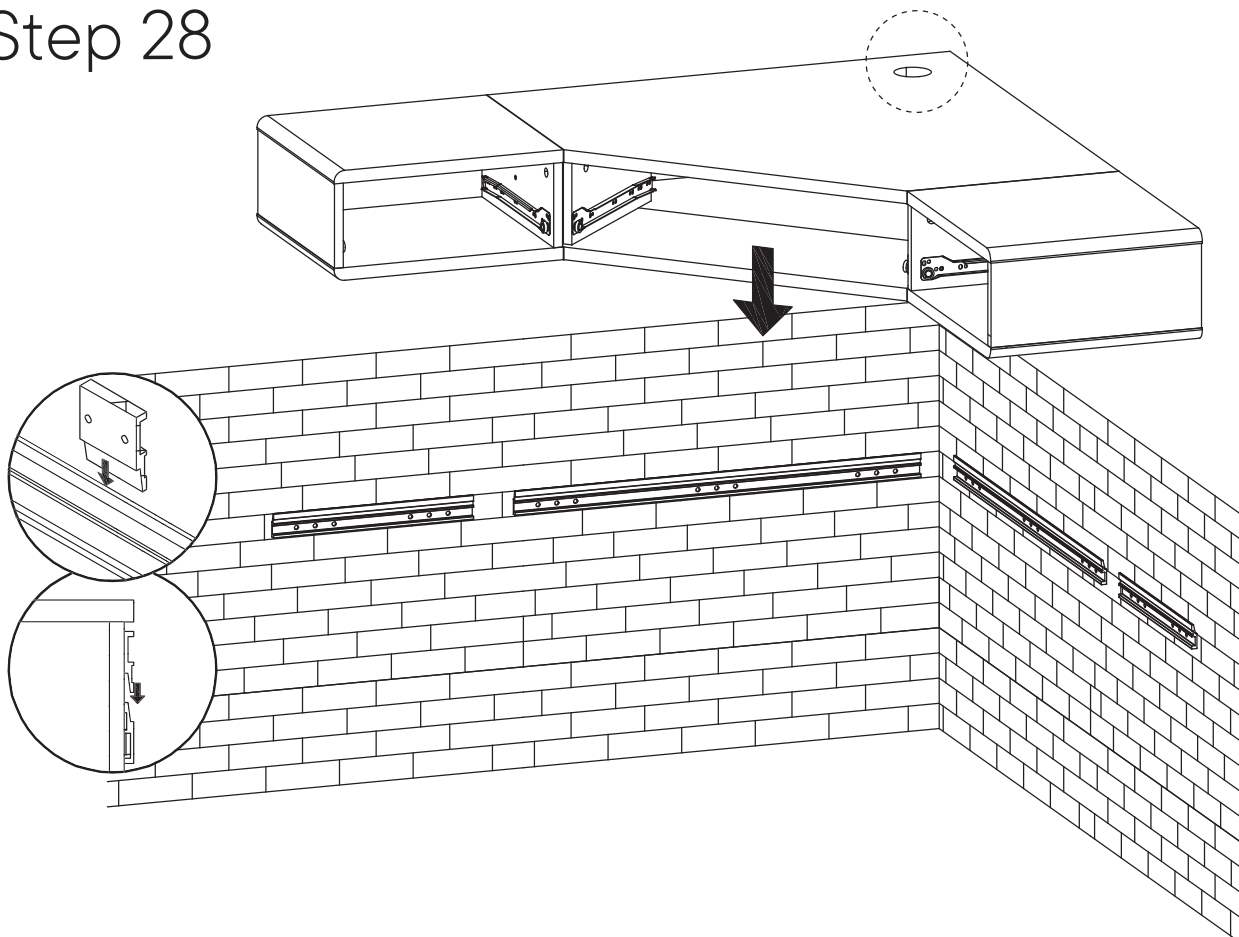

Step 29

HARDWARE

W Wall Mounted Bolt x2

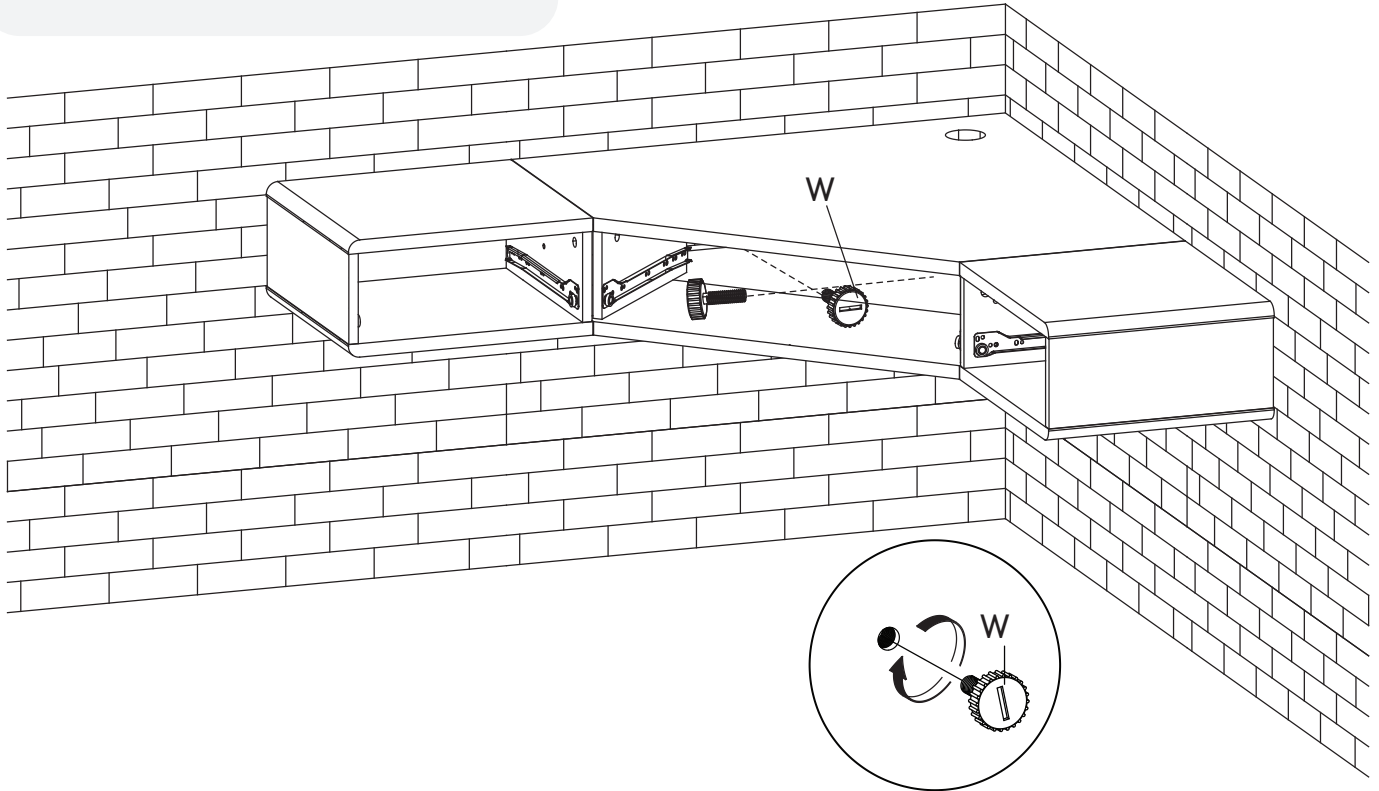

Step 30

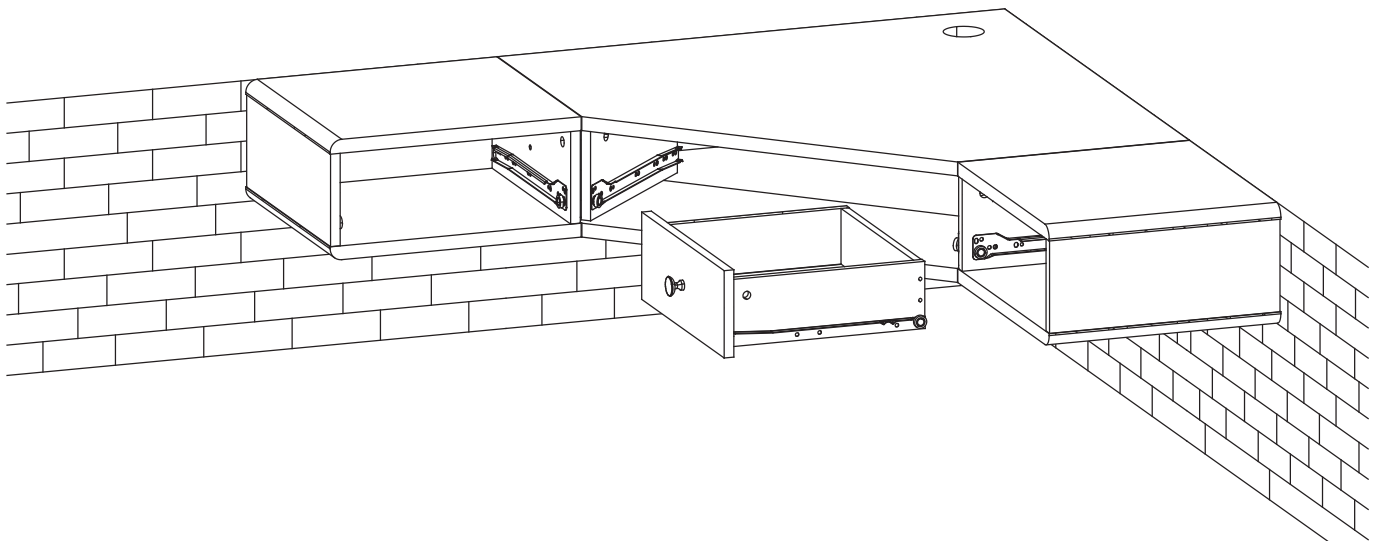
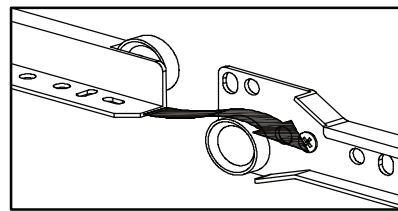

Step 31

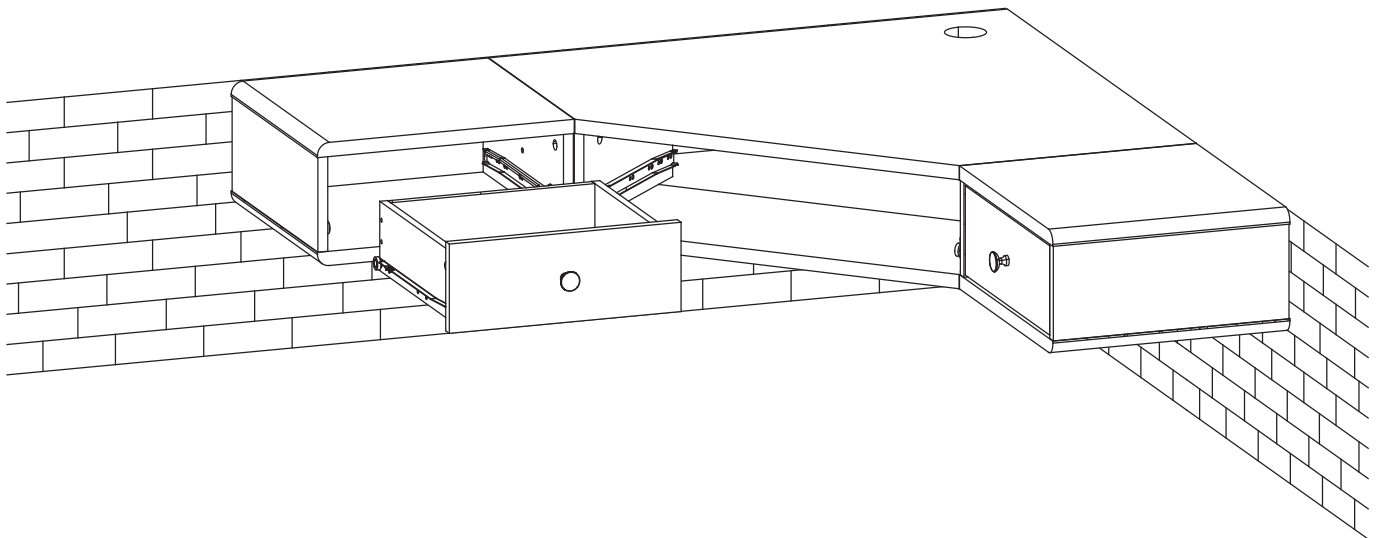
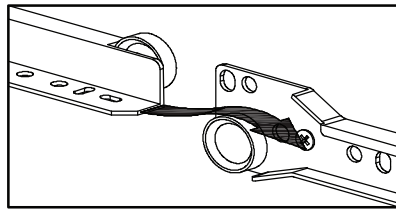

Step 32

HARDWARE



Grommet Cover

x1

M

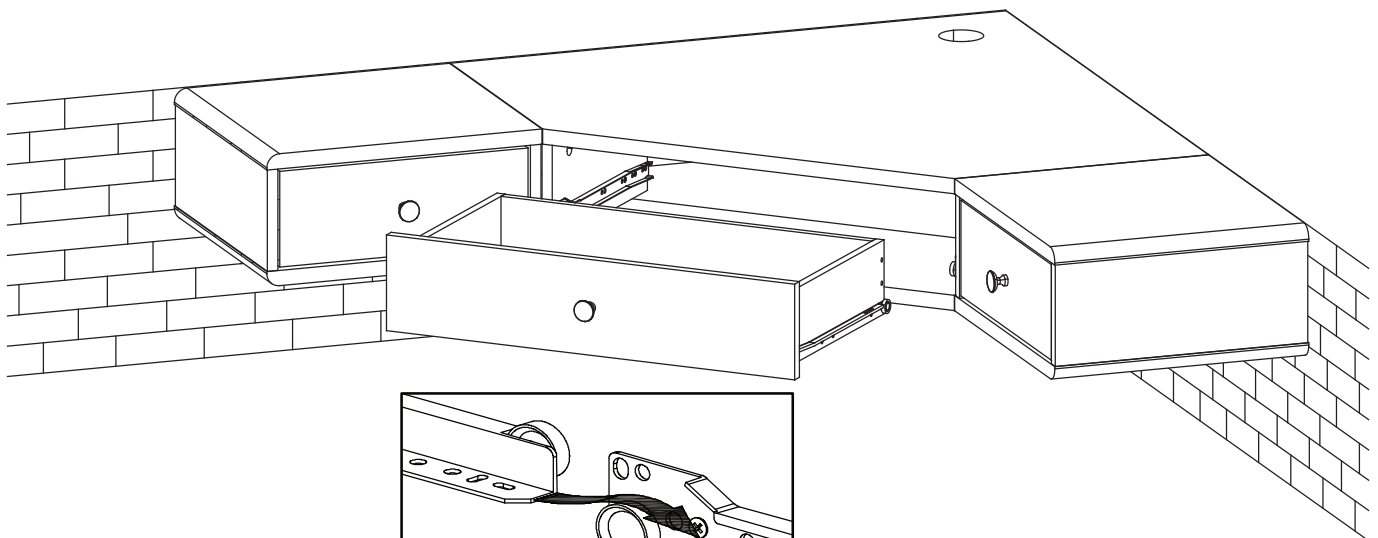

Great job!

Desk assembly is complete.

♥ CARING FOR YOUR ITEM

Indoor use only.

Not contract grade.

Clean using a non-abrasive cloth and a mild cleaner.

Never use harsh chemicals, as they could damage the finish or integrity of the item.

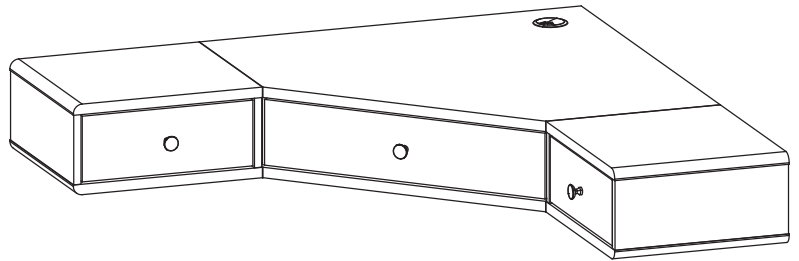

CONNECT WITH US!   

Tag us @modway_furniture and #modway for a chance to be featured.