

Thank you for purchasing the **MODWAY TV STAND** !

Before you start, here are some helpful advice:

1. We suggest you spend a short time reading through this leaflet and then follow the simple step-by-step instructions.
2. Owing to the size and weight of the TV Stand, we recommend that it is assembled by two adults, on a carpeted or padded area, in the room that it is intended for. Approximate assembly time: 60 minutes.
3. Please do not use any tools other than those provided or recommended in these instructions.
4. Please do not throw away any of the packaging or instructions until you have checked all the components and hardware and the furniture is fully assembled.
5. Assemble all components loosely until advised to tighten. Depending on use, it may be necessary to tighten the components from time to time, so please save the tools that have been provided.
6. Please keep all pieces out of reach of children.

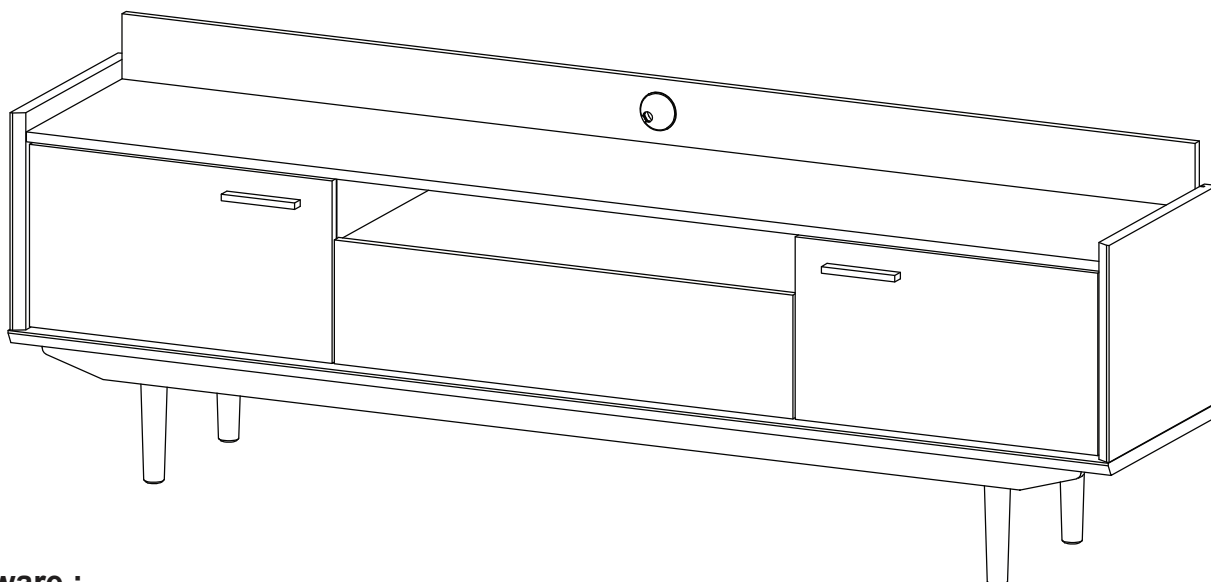

## Hardware :

<b>A)</b> Cambolt/Metal  $\varnothing$ 6 x 35 mm x 17	<b>B)</b> CamLock Big/Metal  $\varnothing$ 15 mm x 15	<b>C)</b> CamLock Small/Metal  $\varnothing$ 12 mm x 2	<b>D)</b> Dowel Big/Wood  $\varnothing$ 8 x 30 mm x 20	<b>E)</b> Dowel Small/Wood  $\varnothing$ 6 x 30 mm x 6
<b>F)</b> Screw/Metal  M 7 x 50 mm x 8	<b>G)</b> Key/Metal  L 4 x 1	<b>H)</b> Shelf Pin/Metal  $\varnothing$ 5 x 15 mm x 8	<b>I)</b> Screw/Metal  M 3.5 x 22 mm x 4	<b>J)</b> Screw/Metal  M 4 x 19 mm x 16
<b>K)</b> Screw Cup/Plastic  $\varnothing$ 15 mm x 4	<b>L)</b> Buffer/Rubber  $\varnothing$ 8 mm x 4	<b>M)</b> Screw/Metal  M 8 x 39 mm x 4	<b>N)</b> Plat Mitres/Metal  80 x 65 mm x 4	<b>O)</b> Wedge/Plastic  9 x 14 x 10 mm x 10
<b>P)</b> Screw/Metal  M 3.5 x 15.5 mm x 10	<b>Q)</b> Anti-Deflection Bar/Metal  x 1	<b>R)</b> Rail/Metal  x 1	<b>S)</b> Hinge/Metal  84 x 51 x 29 mm x 4	<b>T)</b> Screw/Metal  M 3.5 x 13 mm x 14
<b>U)</b> Screw/Metal  M 6 x 10.5 mm x 34	<b>V)</b> Screwdriver (Not Include)  x 1			

## Components:

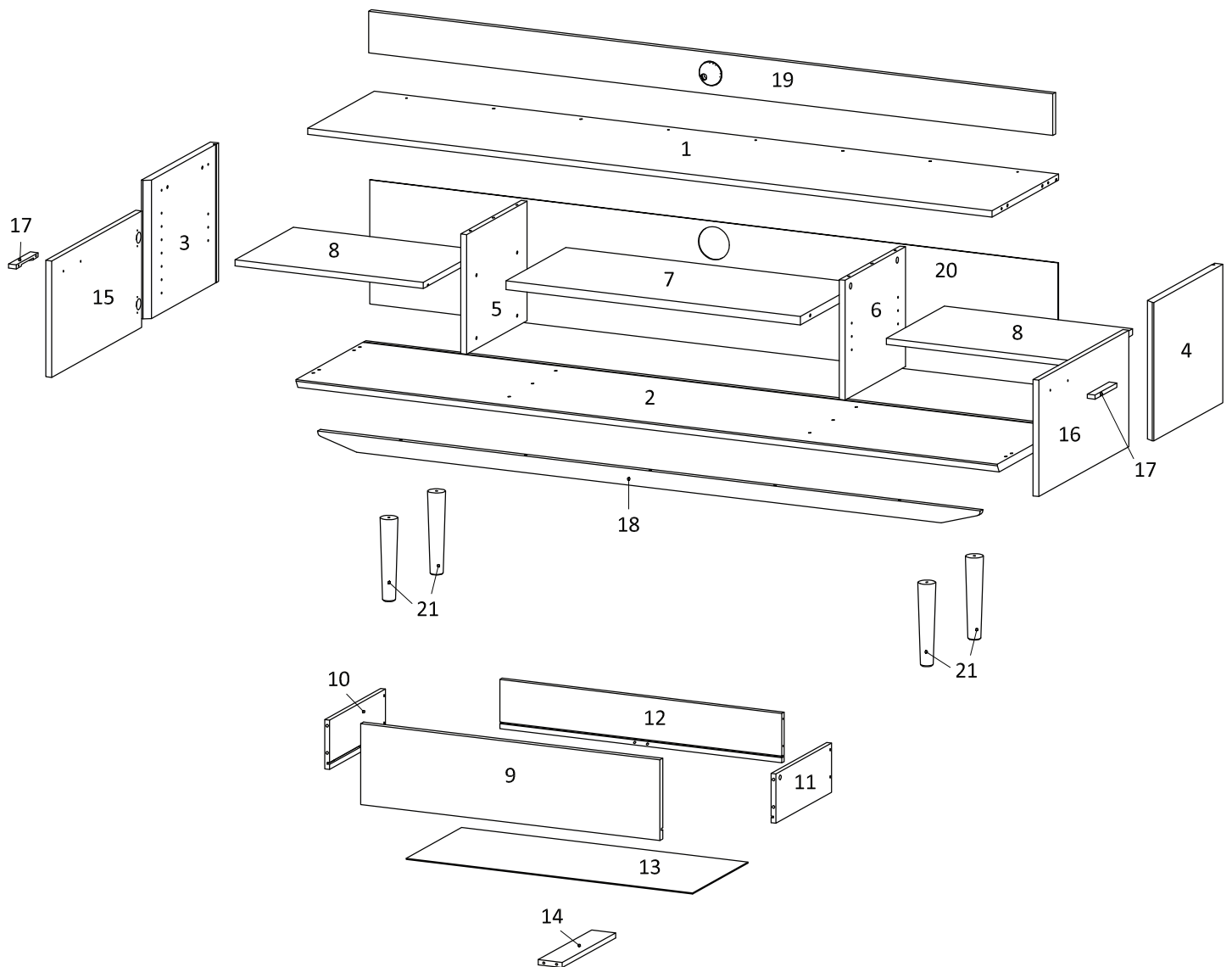

1	Top Board	x1	2	Bottom Board	x1	3	Side Board Left	x1	4	Side Board Right	x1
5	Centre Board Left	x1	6	Centre Board Right	x1	7	Fixed Shelf	x1	8	Adjustable Shelf	x2
9	Front Drawer	x1	10	Side Drawer Left	x1	11	Side Drawer Right	x1	12	Back Drawer	x1
13	Bottom Drawer	x1	14	Support Drawer	x1	15	Wooden Door Left	x1	16	Wooden Door Right	x1
17	Handle	x2	18	Front Skirt	x1	19	Support Board	x1	20	Back Board	x1
21	Leg	x4									

## STEP 1:

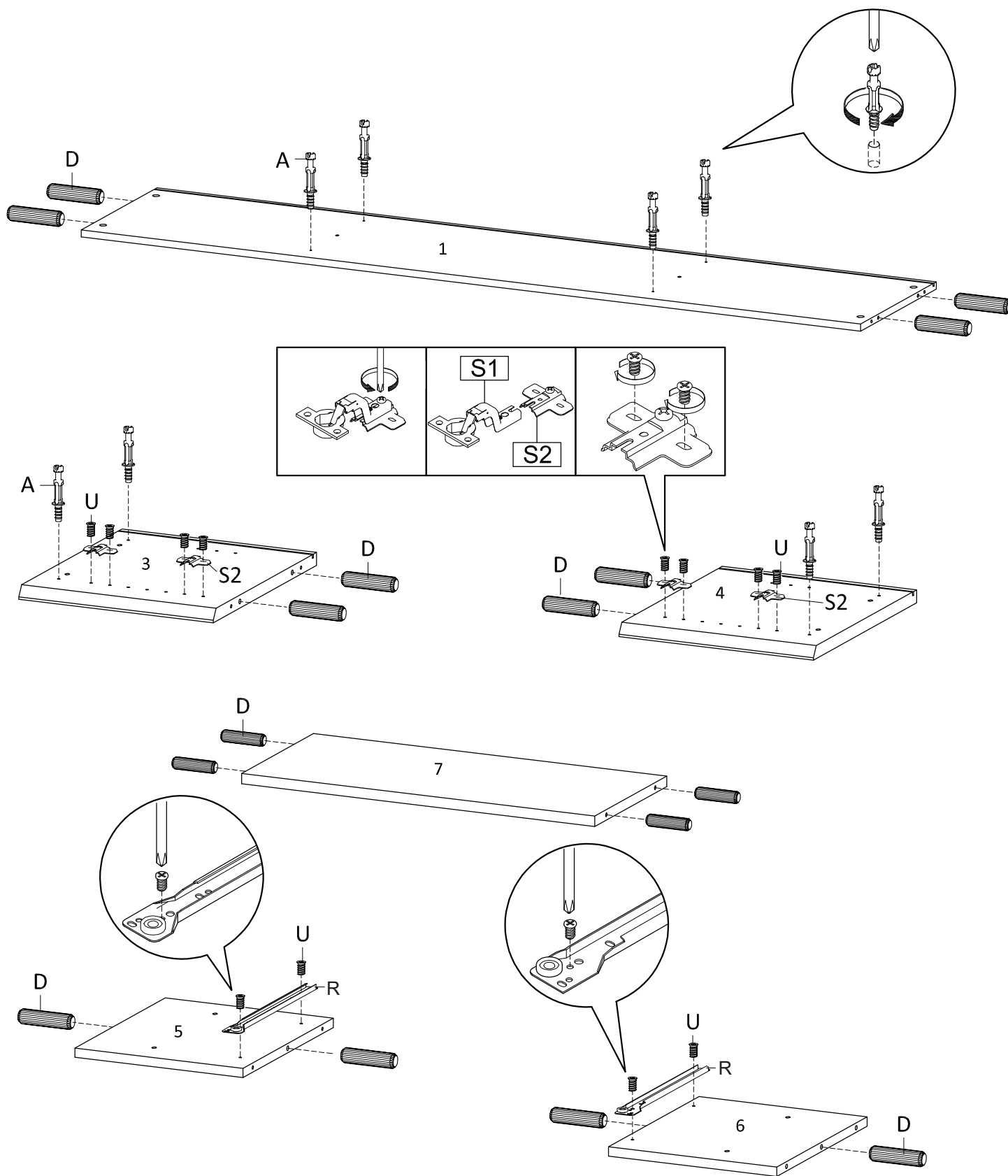

Hardware required.  
Screwdriver not included

					
Ax8	Dx16	Sx4	Ux12	Rx1	Vx1

## STEP 2:

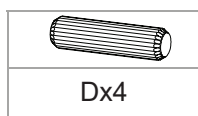
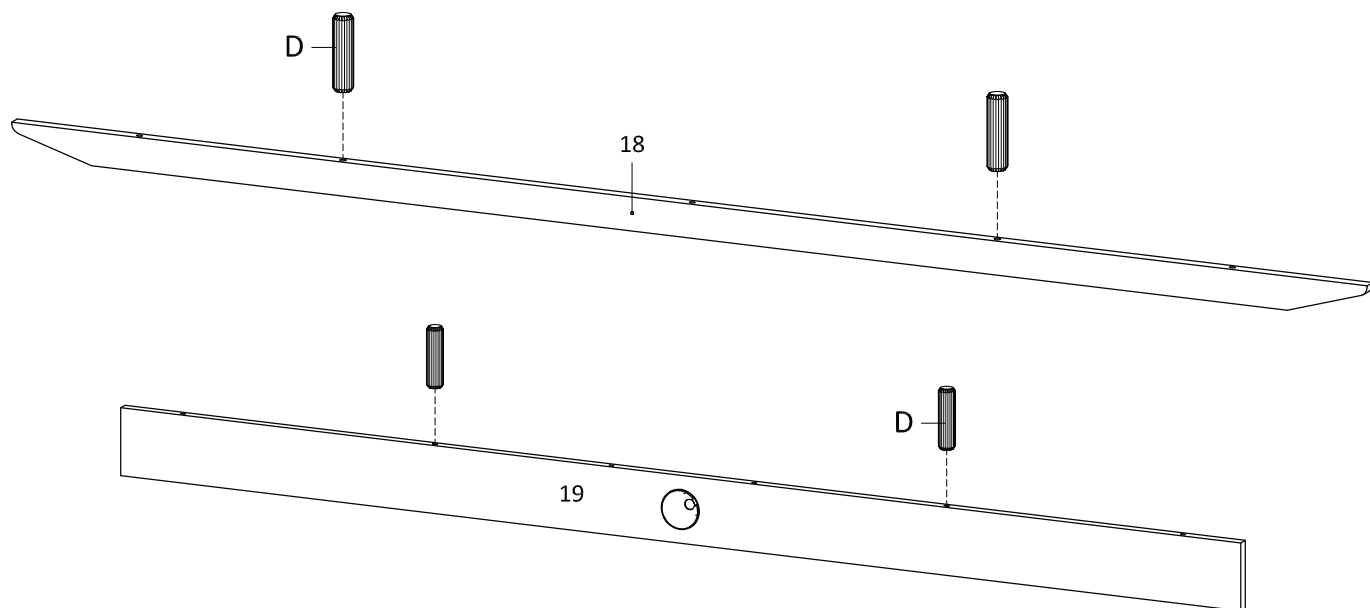

Dx4

Hardware required.

## STEP 3:

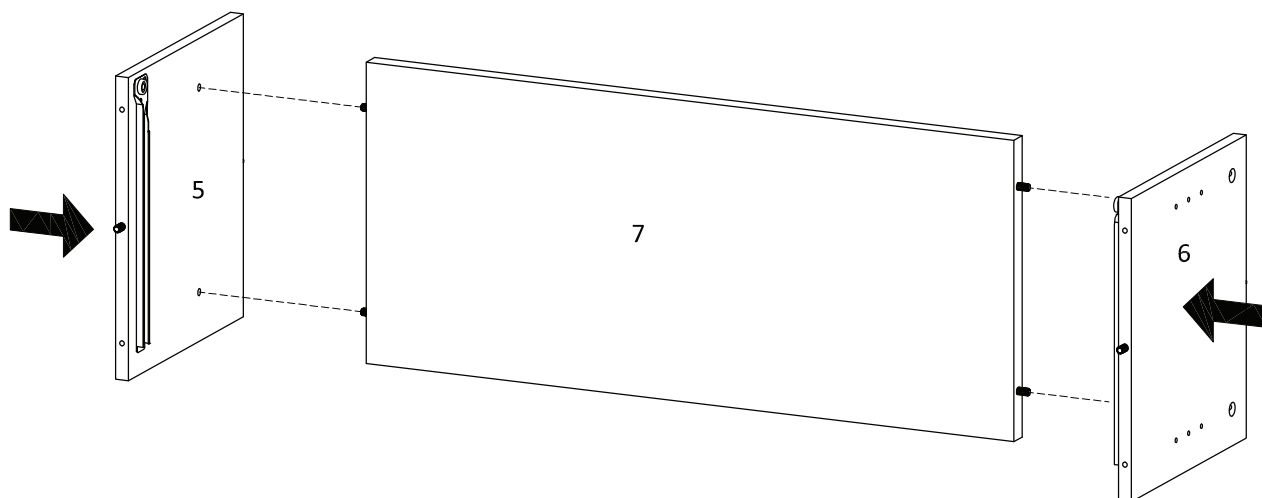

## STEP 4:

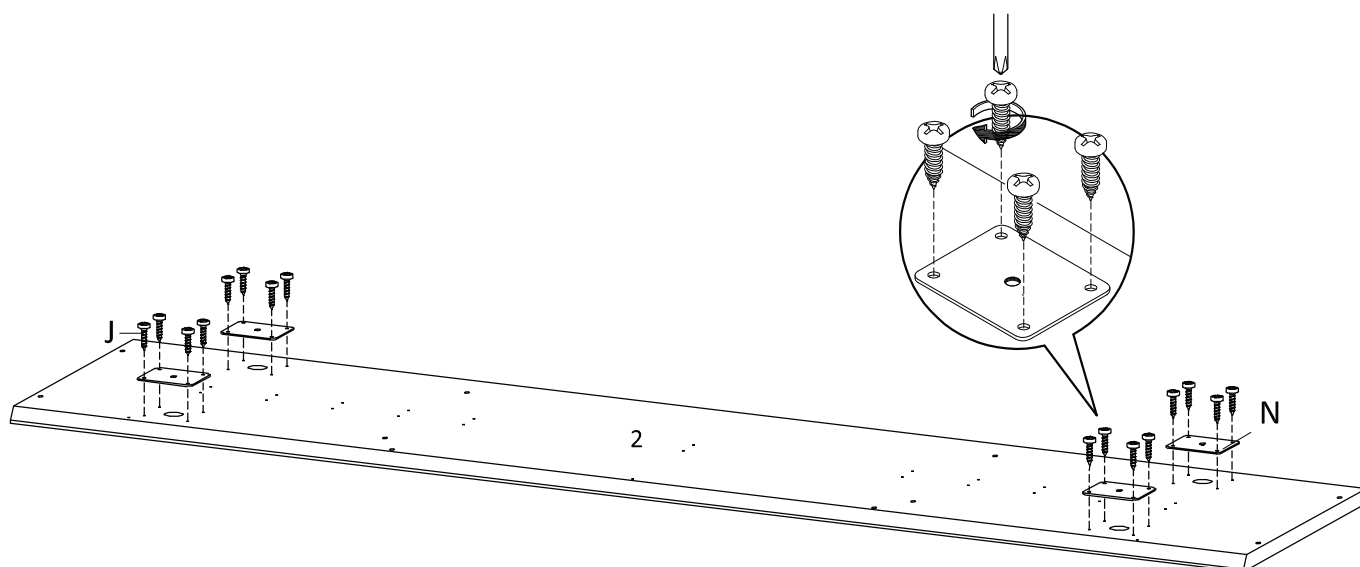

Jx16	Nx4	Vx1

Hardware required.  
Screwdriver not included

## STEP 5:

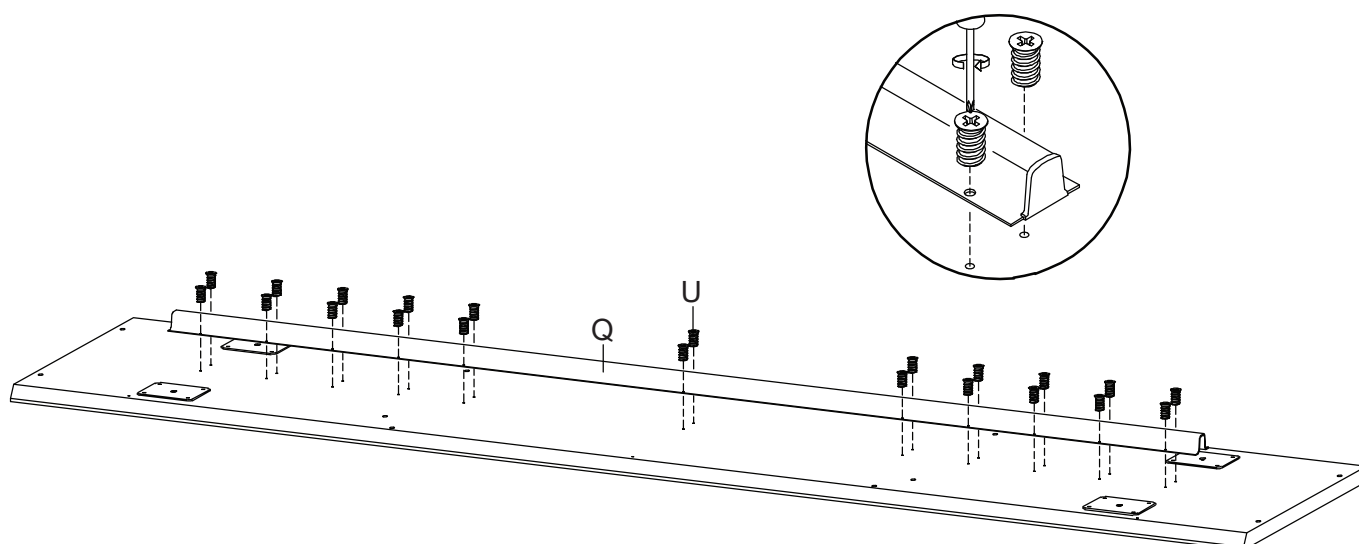



Qx1	Ux22	Vx1

Hardware required.  
Screwdriver not included

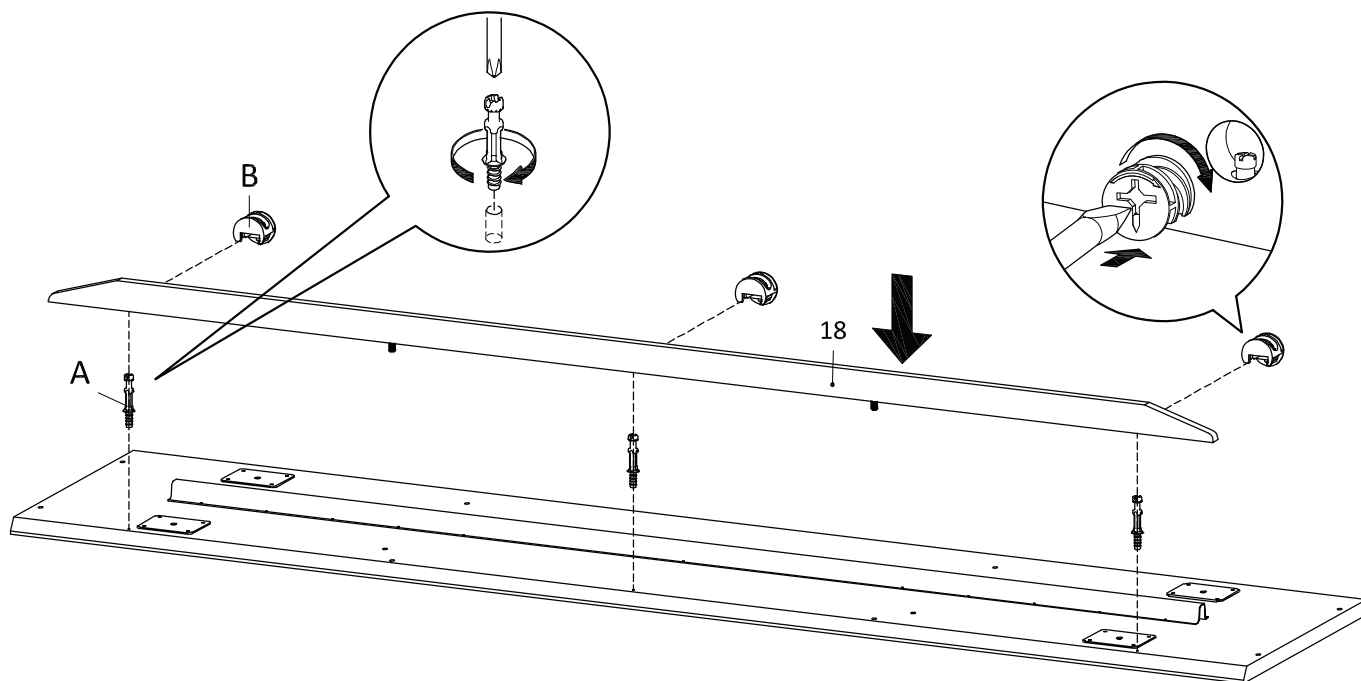
## STEP 6:



		
Ax3	Bx3	Vx1

Hardware required.  
Screwdriver not included

## STEP 7:

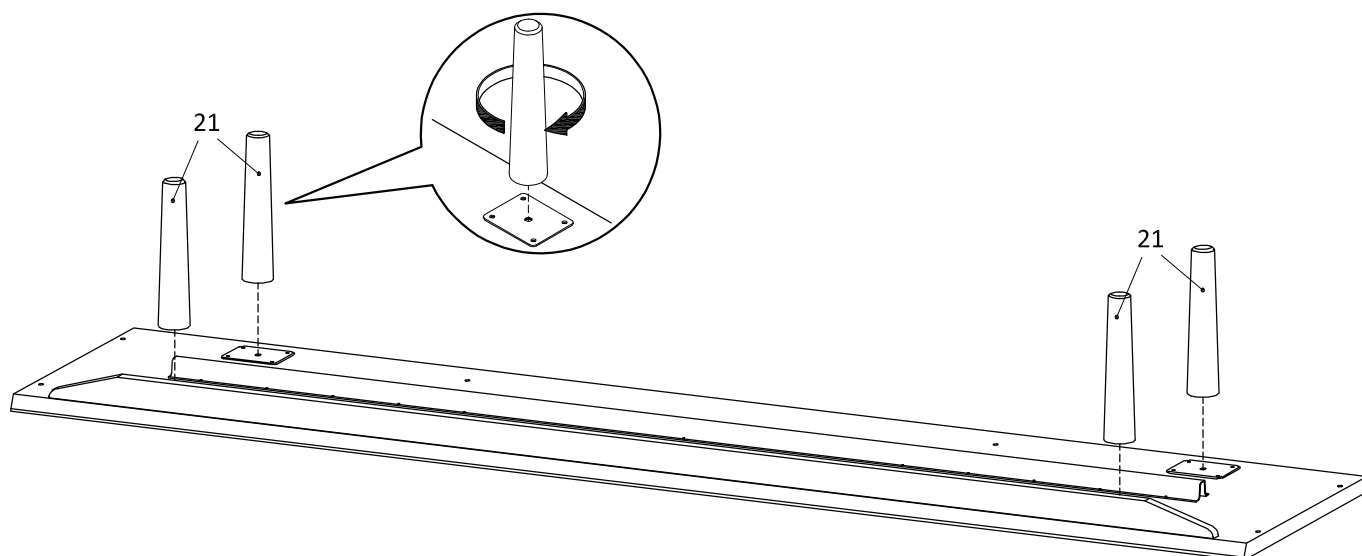

## STEP 8:

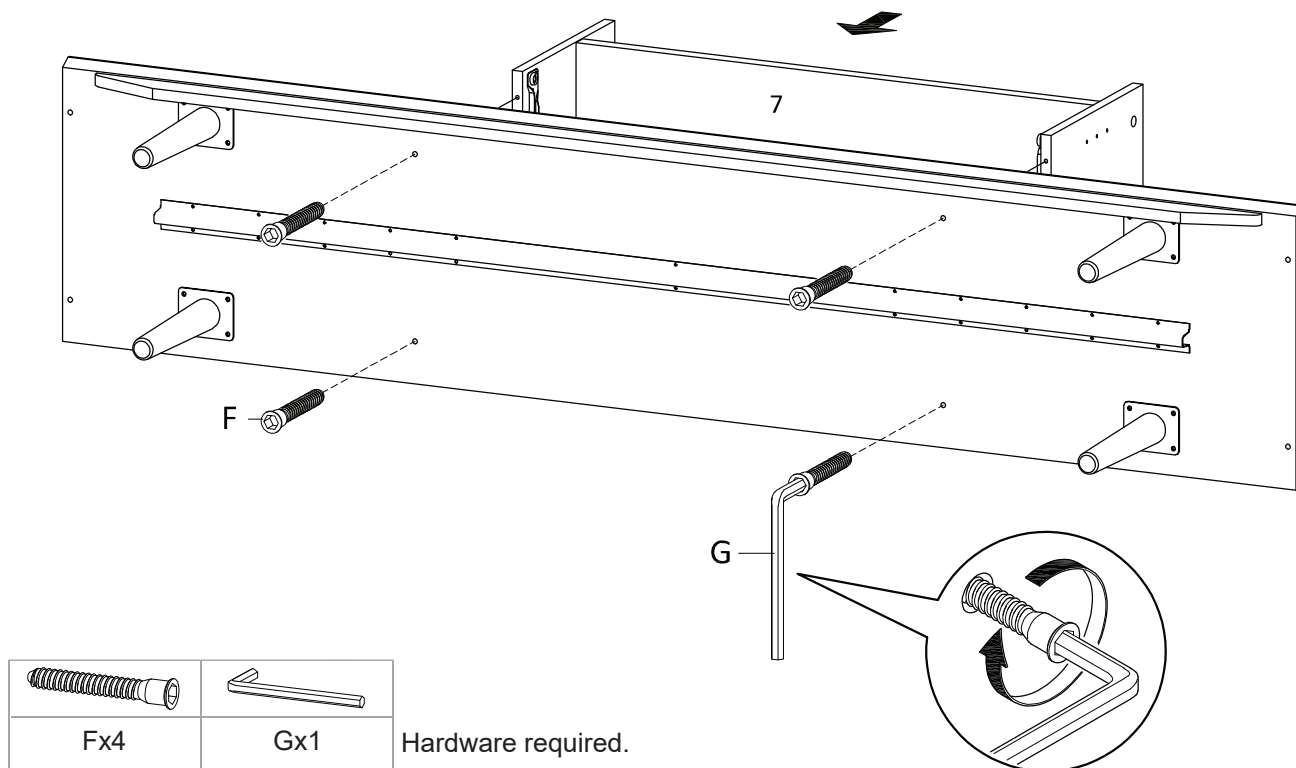

## STEP 9:

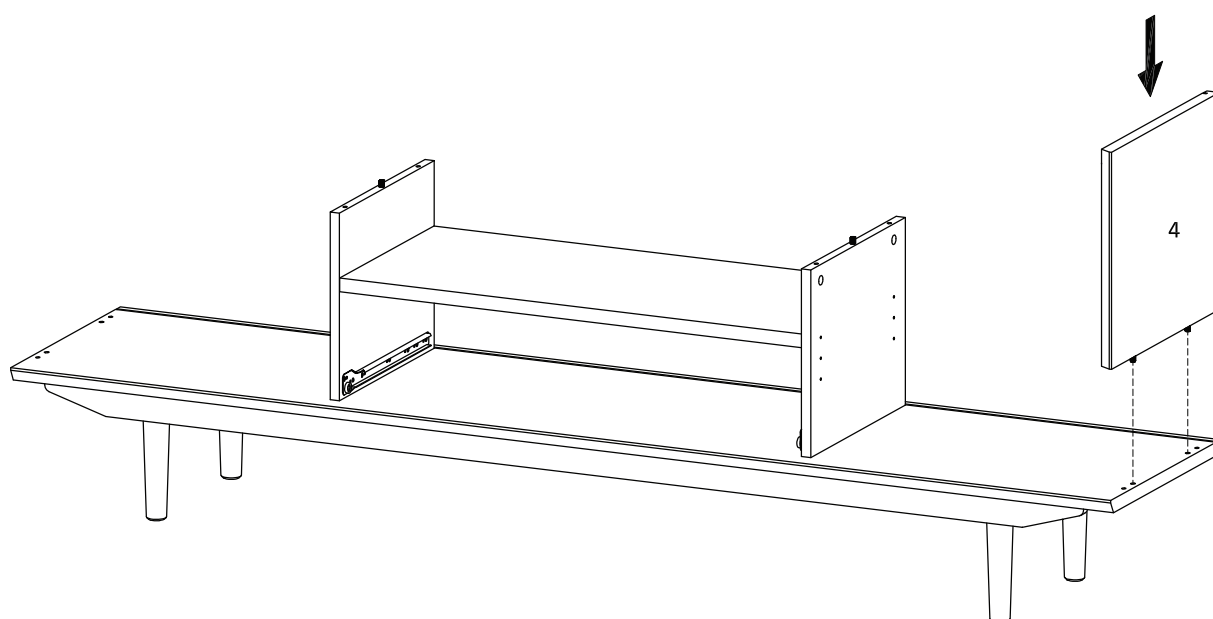

## STEP 10:

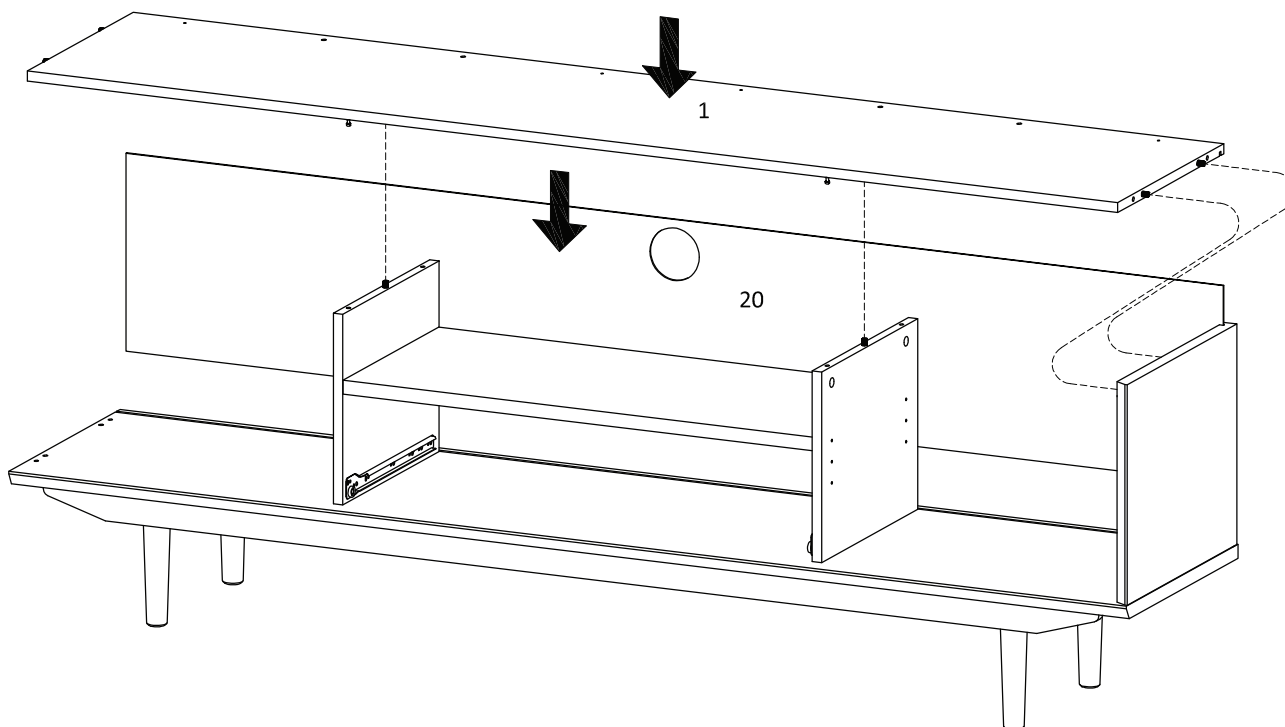

## STEP 11:

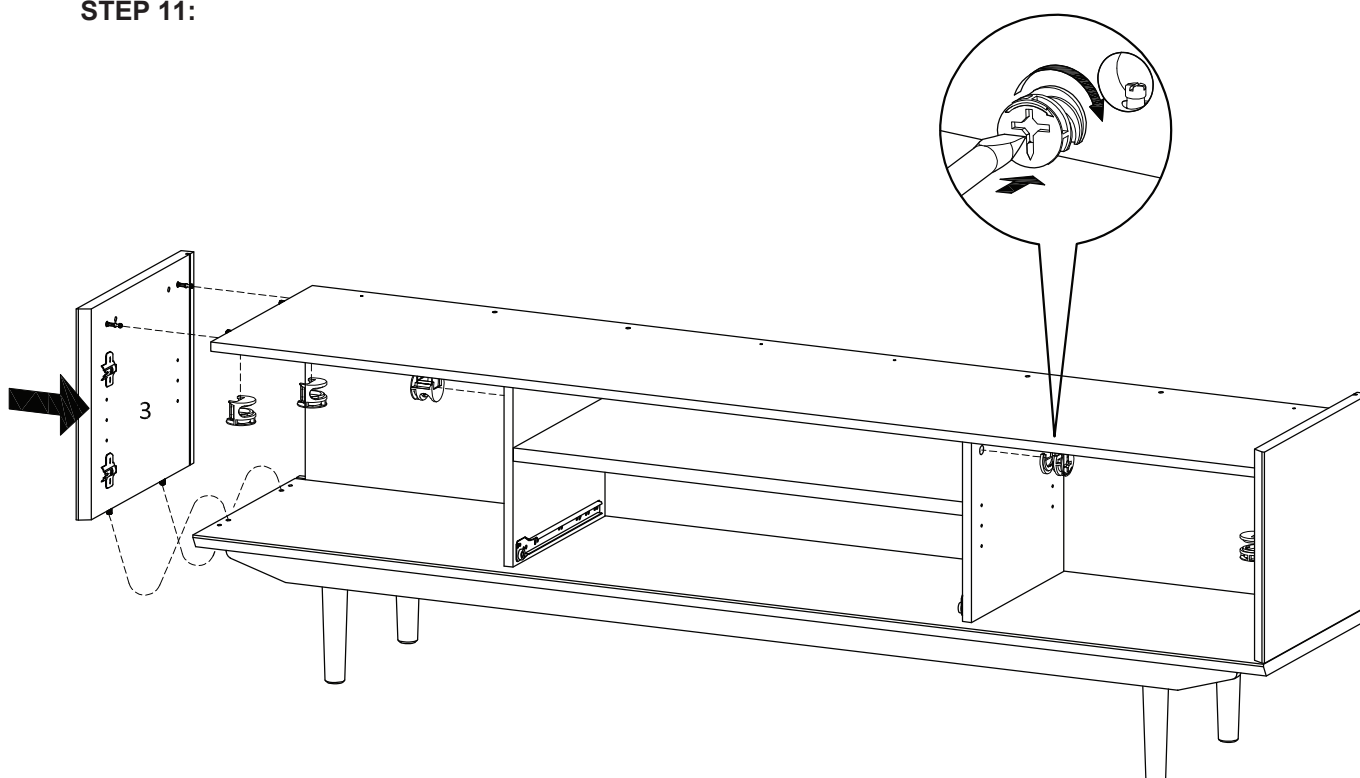

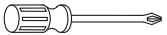
	
Bx8	Vx1

Hardware required.  
Screwdriver not included



## STEP 12:

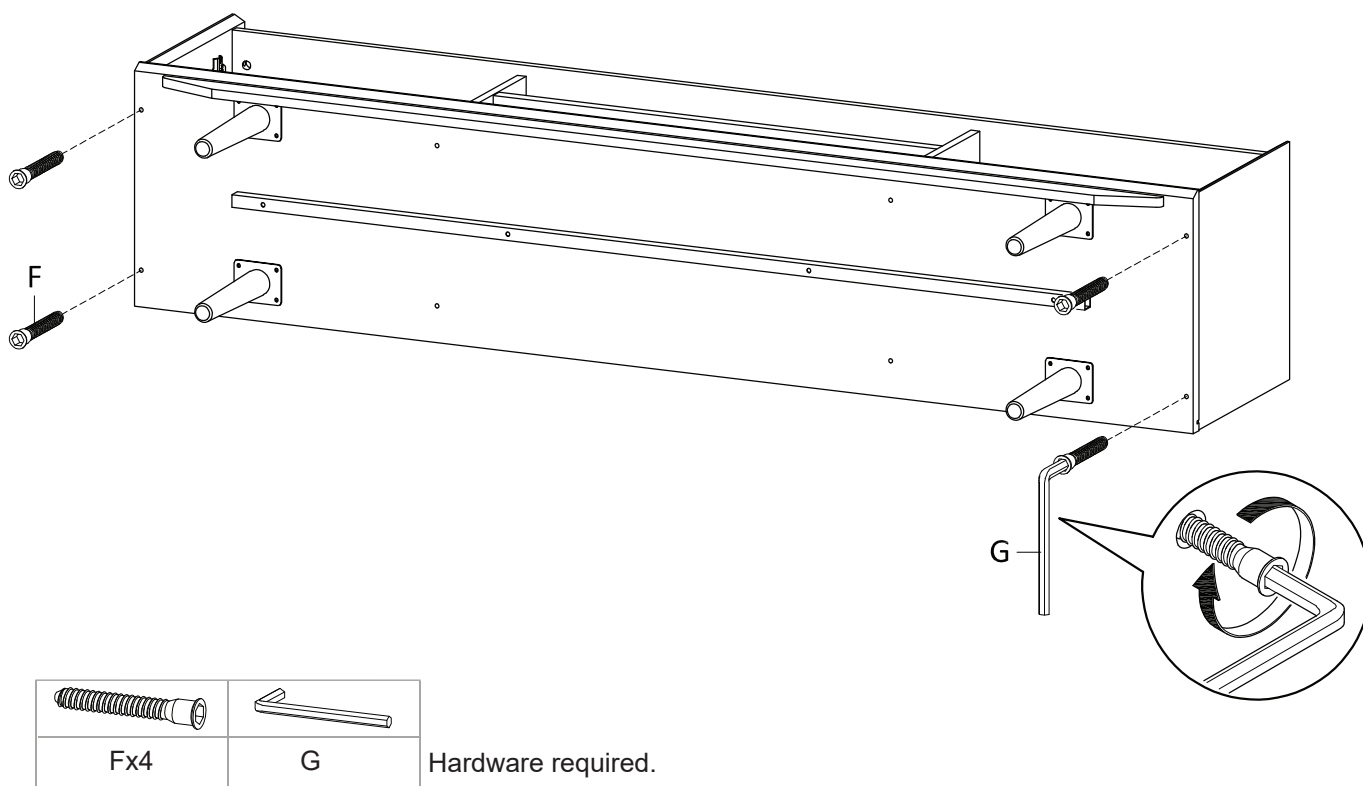

## STEP 13:

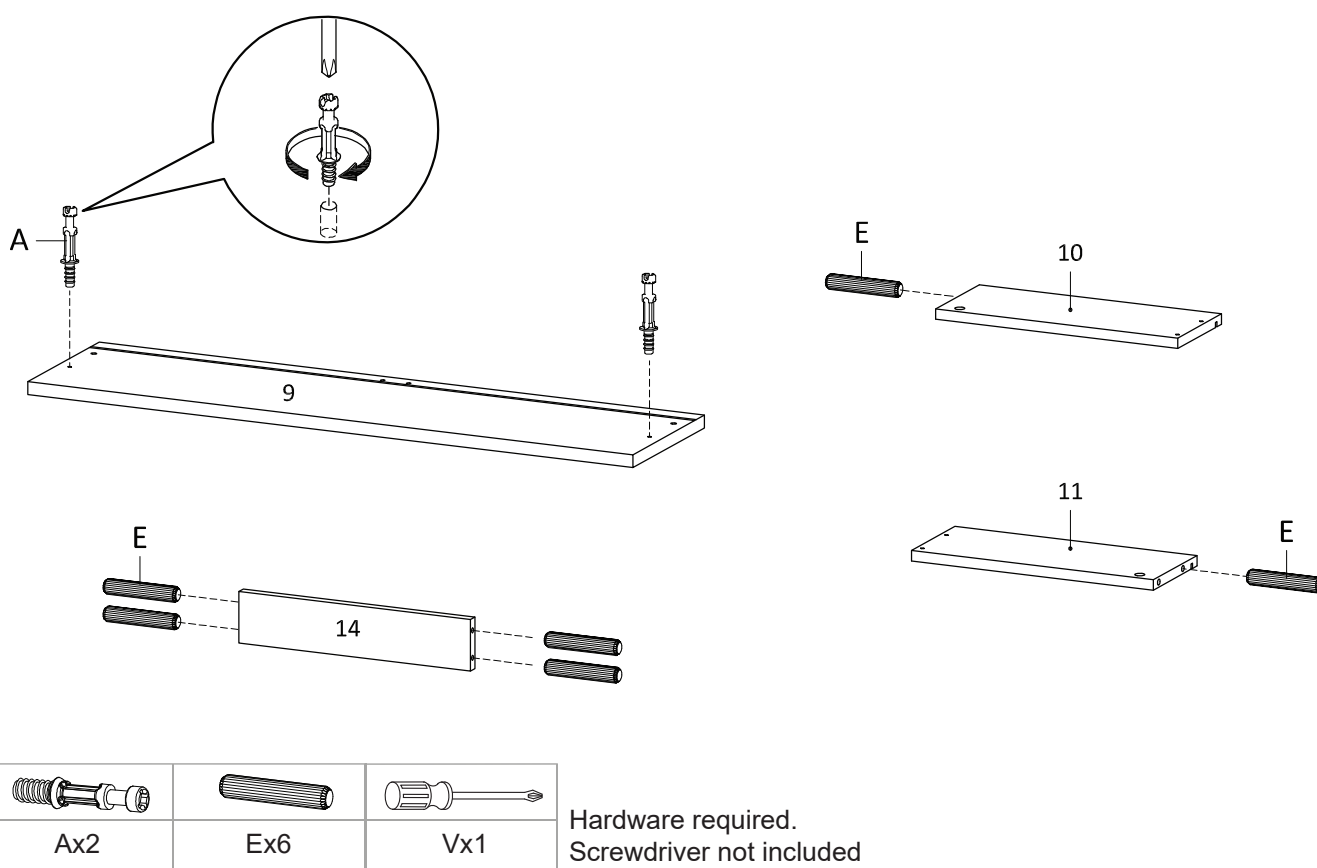

## STEP 14:

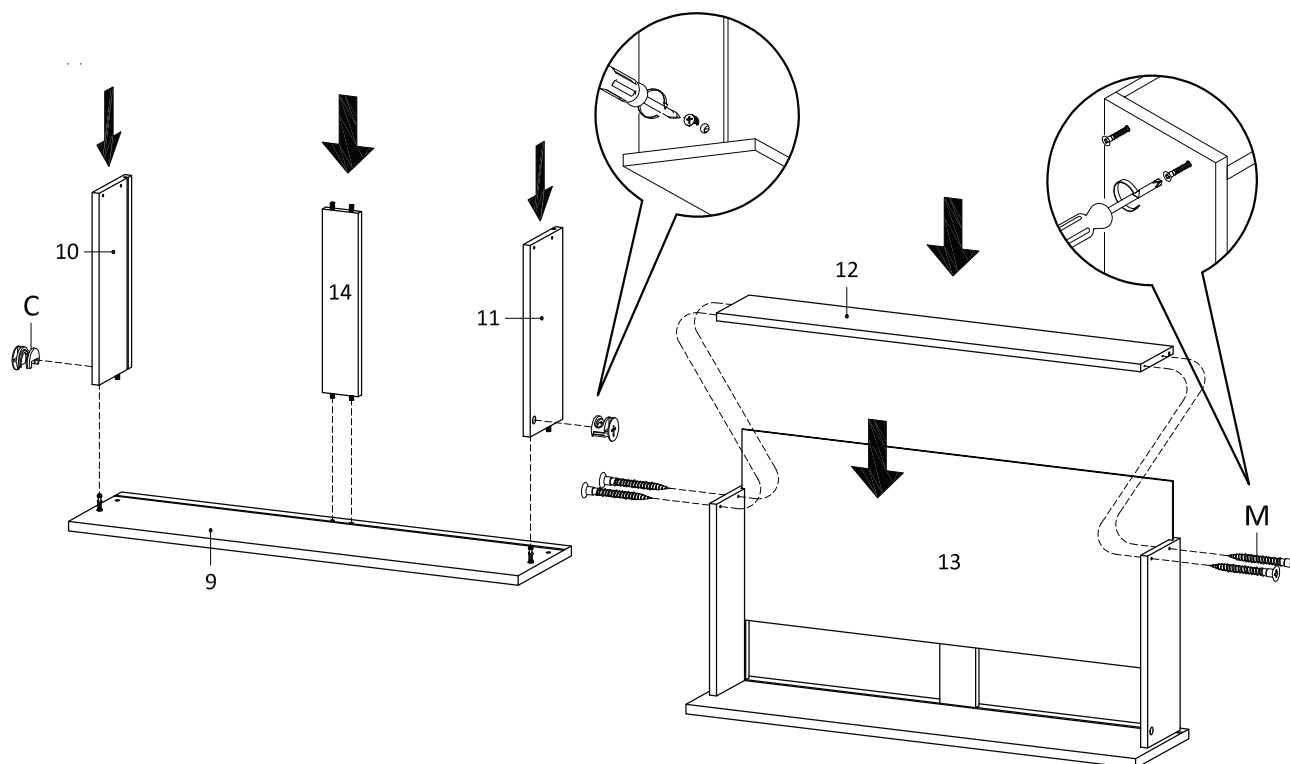

Cx2	Mx4	Vx1

Hardware required.  
Screwdriver not included

## STEP 15:

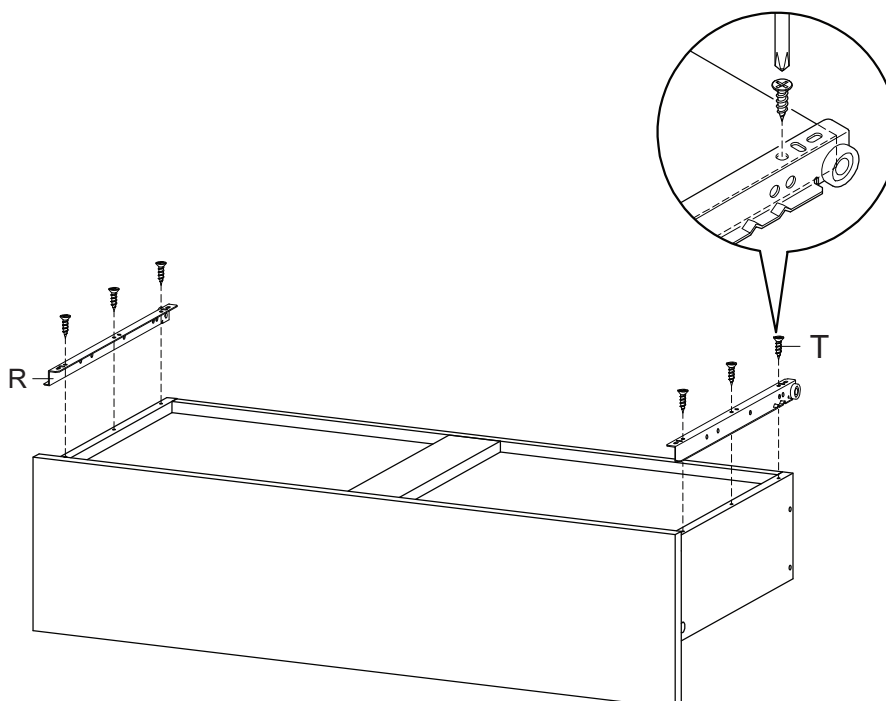

Rx1	Tx6	Vx1

Hardware required.  
Screwdriver not included

## STEP 16:

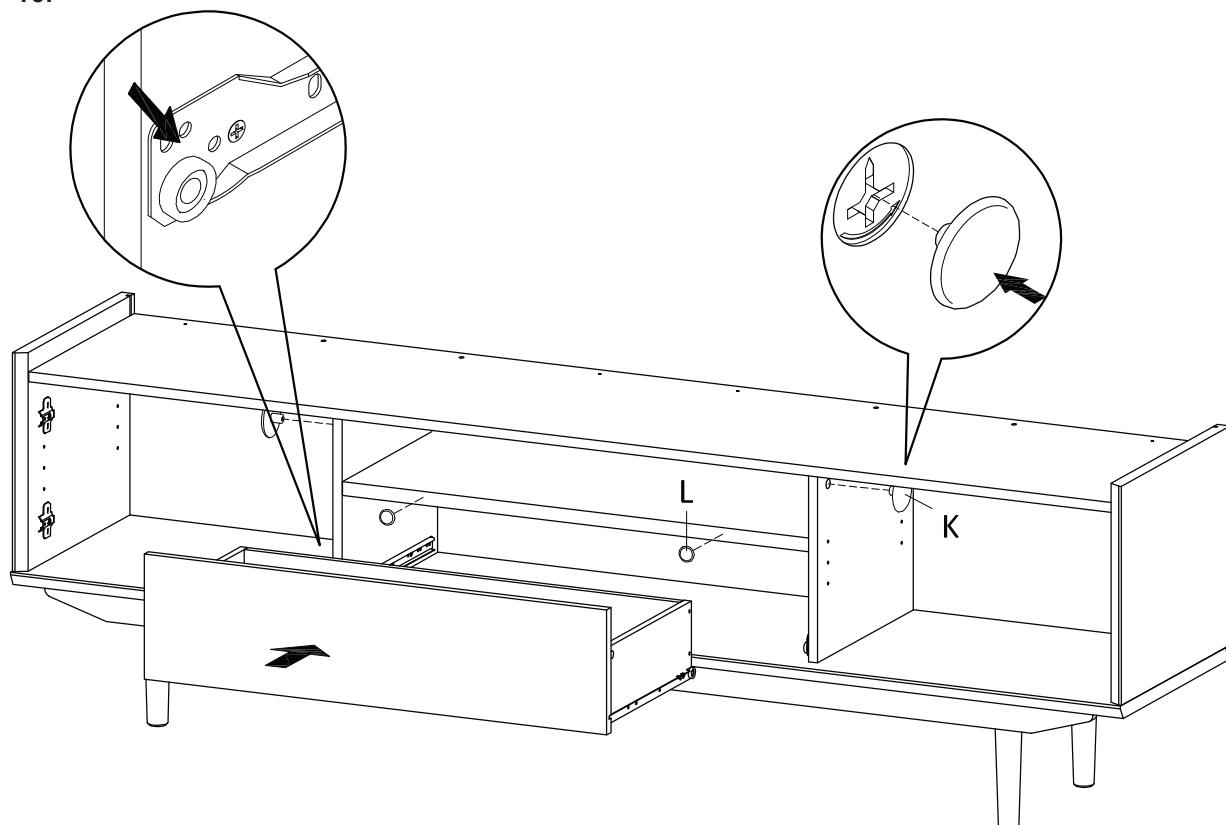

Kx4	Lx2

Hardware required.

## STEP 17:

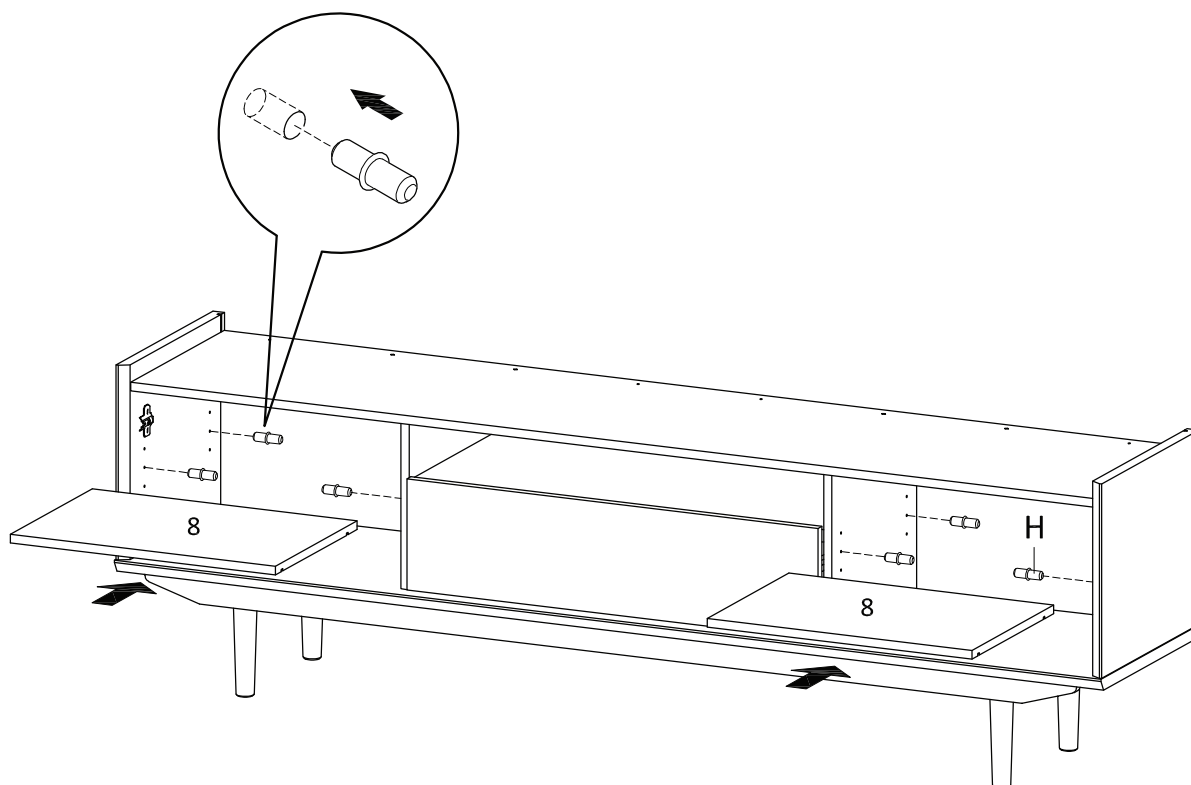

Hx8

Hardware required.

## STEP 18:

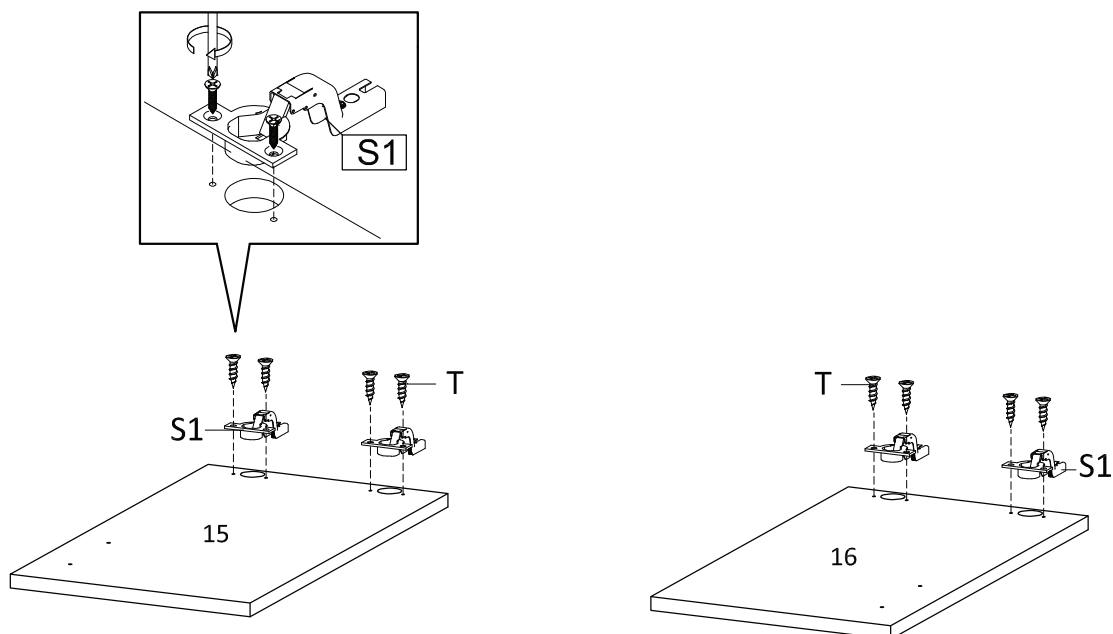

Sx4	Tx8	Vx1

Hardware required.  
Screwdriver not included

## STEP 19:

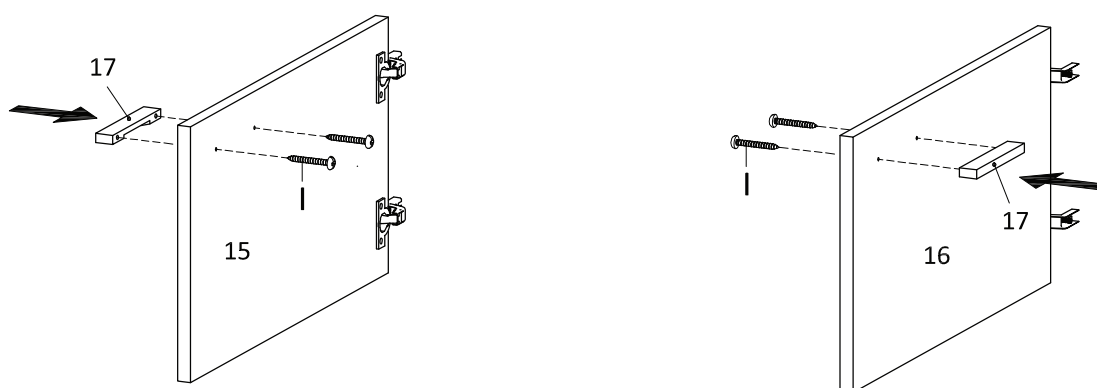

Ix4	Vx1

Hardware required.  
Screwdriver not included

## STEP 20:

### Hinges Adjustment

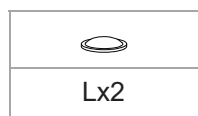
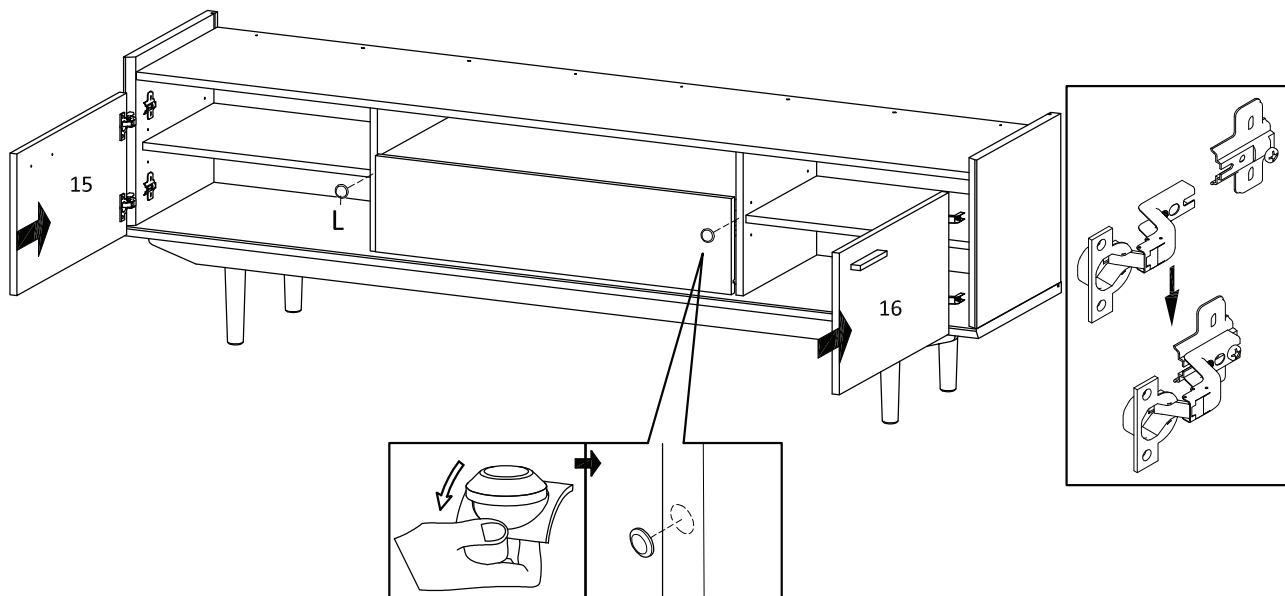
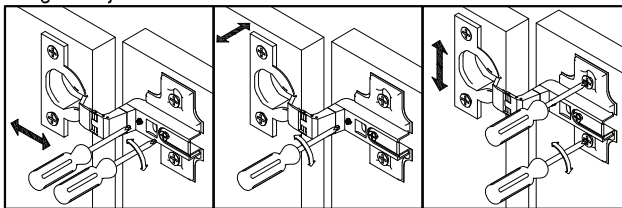

Lx2

Hardware required.

## STEP 21:

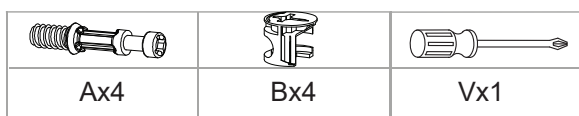
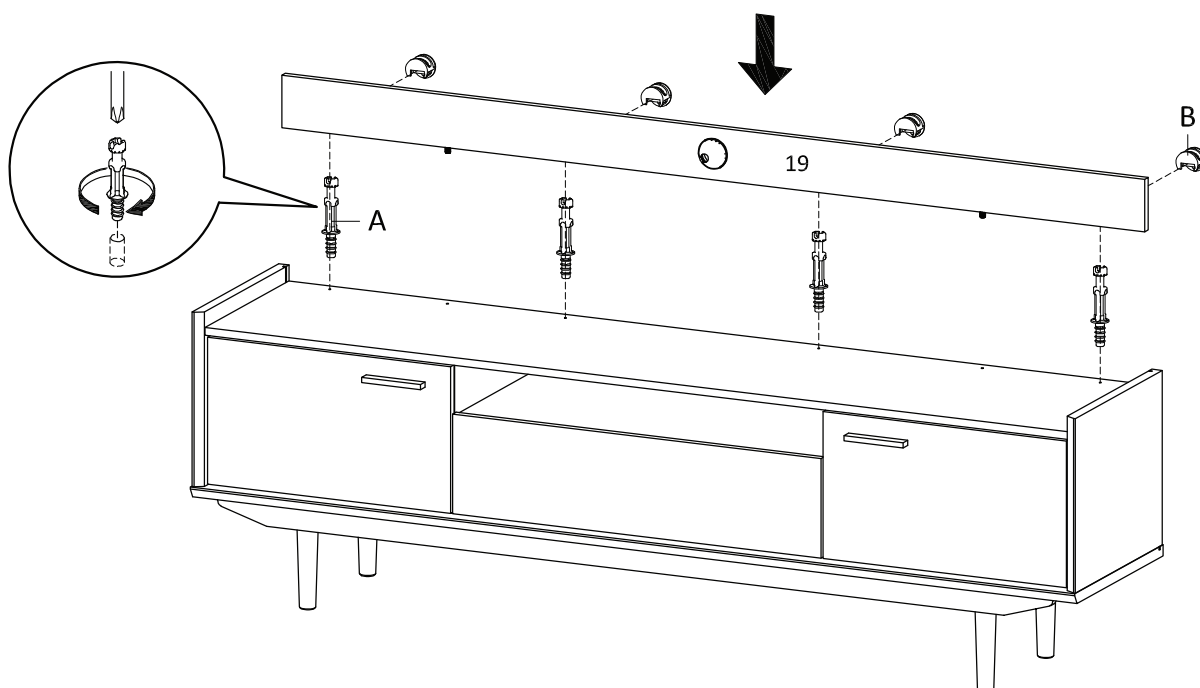

Ax4



Bx4

Vx1

Hardware required.  
Screwdriver not included

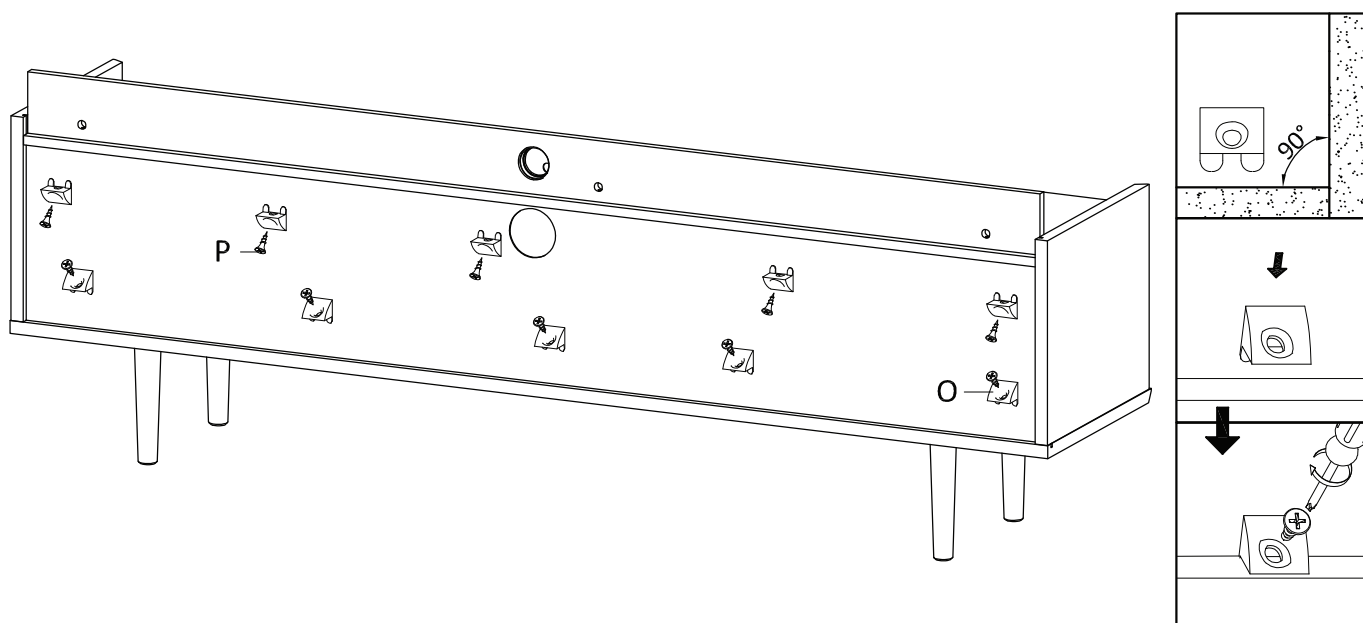
## STEP 22:

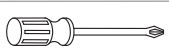

		
Ox10	Px10	Vx1

Hardware required.  
Screwdriver not included

## STEP 23:

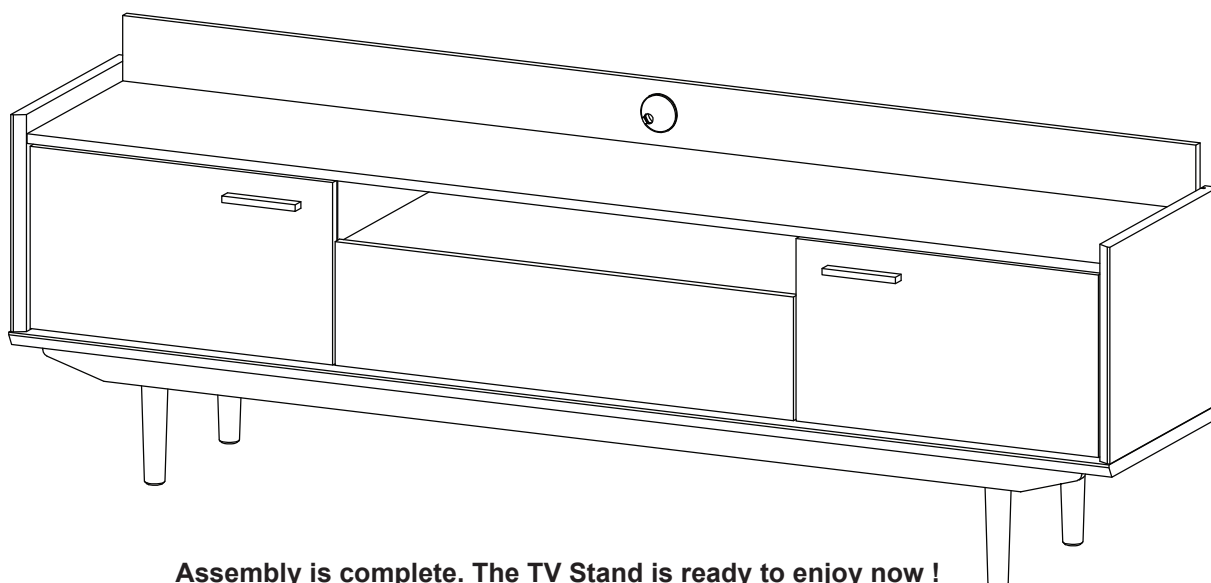

Assembly is complete. The TV Stand is ready to enjoy now !