

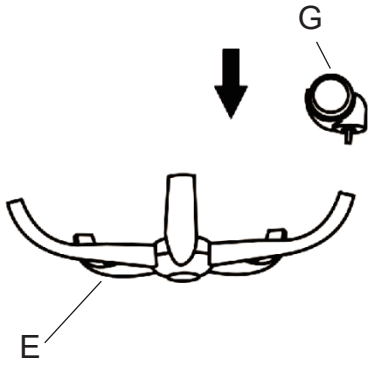

THANK YOU FOR PURCHASING THIS QUALITY PRODUCT.

BE SURE TO CHECK ALL PACKING MATERIAL CAREFULLY FOR SMALL PARTS THAT MAY HAVE COME LOOSE INSIDE THE CARTON DURING TRANSIT.

Step 1
Assemble wheels(H) to the base(E).



Step 2
Insert the gaslift(F) to the base(E).

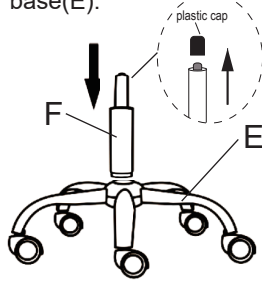

Step 3
Assemble swivel tray(D) to the seat(B).

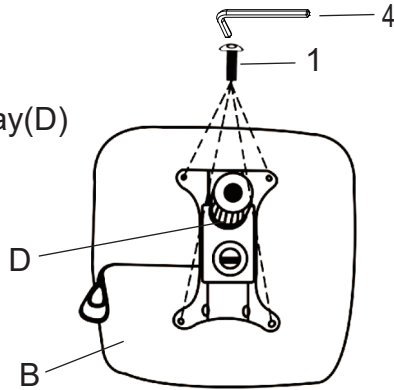

Step 4
Assemble arms(C) to backrest(A).

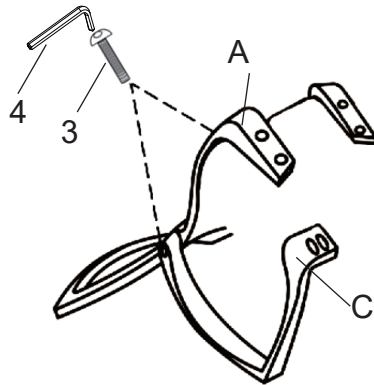

Step 5
Assemble arms(C) and backrest(A) to the seat(B) with screw2 and screw3.

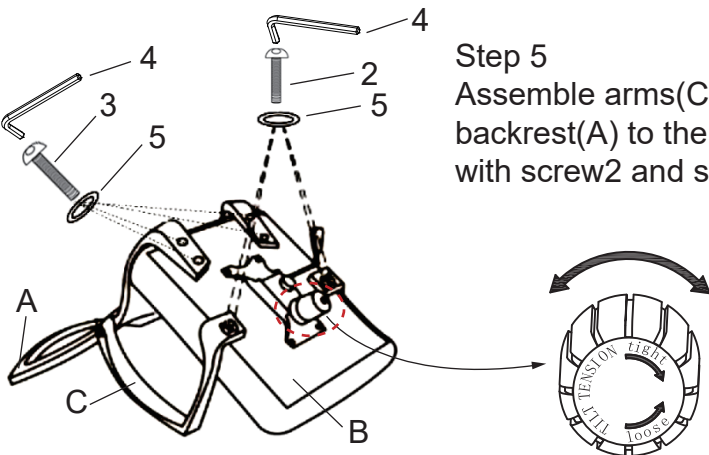

PART LIST

NO	DESC	SIZE(MM)	SKETCH	QTY
A	BACK	580x480		1
B	SEAT	490x510		1
C	ARMREST	340x50x260		2
D	SWIVEL TRAY	155x235		1
E	BASE	Dia320		1
F	GASLIFT	100		1
G	WHEEL	Dia50		5

HARDWARE LIST

NO	DESC	SIZE(MM)	SKETCH	QTY
1	screw1	M6X20		4
2	screw2	M6X30		4
3	screw3	M6X35		6
4	allen key	M6		1
5	washer	dia 8 x 16		12

Step 6
Insert the gaslift into the whole where in the swivel tray. Then finished.



FINISHED