

# ASSEMBLY INSTRUCTION

## COMPONENTS

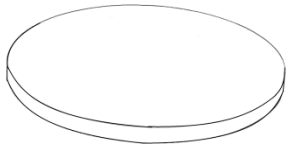

1-TOP UNIT



3 -LEGS

## HARDWARE



3-BOLTS

## TOOLS



L-END KEY

1

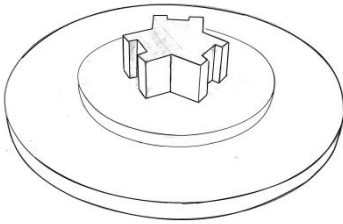

1. CAREFULLY PLACE **TOP UNIT** FACE DOWN ONTO A CLEAN, PADDED SURFACE.

2

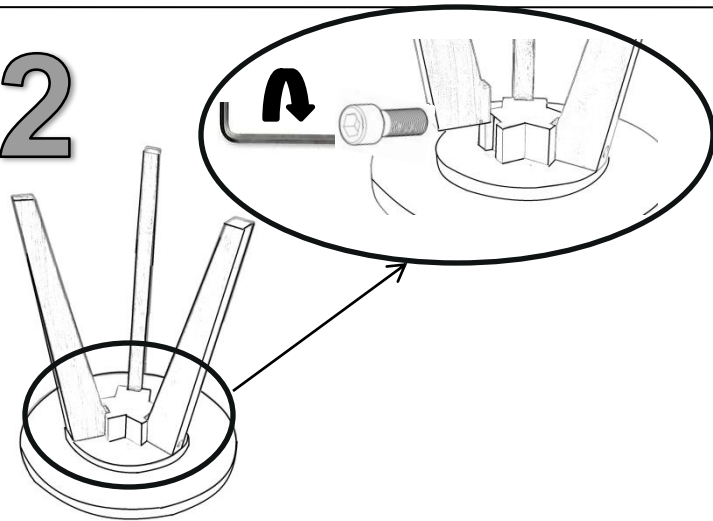

2. FIX EACH LEG WITH BOLT AND L END KEY

3

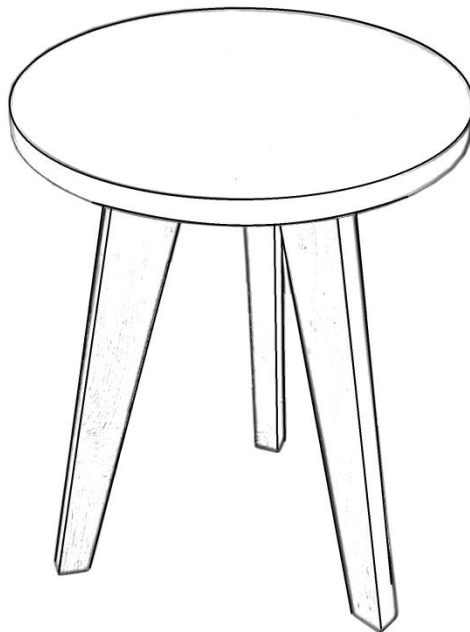

3. NOW KEEP THE TABLE UPRIGHT.