

ASSEMBLY INSTRUCTION

ITEM : PITA DAYBED

NO	PARTLIST	QTY
1	BACK PANEL	1PC
2	SIDE PANEL (L)	1PC
3	SIDE PANEL (R)	1PC
4	FRONT RAIL	1PC
5	BACK RAIL	1PC
6	LEG	4PCS
7	SLAT	2SETS
ITEM	HARDWARE	QTY
A	JCBB SCREW M8 x 20MM	8PCS
B	JCBC SCREW M6 x 15MM	12PCS
C	JCBC SCREW M6 x 50MM	4PCS
D	SPRING WASHER M6 x 12MM	4PCS
E	FLAT WASHER M6 x 19MM	4PCS
F	SCREW M4 x 32MM	8PCS
G	L - KEY M4 x 100MM	1PC
H	L - KEY M5 x 65MM	1PC

STEP 1

Begin assembly by attaching each Leg (6) to the bottom of Right Arm (2) & Left Arm (3) by securing with 3 Allen Bolts (B) per leg using L - key (G).

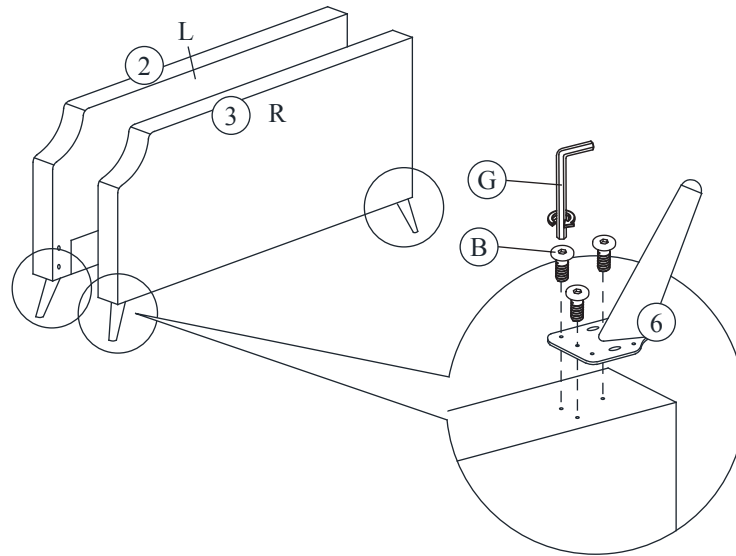

STEP 2

Attach the Front Rail (4) and Back Rail (5) to the Left Side Panel (2) and Right Side Panel (3). Aligning the holes and securing with 2 Allen Bolts (A) per each end by using L-Key (H).
(DO NOT FULLY TIGHTEN BOLTS FOR THIS STEP.)

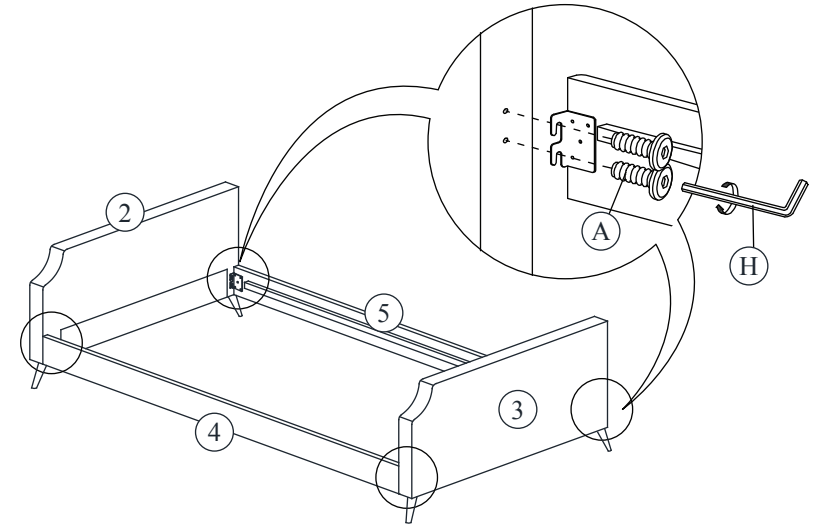

STEP 3

Attach the Back Panel (1) to the Left Side Panel (2) and Right Side Panel (3), and securing with 2 Allen Bolts (C), 2 Spring Washer (D), 2 Flat Washer (E) each side of the Back Panel by using L-Key (G).

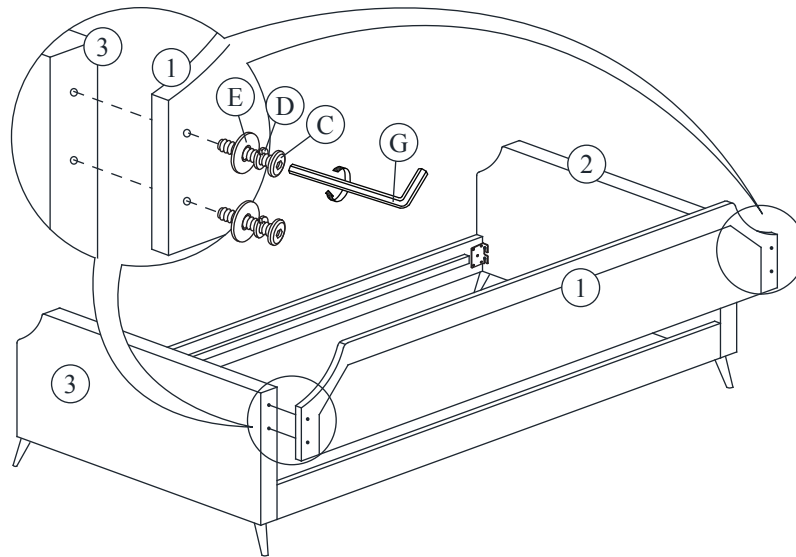

STEP 4

Tighten all Bolts on step 2 by using the L-Key (H) and following step 3 using L-Key (G) that has been provided. Attach Slats (7) to the Front Rail (4) and Back Rail (5) by unrolling and securing with 2 Screws (F) per each side. Tighten all screws using philips head screwdriver (NOT INCLUDED).

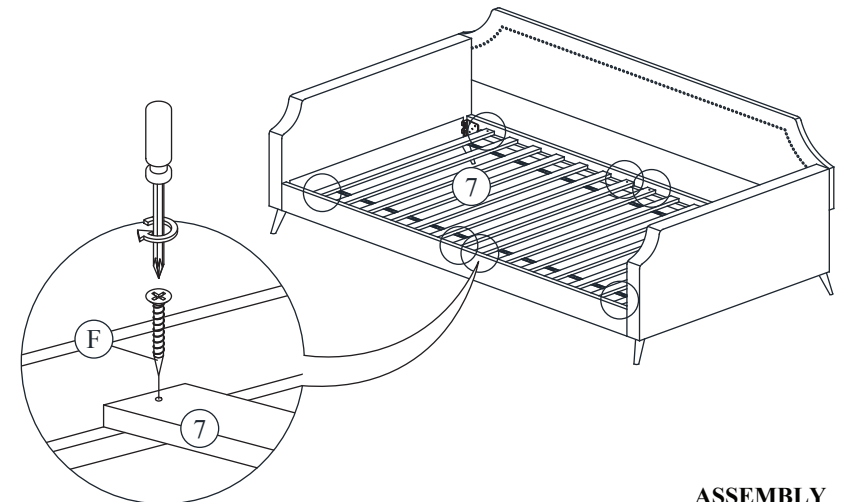

**ASSEMBLY
COMPLETED**