

# 0102 Queen Bed

## Assembly Instructions

WI-0622

### 1 Assembled View

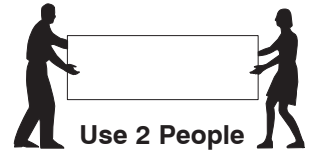

**Note:** Do not assemble using power tools. This can cause the bolts to be overtightened

### 2 Parts List

#### Parts in Box A:

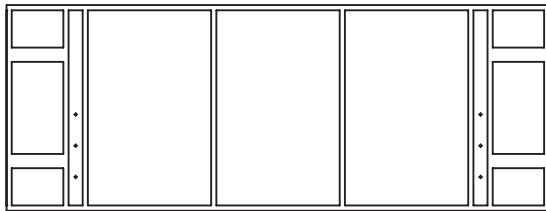

**A** Headboard x 1



**B** Headboard Side Panel Right x 1



**C** Headboard Side Panel Left x 1



**D** Headboard Support x 2

#### Parts in Box B:



**E** Headboard Panel x 1



**F** Footboard Panel x 1



**G** Side Rail x 2



**H** Long Support x 1



**J** Post (Left hand) x 2



**K** Post (Right hand) x 2

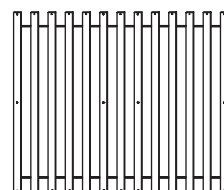

**M** Set of Bed Slats x 1



**N** Support Leg x 3

# 0102 Queen Bed

## Assembly Instructions

WI-0622

### 3 Hardware List

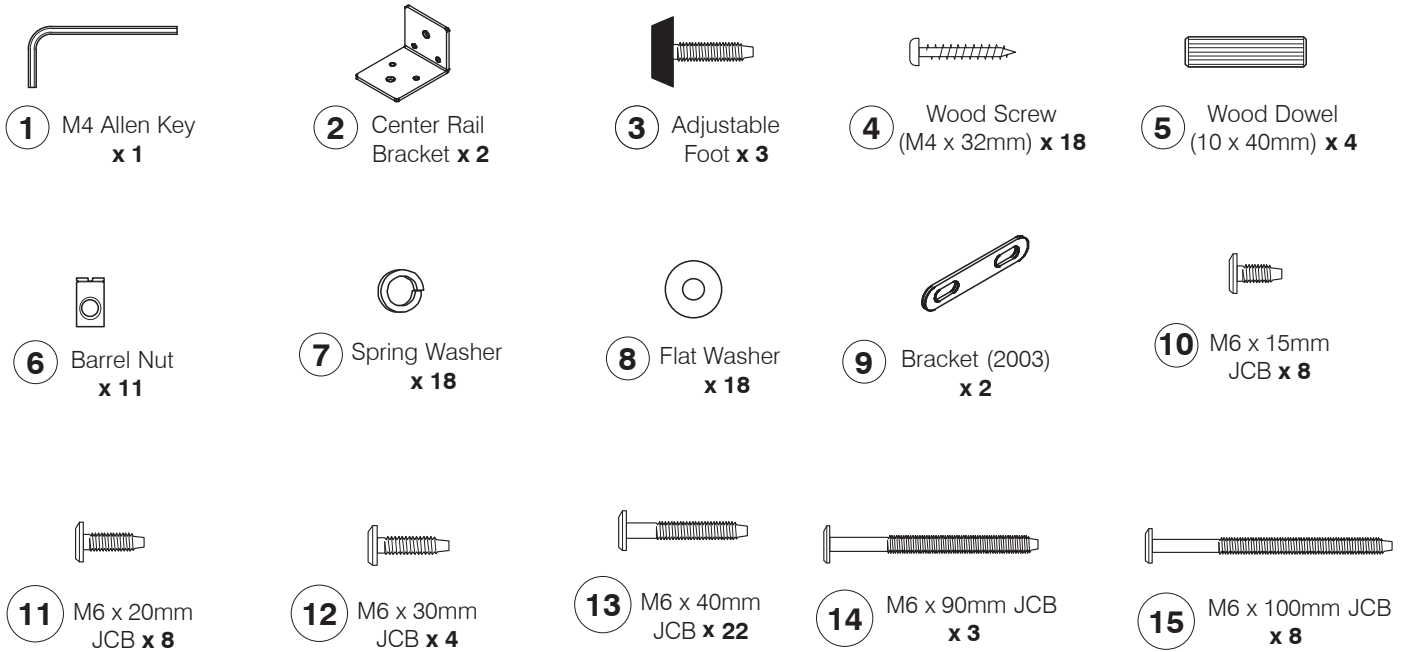

### 4 Assembled the Support Leg (N) to the Long Support (H).

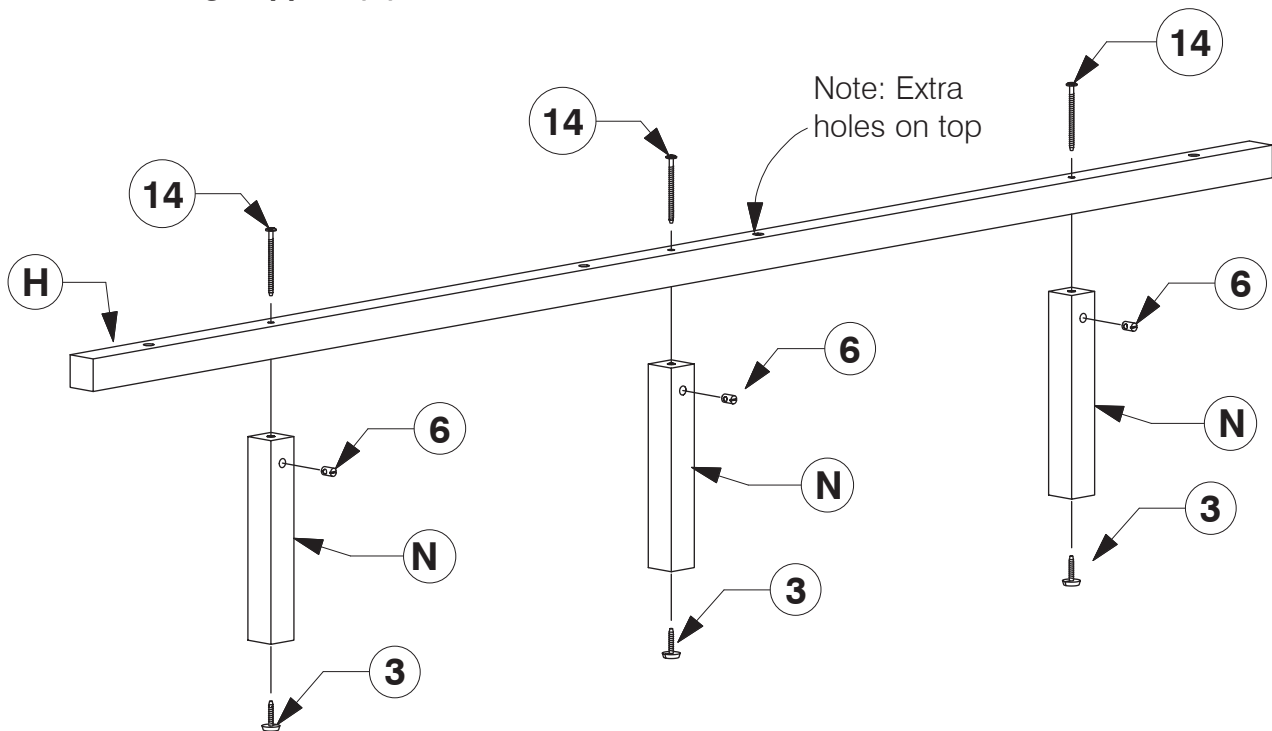

# 0102 Queen Bed

## Assembly Instructions

WI-0622

- 5** Fit the Centre Rail Bracket to the Headboard & Footboard (E/F).  
Assemble the Post (J & K) to the Headboard & Footboard (E/F).

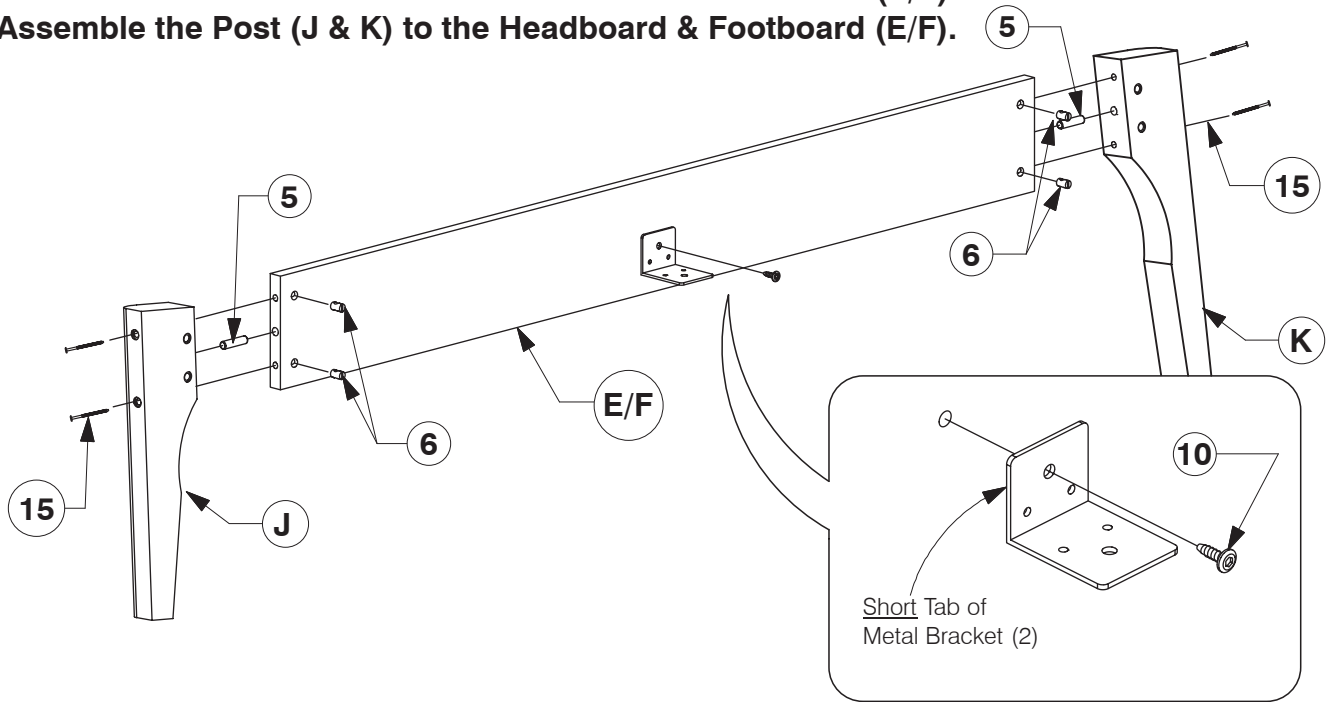

- 6** Fit the Side Panel (B & C) to the Headboard (A).

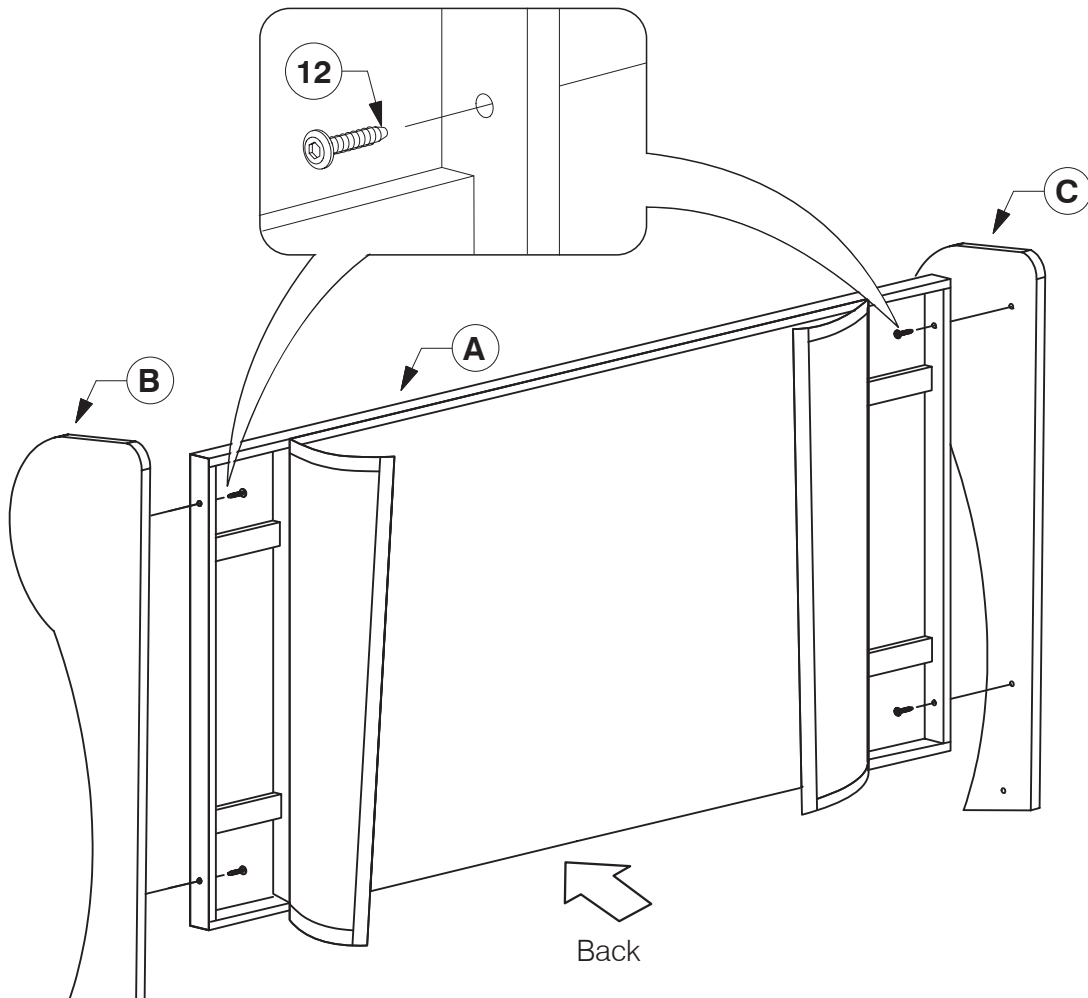

# 0102 Queen Bed

## Assembly Instructions

WI-0622

- 7** Assembled the Side Rail (G) to the Headboard & Footboard Panel (E & F).

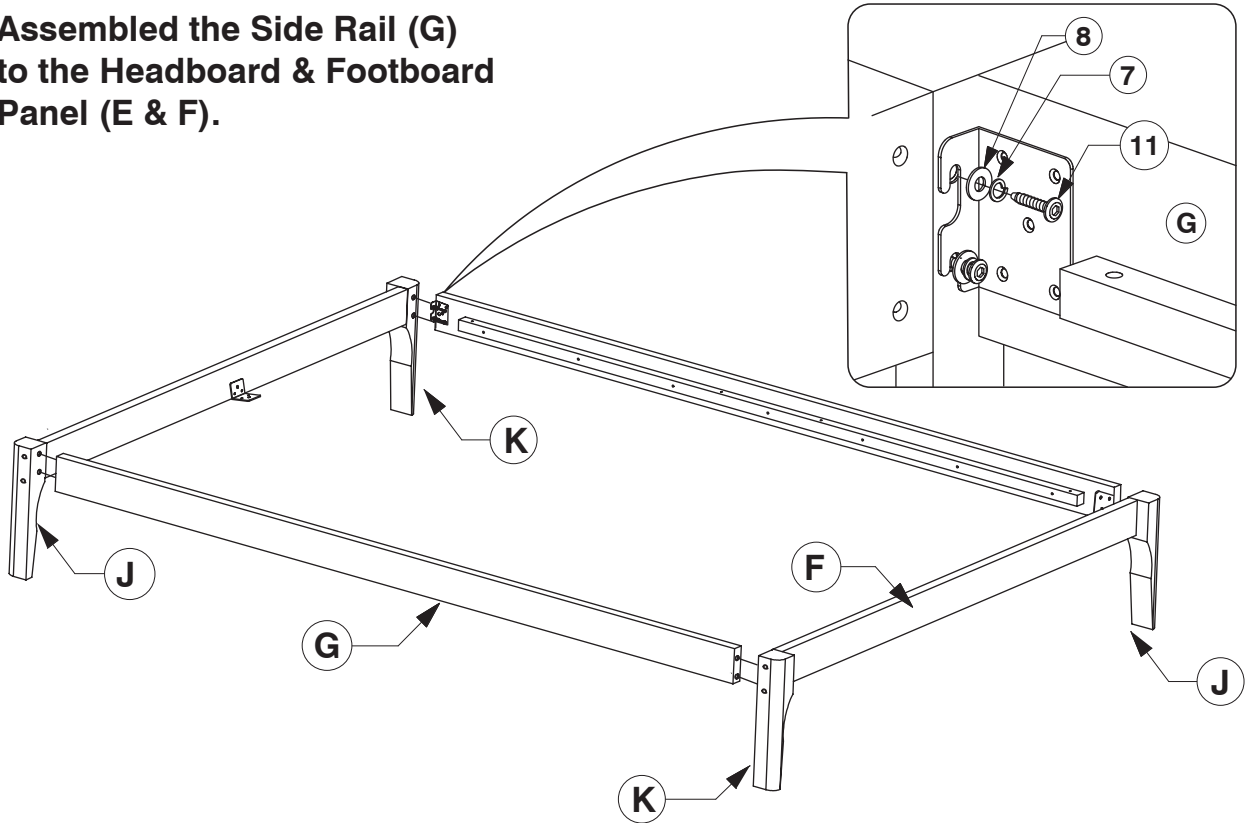

- 8** Bolt the Long Support (H) to the Center Rail Brackets on the Head & Footboard Panel (E & F).

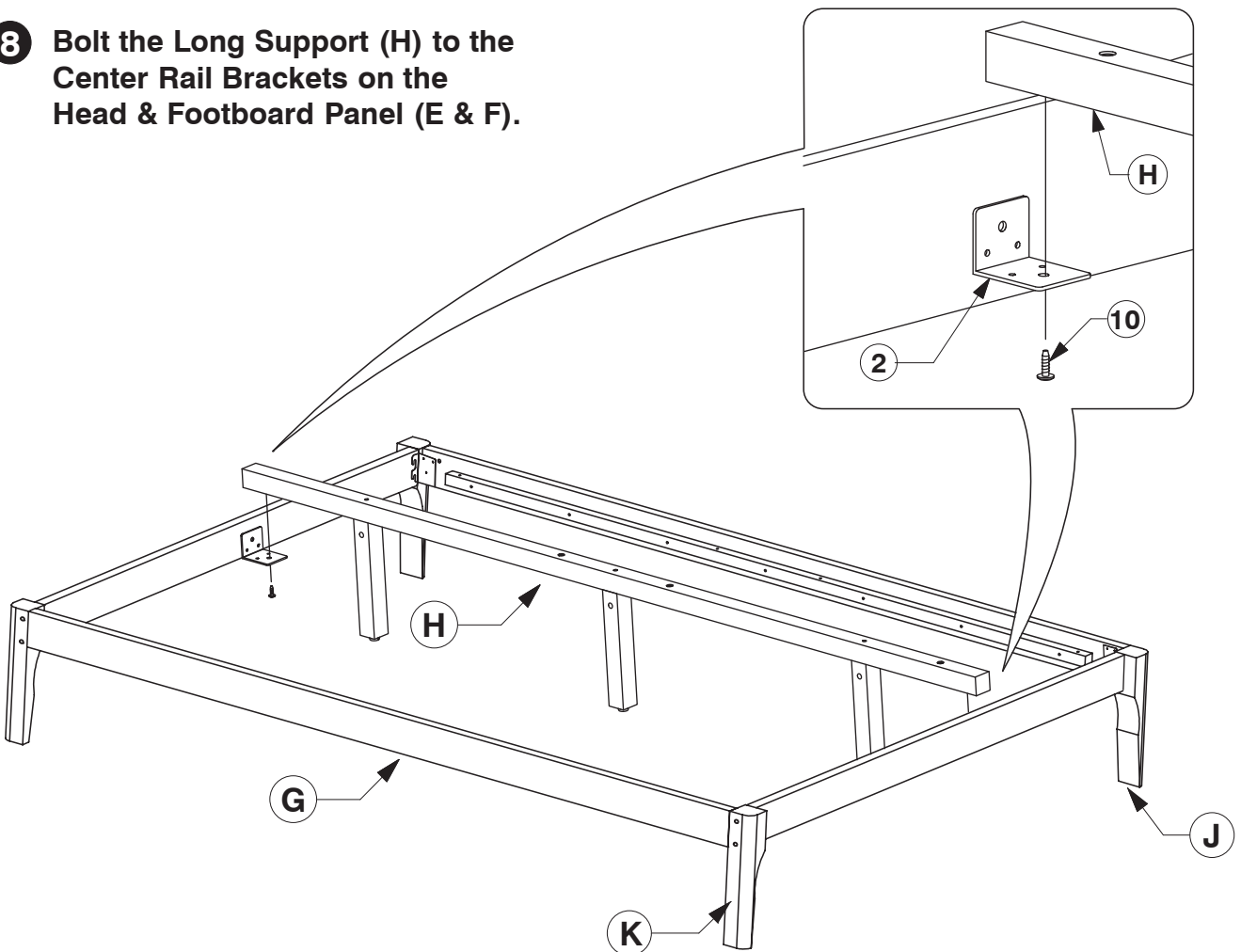



# 0102 Queen Bed

## Assembly Instructions

WI-0622

- 11** Assemble the Headboard (A) to the Headboard Support (D).

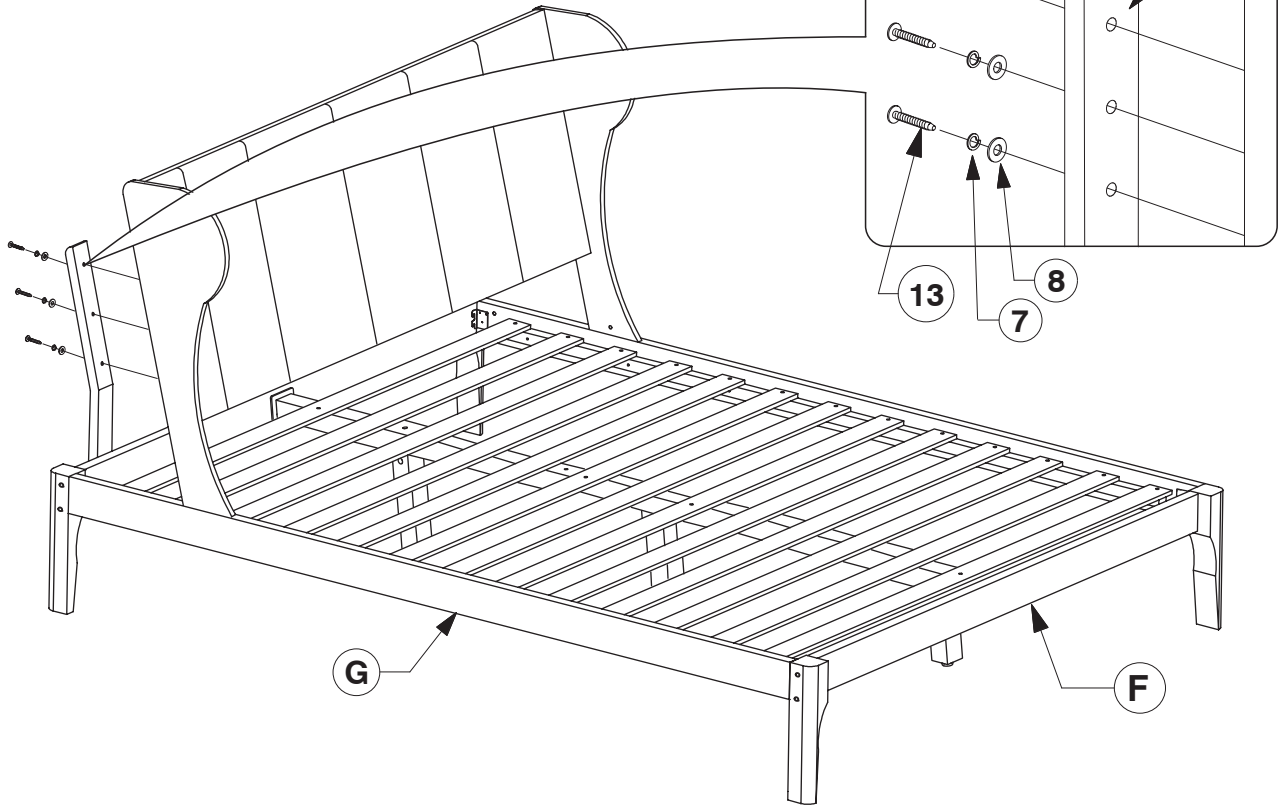

- 12** Fit the Side Panel (B & C) to the Side Rail (G).

