

# ASSEMBLY INSTRUCTIONS

Read this instruction carefully. See hardware and furniture part list for guidance. Be sure all parts are complete, before you assemble. Place all wooden furniture parts on a clean and flat soft surface to prevent from being scratched. Follow the figure to start assembling.

**CAUTIONS :** 1. Do not FULLY - TIGHTEN the nut or nut bolt until all nut or bolt is ready assembled.  
2. Do not OVER - TIGHTEN the nut or bolt to avoid causing damages to the thread.  
3. Keep all hardware parts out of reach of children.

**NOTE :** THE LIST AND QUANTITY SHOWN ARE FOR 1 UNIT ASSEMBLY.  
Tool needed : Screwdriver (not provider).

PART LIST		
ITEM	DESCRIPTION	QTY
A	FRONT LEG	3 PCS
B	BACK LEG	3 PCS
C	BENCH	1 PC
D	CENTER SUPPORT	4 PCS
E	CENTER RAIL	3 PCS

HARDWARE LIST		
ITEM	DESCRIPTION	QTY
1	JCBC BOLT M6 x 50mm	12 PCS
2	M6 FLAT WASHER	12 PCS
3	M6 SPRING WASHER	12 PCS
4	WOOD SCREW M4 x 45mm	14 PCS
5	M4 ALLEN KEY (BALL SHAPE)	1 PC

## STEP 1

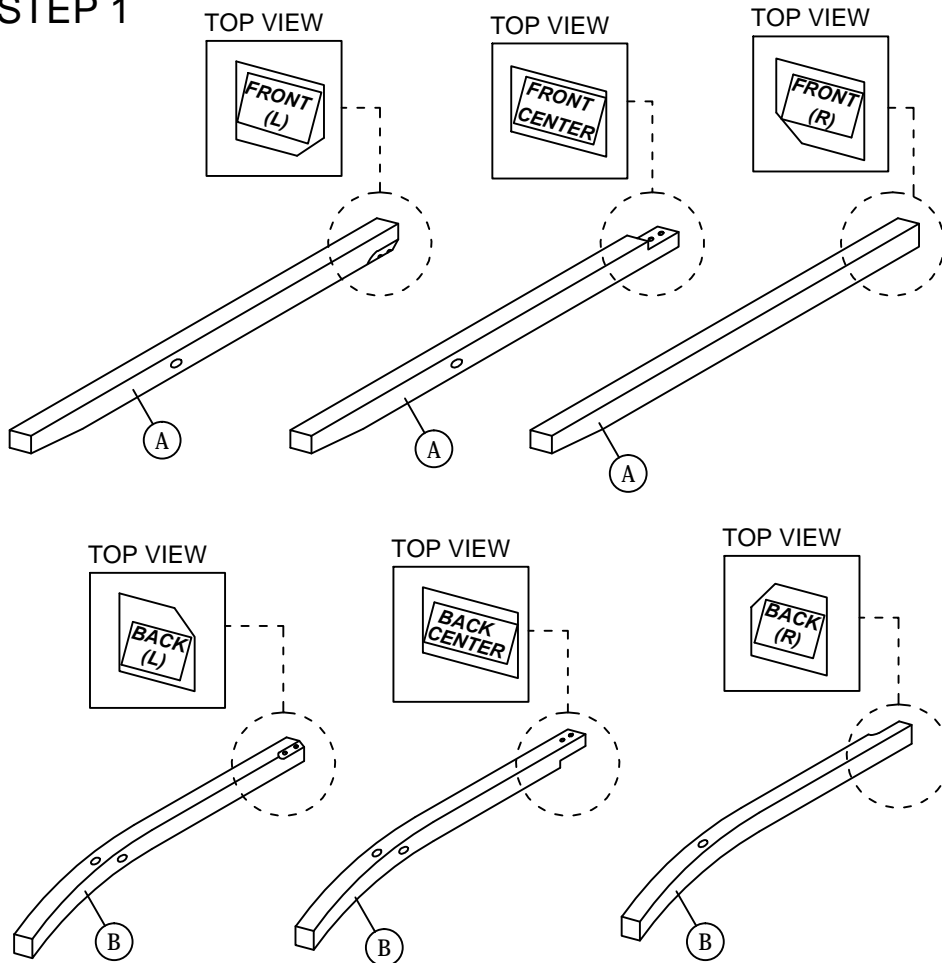

## STEP 2

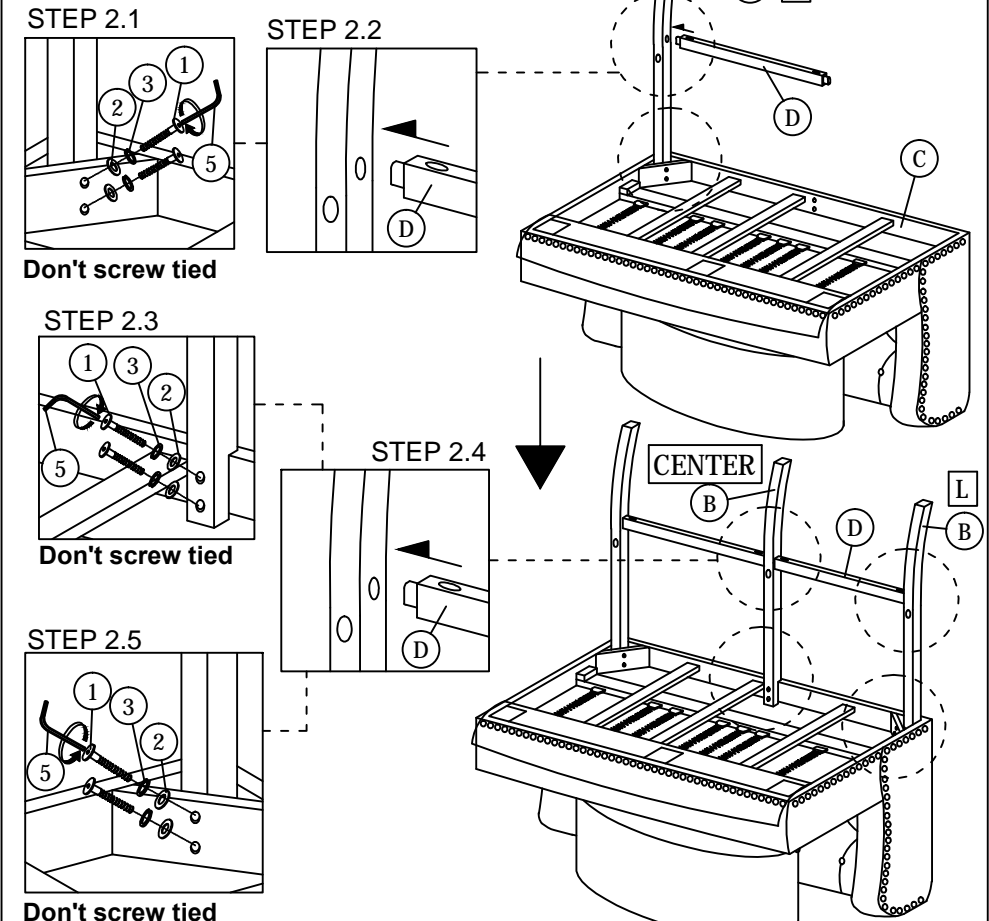

# ASSEMBLY INSTRUCTIONS

## STEP 3

### STEP 3.1

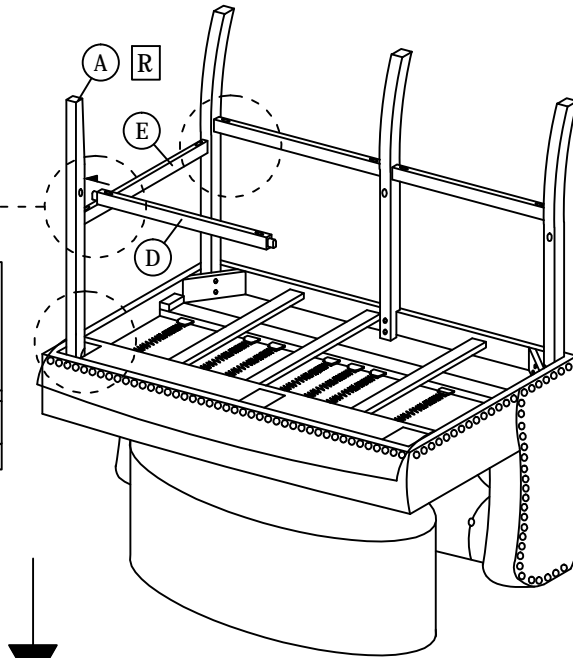
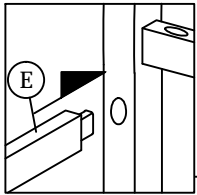

### STEP 3.2

Don't screw tied

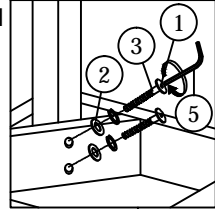

### STEP 3.3

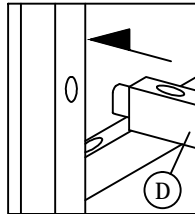

### STEP 3.4

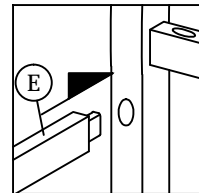

### STEP 3.5

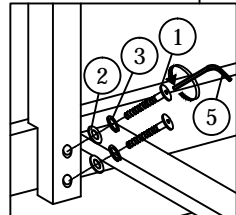

Don't screw tied

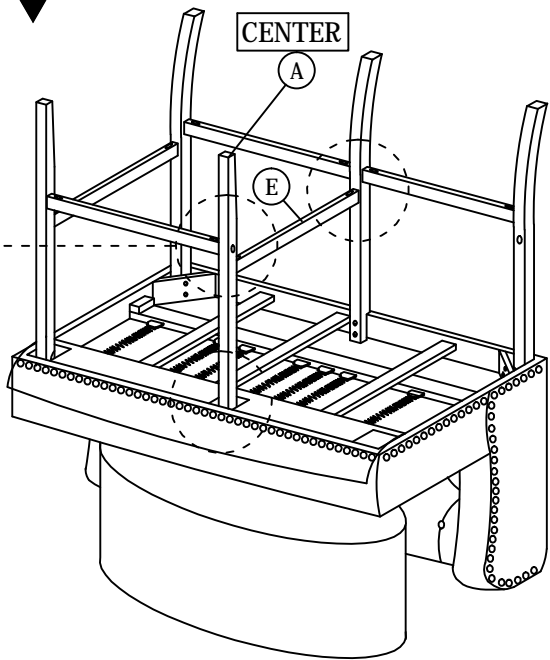

## STEP 4

### STEP 4.1

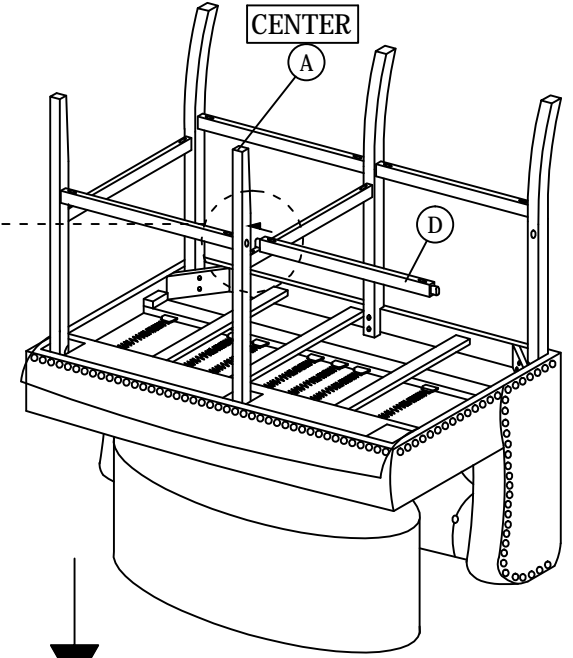
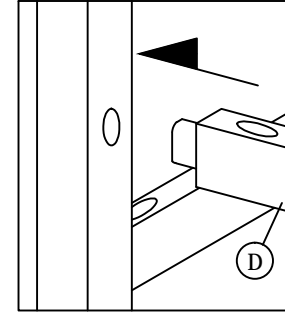

### STEP 4.2

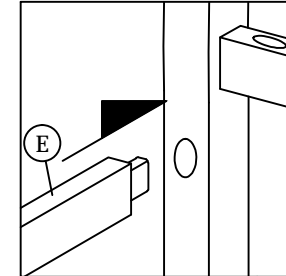

### STEP 4.3

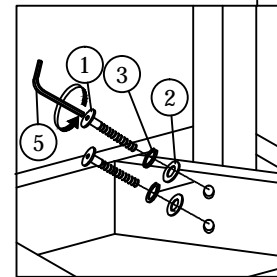

Don't screw tied

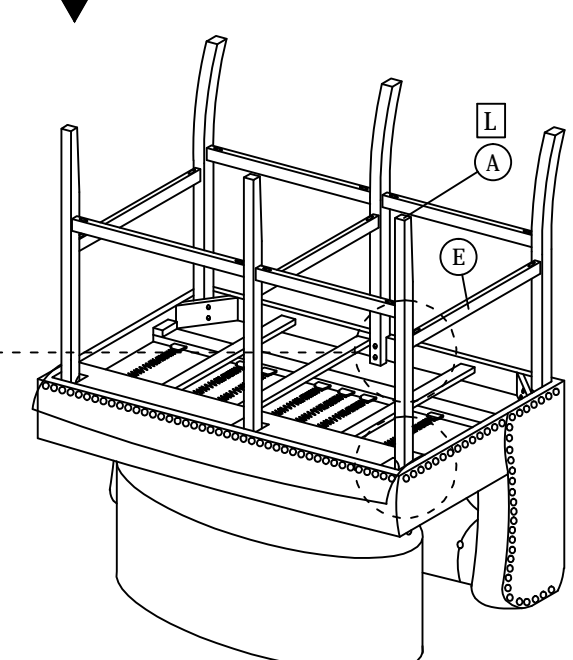

# ASSEMBLY INSTRUCTIONS

## STEP 5

**\*\*Finish step 5, Please screw tied the step 2 , 3 & 4 bolt.**

STEP 5.1

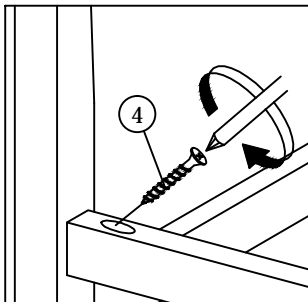

STEP 5.2

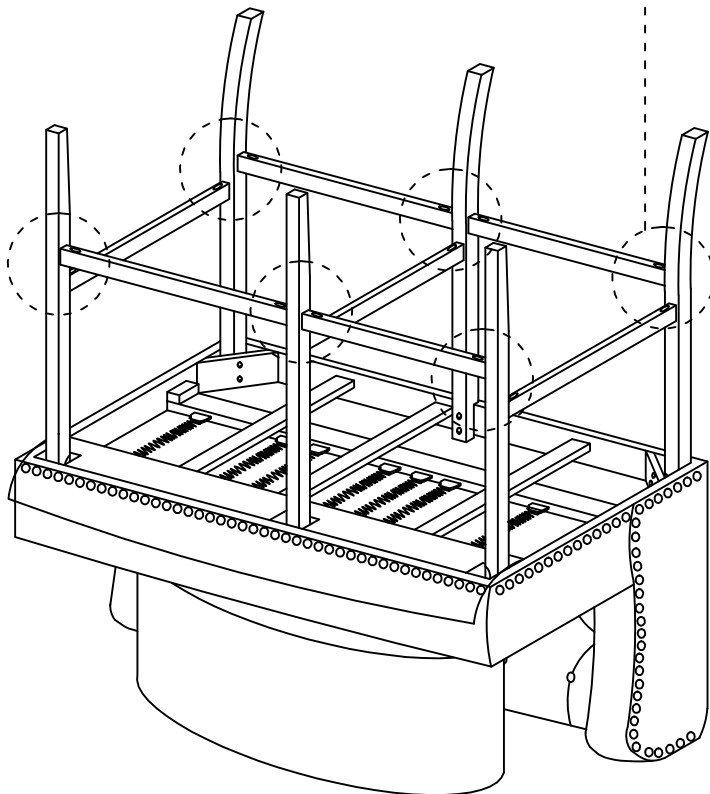
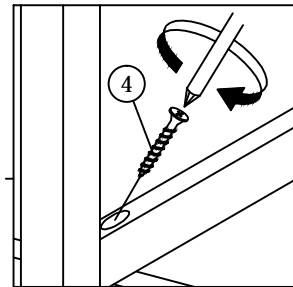

## STEP 6

