

QUEEN

ASSEMBLY INSTRUCTIONS

Before assembling your murphy bed, please read through these instructions carefully and familiarize yourself with the different parts.

ATTENTION! If you receive a damaged or defective item, please contact affurnishings at customerservice@afifurnishings.com or 1-800-955-3726

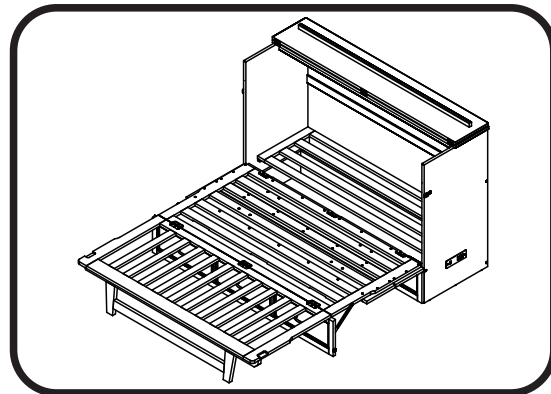
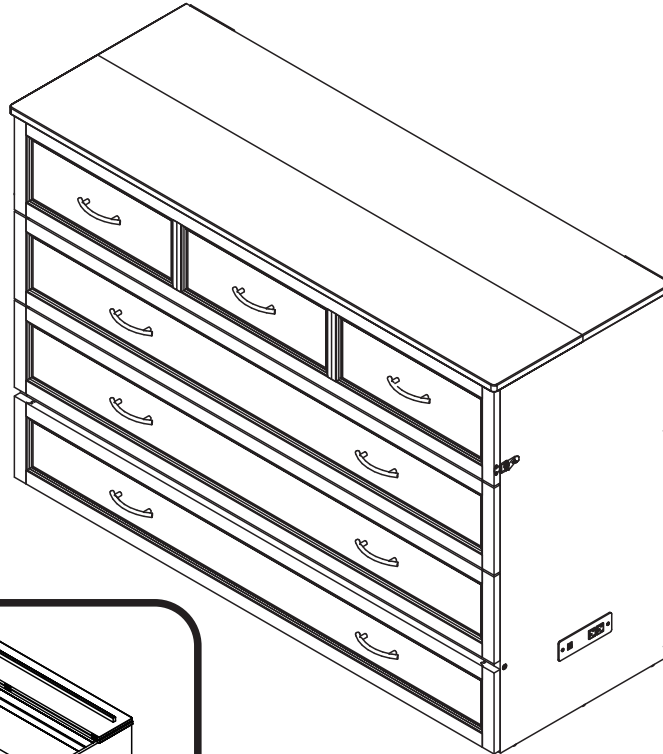

CODE	ITEM
MB-DR-NFD	C-5842X
MB-PL-NFD	C-5845X
MB-CB-NFD	C-5849X

PO :

HARDWARE

NOTE: WE INCLUDE SPARE HARDWARE IN CASE DAMAGE OCCURS DURING ASSEMBLY.

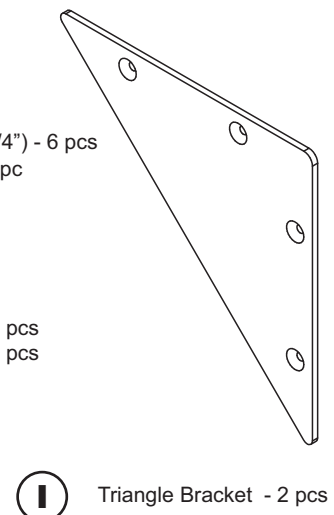
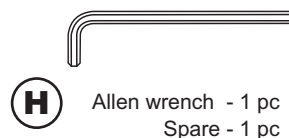
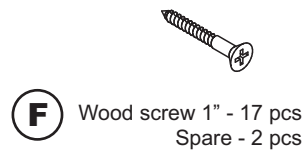
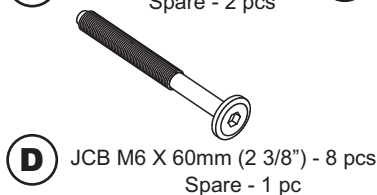

QUEEN

STEP 6

Attach top panel (02) to cabinet assembly as shown below. Use JCB (B). Tighten with Allen wrench (H)

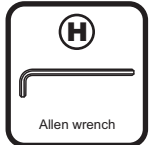
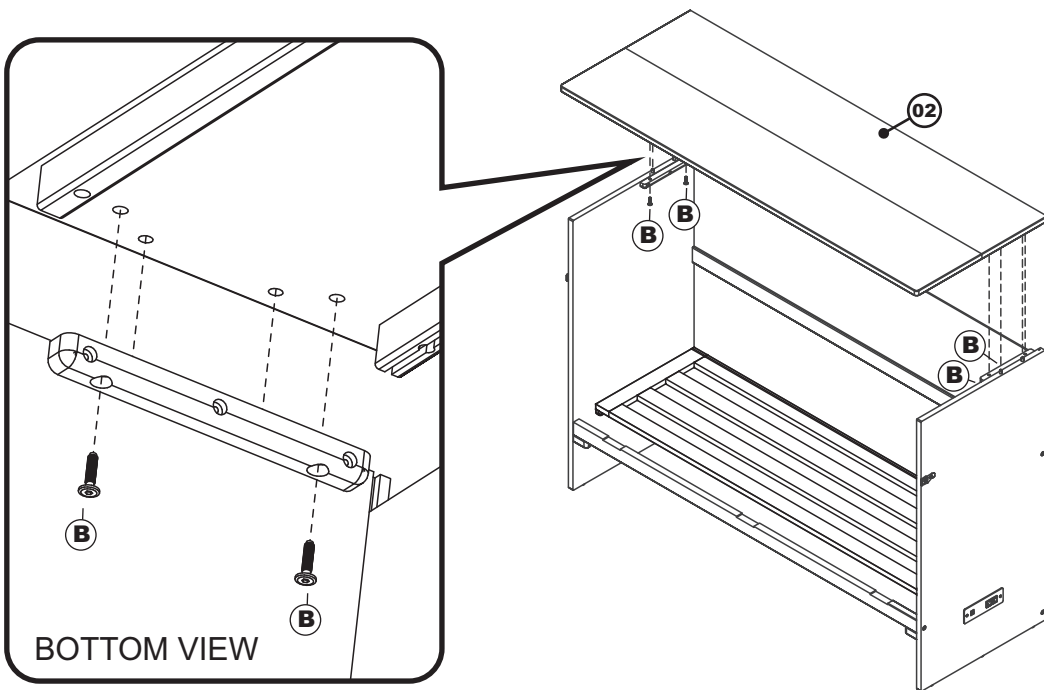

STEP 7

Open top drawer folding leg until lock of metal support as shown below.

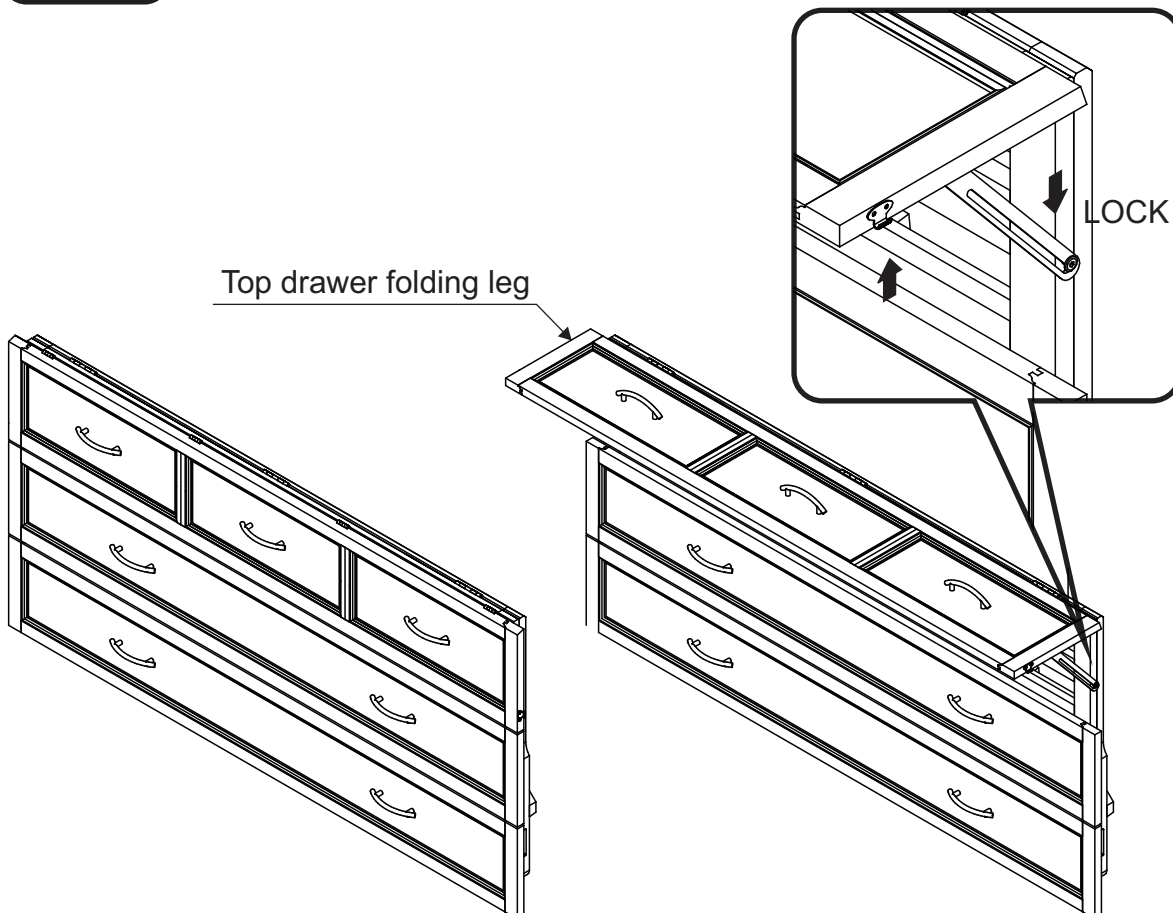

QUEEN

STEP 8

Attach door panel to cabinet assembly as shown below. Use wood screw (F) tighten with Phillips head screwdriver. (customer supplied). Be sure to align with cabinet.

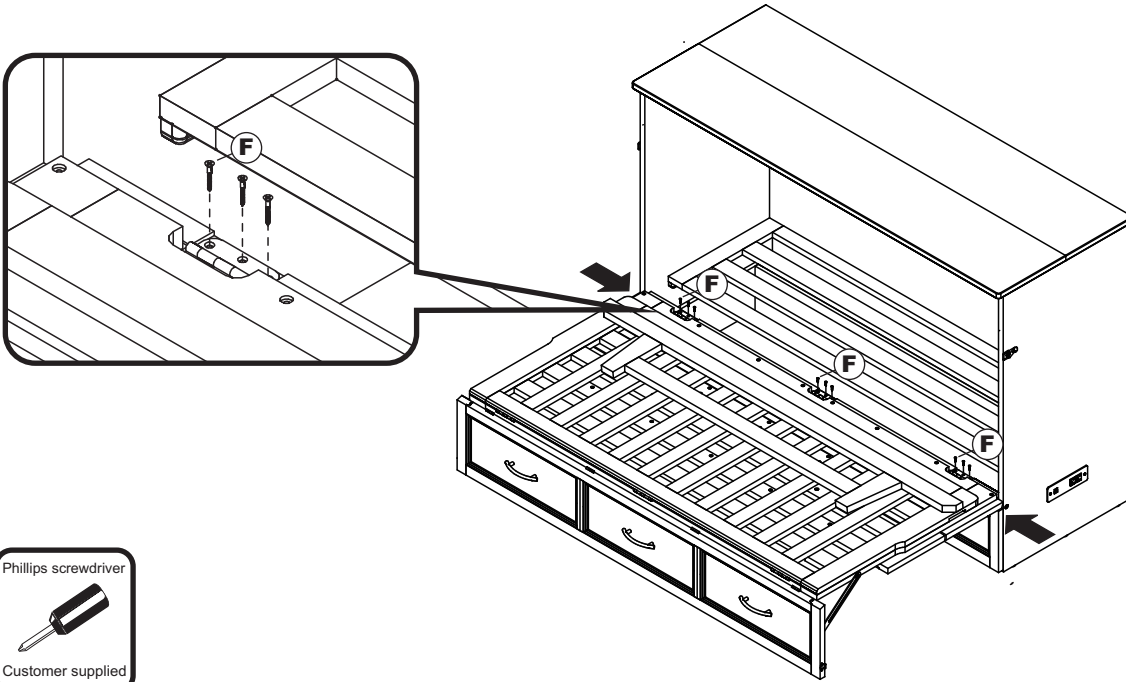

Phillips screwdriver

Customer supplied

STEP 9

Lift the door and push the metal support. Push the door closed and latch both sides as shown below.

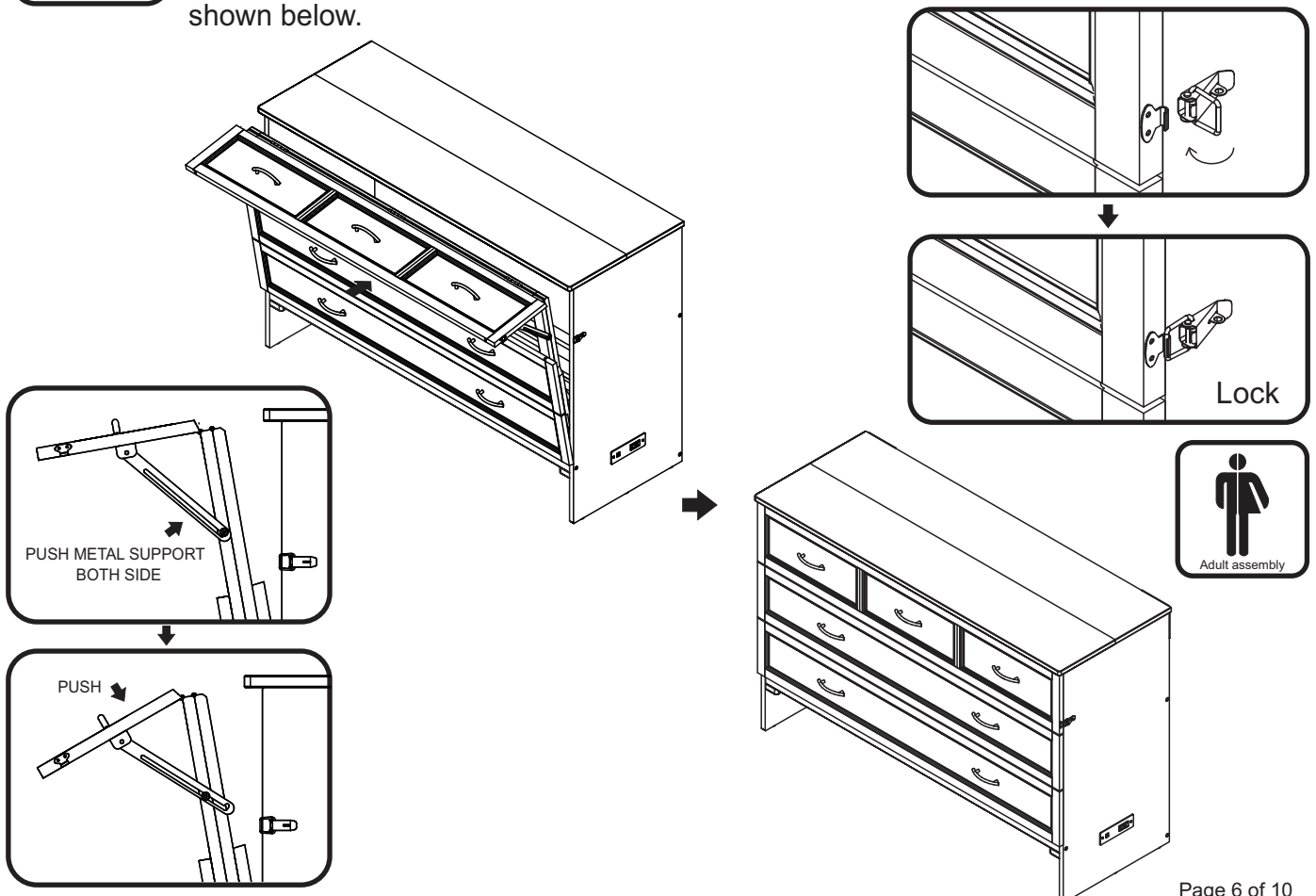

QUEEN

STEP 10 Attach triangle bracket (I) to the back of cabinet as shown below. Use wood screw (F) tighten with Phillips head screwdriver. (customer supplied).

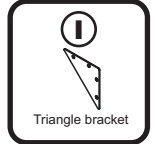
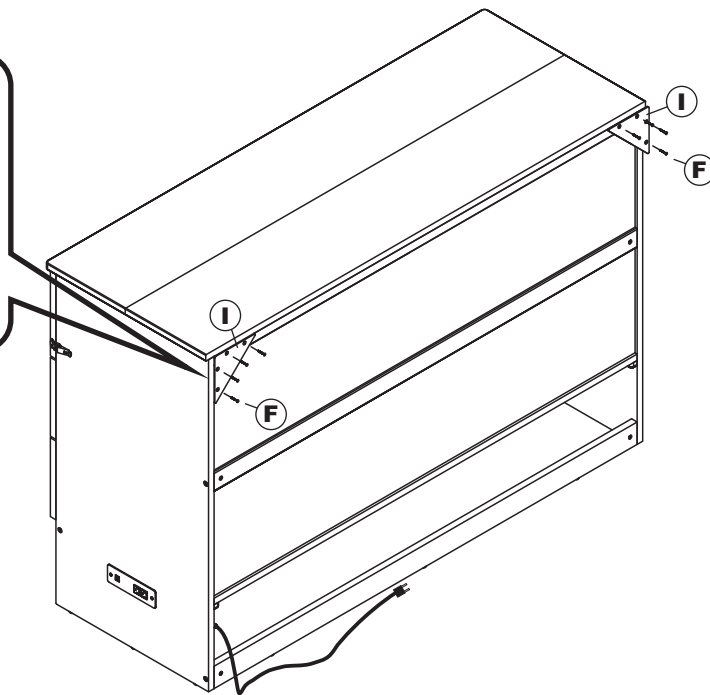
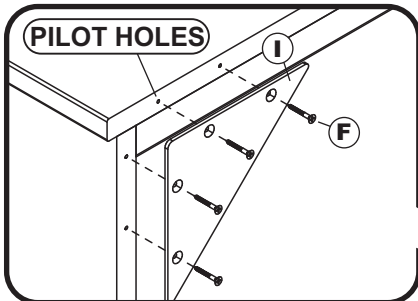

STEP 11 Lay the drawer face (11) on smooth, flat surface so the groove is facing upwards. Fit the drawer side (12) to drawer face (11), Use JCB (C), align groove inside panel with groove in drawer face. Tighten with Allen wrench (H).

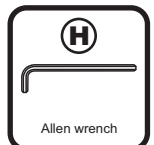
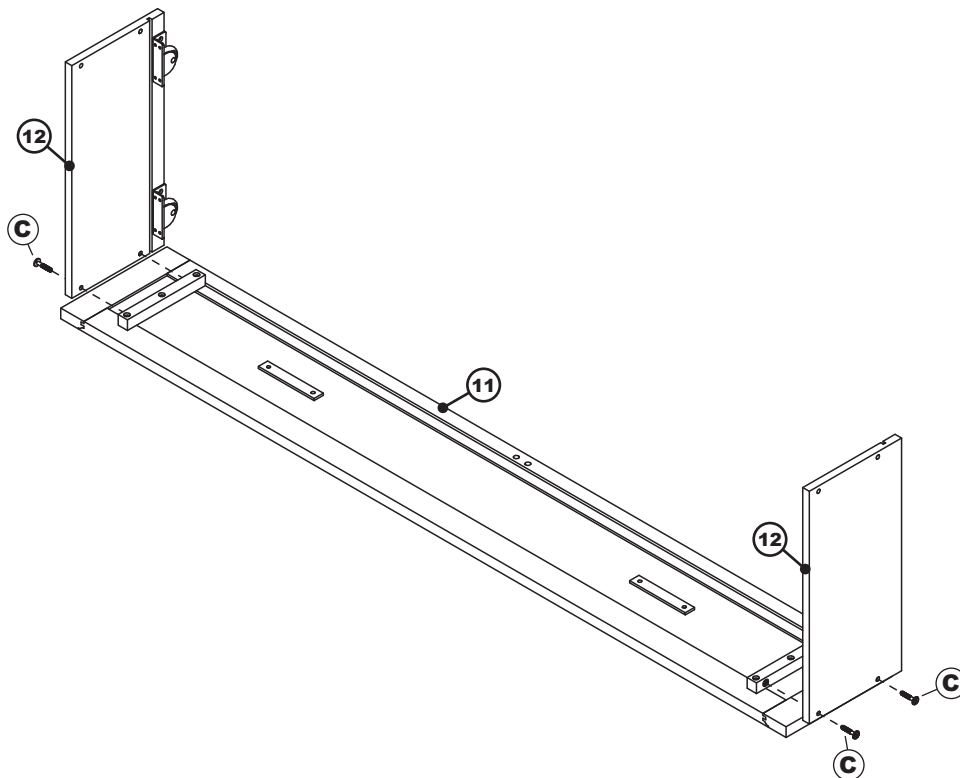

QUEEN

STEP 12

Guide the drawer panel (14) in carefully so that it won't jump out of its grooves. Be sure it fits fully into its groove at the bottom (in the drawer face) before fitting the drawer back. Attach drawer panel support (15) to the drawer face as shown below.

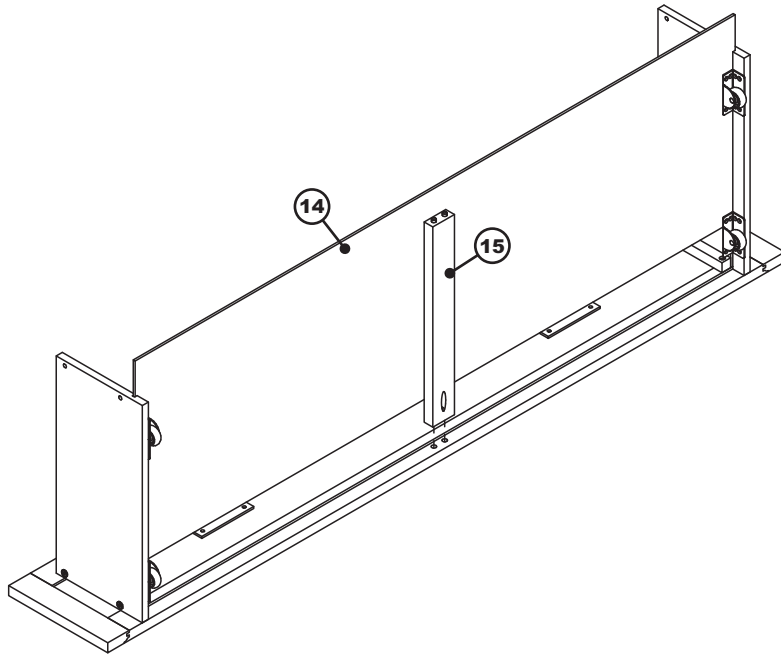

STEP 13

Attach drawer back (13) and drawer side block (16) to bed drawer assembly as shown below. Use JCB (C)(D). Tighten with Allen wrench (H). Use wood screw (G) tighten with Phillips head screwdriver (customer supplied).

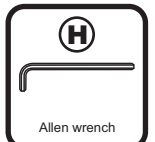
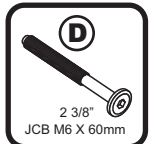
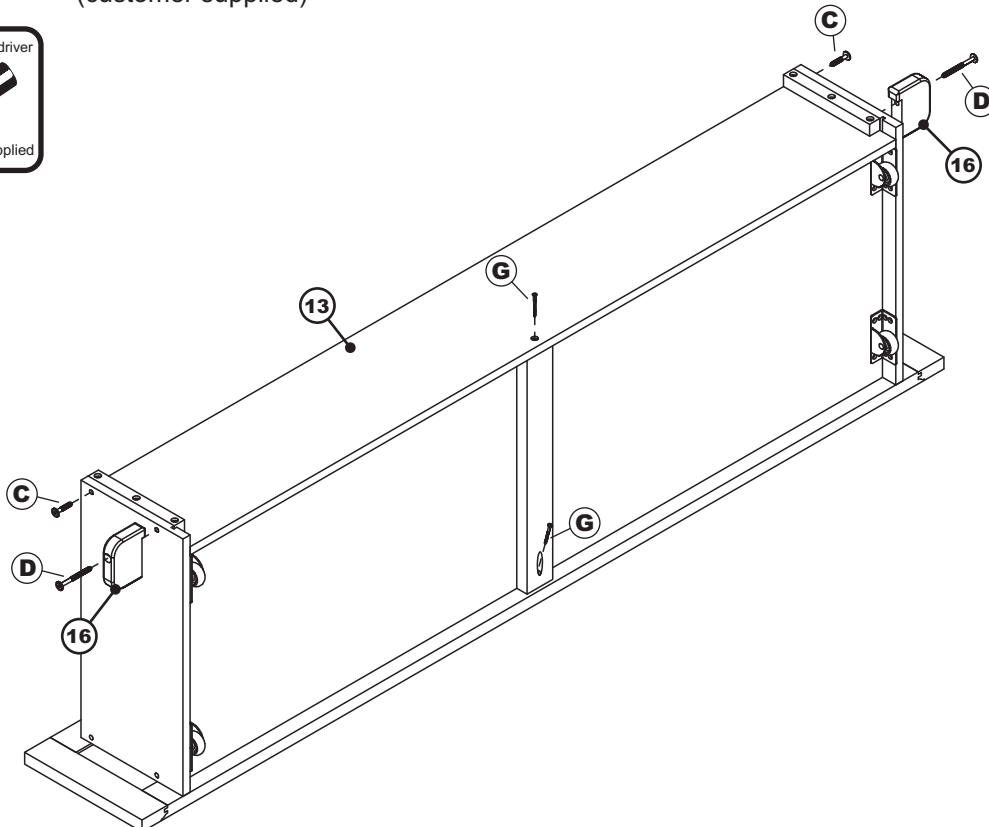

QUEEN

STEP 14

Move the murphy bed where you want to place them in the room. Push drawer assembly in as shown below. Be sure to align with cabinet.

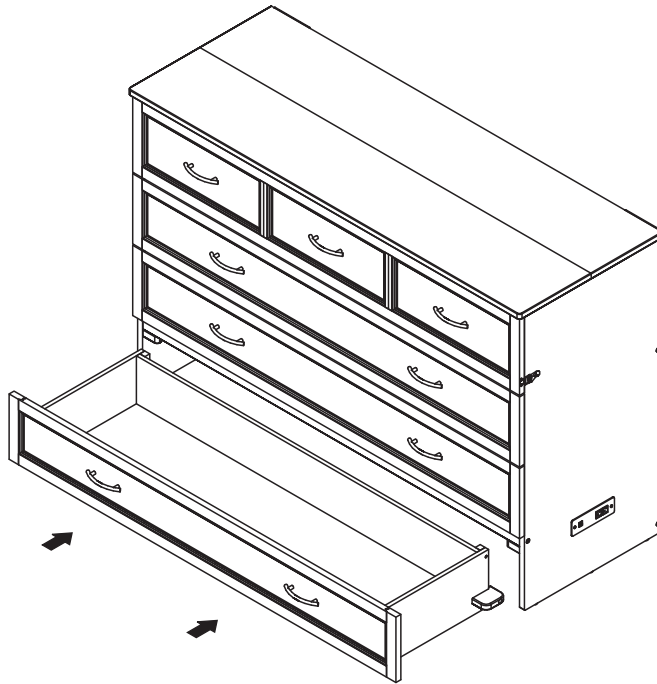

STEP 15

Unlatch the door and open top drawer folding leg until lock of metal support, folding down as shown.

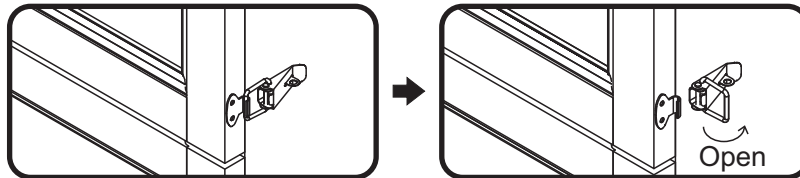

TOP DRAWER FOLDING LEG

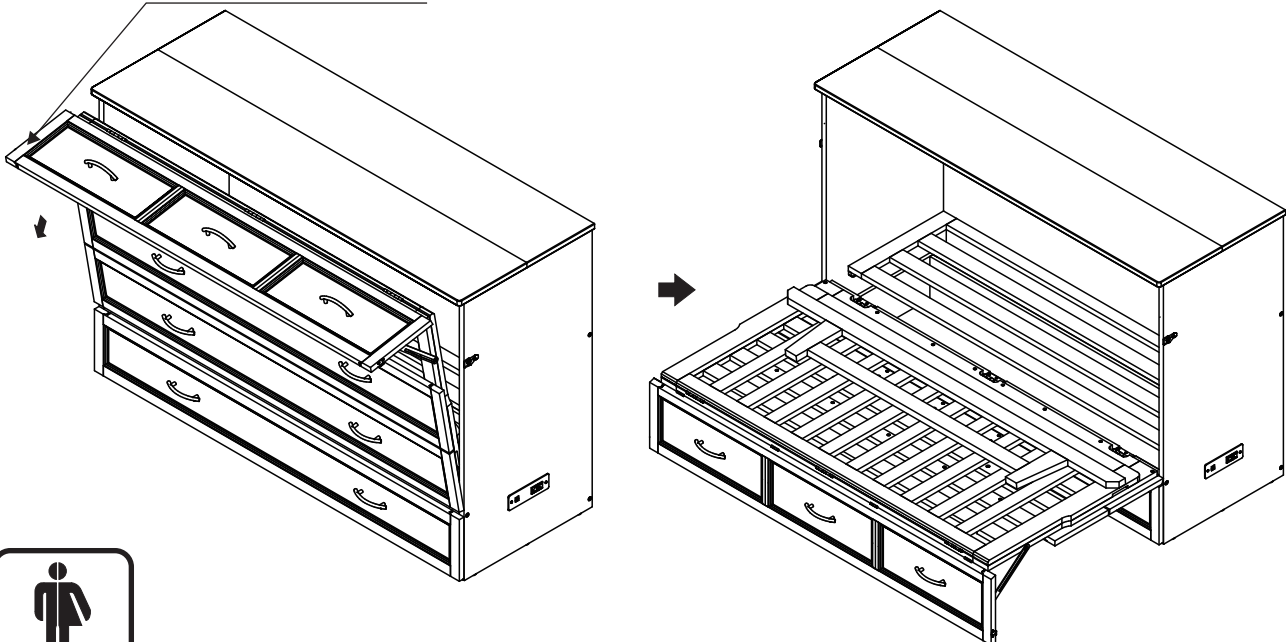

QUEEN

STEP 16 Open and pull footboard frame and open footboard leg as shown below.

