

ASSEMBLY INSTRUCTION

MODEL : #5095 (5')

Step 1 : Install the legs (B) to leg holder (C).

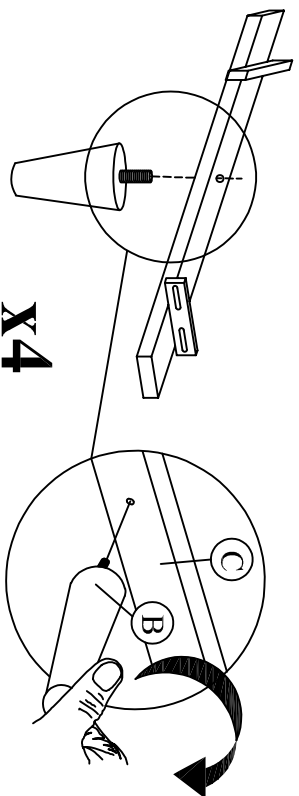

Step 2 : Attach Wooden Holder Support (D) to footboard (F) and headboard (A).

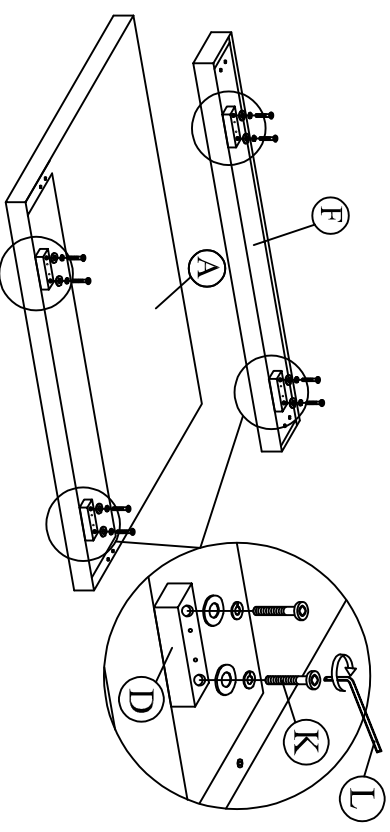

(BOX 1) #5095-Q-HB
BOX OF HEADBOARD

A	Headboard	1 pc
---	-----------	------

B	Legs 60 x 130(H)	4 pcs
---	---------------------	-------

C	Leg Holder	4 pcs
---	------------	-------

D	Wooden Holder Support Support Leg With Adjuster 180mm	4 pcs
---	--	-------

E	Support Leg With Adjuster 180mm	4 pcs
---	---------------------------------	-------

(BOX 2) #5095-Q-FB
BOX OF FOOTBOARD

F	Footboard	1 pc
---	-----------	------

G	Slat 137mm	4 pcs
---	---------------	-------

(BOX 3) #5095-K-Q-RAIL
BOX OF SIDE RAIL

H	Side Rail	2 pcs
---	-----------	-------

(BOX 4) #5095-Q-HB
HARDWARE LIST

I	ICRC M6 X 10 + Flat Washer	8 pcs
---	----------------------------	-------

J	ICRC M6 X 40	4 pcs
---	--------------	-------

K	ICRC M0X 30 + Spring Washer + Flat Washer	24 pcs
---	---	--------

L	M4 x 65mm	1 pc
---	-----------	------

M	CSK M4 x 32mm	8 pcs
---	---------------	-------

Step 3 : Attached side rail (H) to headboard (A) and footboard (F) and tightened the screws + flat washers (I) to the headboard (A) and footboard (F).

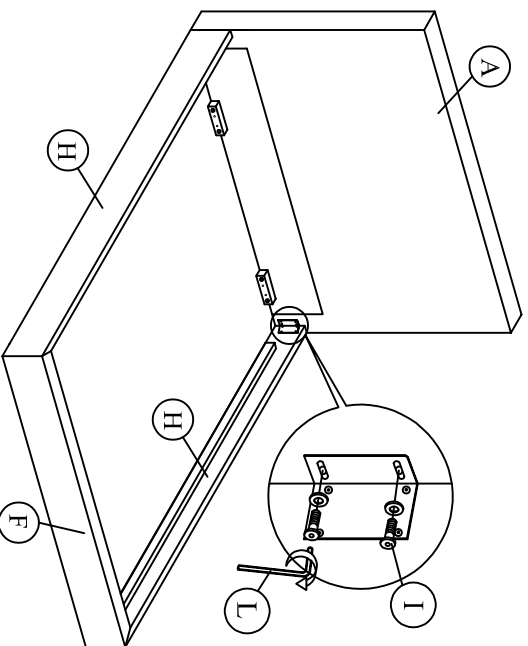

Step 4 : Attach leg holder (C) with leg (B) to the side rail (H), footboard (F) and headboard (A).

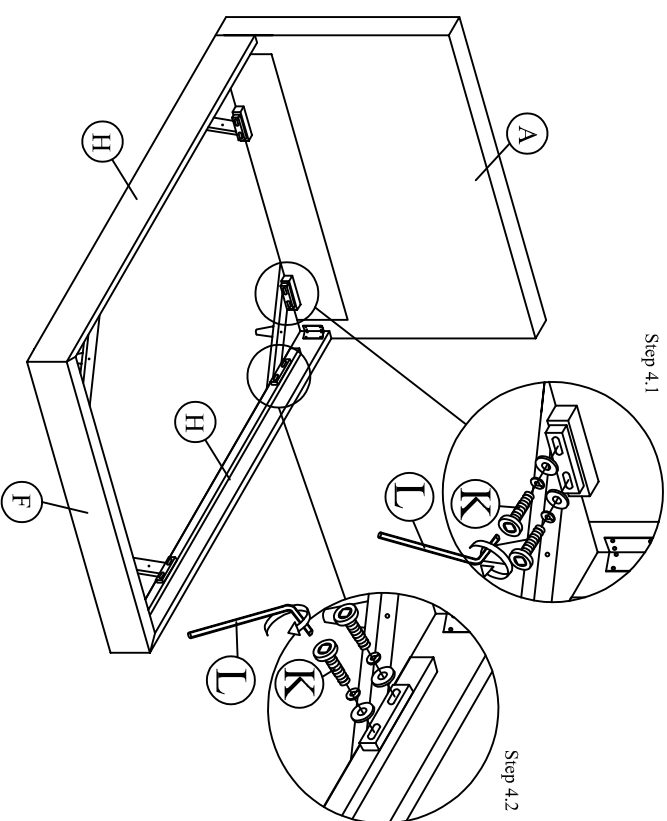

THE HARDWARE IS LOCATED IN THE PACKING ITEMS

PAGE 1 OF 2

Step 5 : Attach the support legs (E) to the slat (G) of the bed as shown.

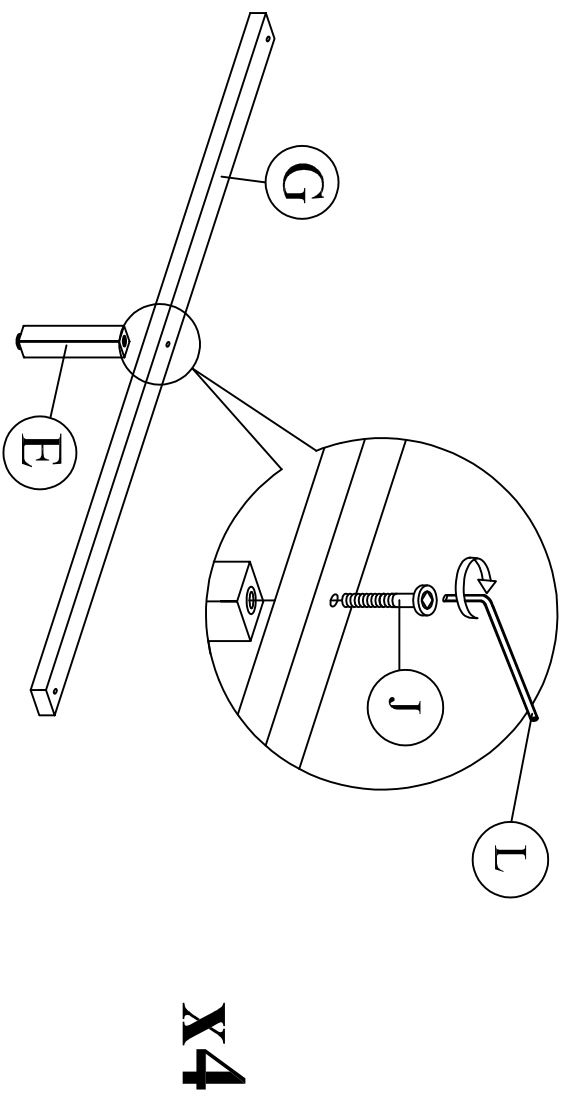

Step 6 : Affix the Slat (G) to the side rail support wood. Tighten all the 4 corner.

