

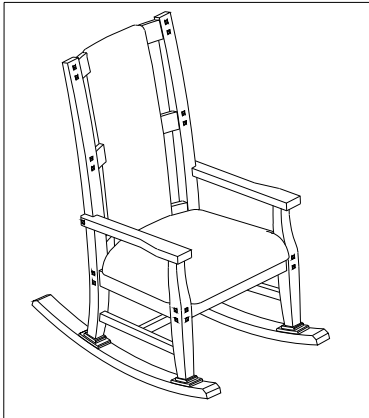

ASSEMBLY INSTRUCTION #1935



HARDWARE LIST

NO	SKETCH	HARDWARE	QTY
1		JCBC M8 x 80	4 Pcs
2		JCBC M8 x 40	2 Pcs
3		JCBC M6 x 35	2 Pcs
4		Spring Washer M8	6 Pcs
5		Plat Washer M8	6 Pcs
6		Allen Key	1 Pcs
7		Wrench Key	1 Pcs

PART LIST

NO	DESCRIPTION	QTY
A	Backrest	1 Pc
B	Seat cushion	1 Pc
C	Leg - L	1 Pc
D	Leg - R	1 Pc
E	Support Stretcher - L	1 Pc

PART LIST

NO	DESCRIPTION	QTY
F	Support Stretcher - R	1 Pc
G	Stretcher	1 Pc
H	Base Leg - L	1 Pc
I	Base Leg - R	1 Pc
J	Wood Plug	2 Pcs

Note:

Before Assembly, please open hexagonal nut, spring washer and flat washer from leg.

ASSEMBLY STEP

STEP 2

STEP 1

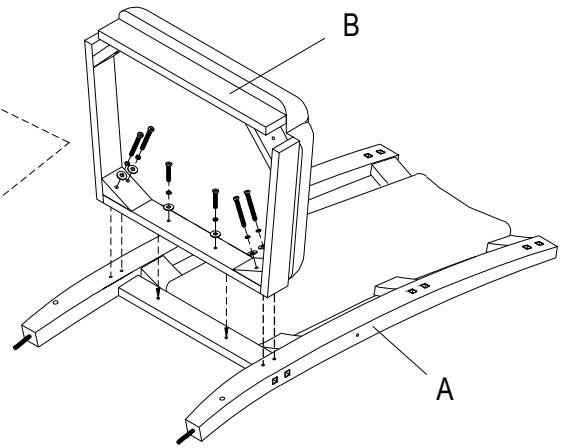
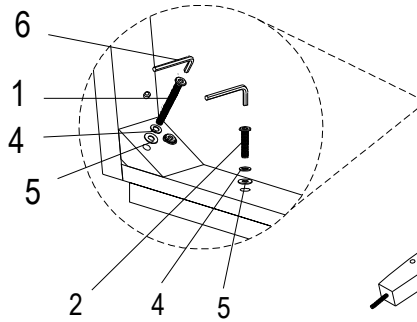
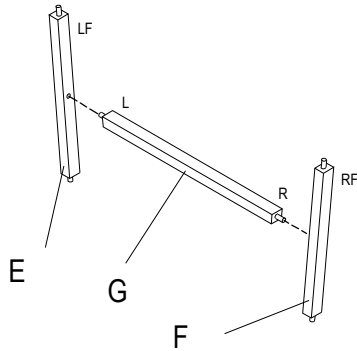

STEP 3

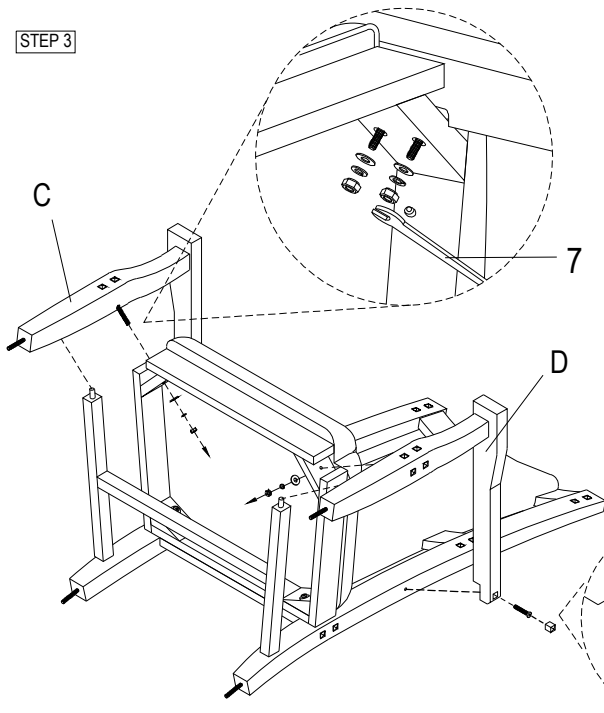

STEP 4

